

H/24
H/20
11/28/93
ASRP

PERMIT

SEWAGE DISPOSAL SYSTEM

DEPARTMENT OF HEALTH AND MENTAL HYGIENE

P 49639

A 43384

DISTRICT 4th

DATE 9/30/93

HOWARD COUNTY HEALTH DEPARTMENT

BUREAU OF ENVIRONMENTAL HEALTH

~~461-9933~~ 313-2640

DATE SYSTEM APPROVED 12/28/93

INDEXED

INSPECTOR ACM

Masonry Contractors, Inc. IS PERMITTED TO INSTALL ALTER

ADDRESS 4219 Hanover Pike, Manchester, Maryland 21102 PHONE 239-8330

SUBDIVISION Cabin Branch Farm LOT 8 ROAD 3228 Starting Gate Court

PROPERTY OWNER ~~Martin II, Inc.~~ Nancy Kestevan

ADDRESS

SEPTIC TANK CAPACITY 1000 GALLONS

NUMBER OF BEDROOMS 3

240 SQUARE FEET PER BEDROOM

LINEAR FEET OF TRENCH REQUIRED 240

TRENCHES - Trench to be 3 feet wide. Inlet 4 feet below original grade. Bottom maximum depth 6 feet below original grade. Effective area begins at 4 feet below original grade. 2 feet of stone below distribution pipe.

LOCATION - Place distribution box 100 feet from left lot line and 210 feet from front lot line (162.60') as viewed from Starting Gate Court. Install trenches on contour toward left lot line.

NOTES - No trench to exceed 100 feet in length. Provide 6" - 8" diameter cleanout and cap to grade or above on septic tank. OK MR 11/3/93

PLANS APPROVED BY Ronald J. Pinkley/Mark Rifkin REVISED DATE 11/02/93

COVER NO WORK UNTIL INSPECTED AND APPROVED

NEITHER THE HOWARD COUNTY COUNCIL NOR THE HEALTH DEPARTMENT IS RESPONSIBLE FOR THE SUCCESSFUL OPERATION OF ANY SYSTEM

NOTE: CLEANOUT REQUIRED EVERY 70 FEET OF SEWER LINE AND/OR AT 90° SWEEPS IN LINES FROM HOUSE TO DRAIN FIELDS, 90° ELBOWS NOT ACCEPTABLE.

NOTE: ALL PARTS OF SEPTIC SYSTEMS (I.E. TANK, DISTRIBUTION BOX TRENCHES) TO BE 100 FEET FROM WELL (UNLESS OTHERWISE SPECIFICALLY AUTHORIZED)

NOTE: IF DEEP TRENCH(ES) ARE USED CALL FOR INSPECTION BEFORE AND AFTER PLACING GRAVEL IN TRENCH(ES)

NOTE: NO DRY WELL SHALL EXCEED 15 FOOT IN DIAMETER NO ABSORPTION TRENCH TO EXCEED 100 FEET IN LENGTH

NOTE: ALL PIPE FROM HOUSE TO SEPTIC TANK MUST BE CAST IRON OR SCHEDULE 35/40 PVC OR ABS

PERMIT VOID AFTER TWO YEARS

NOTE: INSTALL STAND PIPE ON SEPTIC TANK AND DRY WELL STAND PIPES MUST BE 6 INCHES IN DIAMETER CAST IRON. CONCRETE OR TERRA COTTA OR PVA OR ABS ACCEPTED. IF TOP OF SEPTIC TANK IS DEEPER THAN 3 FEET. MANHOLE TO GRADE REQUIRED.

NOTE: DISTRIBUTION BOXES MUST HAVE BAFFLES

***INSTALLER IS RESPONSIBLE FOR OBTAINING FINAL APPROVAL ON THIS PERMIT**

A
43384

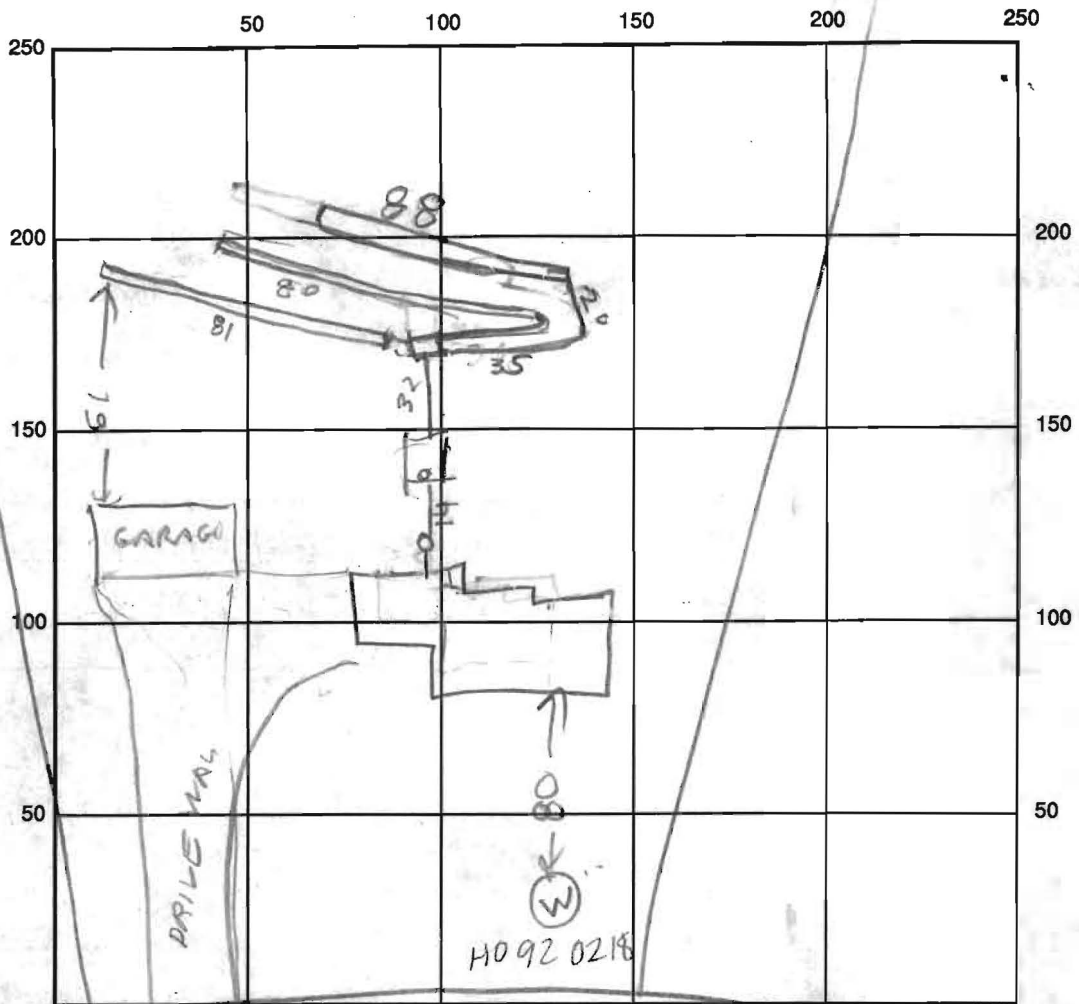

30
80
85
217

80

INDICATE NORTH - NAME ADJOINING ROADWAY AS BASE LINE
STARTING CATS COURT

SEPTIC TANK LEVEL OK 1000 CLEANOUTS 0/K

DISTRIBUTION BOX LEVEL OK

DRAIN FIELD/TITLE DEPTH 6 FT. TRENCH WIDTH 3 FT. INLET DEPTH 4 FT.

EFFECTIVE GRAVEL DEPTH 2 FT. TOTAL LENGTH 240 FT.

NUMBER OF TRENCHES 3 ONE SIDEWALL/BOTTOM AREA 720 SQ. FT.

DRYWALL INSIDE DIAMETER FT. EFFECTIVE DEPTH BELOW INLET FT.

ABSORBENT AREA SQ. FT.

REMARKS: 11/24/93 CALL FOR INSPECTION OF HOUSE HOOK UP
WHEN READY COVER REST OF SYSTEM RH

12/14/93 - HOUSE SEWER NOT YET INSTALLED RH

12/28/93 House connection made Am

12/24/93 WPI OK per WPI form - inspector RH

DATE SYSTEM APPROVED 12/28/93 INSPECTOR Amy McMullen