

AVP

- 7082
- 4' bm l sbk
- 5' red bm scl 1csbk
- 8' red bm sl 1msbk
- red bm fs1
- red bm vchsl
- 9.5'
- 7083
- 3.5' orgbm scl 1msbk
- 4' yellowbm sl saprock
- yellowbm chfs1
- 9'
- 11.5' beige platy fs1 saprock
- 7084
- 1' bm l
- 3' orgbm scl 1csbk
- 6' yellowbm sl saprock
- 10' orgbm chfs1
- 13' pinkbm fs1 platy saprock

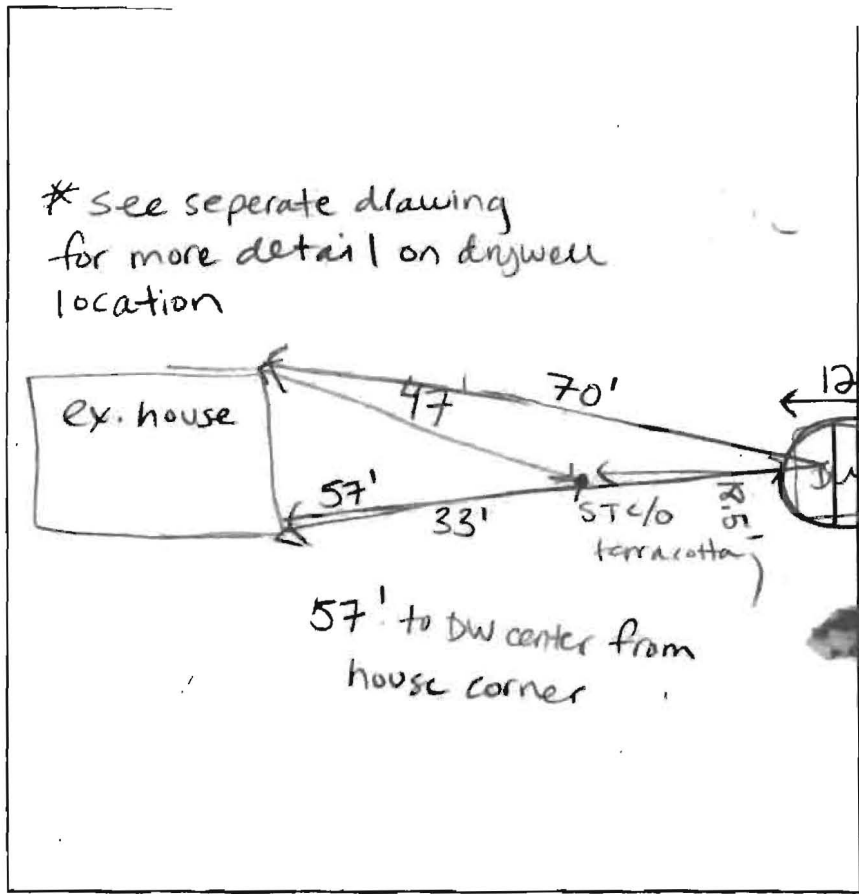

- 7085
- 4' bm scl 1csbk
- 6.5' bm sl 20% rx
- yellowbm fs1 platy saprock
- 8.5'
- yellowbm fs1
- 10'
- 7086
- 1' bm l
- 4.5' bm scl 1csbk
- 7' bm chfs1 & saprock
- 9' bm fs1
- 11' bm vfl es & mica schist
- 7087
- 4.5' redbm ch sl
- 8' pink sl saprock & mica schist
- 10' bm fl fs1 & platy saprock

DATE	TEST #	DEPTH	START	BREAK 1' DROP	STOP 2' DROP	TIME OF 2ND INCH	P/F/H
5-2-12	7082	4.5' / 9.8'	1:04	no movement			F
	7083	4.5' / 11.5'	1:18	1:21	1:26	5	P
	7084	3.5' / 13'	1:31	1:33 <sup>2</sup>	1:36	3	P
	7085	5' / 10'	1:36	730 min		-reshelf-	
	7086	11'	VISUAL				OK
	7087	5' / 10'	2:02	2:06	2:12	6	P
	7085	4' / 10'	2:13	2:14 <sup>27</sup>	2:16 <sup>50</sup>	2	P
	5002	4.5'	VISUAL	Rx			F
	5001	3'	VISUAL	Rx			F

REMARKS remainder parcel

SANITARIAN HS BACKHOE Chuck OTHERS Jeremy

TEST HOLES USED IN SDA \_\_\_\_\_ AVG. PERC TIME \_\_\_\_\_ SQ. FT/BR \_\_\_\_\_

TRENCH WIDTH 2' INLET DEPTH 4' MAX. BOT DEPTH 8 EFFECTIVE SW 2'