

U.S. Postal Service™

CERTIFIED MAIL™ RECEIPT

(Domestic Mail Only; No Insurance Coverage Provided)

For delivery information visit our website at www.usps.com®

OFFICIAL USE

Postage

\$

Certified Fee

Return Receipt Fee

(Endorsement Required)

Restricted Delivery Fee

(Endorsement Required)

Total Postage & Fees

\$

Postmark
Here

Sent To

John Lebon

Street, Apt. No.;
or PO Box No.

8462 Church Lane Rd

City, State, ZIP+4

Ellicott City, MD 21043

7004 1160 0002 3409 5233

Certified Mail Provides:

- A mailing receipt
- A unique identifier for your mailpiece
- A record of delivery kept by the Postal Service for two years

Important Reminders:

- Certified Mail may **ONLY** be combined with First-Class Mail® or Priority Mail®.
- Certified Mail is *not* available for any class of international mail.
- **NO INSURANCE COVERAGE IS PROVIDED** with Certified Mail. For valuables, please consider Insured or Registered Mail.
- For an additional fee, a *Return Receipt* may be requested to provide proof of delivery. To obtain Return Receipt service, please complete and attach a Return Receipt (PS Form 3811) to the article and add applicable postage to cover the fee. Endorse mailpiece "Return Receipt Requested". To receive a fee waiver for a duplicate return receipt, a USPS® postmark on your Certified Mail receipt is required.
- For an additional fee, delivery may be restricted to the addressee or addressee's authorized agent. Advise the clerk or mark the mailpiece with the endorsement "*Restricted Delivery*".
- If a postmark on the Certified Mail receipt is desired, please present the article at the post office for postmarking. If a postmark on the Certified Mail receipt is not needed, detach and affix label with postage and mail.

IMPORTANT: Save this receipt and present it when making an inquiry. Internet access to delivery information is not available on mail addressed to APOs and FPOs.

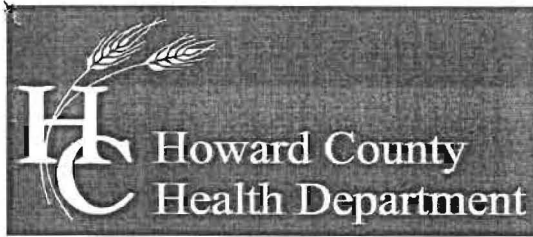

Bureau of Environmental Health

8930 Stanford Boulevard, Columbia, MD 21045

Main: 410-313-2640 | Fax: 410-313-2648

TDD 410-313-2323 | Toll Free 1-866-313-6300

www.hchealth.org

Facebook: www.facebook.com/hocohealth

Twitter: [HowardCoHealthDep](https://twitter.com/HowardCoHealthDep)

Dr. Maura J. Rossman, M.D., Health Officer

NOTICE OF VIOLATION

May 8, 2014

John Lebon
8462 Church Lane Road
Ellicott City, Maryland 21043

**RE: Sewage overflow; pollution of ground surface
8458 Church Lane Road. Ellicott City, MD**

Dear Mr. Lebon:

On April 28, 2014 a site investigation was conducted at 8458 Church Lane Road. Kathleen Cook has spoken to you previously on the telephone regarding access to the above reference property. At the time of investigation septic effluent was clearly visible on the surface of the ground behind 8454 Church Lane Road. After further investigation we were able to confirm the location and existence of two separate septic systems serving 8454 Church Lane and 8458 Church Lane. At the time of investigation we were able to conclude that the septic system supplying the house at 8458 Church Lane Road was the source of the septic effluent at the surface of the ground.

Be advised that the condition of septic tank effluent emerging onto the soil surface is a violation of the Code of Maryland (COMAR) 26.04.02.02(E): "A person may not dispose of sewage, body, or industrial wastes in any manner which may cause pollution of the ground surface, the waters of the State, or create a nuisance." This condition is also in violation of the Howard County Code 3.804(a)(1), as a sewage overflow is defined as a nuisance, [12.110(a)].

It is the property owner's responsibility to maintain the septic system so that an overflow does not occur until a repair can be performed.

You are hereby ordered to immediately pump and haul the contents of the septic tank. You will be responsible for continuing to pump the contents of the septic tank at a frequency that prevents septic effluent from coming to the surface. You must apply for connection to public sewer utilities within 14 (fourteen) days of receiving this notice. Failure to comply will result in the issuance of a civil citation(s). Under Howard County Code, paragraph 12.112, each day this violation is allowed to occur is considered a separate offense.

If you believe that the condition described above is not and could not be a hazard to health, or that the Health Department is not acting in compliance with pertinent laws and regulations, you may request a formal hearing before the Board of Health within 15 (fifteen) days of receipt of this letter. All requests are to be made in writing and directed to the Executive Secretary of the Board of Health at the above address.

If you have any questions regarding this letter, please contact me at the Bureau of Environmental Health, phone 410-313-1771.

Sincerely,

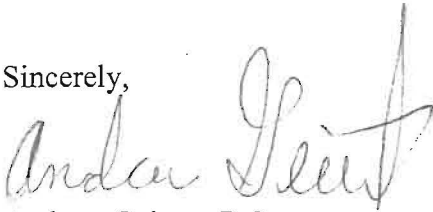
A handwritten signature in cursive script, appearing to read "Andrew Geisert". The signature is written in dark ink and is positioned to the right of the word "Sincerely,".

Andrew Geisert, R.S.
Bureau of Environmental Health
Well and Septic Program



Howard County
Health Department

Bureau of Environmental Health
7178 Columbia Gateway Drive
Columbia, MD 21046-2147
(410) 313-2640 Fax (410) 313-2648
TDD (410) 313-2323 Toll Free 1-866-313-6300
website: www.hchealth.org

RECORD OF INVESTIGATION

Case #:

LOCATION ELLICOTT CITY ZIP 21043
 COMPLAINEE LEBON JOHN ADDRESS 8458 CHURCH LANE DR PHONE _____
 COMPLAINANT _____ ADDRESS _____ PHONE 4103002754

REASON FOR INVESTIGATION 4/25/14 - While at the neighboring property on an unrelated complaint, that owner showed me an area in her backyard (8454) that appeared to have overflowing sewage. The 8458 yard appeared to have overflowing sewage as well. At that time, I was not sure if the systems were connected, or what was happening to cause overflow on both properties. KMC
4/25/14 - Consulted with Andrew of W&S program, we will go out to the property on 4/28 to evaluate the situation.

RECEIVED BY _____ DATE 4/25/14 ASSIGNED TO Cook, Kathleen DATE _____



RECORD OF INVESTIGATION

Case #:

<u>Date</u>	<u>Activity</u>	<u>Entered By</u>	<u>Comments</u>
4/25/14	Assigned to San	kcook	
4/25/14	Responded-HStat	kcook	
4/25/14	Field Inspection	kcook	<p>While at 8454 Church Lane Rd for an unrelated complaint, the owner there showed me an area in her yard that appeared to have septic effluent pooling on the ground. There appeared to be a cleanout pipe without a lid that was submerged in gray effluent, there was a mild odor. The 8454 owner said that she has not had any issues in her home, but the neighbor at 8458 has had issues with sewer. She pointed out an area in the 8458 yard that appeared to have standing water.</p> <p>I saw a man outside at 8458, and asked to see the area in back yard with the standing water. The man said yes, and I observed an area of grayish effluent draining out from the rear of the house, he said it was laundry water, and there were a few suds. Pictures were taken of both areas of standing water.</p>
4/25/14	Voicemail	kcook	VM to the owner of 8458, John LeBon.
4/25/14	Telephone Contact	kcook	REcd a CB from Mr. LeBon. He said that he is aware that there is a septic issue at 8458, he had it pumped out back in November 2013, and again about a month ago. He said that he intends to hook up to public sewer, and he has a plumber that will start the process with the county on Monday. He said that 8458 and 8454 share the septic system. I told him that I would be out again on Monday with Andrew from W&S to further evaluate what was going on. He said to call him if needed.
4/28/14	Field Inspection	kcook	Andrew Geisert and I inspected both properties to determine what was going on with the septic. From records that W&S had on file for 8454 and from Andrew's investigation, it appears that 8454 has a septic system with trenches that run behind the trenches for 8458. The septic system for 8454 is not showing signs of failure. It appears that the septic tank for 8458 is on the 8454 property, and that is showing signs of failure (overflowing septic effluent). Also, there is possible graywater discharge now being diverted from 8458 by a long PVC pipe. Andrew diagrammed the area, and will send the NOV letter ordering hook up to public sewer.



RECORD OF INVESTIGATION

Case #:

5/29/14	Field Inspection	hoswald	<p>A site visit was conducted to determine status of septic system and hand deliver the NOV letter (since we had not received back the certified mail receipt). While onsite, it appeared that the connection had already been done. On the way out, I was confronted by one of Mr. Lebon employee's who indicated that connection was completed. I spoke to Mr. Lebon on the phone and in person when he arrived home. Mr. Lebon's paperwork revealed that the permit was issued on 4/28/14. Mr. Lebon stated that the connection was completed approximately 3 to 4 days later by Bauman Plumbing LLC. (Contract # 14-4432-1. The connection was inspected on 5.9.14 by County inspector Duvall?). Mr. Lebon also indicated that the septic tank was pumped, crushed and filled in too by the same plumber. The septic tank area seemed indicative of this statement. Accela revealed P14001634 with a status of completed. No further action will be taken at this time.</p>
---------	------------------	---------	---

* Site Investigation conducted
 4/28/14. with Andrew Geisert
 @ 1:45pm Kathleen Cook *

- site visit revealed the septic serving 8458 Church Lane in on the neighboring property 8454 Church Lane.
- Also, the septic for 8458 is in a state of failure with effluent ponding at the surface above the septic tank and running down a hill over the ground.
- 8458 + 8454 have separate systems located in close proximity to each other
- septic serving 8454 Church Lane is showing NO signs of failure

* straight pipe *
 from laundry or sink

8458 has a straight PVC pipe ~~the~~ originator from the interior of the house through the side of the wall (above ground)

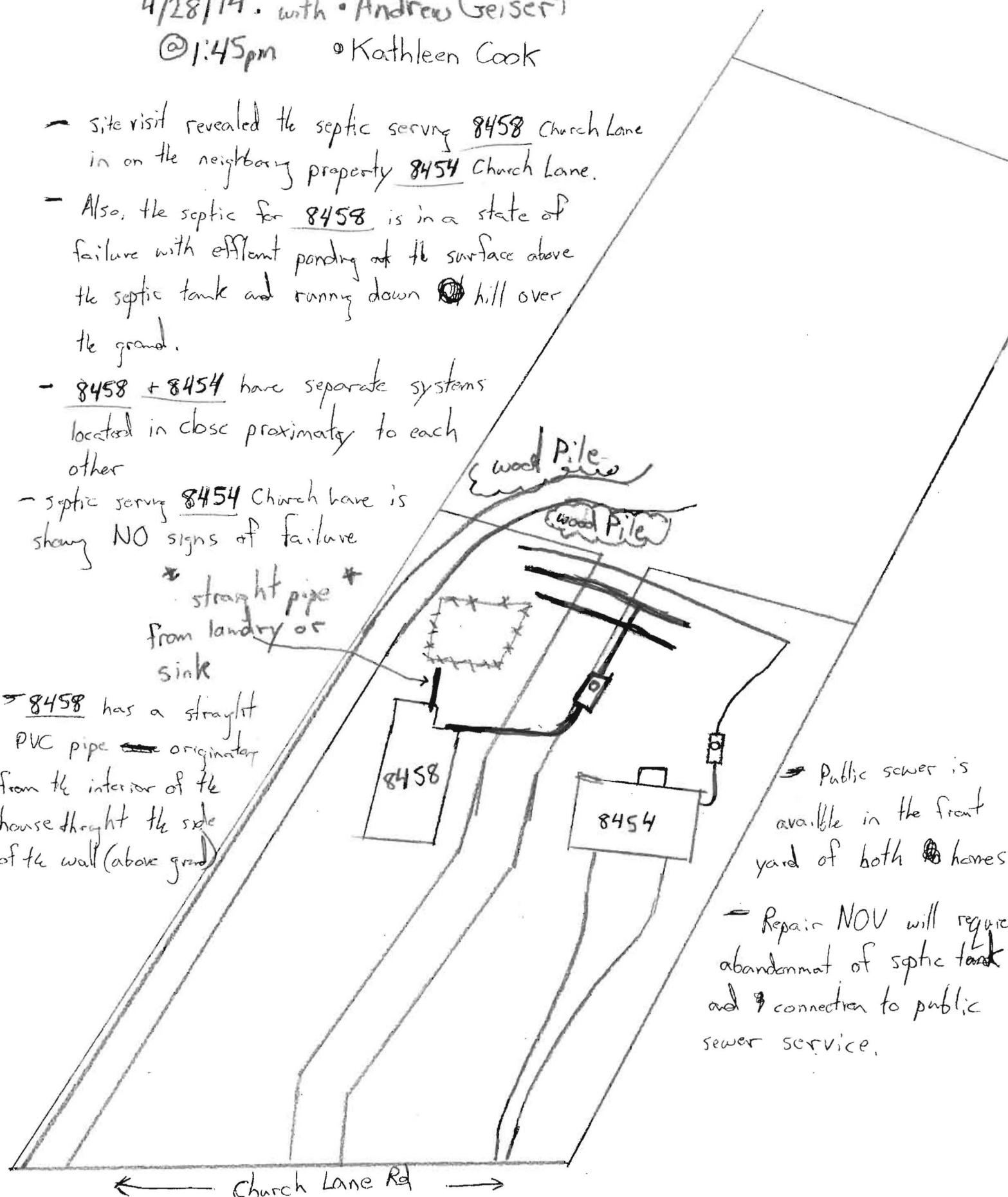

Public sewer is available in the front yard of both homes

- Repair NOV will require abandonment of septic tank and connection to public sewer service.

Search Result for HOWARD COUNTY

[View Map](#) [View GroundRent Redemption](#) [View GroundRent Registration](#)

Account Identifier: District - 02 Account Number - 217155

Owner Information

Owner Name:	LEBON JOHN	Use:	RESIDENTIAL
Mailing Address:	8462 CHURCH LANE RD ELLCOTT CITY MD 21043-3304	Principal Residence:	NO
		Deed Reference:	1) /11459/ 00001 2)

Location & Structure Information

Premises Address:	8458 CHURCH LANE RD ELLCOTT CITY 21043-0000	Legal Description:	LOT 1 20,305 SQ' 8458 CHURCH LANE RD RYMAC SUB
--------------------------	--	---------------------------	--

Map:	Grid:	Parcel:	Sub District:	Subdivision:	Section:	Block:	Lot:	Assessment Year:	Plat No:	20290
0018	0013	0206		0000			1	2013	Plat Ref:	

Special Tax Areas:	Town:	NONE
	Ad Valorem:	104
	Tax Class:	

Primary Structure Built	Above Grade Enclosed Area	Finished Basement Area	Property Land Area	County Use
1977	1,342 SF		20,305 SF	

Stories	Basement	Type	Exterior	Full/Half Bath	Garage	Last Major Renovation
1.000000	NO	STANDARD UNIT	FRAME	1 full		

Value Information

	Base Value	Value	Phase-in Assessments	
		As of	As of	As of
		01/01/2013	07/01/2013	07/01/2014
Land:	204,200	175,300		
Improvements	60,200	83,300		
Total:	264,400	258,600	258,600	258,600
Preferential Land:	0			0

Transfer Information

Seller: SMITH JASON M	Date: 01/05/2009	Price: \$400,000
Type: ARMS LENGTH MULTIPLE	Deed1: /11459/ 00001	Deed2:
Seller: HIRTH DORIS M	Date: 03/26/2007	Price: \$370,000
Type: NON-ARMS LENGTH OTHER	Deed1: /10591/ 00306	Deed2:
Seller: HIRTH DORIS MET AL	Date: 01/11/2002	Price: \$0
Type: NON-ARMS LENGTH OTHER	Deed1: /05914/ 00384	Deed2:

Exemption Information

Partial Exempt Assessments:	Class	07/01/2013	07/01/2014
County:	000	0.00	
State:	000	0.00	
Municipal:	000	0.00 0.00	0.00 0.00

Tax Exempt:	Special Tax Recapture:
Exempt Class:	NONE

Homestead Application Information

Homestead Application Status: No Application

HOWARD COUNTY, MD

Howard County

My Navigation

- CAP Detail/Summary
- Application Comments
- Workflow
- Workflow History
- App Spec Info
- Hierarchy
- Assess/Invoice Fees
- Payment Summary
- Attachments
- Manage Inspections
- Assign Tasks
- Address Info
- Parcel Info
- Sets

Permit ID	Status	Permit Type	Address	City	Issue Date	Inspector
P14001634	Completed	Residential Plumbing Addition Alteration Permit	8458 CHURCH LANE RD	SFD/CONNECT SEWER (S...	04/28/2014	ELL CIT
M12000657	Completed	Residential HVAC New Permit	8458 JACQUELINE CT	INSTALL HVAC NEW SF	07/26/2012	JES
E12003288	Completed	Residential Electrical New Home Permit	8458 JACQUELINE CT	NEW SFD - WIRE NEW 200...	07/17/2012	JES
E12003271	Completed	Residential Electrical Low Voltage Permit	8458 JACQUELINE CT	INSTALL 6 INTERCOM, 4 ...	07/17/2012	JES
E12000733	Completed	Residential New-Addition SFD Sprinkler Permit	8458 JACQUELINE CT	SFD/INSTALL NEW NFPA 1...	07/03/2012	JES

Building Permit ID: P14001634

Menu Save Reset Summary Reports Help

Go To Permit

Permit Number	Permit Type	Status
P14001634	Building/Residential/Plum/Add Alt	Completed

Opened Date *	Est Construction Cost	Total Fee Invoiced	Total Pay	Balance
04/28/2014	0.00	215.00	215.00	0.00

Description of Work

SFD/CONNECT SEWER (SEWER NOT IN SERVICE)

Record ID	In Possession Time (hrs)
14FIR-00000-05670	

My Tasks