

B 1 0945
1 2 3 6

SEQUENCE NO. (MDE USE ONLY)

STATE OF MARYLAND
APPLICATION FOR PERMIT TO DRILL WELL
535167 please type

STATE PERMIT NUMBER

HO-95-2113
70 fill in this form completely 79

Date Received (APA)
01/20/11

OWNER INFORMATION

Heritage Land Development
P.O. Box 482
Lisbon MD 21765

B 3 HOWARD LOCATION OF WELL

Howard
Meriwether Farm
Glencolg
2 MILES FROM TOWN

DRILLER INFORMATION

Ralph E Mayne
Ralph Mayne Well Drilling
17024 Hardy Rd., Mt. Airy, MD 21771

B 4

DIRECTION OF WELL FROM TOWN (CIRCLE BOX)

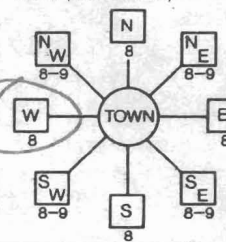

Meriwether DR
300 FT FROM ROAD
TAX MAP: 21 BLK: 16 PARCEL 28

WELL INFORMATION
APPROX. PUMPING RATE (GAL. PER MIN.) 5
AVERAGE DAILY QUANTITY NEEDED (GAL. PER DAY) 500

USE FOR WATER (CIRCLE APPROPRIATE BOX)

- DOMESTIC POTABLE SUPPLY & RESIDENTIAL IRRIGATION
- FARMING (LIVESTOCK WATERING & AGRICULTURAL IRRIGATION)
- INDUSTRIAL, COMMERCIAL, DEWATERING
- PUBLIC WATER SUPPLY WELL
- TEST, OBSERVATION, MONITORING
- GEO-THERMAL

NOT TO BE FILLED IN BY DRILLER HEALTH DEPARTMENT APPROVAL

Howard (13) A522987
COUNTY NAME COUNTY NO.
STATE SIGNATURE INSERT S
DATE ISSUED 5/2/2011
CO SIGNATURE Brian Baker 5/2/2012
NORTH GRID 519 000 EAST GRID 792 000

APPROXIMATE DEPTH OF WELL 150 FEET
APPROXIMATE DIAMETER OF WELL 6" NEAREST INCH

METHOD OF DRILLING (circle one)

BORED (or Augered) JETTED Jetted & DRIVEN
AIR-ROTary AIR-PERcussion ROTARY (Hydraulic Rotary)
CABLE REVerse-ROTary DRive-POINT

REPLACEMENT OR DEEPEMED WELLS (CIRCLE APPROPRIATE BOX)

- THIS WELL WILL NOT REPLACE AN EXISTING WELL
- THIS WELL WILL REPLACE A WELL THAT WILL BE ABANDONED AND SEALED
- THIS WELL WILL REPLACE A WELL THAT WILL BE USED AS A STANDBY-CONTACT LOCAL APPROVING AUTHORITY FOR POLICY ON STANDBY WELLS
- THIS WELL WILL DEEPEMED AN EXISTING WELL

SHOW MAJOR FEATURES OF BOX & LOCATE WELL WITH AN X

SOURCES OF DRILLING WATER

- 1. Well
- 2.
- 3.

WRITE THE BOX NUMBER FROM THE MAP HERE

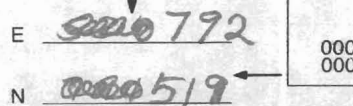

DRAW A SKETCH BELOW SHOWING LOCATION OF WELL IN RELATION TO NEARBY TOWNS AND ROADS AND GIVE DISTANCE FROM WELL TO NEAREST ROAD JUNCTION

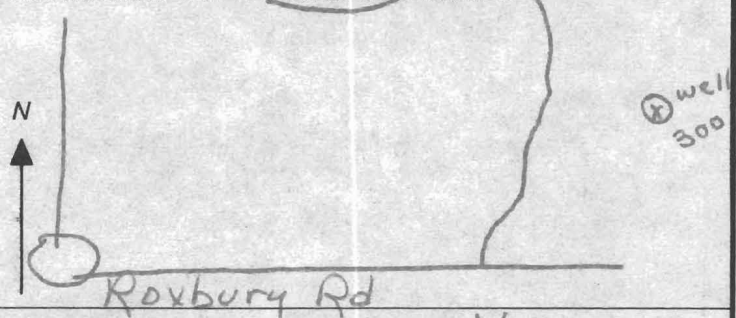

Not to be filled in by driller (MDE OR COUNTY USE ONLY)

APPROX. PERMIT NUMBER H02008G010
PERMIT No. HO-95-2113

SPECIAL CONDITIONS: Wells within 100' Must Be Simultaneously Yield Tested

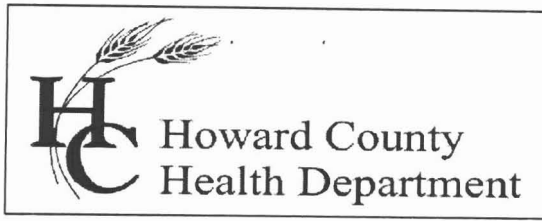

Bureau of Environmental Health
7178 Columbia Gateway Drive, Columbia, MD 21046-2147
Main: 410-313-6300 | Fax: 410-313-6303
TDD 410-313-2323 | Toll Free 1-866-313-6300
www.hchealth.org
Facebook: www.facebook.com/hocohealth
Twitter: HowardCoHealthDep

Maura J. Rossman, M.D., Health Officer

INTERIM CERTIFICATE OF POTABILITY
Expiration Date – March 23, 2013

September 23, 2013

Homeowner
14858 Meriwether Drive
Glenelg, Maryland, 21737

**RE: Meriwether Drive, Lot #36
14858 Meriwether Drive
Building Permit: B13000584
Well Permit: HO-95-2113**

Dear Homeowner:

This is to advise you that the septic system installation and water well construction for the above referenced property have been inspected and approved. Final approval of the septic system was granted on **7/5/2013**. Final approval of the well line connection to the dwelling was granted on **8/22/2013**. The well construction was completed on **6/14/2011**. Water samples were collected on **9/19/2013**.

The water sample results indicate that the water samples submitted for testing were free of coliform and fecal coliform bacteria at the time of sampling and are bacteriologically safe for drinking. This certifies that the initial sampling requirements of COMAR 26.04.04 "Well Regulations" have been met for the water supply system installed under well permit HO-95-2113. Although the submitted sample results are in compliance with COMAR standards, the Health Department does not guarantee water supplies.

This Interim Certificate of Potability will expire **six months** from the date of issuance. Submission of a second bacteriological test indicating the water is free of coliform and fecal coliform bacteria is required prior to the expiration date, after which time a Final Certificate of Potability will be issued. **Failure to submit an additional sample and obtain a Final Certificate of Potability will result in a Notice of Violation and is punishable as a misdemeanor under the Annotated Code of Maryland, Environment Article, 9-1311, subject to a fine of up to \$500 or imprisonment not to exceed three months.**

Please contact (410) 313-1773 to schedule a final water sample appointment or contact a Maryland certified water laboratory to schedule a water sample. A list of laboratories certified by the state of Maryland may be found at the following website:
<http://www.mde.state.md.us/assets/document/WSP-Labs-2010apr16.pdf>

Approving Authority,

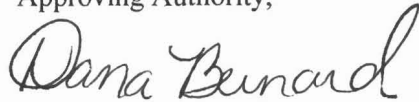
A handwritten signature in cursive script that reads "Dana Bernard".

Dana Bernard, REHS, RS
Environmental Sanitarian
Well & Septic Program

cc: Howard County Dept. of Inspections, Licenses, and Permits
Community Hygiene Program
File