

APPLICATION

PERCOLATION TESTING

A 513696

P _____

HOWARD COUNTY HEALTH DEPARTMENT
BUREAU OF ENVIRONMENTAL HEALTH
3525-H ELLICOTT MILLS DRIVE/ELLICOTT CITY, MARYLAND 21043
TELEPHONE: 313-2640

DISTRICT _____

DATE 7/20/2000

TO: THE COUNTY HEALTH OFFICER
ELLICOTT CITY, MARYLAND

I HEREBY APPLY FOR THE NECESSARY TEST PRIOR TO APPLICATION FOR PERMIT TO CONSTRUCT (OR RECONSTRUCT) A SEWAGE DISPOSAL SYSTEM.

PROPERTY OWNER FREDERICK W. RAULIN

ADDRESS BUSHY PARK Rd PHONE 301-854-6644

AGENT OR PROSPECTIVE BUYER THE WILLIAMSBURG GROUP LLC

ADDRESS P.O. BOX 1018 Columbia MD 21044 PHONE 410-997-8800

PROPERTY LOCATION:

SUBDIVISION Village of Three Keys LOT NO. _____

ROAD AND DESCRIPTION NORTH SIDE of Bushy Park Rd, approx 1 mile SOUTH of
WEST of FREDERICK Rd (RT 144) ADC map 3 K13

TAX MAP 8 PARCEL # 59

SIZE OF LOT _____ TYPE BLDG. _____
(SINGLE FAMILY DWELLING OR COMMERCIAL)

THE SYSTEM INSTALLED UNDER THIS APPLICATION IS ACCEPTABLE ONLY UNTIL PUBLIC FACILITIES BECOME AVAILABLE. I FULLY UNDERSTAND THE FEE CONNECTED WITH THE FILING OF THIS PERC TEST APPLICATION IS NON-REFUNDABLE UNDER ANY CIRCUMSTANCES. I ALSO AGREE TO COMPLY WITH ALL M.O.S.H.A. REQUIREMENTS IN TESTING THIS LOT.

Stigene P. Davis
(SIGNATURE OF APPLICANT)

APPROVED BY _____ FOR _____ DATE _____

DISAPPROVED BY _____ FOR _____ DATE _____

HOLD PENDING FURTHER TESTS _____

REASONS FOR REJECTION OR HOLDING _____

PERCOLATION TEST PLAT/PRELIMINARY PLAT - TITLE OR I.D. # _____ DATE _____

SITE DEVELOPMENT PLAN/FINAL PLAT - TITLE OR I.D. # _____ DATE _____

THIS IS NOT A PERMIT

COUNTY #

SOIL PROFILE

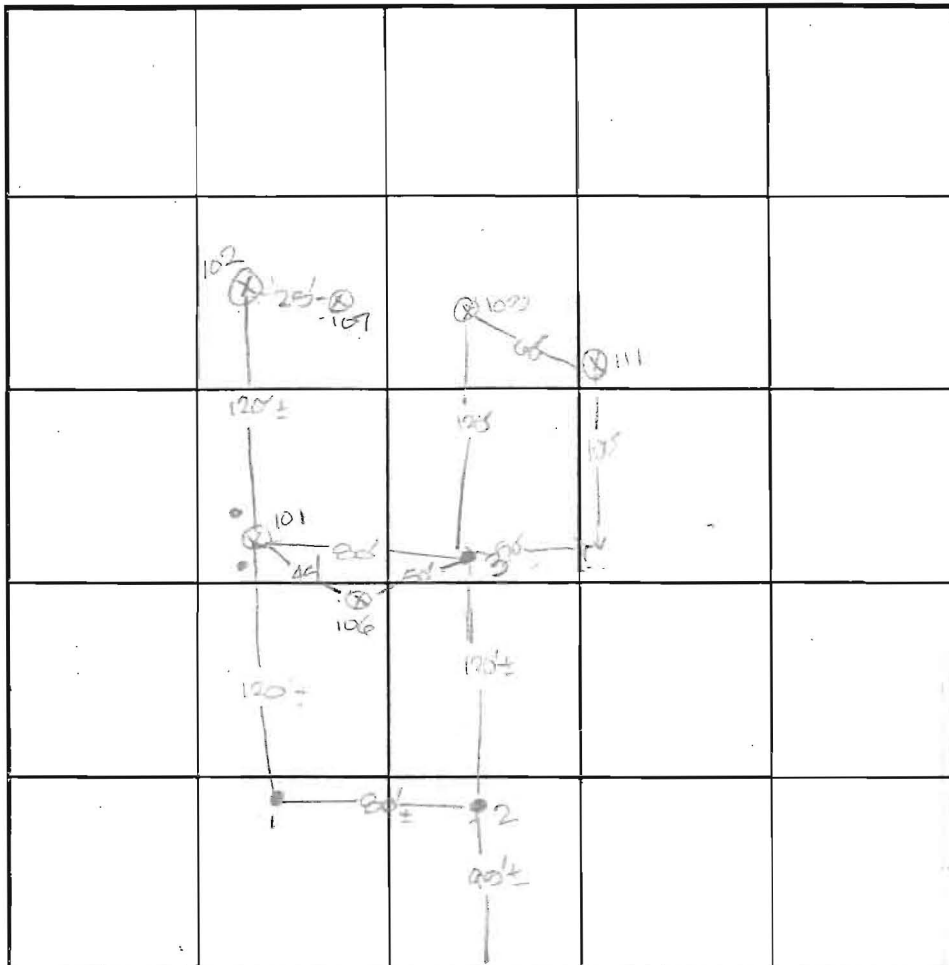
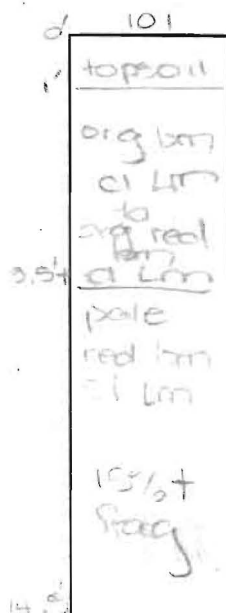
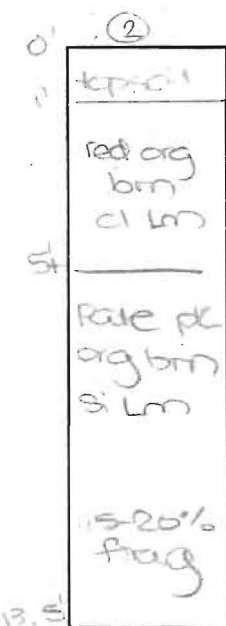
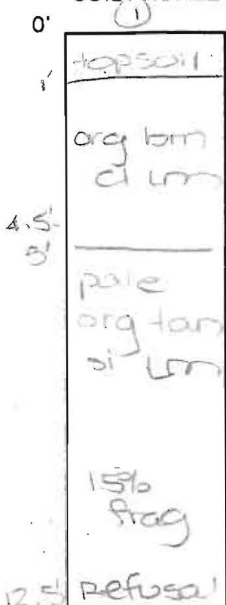

SOIL PROFILE

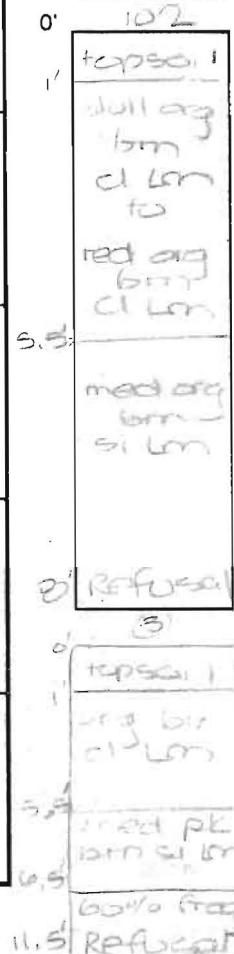

| DATE | TEST NO. | DEPTH | PRE-WET | | TEST - 1" DROP | | TIME |
|----------|----------|--------|----------------|---------------|----------------|-------|------|
| | | | START | STOP | START | STOP | |
| 11-16-00 | 1 | 5.5'S | 10:17 | 10:18 | 10:18 | 10:23 | 5 |
| | | 12.5'D | Refusal | - See profile | | | OK |
| | 2 | 5.5'S | 10:24 | 10:30 | 10:30 | 10:40 | 10 |
| | | 13.5'D | Visual | - See profile | | | OK |
| | 101 | 6.0'S | 10:42 | 10:44 | 10:44 | 10:47 | 3 |
| | | 14.5'D | Visual | - See profile | | | OK |
| | 102 | 8.0'D | Refusal | - See profile | | | FAIL |
| | 3 | 5.0'S | 11:16 | test stopped | | | |
| | | 11.5'D | Refusal | - See profile | | | FAIL |
| | 111 | 11.5'D | Refusal (7 1/2 | 10:16 (11:16) | | | FAIL |

REMARKS: ● = staked test hole (⊙) = test hole not staked

TYPE OF SOIL _____

TESTED BY _____ ALSO PRESENT _____

TRENCH DESIGN DATA: AVERAGE PERCOLATION TIME _____ TRENCH WIDTH _____

INLET DEPTH: _____ MAXIMUM BOTTOM DEPTH _____ SQ. FT./BEDROOM _____



APPLICATION

FOR PERCOLATION TESTING AND SITE EVALUATION

TEST DATE(S) _____

TEST TIME _____

AP 527809

AGENCY REVIEW: _____

DATE _____

DO NOT WRITE ABOVE THIS LINE

I HEREBY APPLY FOR THE NECESSARY TESTING/EVALUATION PRIOR TO ISSUANCE OF SEWAGE DISPOSAL SYSTEM PERMIT(S) TO:

CHECK AS NEEDED:

- CONSTRUCT NEW SEPTIC SYSTEM(S)
- REPAIR/ADD TO AN EXISTING SEPTIC SYSTEM
- REPLACE AN EXISTING SEPTIC SYSTEM

CHECK AS NEEDED:

- NEW STRUCTURE(S)
- ADDITION TO AN EXISTING STRUCTURE
- REPLACE AN EXISTING STRUCTURE

CHECK ONE:

- CREATE NEW LOT(S)
- BUILD ON AN EXISTING LOT IN A SUBDIVISION
- BUILD ON AN EXISTING PARCEL OF RECORD

IS THE PROPERTY WITHIN 2500' OF ANY RESERVOIR?

- YES
- NO

THE TYPE OF STRUCTURE IS:

- RESIDENTIAL WITH PROPOSED BEDROOMS IN THE COMPLETED STRUCTURE (NOTE UNKNOWN IF APPROPRIATE)
- COMMERCIAL (PROVIDE DETAIL OF NUMBERS AND TYPES OF EMPLOYEES/CUSTOMERS ON ACCOMPANYING PLAN)
- INSTITUTIONAL/GOVERNMENT (PROVIDE DETAIL OF NUMBERS AND TYPES OF EMPLOYEES/USERS ON ACCOMPANYING PLAN)

PROPERTY OWNER(S) **Frederick Raulin** Tim 410-984-0408

DAYTIME PHONE _____ CELL _____ FAX _____

MAILING ADDRESS **15101 Frederick Road** **Woodbine** **MD** **21797**

STREET CITY/TOWN STATE ZIP

APPLICANT **Heritage Land Development**

DAYTIME PHONE **410-489-7900** CELL **410-984-0408** FAX **410-489-9768**

MAILING ADDRESS **P.O. Box 482** **Lisbon** **MD** **21765**

STREET CITY/TOWN STATE ZIP

APPLICANT'S ROLE DEVELOPER BUILDER BUYER RELATIVE/FRIEND REALTOR CONSULTANT

PROPERTY LOCATION

SUBDIVISION NAME **Village of Three Keys** LOT NO. **5**

PROPERTY ADDRESS **15160 Bushy Park Road** **Woodbine, MD 21797**

STREET TOWN/POST OFFICE

TAX MAP PAGE(S) **8** GRID _____ PARCEL(S) **59** PROPOSED LOT SIZE **1.29 Ac**

AS APPLICANT, I UNDERSTAND THE FOLLOWING: THE SYSTEM INSTALLED SUBSEQUENT TO THIS APPLICATION IS ACCEPTABLE ONLY UNTIL PUBLIC SEWAGE IS AVAILABLE. THIS APPLICATION IS COMPLETE WHEN ALL APPLICABLE FEES AND A SUITABLE SITE PLAN HAVE BEEN RECEIVED. I ACCEPT THE RESPONSIBILITY FOR COMPLIANCE WITH ALL M.O.S.H.A. AND "MISS UTILITY" REQUIREMENTS. APPROVAL IS BASED UPON SATISFACTORY REVIEW OF A PERC CERTIFICATION PLAN. TEST RESULTS WILL BE MAILED TO APPLICANT.

SIGNATURE OF APPLICANT

HOWARD COUNTY HEALTH DEPARTMENT, BUREAU OF ENVIRONMENTAL HEALTH, WELL AND SEPTIC PROGRAM
7178 COLUMBIA GATEWAY DRIVE, COLUMBIA, MARYLAND 21046 (410) 313-1771 FAX (410) 313-2648
TDD (410) 313-2323 TOLL FREE 1-877-4MD-DHMH

lot 5

A/P



301

brown l
red
dense sct
massive
micaceous

dipping



301

24' micaceous
(pale red, yellow brown)
medium sct
saprinite

27' multicolored
course sct
20% chert
concretion
refuse

12'

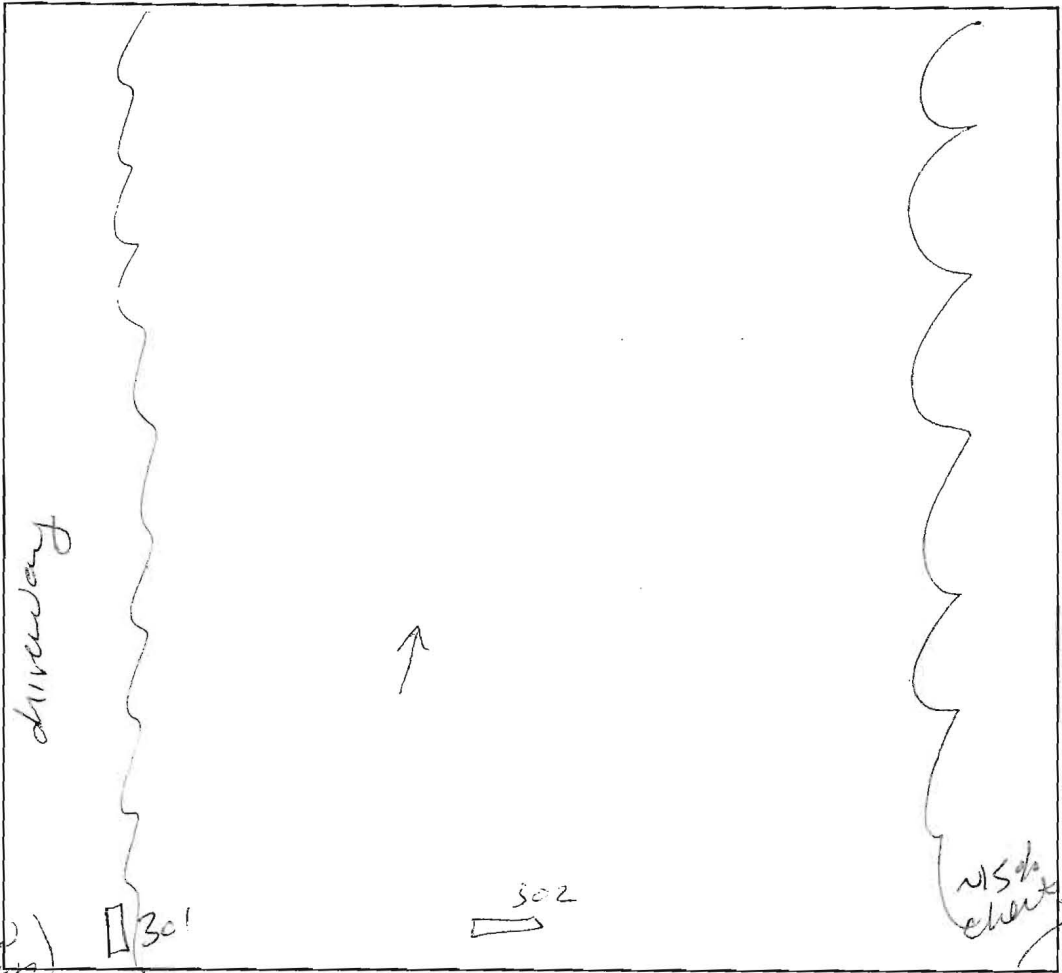

302

Bushy Park Rd

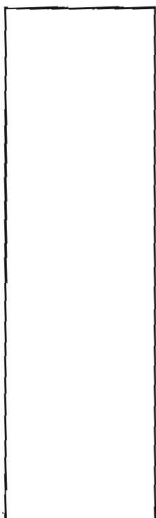

302

brown
l sct
red brown
fine sct.
micaceous
multicolored
(pale red
yellow brown)
dense fsl sct
siderite
saprinite
micaceous

15% coarse
chert
bed

| DATE | TEST # | DEPTH | START | BREAK 1" DROP | STOP 2" DROP | TIME OF 2nd INCH | P/F/H |
|----------|--------|------------|-------|------------------|-----------------|---------------------|-------|
| 10/17/07 | 301 | 5' / 12' | 9:48 | 9:53 | 9:59 | 6 | P |
| | 302 | 4'5" / 14' | 11:01 | 11:05 | 11:17 | 12 | P |
| | | | | | | | |
| | | | | | | | |
| | | | | | | | |
| | | | | | | | |
| | | | | | | | |
| | | | | | | | |
| | | | | | | | |
| | | | | | | | |
| | | | | | | | |
| | | | | | | | |

REMARKS very dry bushy area w/ trees

SANITARIAN SF BACKHOE Dennis Feag OTHERS T. Feag

TEST HOLES USED IN SDA _____ AVG. PERC TIME _____ SQ. FT/BR _____

TRENCH WIDTH _____ INLET DEPTH _____ MAX. BOT DEPTH _____ EFFECTIVE S/W _____

APPLICATION

PERCOLATION TESTING

A 513696

P _____

HOWARD COUNTY HEALTH DEPARTMENT
BUREAU OF ENVIRONMENTAL HEALTH
3525-H ELLICOTT MILLS DRIVE/ELLICOTT CITY, MARYLAND 21043
TELEPHONE: 313-2840

DISTRICT _____

DATE _____

TO: THE COUNTY HEALTH OFFICER
ELLICOTT CITY, MARYLAND

I HEREBY APPLY FOR THE NECESSARY TEST PRIOR TO APPLICATION FOR PERMIT TO CONSTRUCT (OR RECONSTRUCT) A SEWAGE DISPOSAL SYSTEM.

PROPERTY OWNER _____

ADDRESS _____ PHONE _____

AGENT OR PROSPECTIVE BUYER _____

ADDRESS _____ PHONE _____

PROPERTY LOCATION:

SUBDIVISION Village of Three Keys LOT NO. 5

ROAD AND DESCRIPTION Bushy Park Road

TAX MAP _____ PARCEL # _____

SIZE OF LOT _____ TYPE BLDG. _____
(SINGLE FAMILY DWELLING OR COMMERCIAL)

THE SYSTEM INSTALLED UNDER THIS APPLICATION IS ACCEPTABLE ONLY UNTIL PUBLIC FACILITIES BECOME AVAILABLE. I FULLY UNDERSTAND THE FEE CONNECTED WITH THE FILING OF THIS PERC TEST APPLICATION IS NON-REFUNDABLE UNDER ANY CIRCUMSTANCES. I ALSO AGREE TO COMPLY WITH ALL M.O.S.H.A. REQUIREMENTS IN TESTING THIS LOT.

(SIGNATURE OF APPLICANT)

APPROVED BY _____ FOR _____ DATE _____

DISAPPROVED BY _____ FOR _____ DATE _____

HOLD PENDING FURTHER TESTS _____

REASONS FOR REJECTION OR HOLDING _____

PERCOLATION TEST PLAT/PRELIMINARY PLAT - TITLE OR I.D. # _____ DATE _____

SITE DEVELOPMENT PLAN/FINAL PLAT - TITLE OR I.D. # _____ DATE _____

THIS IS NOT A PERMIT

Lot 5

COUNTY #

SOIL PROFILE

0' (203)
 Red Br Cl Loam
 4.5'
 Or Br Sa Cl Loam
 5.5'
 Light Or Br Sa Cl Loam
 6'
 > 50% Rock
 9.5' Hard Bottom
 (202)
 Red Br Cl Loam
 5.5'
 Yellow Si Loam
 Pocket of > 50% Rock
 6.5'
 Light Or Br Sa Cl Loam
 10-20% Rock
 11.5' Hard Bottom
 (204)
 Red Br Cl Loam
 4'
 Or Br Sa Cl Loam
 5'
 Light Or Br Sa Cl Loam
 10-15% Rock
 13'

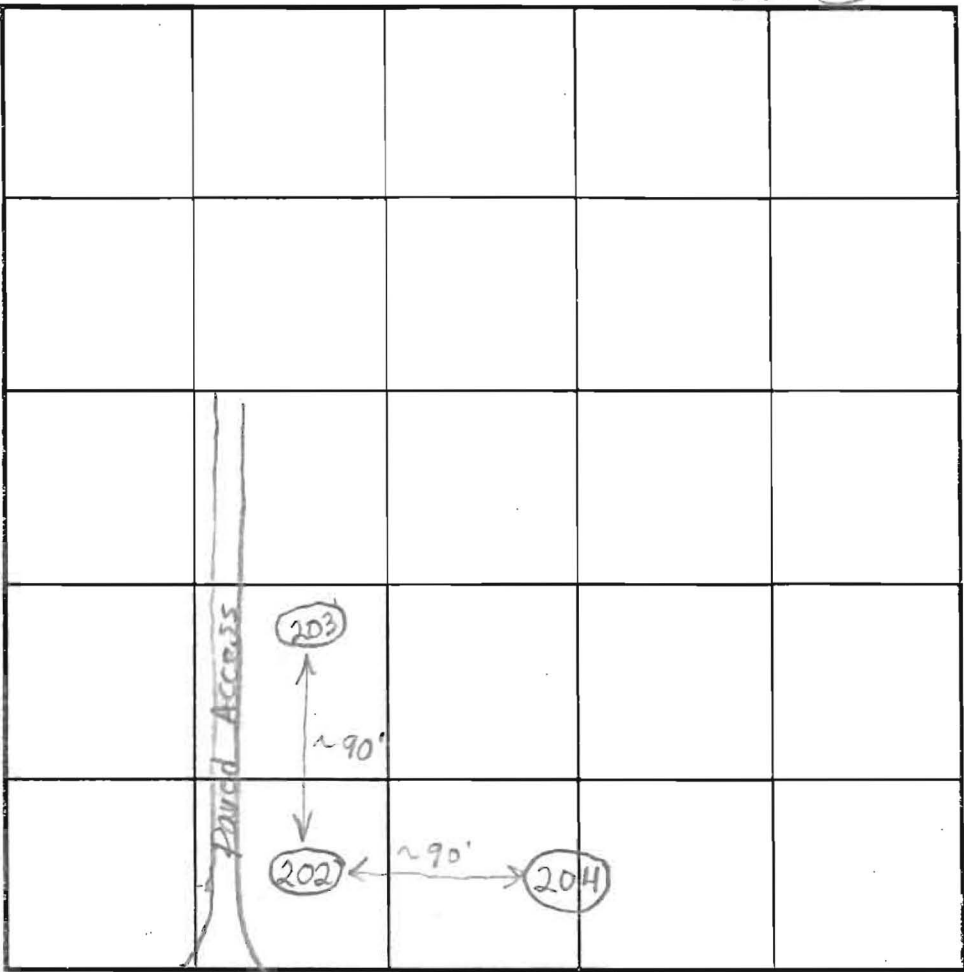

SOIL PROFILE

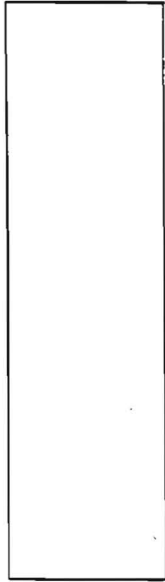

INDICATE NORTH - NAME ADJOINING ROADWAY AS BASE LINE.

Bushy Park Road

| DATE | TEST NO. | DEPTH | PRE-WET | | TEST - 1" DROP | | TIME |
|----------|----------|-------------|---------|---------|----------------|------|--------|
| | | | START | STOP | START | STOP | |
| 11/26/01 | 203 | 9.5'V | | | | | (F) |
| | 202 | 7' / 11.5'V | 2:26 | 2:23 | 2:23 | 2:31 | 8 |
| | 204 | 5' / 13'V | 2:35 | 2:46:30 | 2:46:30 | 3:16 | 29 1/2 |
| | | | | | | | |
| | | | | | | | |
| | | | | | | | |
| | | | | | | | |
| | | | | | | | |
| | | | | | | | |

REMARKS _____
 TYPE OF SOIL _____
 TESTED BY _____ ALSO PRESENT _____
 TRENCH DESIGN DATA: AVERAGE PERCOLATION TIME _____ TRENCH WIDTH _____
 INLET DEPTH _____ MAXIMUM BOTTOM DEPTH _____ SQ. FT./BEDROOM _____

WT 45

COUNTY #

SOIL PROFILE

119

topsoil

org red
bott
cl Lm

14 org
bott
sl Lm

cast
rock

Refusal

SOIL PROFILE

0'

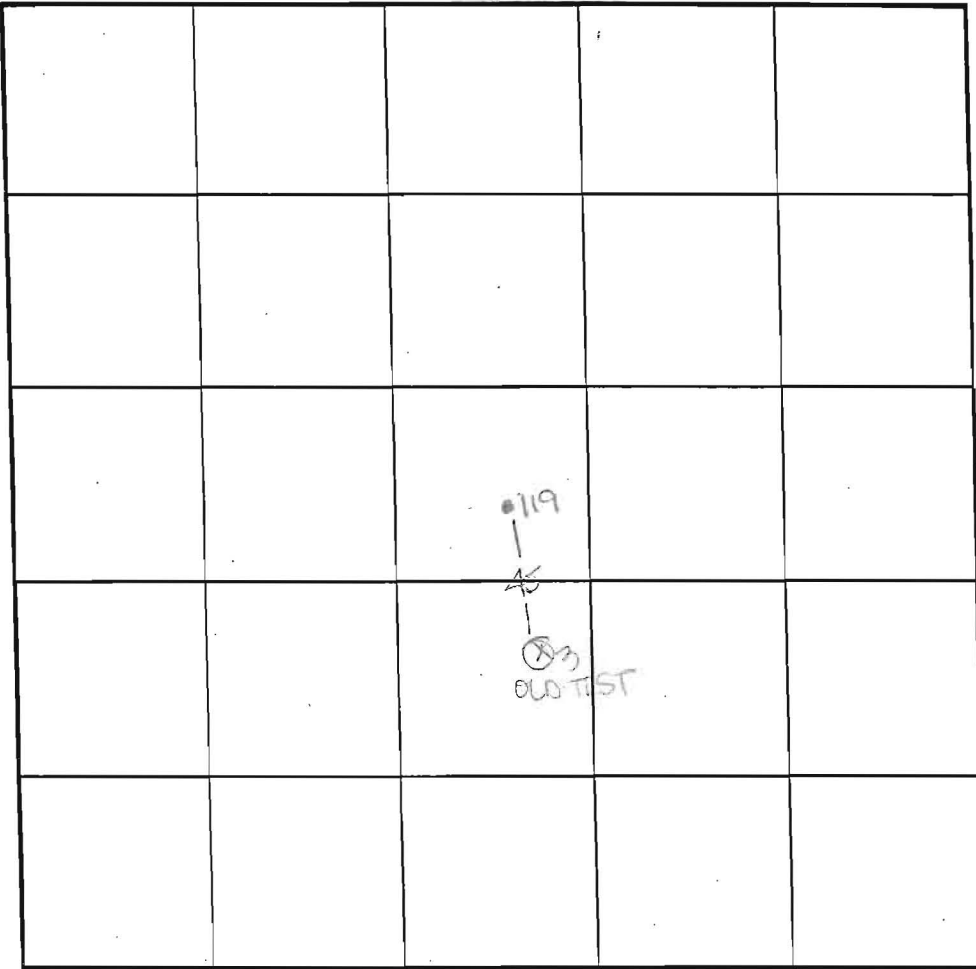

INDICATE NORTH - NAME ADJOINING ROADWAY AS BASE LINE.

Bushy Park Road

| DATE | TEST NO. | DEPTH | PRE-WET | | TEST - 1" DROP | | TIME |
|--------|----------|--------|---------|-------|----------------|------|------|
| | | | START | STOP | START | STOP | |
| 3-7-01 | 119 | 9.0' D | Refusal | 1-5ae | profile | | FAIL |
| | | | | | | | |
| | | | | | | | |
| | | | | | | | |
| | | | | | | | |
| | | | | | | | |
| | | | | | | | |
| | | | | | | | |
| | | | | | | | |
| | | | | | | | |
| | | | | | | | |
| | | | | | | | |

REMARKS hole tested as stored

TYPE OF SOIL _____

TESTED BY DKC ALSO PRESENT Albert's

TRENCH DESIGN DATA: AVERAGE PERCOLATION TIME _____ TRENCH WIDTH _____

INLET DEPTH _____ MAXIMUM BOTTOM DEPTH _____ SQ. FT./BEDROOM _____

| SEPTIC EASEMENT AREAS | | |
|-----------------------|------------------------|-----------------------------|
| LOT NUMBER | LOT AREA (SQUARE FEET) | SEPTIC ESMNT. (SQUARE FEET) |
| 5 | 58,656 | 10,454 |
| 6 | 59,984 | 10,360 |
| 7 | 59,087 | 10,598 |

LEGEND

CONTOUR INTERVAL 2 FT.

EXISTING CONTOUR

PROPOSED CONTOUR

SPOT ELEVATION

PERCOLATION LOCATION - PASS

PERCOLATION LOCATION - FAIL

TYPICAL HOUSE LOCATION

ALTERNATE WELL LOCATION AREA

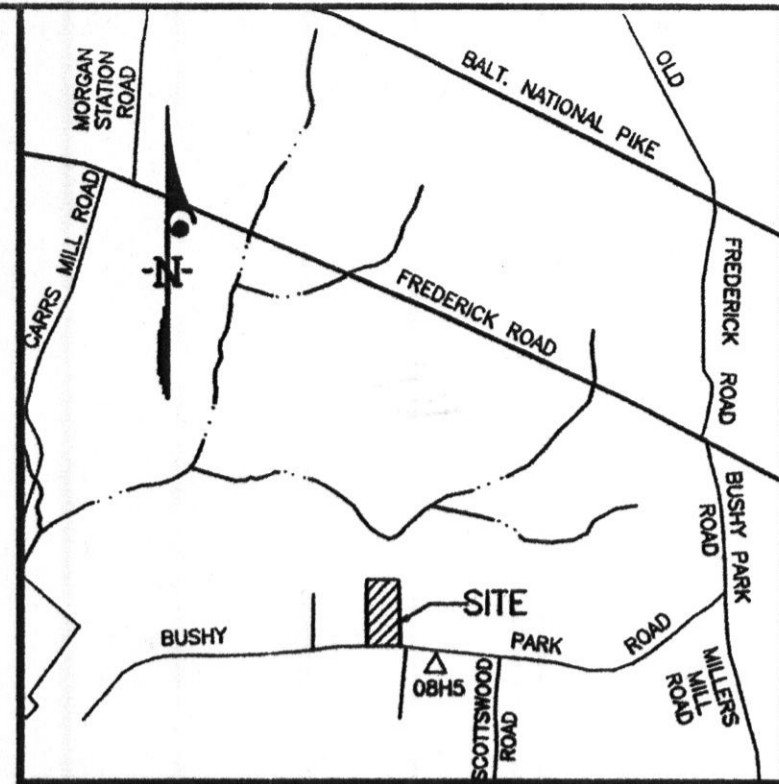

HOWARD COUNTY BENCH MARK
NO. 08H5
N. 183,356.6429
E. 396,572.1657
Scale: 1"=2000'

PARCEL 2
L. 439 F. 515
12.5 ACRES

NON-BUILDABLE
BULK PARCEL

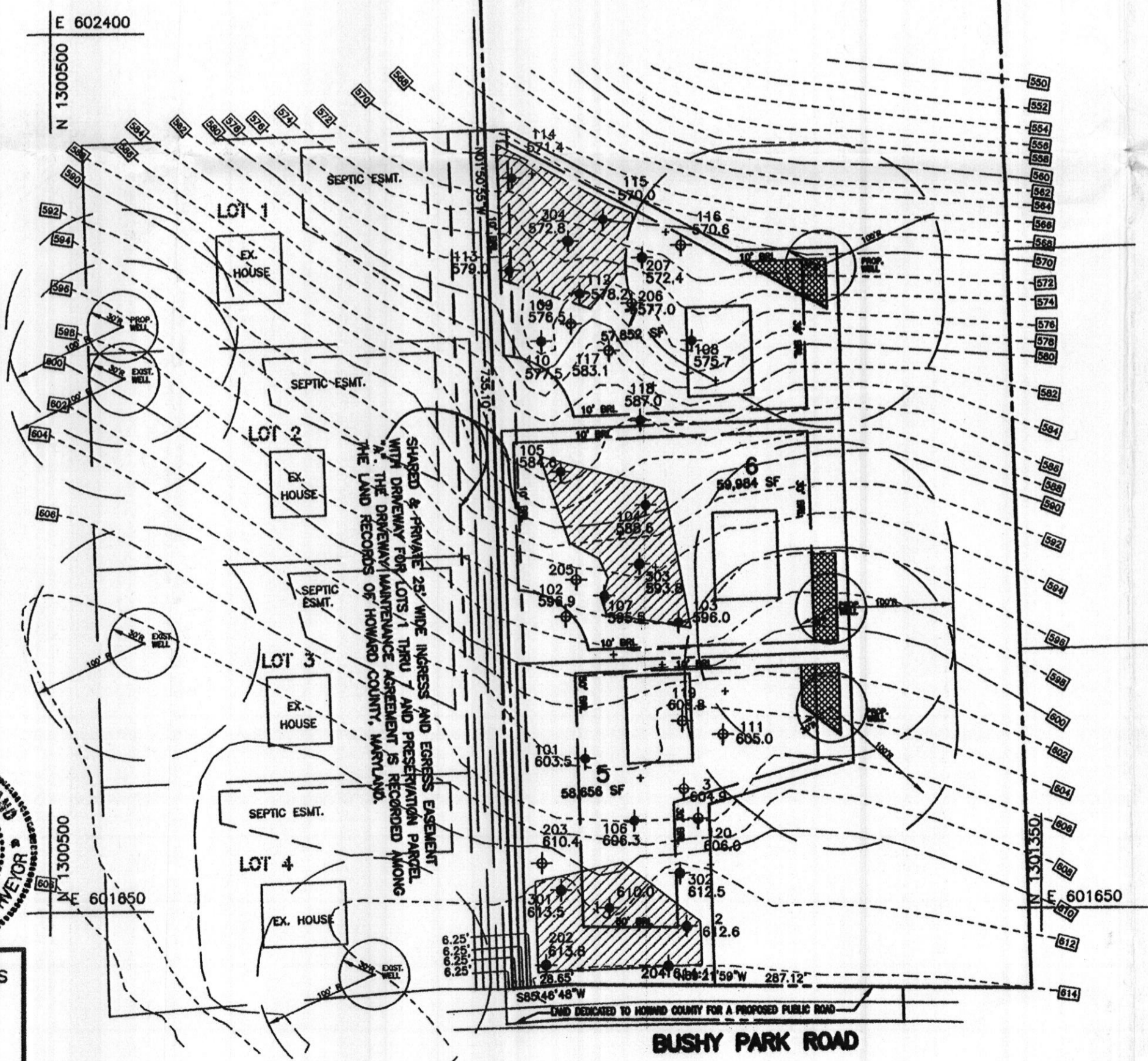

GENERAL NOTES:

- Existing topography shown is from Howard County aerial topography. Perc. test location elevations based on field run survey by Clark, Finefrock & Sackett. Existing Topography has been field verified.
- All existing and proposed, septic systems and wells within 100' feet of the adjoining property have been shown.
- This area designates a private sewerage easement of 10,000 sq. ft. as required by the Maryland State Department of the Environment for individual sewage disposal. Improvements of any nature in this area are restricted until public sewage is available. These easements shall become null and void upon connection to a public sewage system. The County Health Officer shall have the authority to grant adjustments to the private sewerage easement. Recordation of a modified sewerage easement shall not be necessary.
- No grading shall be performed over any portion of a septic easement unless specifically approved by the Health Department.
- This property is zoned RC.
- All wells are to be drilled prior to Record Plat submittal.
- Use-In-Common Driveway Easements are indicated to provide driveway access to Lots 1 - 7.
- The lot shown hereon complies with the minimum ownership width and lot area as required by the Maryland State Department of the Environment.
- The house location shown complies with the minimum building restriction regulation.
- This area designates a proposed 1,500 square foot well area.
- Any change to a private sewerage easement will require a revised perc certification plan.
- All wells to be drilled prior to final plat approval. It is the developer's responsibility to schedule well drilling prior to final plat submission. It will not be considered government delay if the well drilling holds up the Health Department signature of the plat. (applicable to proposed subdivision only).
- Lots 6 & 7 to have maximum 5 bedrooms.

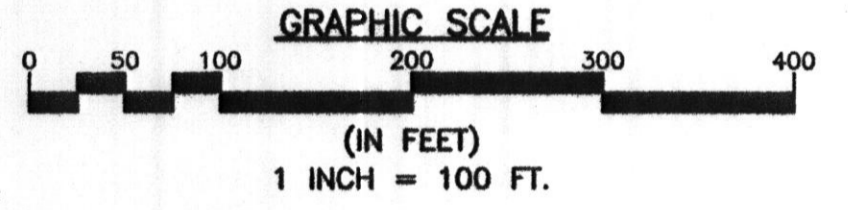

OWNER
FREDERICK W. RAULIN
15101 FREDERICK ROAD
WOODBINE, MARYLAND 21797

DEVELOPER/CONTRACT PURCHASER
HERITAGE LAND DEVELOPMENT
P.O. BOX 482
LISBON, MARYLAND 21765

CLARK · FINEFROCK & SACKETT, INC.
ENGINEERS · PLANNERS · SURVEYORS
7135 MINSTREL WAY · COLUMBIA, MD 21045 · (410) 381-7500 BALT. · (301) 621-8100 WASH.

| | | |
|---|---|----------------------|
| DESIGNED DAR | PERC CERTIFICATION PLAT LOTS 5 THRU 7 TAX MAP 8, GRID 21, PARCEL 59 | SCALE 1" = 100' |
| DRAWN ZAH | | DRAWING 1 of 1 |
| CHECKED DAR | VILLAGE OF THREE KEYS FOURTH (4th) ELECTION DISTRICT HOWARD COUNTY, MARYLAND | JOB NO. 07-040 |
| DATE 4-27-09 | | FILE NO. 07-040 0 |
| FOR : HERITAGE LAND DEVELOPMENT P.O. BOX 482 LISBON, MARYLAND 21765 | | |

PERC CERTIFICATION:
I certify that the information shown hereon are based on field work done under my direct supervision, and is correct, to the best of my professional knowledge and belief.

William Lee Machen 12 MAY 09
Surveyor Date



APPROVED: FOR PRIVATE WATER AND PRIVATE SEWERAGE SYSTEMS

Barbara P. Steilenson 6/23/2009
COUNTY HEALTH OFFICER DATE
HOWARD COUNTY HEALTH DEPARTMENT