

Spec. Sect. 6/14/69 9:30 - 1st

147
5
A 14567 42.9

APPLICATION

SEWAGE DISPOSAL TESTING

MARYLAND STATE DEPARTMENT OF HEALTH

HOWARD COUNTY

ELLICOTT CITY

DISTRICT 5

DATE 6/5/69

Sigbee Tank - 750 gal.

Dry Well - 429 sq ft absorbent side wall area to begin below the first 6 1/2 ft of more absorbent ground, 210 sq ft depth permitted for dry well is 15 ft below city street grade.

Place Dry Well about 50 ft from front lot line and 50 ft from left side line and even when facing lot from back of lot use entrance telephone pole line as front property line

TO: THE COUNTY HEALTH OFFICER
ELLICOTT CITY, MARYLAND

I, HEREBY, APPLY FOR THE NECESSARY TESTS IN ORDER TO CONSTRUCT (OR RECONSTRUCT) A SEWAGE DISPOSAL SYSTEM.

PROPERTY OWNER William Serveais

ADDRESS % Robert Johnson, Ashton Realty PHONE 924-4811

PROPERTY LOCATION:

SUBDIVISION Wood Ridge LOT NO. 1

ROAD AND DESCRIPTION Nichols Drive

OCCUPANT _____ PHONE _____

PERSON TO CONSTRUCT SYSTEM _____

ADDRESS _____ PHONE _____

SIZE OF LOT 52,196 sq. ft. TYPE BLDG. 3

NUMBER OF BEDROOMS
(Single Fmly. Dwllg.)

IF NOT SINGLE RESIDENCE DESCRIBE _____

SIGNATURE OF APPLICANT *Wm. Serveais by R. Johnson*

APPROVED BY *D.W. Mancig* FOR *Dry Well* DATE 6-10-69

REJECTED BY _____ FOR _____ DATE _____

HOLD PENDING FURTHER TESTS _____ DATE _____

REASONS FOR REJECTION OR HOLDING _____

THIS IS NOT A PERMIT

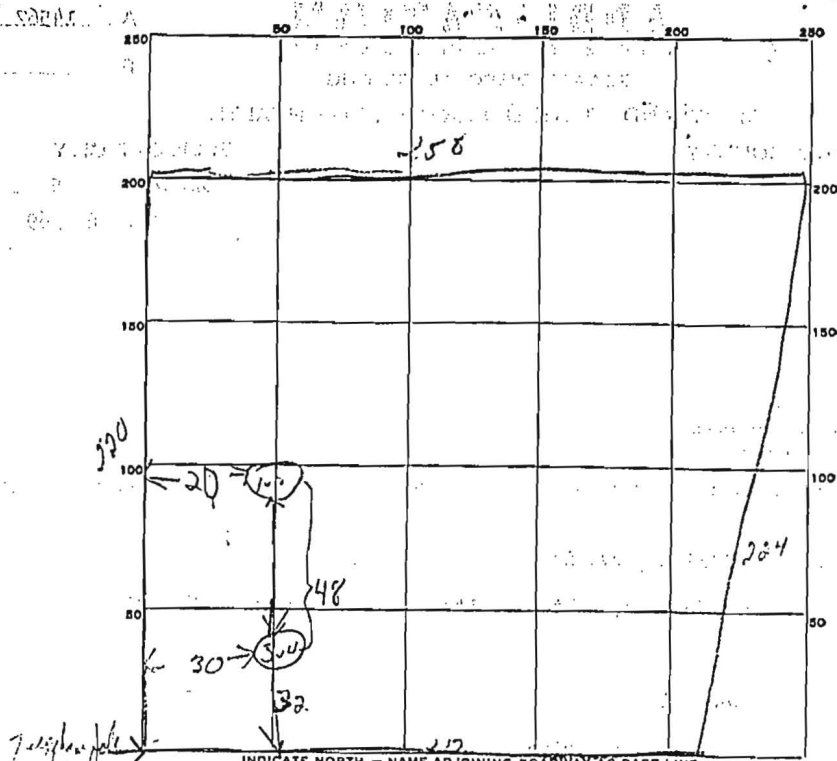

Telephone pole
Cable

INDICATE NORTH - NAME ADJOINING ROADWAY AS BASE LINE.

Michael's Lane

DATE	TEST NO.	DEPTH	PRE-WET		TEST - 1" DROP		TIME	
			START	STOP	START	STOP		
6-10-59	1	7 ft	9:45	9:55	9:55	10:22	27 min	
	2	15 ft	9:42	9:49	9:49	9:52	3 min	
	3	13 ft	10:01	10:03	10:03	10:08	5 min	
	4	1/2 in material - dry						
1/9/73		13 ft	Soil setting wet - No water uptake					
			30 min wait					

SOIL AUGER FINDING. low soil stick test

TESTED BY DJM

REMARKS _____