

APPLICATION

PERCOLATION TESTING

A _____

P _____

HOWARD COUNTY HEALTH DEPARTMENT
BUREAU OF ENVIRONMENTAL HEALTH
3525-H ELLICOTT MILLS DRIVE/ELLICOTT CITY, MARYLAND 21043
TELEPHONE: 313-2640

DISTRICT 5th

DATE _____

TO: THE COUNTY HEALTH OFFICER
ELLICOTT CITY, MARYLAND

I HEREBY APPLY FOR THE NECESSARY TEST PRIOR TO APPLICATION FOR PERMIT TO CONSTRUCT (OR RECONSTRUCT) A SEWAGE DISPOSAL SYSTEM.

PROPERTY OWNER H Y Real Estate Joint Venture, c/o Robert B. Canter, Esquire

ADDRESS 11921 Rockville Pike, Suite 300 PHONE (301) 230-5220
Rockville, MD. 20852-2737

AGENT OR PROSPECTIVE BUYER Mount View, LLC. Attention: Paul M. Revelle

ADDRESS 6258 Cardinal La, Columbia Md. 21044 PHONE (410) 992 5805

PROPERTY LOCATION:

SUBDIVISION Pindell Woods LOT NO. (21)

ROAD AND DESCRIPTION "B"

TAX MAP 41 PARCEL # 274 & 275

SIZE OF LOT 1-Acre Lot TYPE BLDG. Single Family Dwelling
(SINGLE FAMILY DWELLING OR COMMERCIAL)

THE SYSTEM INSTALLED UNDER THIS APPLICATION IS ACCEPTABLE ONLY UNTIL PUBLIC FACILITIES BECOME AVAILABLE. I FULLY UNDERSTAND THE FEE CONNECTED WITH THE FILING OF THIS PERC TEST APPLICATION IS NON-REFUNDABLE UNDER ANY CIRCUMSTANCES. I ALSO AGREE TO COMPLY WITH ALL M.O.S.H.A. REQUIREMENTS IN TESTING THIS LOT. _____
(SIGNATURE OF APPLICANT)

APPROVED BY _____ FOR _____ DATE _____

DISAPPROVED BY _____ FOR _____ DATE _____

HOLD PENDING FURTHER TESTS _____

REASONS FOR REJECTION OR HOLDING _____

PERCOLATION TEST PLAT/PRELIMINARY PLAT - TITLE OR I.D. # _____ DATE _____

SITE DEVELOPMENT PLAN/FINAL PLAT - TITLE OR I.D. # _____ DATE _____

THIS IS NOT A PERMIT

COUNTY #

SOIL PROFILE

0' 522
topsoil
1' red brn
cl. Lm
4' med
org red
brn
sa mica
Lm
12.5' 15-20%
sapr
sh

0' 605A/604A
1' topsoil
4.5' red brn
cl Lm
med
red/pk
brn
sa mica
Lm
12' 15%
sapr
sh

0' 656
1' topsoil
br
red/brn
cl Lm
4.5' dk pk
brn
woporr
belge
sa mica
Lm
15' 10-15%
sapr
sh

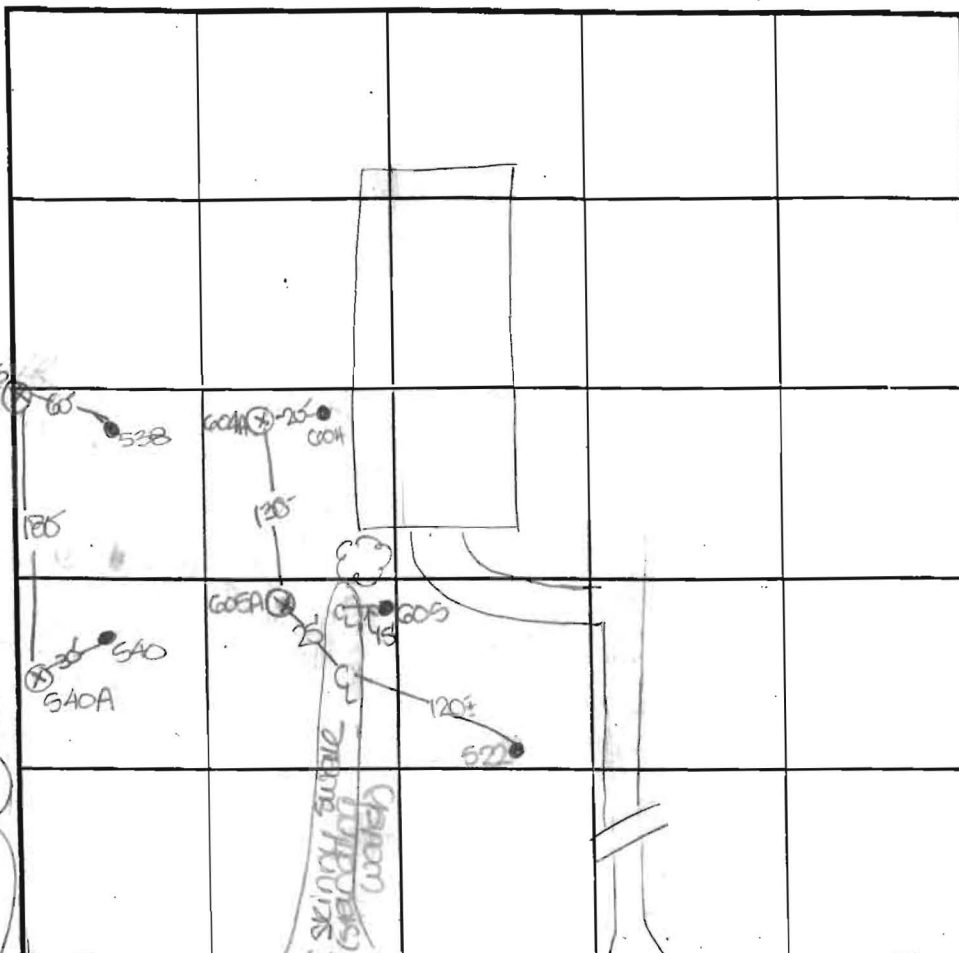

SOIL PROFILE

0' 540A
1' topsoil
4' org brn
cl Lm
4.5' dk
red/pk
brn
sa mica
Lm
12.5' 15%
sapr
sh

INDICATE NORTH - NAME ADJOINING ROADWAY AS BASELINE.

Pindell School Road

DATE	TEST NO.	DEPTH	PRE-WET		TEST - 1" DROP		TIME
			START	STOP	START	STOP	
7-11-00	522	4'8" S	10:07	10:08	10:08	10:12	4
		12.5' D	visual	- see	profile		OK
	605A	4'8" S	10:14	10:16	10:16	10:20	4
		12.0' D	visual	- see	profile		OK
	604A	4.0' S	10:23	10:37	10:37	10:57	20
		14.0' D	visual	- see	profile		OK
	656	4.0' S	10:34	slow	test	stopped	-
		15.0' D	visual	- see	profile		OK
	540A	12.5' D	visual	- see	profile		OK
	656	4'8" m	11:39	11:39	11:39	11:47	8

REMARKS: holes tested as staked except 605A/604A 540A
 TYPE OF SOIL: _____
 TESTED BY: DKS ALSO PRESENT: C. Zepp, R. Colson
 TRENCH DESIGN DATA: AVERAGE PERCOLATION TIME: _____ TRENCH WIDTH: _____
 INLET DEPTH: _____ MAXIMUM BOTTOM DEPTH: _____ SQ. FT./BEDROOM: _____

