

LAYOUT _____

INSP 1 _____ INSP 3 _____

INSP 2 _____ INSP 4 _____

ISSUE DATE: 9/12/06

P 525551

APPROVAL
DATE:

11/29/06

PERMIT
INDEXED
TAX ID # 03-347524

A _____

COMMUNITY SEPTIC SYSTEM
COMMUNITY CENTER SEWER LINE CONNECTION

HOWARD COUNTY HEALTH DEPARTMENT
BUREAU OF ENVIRONMENTAL HEALTH

Ryan Homes - Adam Bennett IS PERMITTED TO INSTALL ALTER

ADDRESS: 6085 Marshalee Drive PHONE NUMBER: 410-796-0980

SUBDIVISION Homeland Unit # 75

ADDRESS: 3040 Harbin Field PROPERTY OWNER: NVR, Inc. /a Ryan Homes
Lester M Zink

COMMUNITY BUILDING SERVED BY A COMMUNITY SEPTIC SYSTEM & PUBLIC WATER SUPPLY.

LOCATION:	Install 4" house sewer line connection per the approved site plan. Final acceptance of the sewer system will be subject to the approval of the Maryland Dept. of the Environment.
NOTES:	This permit is limited to the installation of the individual house sewer line connection.

PLANS APPROVED: Gabriel A. Creighton DATE: 8/11/06

PERMIT VOID AFTER 2 YEARS

1. CONTRACTOR IS RESPONSIBLE FOR SCHEDULING A PRE-CONSTRUCTION INSPECTION FOR ALL INSTALLATIONS.
2. ALL PARTS OF SEPTIC SYSTEM SHALL BE 100 FEET FROM ANY WATER WELL UNLESS SPECIFICALLY AUTHORIZED.
3. CONTRACTOR RESPONSIBLE FOR COMPLIANCE WITH APPLICABLE REGULATIONS, GUIDELINES AND THE TERMS OF THIS PERMIT.
4. NEITHER THE HOWARD COUNTY COUNCIL OR THE HEALTH DEPARTMENT IS RESPONSIBLE FOR THE SUCCESSFUL OPERATION OF ANY SYSTEM.
5. PERMITTEE RESPONSIBLE FOR OBTAINING FINAL APPROVAL ON THIS PERMIT.

CALL 410-313-1771 FOR INSPECTION OF SEPTIC CONNECTION

P5255501

NOT TO SCALE

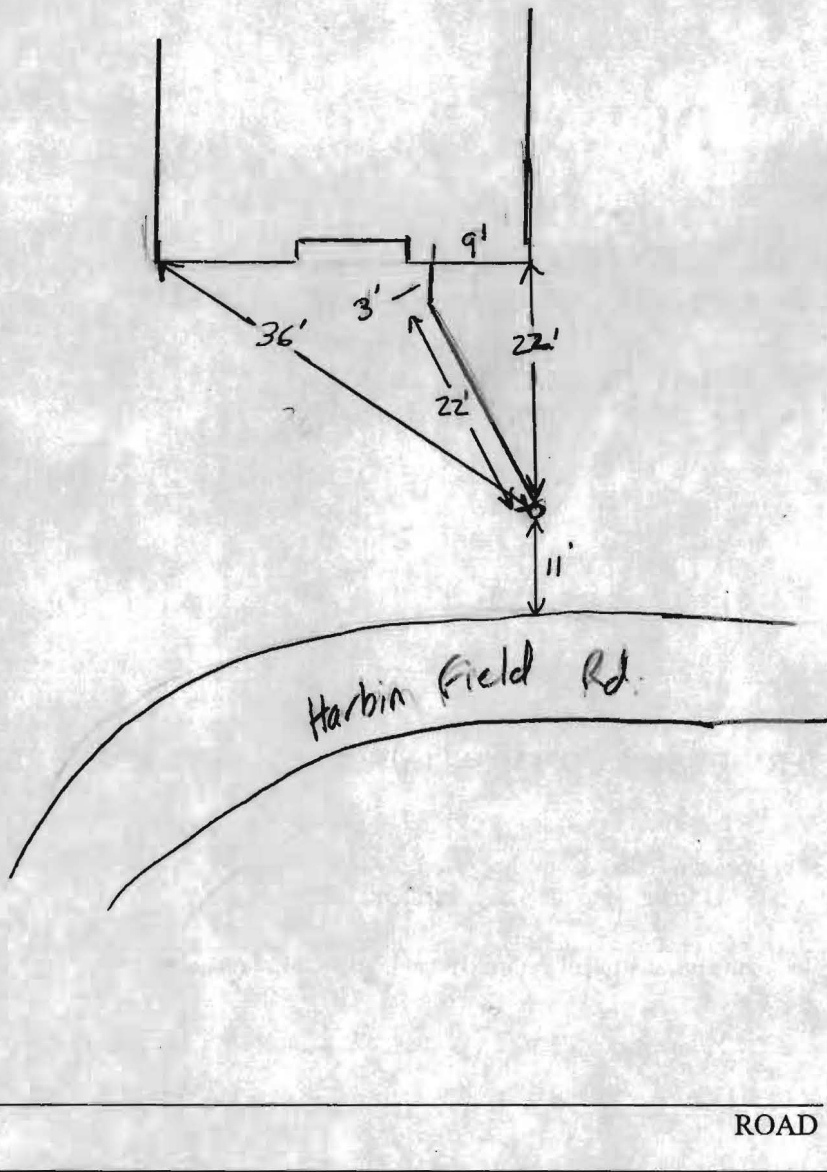

TRENCH/DRAINFIELD DATA

WIDTH	INLET	BOTTOM
_____	_____	_____
NUMBER OF TRENCHES _____		
TOTAL LENGTH _____		
ABSORPTION AREA _____		
DISTRIBUTION BOX LEVEL _____		
DISTRIBUTION BOX BAFFLE _____		
DISTRIBUTION BOX PORT _____		

SEPTIC TANK DATA

SEPTIC TANK 1 LEVEL _____

CAPACITY _____ GAL

SEAM LOC _____

TANK LID DEPTH _____

BAFFLES _____

BAFFLE FILTER _____

MANHOLE LOC _____

6" PORT LOC _____

WATERTIGHT TEST _____

SEPTIC TANK 2 LEVEL _____

CAPACITY _____ GAL

SEAM LOC _____

TANK LID DEPTH _____

BAFFLES _____

BAFFLE FILTER _____

MANHOLE LOC _____

6" PORT LOC _____

WATERTIGHT TEST _____

PRE-CONSTRUCTION _____

11/29/06

INSTALLATION System O.K. to Backfill (Mw)

FINAL INSPECTOR K. Wiley DATE OF APPROVAL 11/29/06

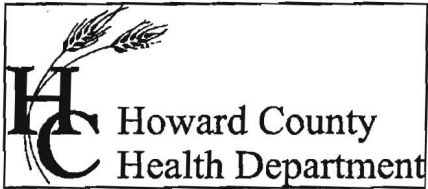

Bureau of Environmental Health
7178 Columbia Gateway Drive Columbia, Maryland 21046-2132
(410) 313-2640 Fax (410) 313-2648
TDD (410) 313-2323 Toll Free 1-866-313-6300
website: www.hchealth.org

Penny E. Borenstein, M.D., M.P.H., Health Officer

December 20, 2006

Ryan Homes
6085 Marshalee Drive, Suite 170
Elkridge, MD 21075

SENT VIA FACSIMILE TO 301-858-0433

RE: Homeland, Lot 75
3040 Harbin Field
Ellicott City, MD 21042
BP# B06002271
PUBLIC WATER

Dear Sir/Madam:

This is to advise you that the septic system for the above referenced property has been installed and inspected. **Final approval of the septic system was granted on 11/29/2006.**

The property is served by public water and is therefore exempt from the Health Department water sampling requirements.

By issuance of this letter, this office recommends release of the Use and Occupancy permit for the referenced property.

Approving Authority,

Stuart Oster, R. S.
Well & Septic Program

cc: Building Inspector's Office
File

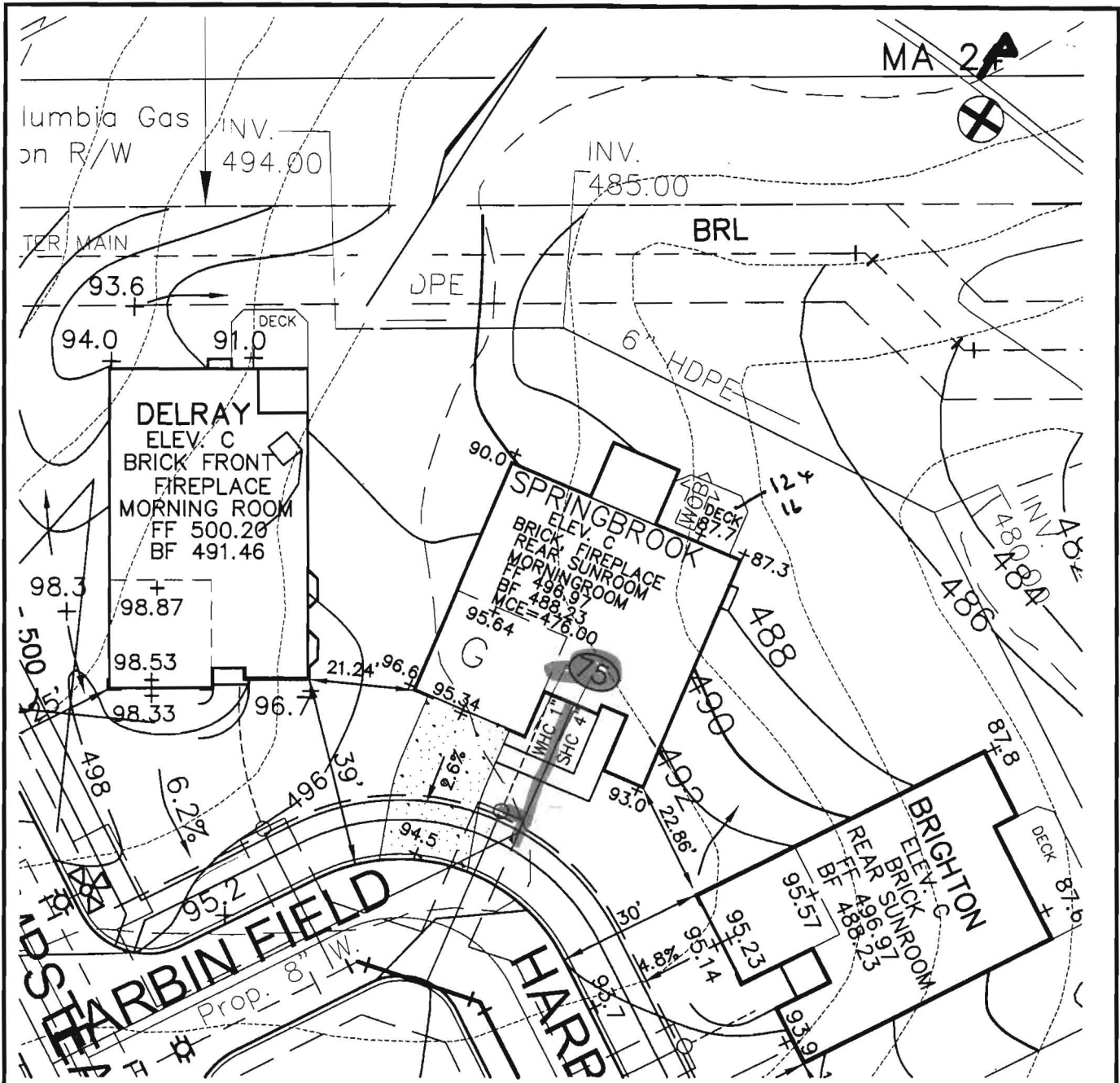

ROBERT H. VOGEL
ENGINEERING, INC.
 ENGINEERS • SURVEYORS • PLANNERS
 8407 MAIN STREET TEL: 410.461.7666
 ELLICOTT CITY, MD 21043 FAX: 410.461.8961

SCALE 1"=30'
 DRAWN BY MY
 CHECKED BY RHV
 DATE JULY 26, 2005
 W. O. # 04-87.00
 SHEET# 1 OF 1

RYAN HOMES
ELLICOTT MEADOWS
UNIT 75

REV. 1/05
 HOMELAND SDP-03-30
 TAX MAP 16
 3RD ELECTION DISTRICT

PARCEL 53,96,165&204
 HOWARD COUNTY, MARYLAND

Lot 75 Block _____

Community Ellicott Meadows
(HB)

BEDROOM RESTRICTION ACKNOWLEDGMENT
Hearthstone at Ellicott Meadows

The undersigned Purchaser has entered into a Purchase Agreement for the Property known as
HB 75 and located in the Ellicott Meadows Community (the "Property").

By signing below, Purchaser acknowledges they have been informed of and understand the following information relating to the Property:

The Hearthstone at Ellicott Meadows is served by a community private sewage disposal system which can only accommodate a maximum of two bedrooms per Unit. Howard County will enforce this restriction and will not issue any building permits for modifications to any Unit where the number of bedrooms will be increased beyond two.

ACKNOWLEDGED BY PURCHASER:

Purchaser:

Joseph E Rawlings

Purchaser:

Norma F Rawlings

Date:

7/17/06