

LAYOUT _____

INSP 1 8/25/05 INSP 3 _____

INSP 2 _____ INSP 4 _____

ISSUE DATE: 8/8/05

APPROVAL DATE: 8/25/05

PERMIT
INDEXED

P 523085

A _____

**COMMUNITY SEPTIC SYSTEM
HOUSE SEWER LINE CONNECTION**

**HOWARD COUNTY HEALTH DEPARTMENT
BUREAU OF ENVIRONMENTAL HEALTH**

NVR

IS PERMITTED TO INSTALL ALTER

ADDRESS: _____ PHONE NUMBER: _____

SUBDIVISION Homeland Unit # 87

ADDRESS: 11911 Hampstead Green PROPERTY OWNER: NVR Inc. t/a Ryan Homes

NUMBER OF BEDROOMS: 2

HOUSE SERVED BY PUBLIC WATER

LOCATION:	Install 4" house sewer line connection per the approved site plan. Final acceptance of the sewer system will be subject to the approval of the Maryland Dept. of the Environment.
NOTES:	This permit is limited to the installation of the individual house sewer line connection.

PLANS APPROVED: Kevin J. Bell DATE: 7/5/05

PERMIT VOID AFTER 2 YEARS

1. CONTRACTOR IS RESPONSIBLE FOR SCHEDULING A PRE-CONSTRUCTION INSPECTION FOR ALL INSTALLATIONS.
2. ALL PARTS OF SEPTIC SYSTEM SHALL BE 100 FEET FROM ANY WATER WELL UNLESS SPECIFICALLY AUTHORIZED.
3. CONTRACTOR RESPONSIBLE FOR COMPLIANCE WITH APPLICABLE REGULATIONS, GUIDELINES AND THE TERMS OF THIS PERMIT.
4. NEITHER THE HOWARD COUNTY COUNCIL OR THE HEALTH DEPARTMENT IS RESPONSIBLE FOR THE SUCCESSFUL OPERATION OF ANY SYSTEM.
5. PERMITTEE RESPONSIBLE FOR OBTAINING FINAL APPROVAL ON THIS PERMIT.

CALL 410-313-1771 FOR INSPECTION OF SEPTIC CONNECTION

P523085

NOT TO SCALE

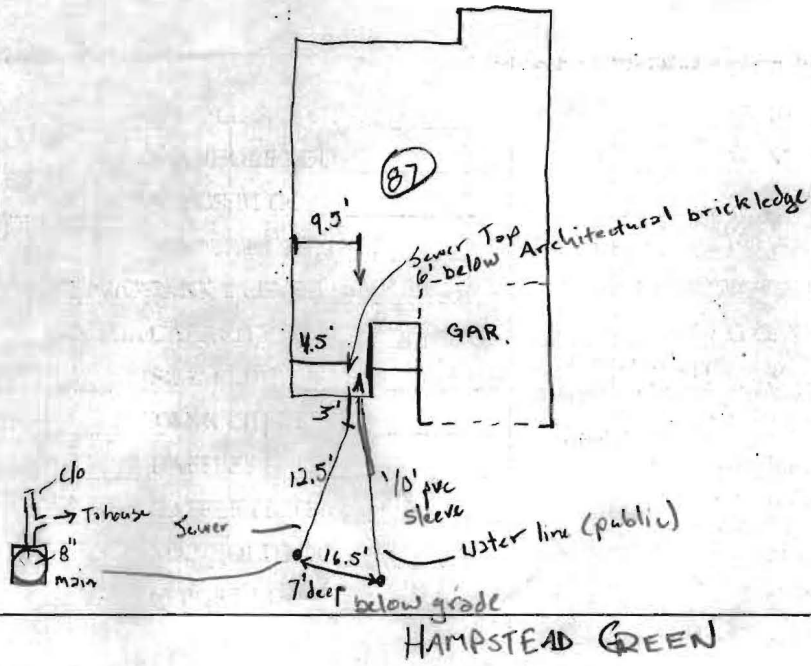

TRENCH/DRAINFIELD DATA		
WIDTH	INLET	BOTTOM
_____	_____	_____
NUMBER OF TRENCHES _____		
TOTAL LENGTH _____		
ABSORPTION AREA _____		
DISTRIBUTION BOX LEVEL _____		
DISTRIBUTION BOX BAFFLE _____		
DISTRIBUTION BOX PORT _____		

SEPTIC TANK DATA	
SEPTIC TANK 1 LEVEL	_____
CAPACITY	_____ GAL
SEAM LOC	_____
TANK LID DEPTH	_____
BAFFLES	_____
BAFFLE FILTER	_____
MANHOLE LOC	_____
6" PORT LOC	_____
WATERTIGHT TEST	_____
SEPTIC TANK 2 LEVEL	_____
CAPACITY	_____ GAL
SEAM LOC	_____
TANK LID DEPTH	_____
BAFFLES	_____
BAFFLE FILTER	_____
MANHOLE LOC	_____
6" PORT LOC	_____
WATERTIGHT TEST	_____

PRE-CONSTRUCTION House Connection to shared septic system.

INSTALLATION ^{8/25/05} Everything visually ok. OK to cover **GAC**

FINAL INSPECTOR D. Cuyler DATE OF APPROVAL 8/25/05

Utility Easement

HAMPSTEAD GREEN

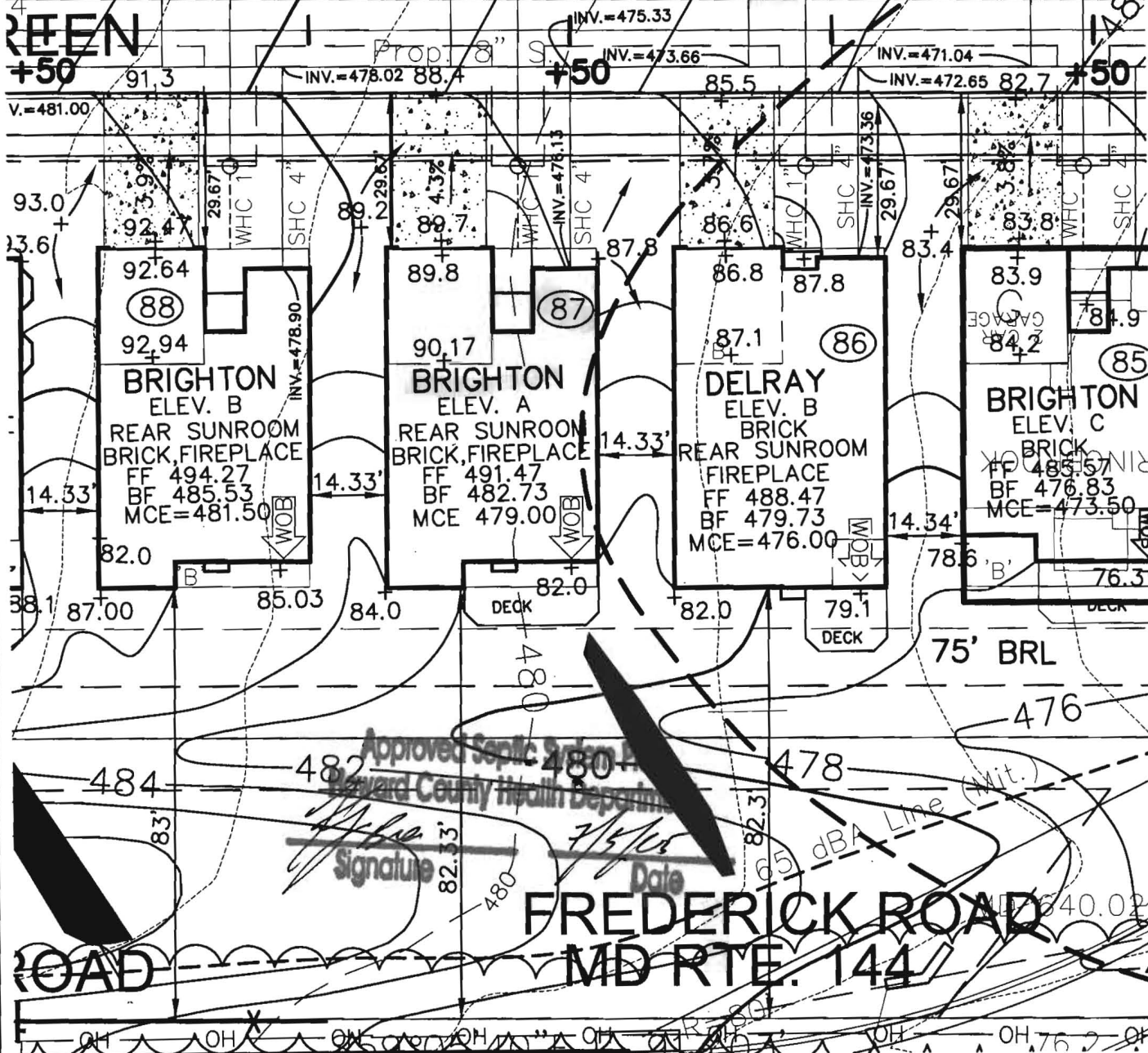

Approved Septic System
 Howard County Health Department
 Signature: *[Signature]*
 Date: 7/5/05

FREDERICK ROAD MD RTE. 144

VA ROBERT H. VOGEL ENGINEERING, INC.
 ENGINEERS • SURVEYORS • PLANNERS
 8407 MAIN STREET TEL: 410.461.7666
 ELLICOTT CITY, MD 21043 FAX: 410.461.8961

NOTE:
 ALL DIMENSION ARE FROM
 ARCHITECTURAL BRICK LEDGE.

SCALE 1"=30'
 DRAWN BY JCO
 CHECKED BY RHV
 DATE JUNE, 2005
 W. O. # 04-87.00
 SHEET# 1 OF 1

RYAN HOMES HOMELAND UNIT 87

SDP-03-30
 TAX MAP 16
 3RD ELECTION DISTRICT

PARCEL 53,96,165&204
 HOWARD COUNTY, MARYLAND

Methods.
 Operator's Operation and Maintenance Manuals

provide operations and maintenance

and at least 60 days prior to the date set for
 to the Owner five (5) Operation and
 and electrical systems and equipment
 include all installation, operation, start-up and
 and in the manuals shall consist of catalogs,
 files, parts, lists, assembly drawings, wiring
 and maintenance measures, approved working
 drawings for the Owner to establish an effective

and in 3-ring loose-leaf binders and indexed.
 above dimensions and placed in envelopes

Operator and/or Owner in understanding the
 operations of the equipment as well as to
 service. Technical and maintenance information
 and electrical components shall be included
 but not limited to, Operation Responsibilities,
 Design Criteria, Operational Modifications,
 Component Equipment O&M, System Equipment
 and As-Builts.

Approval of the facilities will not be undertaken until
 drawings have been submitted. Partial approvals.

NH ₃ -N	35	mg/L
Alkalinity (as CaCO ₃)	100	mg/L
pH	6.0 - 9.0	S.U.
Water Temperature Min.	15	°C
Water Temperature Max	28	°C
Air Temperature Min.	0	°F
Air Temperature Max	100	°F
Site Elevation	442	ft
Effluent Characteristics		
BOD ₅ (20°C)	30	mg/L
Total Suspended Solids	30	mg/L
NH ₃ -N	1.0	mg/L
Total Nitrogen (N)	10.0	mg/l
Influent Pumping		
Average design rate in	15.3	gpm
Peak rate in	61.2	gpm @ 4 x Avg.
Pump rate provided	70	gpm 1-pump (28'TDh)

SBR R

M
T

D

Dosing

PUBLIC WATER +
 PRIVATE SHARED SEPTIC
 SYSTEM

SDP-03-030

HOMELAND SENIOR CENTER
 147 UNITS TOTAL
 EACH UNIT CAN ONLY
 BE A TOTAL OF 2 BEDROOMS

Approved Septic System Plan MDE
~~Howard County Health Department~~

Approved Septic System Plan
 Howard County Health Department

[Signature] 9-2-03
 Signature Date

Steven Roger Krieg 9/2/03
 Signature Date

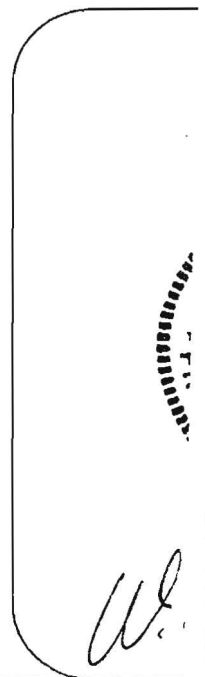



HOWARD COUNTY HEALTH DEPARTMENT

Bureau of Environmental Health
7178 Columbia Gateway Drive, Columbia MD 21046
(410) 313-2640 FAX (410) 313-2648
TDD (410) 313-2323 Toll Free 1-877-4MD-DHMH

Penny E. Borenstein, M.D., M.P.H., County Health Officer

August 29, 2005

NVR Inc. t/a Ryan Homes
6085 Marshalee Drive, Suite 140
Elkridge, Maryland 21075

SENT VIA FACSIMILE 410-796-7094

RE: Homeland, Lot 87
11911 Hampstead Green
Ellicott City, MD 21043
BP # B00154668
PUBLIC WATER

Dear Sirs or Madam:

This is to advise that the connection from the house to the street has been installed and inspected for the referenced property. A Community Septic System serves this dwelling. **Final approval was granted on 08/25/2005 by HCHD for the house connection.**

The property is served by public water and is therefore exempt from the Health Department water sampling requirements.

By issuance of this letter, this office recommends release of the Use and Occupancy permit for the referenced property.

RECOMMENDATION FOR USE AND OCCUPANCY

Respectfully,

Stuart F. Oster, R. S.
Well and Septic Program

cc: DILP, Building Inspectors Office
File



HOWARD COUNTY HEALTH DEPARTMENT

Bureau of Environmental Health
7178 Columbia Gateway Drive, Columbia MD 21046
(410) 313-2640 FAX (410) 313-2648
TDD (410) 313-2323 Toll Free 1-877-4MD-DHMH

Penny E. Borenstein, M.D., M.P.H., County Health Officer

8/29/2005

NVR Inc. t/a Ryan Homes
6085 Marshalee Drive, Suite 140
Elkridge, MD 21075

SENT VIA FACSIMILE 410-796-7094

RE: Homeland, Lot 187
11911 Hampstead Green
Marriottsville, MD 211041
BP # B00154688
PUBLIC WATER

Dear Sirs or Madam:

This is to advise that the connection from the house to the street has been installed and inspected for the referenced property. A Community Septic System serves this dwelling. **Final approval was granted on 8/25/2005 by HCHD for the house connection.** Be advised that the Health Department did not receive the building permit for review until after the permit was released by the DILP because the permit was marked incorrectly for public water and sewer by the applicant.

The property is served by public water and is therefore exempt from the Health Department water sampling requirements.

By issuance of this letter, this office recommends release of the Use and Occupancy permit for the referenced property.

RECOMMENDATION FOR USE AND OCCUPANCY

Respectfully,

Stuart F. Oster, R.S.
Well and Septic Program

cc: DILP, Building Inspectors Office
File

Resent to DILP - 11/28/05 (SC)