

LAYOUT 2/24/06 INSP 4 \_\_\_\_\_  
 INSP 2 3/8/06 INSP 5 \_\_\_\_\_  
 INSP 3 \_\_\_\_\_ INSP 6 \_\_\_\_\_

ISSUE DATE: 2/14/2006

P 524085

APPROVAL DATE: 3/9/06

A 522946

**PERMIT**  
 INDEXED  
 TAX ID #05-384710  
**ON-SITE SEWAGE DISPOSAL SYSTEM**  
**HOWARD COUNTY HEALTH DEPARTMENT**  
**BUREAU OF ENVIRONMENTAL HEALTH**

Fyock Septic Service IS PERMITTED TO INSTALL  ALTER

ADDRESS: PO Box 89, Glenelg, MD 21737 PHONE NUMBER: 410-988-9270

SUBDIVISION: Allnutt Farms Estates LOT NUMBER: 14

ADDRESS: 13492 Open Space Court PROPERTY OWNER: Steve Allnutt

SEPTIC TANK CAPACITY (GALLONS): 1500 OUTLET BAFFLE FILTER REQUIRED

PUMP CHAMBER CAPACITY (GALLONS): n/a COMPARTMENTED TANK REQUIRED

NUMBER OF BEDROOMS: 5

*Inlet 2.5'*  
*Bottom 7.5'*  
*5' Stone Below Pipe*  
*Trenches 2' Wide*

SQUARE FEET PER BEDROOM: 180

LINEAR FEET OF TRENCH REQUIRED: 154 HOUSE SERVED BY PUBLIC WATER

TRENCHES:	Trench to be <sup>2.0'</sup> <del>3.0</del> feet wide. Inlet 3.0 feet below original grade. Bottom maximum depth 7.0 feet below original grade. Effective area begins at 3.0 feet below original grade. 4.0 feet of stone below distribution pipe.
LOCATION:	Place the distribution box at the highest elevation in the approved SDA.
NOTES:	

PLANS APPROVED: Kevin J. Bell Reviewed by: \_\_\_\_\_ DATE: 9/29/05

NOTES: PERMIT VOID AFTER 2 YEARS  
 CONTRACTOR IS RESPONSIBLE FOR SCHEDULING A PRE-CONSTRUCTION INSPECTION FOR ALL INSTALLATIONS  
 WATERTIGHT SEPTIC TANKS REQUIRED  
 ALL PARTS OF SEPTIC SYSTEM SHALL BE 100 FEET FROM ANY WATER WELL UNLESS SPECIFICALLY AUTHORIZED  
 MANHOLE RISERS REQUIRED ON ALL SEPTIC TANKS AND PUMP CHAMBERS UNLESS SPECIFICALLY AUTHORIZED  
 CONTRACTOR RESPONSIBLE FOR COMPLIANCE WITH APPLICABLE REGULATIONS, GUIDELINES AND THE TERMS OF THIS PERMIT

**NEITHER THE HOWARD COUNTY COUNCIL NOR THE HEALTH DEPARTMENT IS RESPONSIBLE FOR THE SUCCESSFUL OPERATION OF ANY SYSTEM PERMITTEE RESPONSIBLE FOR OBTAINING FINAL APPROVAL ON THIS PERMIT ALL 410-313-1771 FOR INSPECTION OF SEPTIC SYSTEM**

A522946

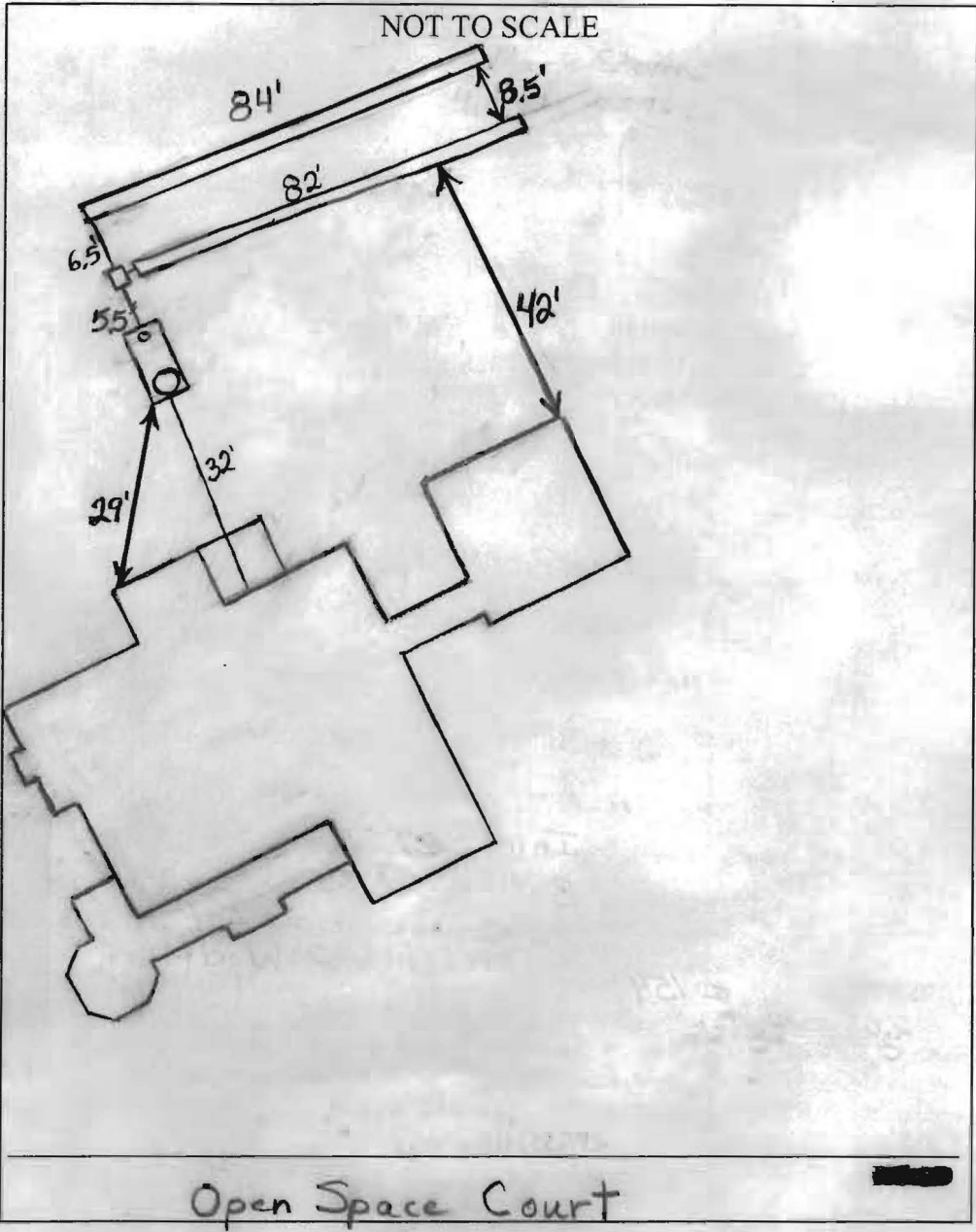

TRENCH/DRAINFIELD DATA		
WIDTH	INLET	BOTTOM
2	2.5'	7.5'
NUMBER OF TRENCHES		2
TOTAL LENGTH		166'
ABSORPTION AREA		830
DISTRIBUTION BOX LEVEL		Levelers
DISTRIBUTION BOX BAFFLE		Yes
DISTRIBUTION BOX PORT		No

SEPTIC TANK DATA	
SEPTIC TANK 1 LEVEL	Yes
CAPACITY	1500 GAL
SEAM LOC	Top
TANK LID DEPTH	1.5'-3'
BAFFLES	Yes
BAFFLE FILTER	No
MANHOLE LOC	Front
6" PORT LOC	Rear
WATERTIGHT TEST	No
SEPTIC TANK 2 LEVEL	N/A
CAPACITY	_____ GAL
SEAM LOC	_____
TANK LID DEPTH	_____
BAFFLES	_____
BAFFLE FILTER	_____
MANHOLE LOC	_____
6" PORT LOC	_____
WATERTIGHT TEST	_____

PRE-CONSTRUCTION \_\_\_\_\_

2/24/06 Fill on top of easement. Remove and call for another

INSTALLATION layout. Install 2 - 77' trenches across top of

easement. See changed trench specs. (BB) 3/8/06 Tank set

House connection made (BB) 3/9/06 Everything finished. O.K.

to backfill. (BB)

FINAL INSPECTOR B. Baker DATE OF APPROVAL 3/9/06