

# APPLICATION

PERCOLATION TESTING

A 513138

*scheduled for Dec 19 @ 1230*

P \_\_\_\_\_

HOWARD COUNTY HEALTH DEPARTMENT  
BUREAU OF ENVIRONMENTAL HEALTH  
3525-H ELLICOTT MILLS DRIVE/ELLICOTT CITY, MARYLAND 21043  
TELEPHONE: 313-2640

DISTRICT \_\_\_\_\_

*Existing lot of record  
Never previously test.  
undeveloped as yet*

DATE 11/19/99

TO: THE COUNTY HEALTH OFFICER  
ELLICOTT CITY, MARYLAND

I HEREBY APPLY FOR THE NECESSARY TEST PRIOR TO APPLICATION FOR PERMIT TO CONSTRUCT (OR RECONSTRUCT) A SEWAGE DISPOSAL SYSTEM.

PROPERTY OWNER FRANCIS D. LIGHT TRUST

ADDRESS 9209 FRIARS RD BETHESDA MD 20817 PHONE 301-564-0098

AGENT OR PROSPECTIVE BUYER FRANCIS LIGHT 301-564-0098

ADDRESS JEFF BRIDGEMAN - 301-953-1303 PHONE \_\_\_\_\_

PROPERTY LOCATION:

SUBDIVISION \_\_\_\_\_ LOT NO. PARCEL #69

ROAD AND DESCRIPTION GAITHER ROAD PARCEL #69

TAX MAP 004 PARCEL # 69

SIZE OF LOT 5.171 ACRES TYPE BLDG. SINGLE FAMILY  
(SINGLE FAMILY DWELLING OR COMMERCIAL)

THE SYSTEM INSTALLED UNDER THIS APPLICATION IS ACCEPTABLE ONLY UNTIL PUBLIC FACILITIES BECOME AVAILABLE. I FULLY UNDERSTAND THE FEE CONNECTED WITH THE FILING OF THIS PERC TEST APPLICATION IS NON-REFUNDABLE UNDER ANY CIRCUMSTANCES. I ALSO AGREE TO COMPLY WITH ALL M.O.S.H.A. REQUIREMENTS IN TESTING THIS LOT.

*Francis D. Light*  
(SIGNATURE OF APPLICANT)

APPROVED BY \_\_\_\_\_ FOR \_\_\_\_\_ DATE \_\_\_\_\_

DISAPPROVED BY \_\_\_\_\_ FOR \_\_\_\_\_ DATE \_\_\_\_\_

HOLD PENDING FURTHER TESTS \_\_\_\_\_

REASONS FOR REJECTION OR HOLDING \_\_\_\_\_

PERCOLATION TEST PLAT/PRELIMINARY PLAT - TITLE OR I.D. # \_\_\_\_\_ DATE \_\_\_\_\_

SITE DEVELOPMENT PLAN/FINAL PLAT - TITLE OR I.D. # \_\_\_\_\_ DATE \_\_\_\_\_

# THIS IS NOT A PERMIT

~~CONFIDENTIAL~~  
~~67~~  
~~CONFIDENTIAL~~

Infl 1A (depth 21"-27")

Start 12:25:52 @ 7"  
12:45:50 @ 6 7/8"  
Infl 1:12:20 @ 6 11/16"

pulled @ 1:31 going too slow  
Screws Tangled - May  
Not be responsible  
but No Time today for more testing

Infl 3B

1:31:30 @ 7"  
1:46:50 @ 6 7/8"  
2:01:50 @ 5 3/4"

15 mpi

Infl 5A (depth 19-24")

12:58:35 @ 7"  
1:03:00 @ 5 3/4"  
1:10:45 @ 4 1/2"  
1:18:20 @ 2 7/8" } ~ 4 mpi

Infl 2 (16-22")

1:55:10 @ 7"  
1:56:45 @ 6"  
1:59:15 @ 4 3/4"  
2:09:30 dry OK  
(probably disturbed looking sandy soil)

I discussed other file & history  
to Kallor Bridgman - they  
still wish to proceed to testing

12/10/99

# APPLICATION

PERCOLATION TESTING

A 5/3/38

P \_\_\_\_\_

HOWARD COUNTY HEALTH DEPARTMENT  
BUREAU OF ENVIRONMENTAL HEALTH  
3525-H ELLICOTT MILLS DRIVE/ELLICOTT CITY, MARYLAND 21043  
TELEPHONE: 313-2640

DISTRICT \_\_\_\_\_

DATE \_\_\_\_\_

*Existing lot of record  
Never previously test.  
undeveloped as yet*

TO: THE COUNTY HEALTH OFFICER  
ELLICOTT CITY, MARYLAND

I HEREBY APPLY FOR THE NECESSARY TEST PRIOR TO APPLICATION FOR PERMIT TO CONSTRUCT (OR RECONSTRUCT) A SEWAGE DISPOSAL SYSTEM.

PROPERTY OWNER FRANCIS D. LIGHT TRUST

ADDRESS 9209 FRIARS RD BETHESDA MD <sup>20817</sup> 301-564-0098

AGENT OR PROSPECTIVE BUYER FRANCIS LIGHT 301-564-0098

ADDRESS JEFF BRIDGEMAN - 301-953-1303

PROPERTY LOCATION:

SUBDIVISION \_\_\_\_\_ LOT NO. PARCEL #69

ROAD AND DESCRIPTION GAITHER ROAD PARCEL #69

TAX MAP 004 PARCEL # 69

SIZE OF LOT 5.171 ACRES TYPE BLDG. SINGLE FAMILY  
(SINGLE FAMILY DWELLING OR COMMERCIAL)

THE SYSTEM INSTALLED UNDER THIS APPLICATION IS ACCEPTABLE ONLY UNTIL PUBLIC FACILITIES BECOME AVAILABLE. I FULLY UNDERSTAND THE FEE CONNECTED WITH THE FILING OF THIS PERC TEST APPLICATION IS NON-REFUNDABLE UNDER ANY CIRCUMSTANCES. I ALSO AGREE TO COMPLY WITH ALL M.O.S.H.A. REQUIREMENTS IN TESTING THIS LOT.

Francis D. Light  
(SIGNATURE OF APPLICANT)

APPROVED BY \_\_\_\_\_ FOR \_\_\_\_\_ DATE \_\_\_\_\_

DISAPPROVED BY \_\_\_\_\_ FOR \_\_\_\_\_ DATE \_\_\_\_\_

HOLD PENDING FURTHER TESTS \_\_\_\_\_

REASONS FOR REJECTION OR HOLDING \_\_\_\_\_

PERCOLATION TEST PLAT/PRELIMINARY PLAT - TITLE OR I.D. # \_\_\_\_\_ DATE \_\_\_\_\_

SITE DEVELOPMENT PLAN/FINAL PLAT - TITLE OR I.D. # \_\_\_\_\_ DATE \_\_\_\_\_

# THIS IS NOT A PERMIT

COUNTY #

SOIL PROFILE

0' 1  
 16' clayey brown loam  
 yel loam - loam  
 PSL @ 8' 50' 2'  
 25' Red - yel loam (2nd 1/2)  
 30' HL - CL (V. Med)  
 - SIL @ 8' 1/2'  
 44' Ten + pale y/whit  
 sandy silty  
 L-SL  
 (5% stones @ 5')

8, 5, 4, 2  
 6' 10" dark brown loam  
 yel loam  
 SL-L  
 19-23" Red gritty  
 HL-CL  
 Stony gran  
 heavy @ 24"  
 50% @ 3 1/2'  
 Refusal @ 4 1/2'  
 Stony ss  
 slightly weathered  
 granitic schist

3B, 3A  
 18' clayey brown SL  
 19' yel loam SL  
 22' Mix SL  
 22-24' Stony Red  
 SL @ 22-30"  
 4 1/2' Refusal @ 4 1/2'

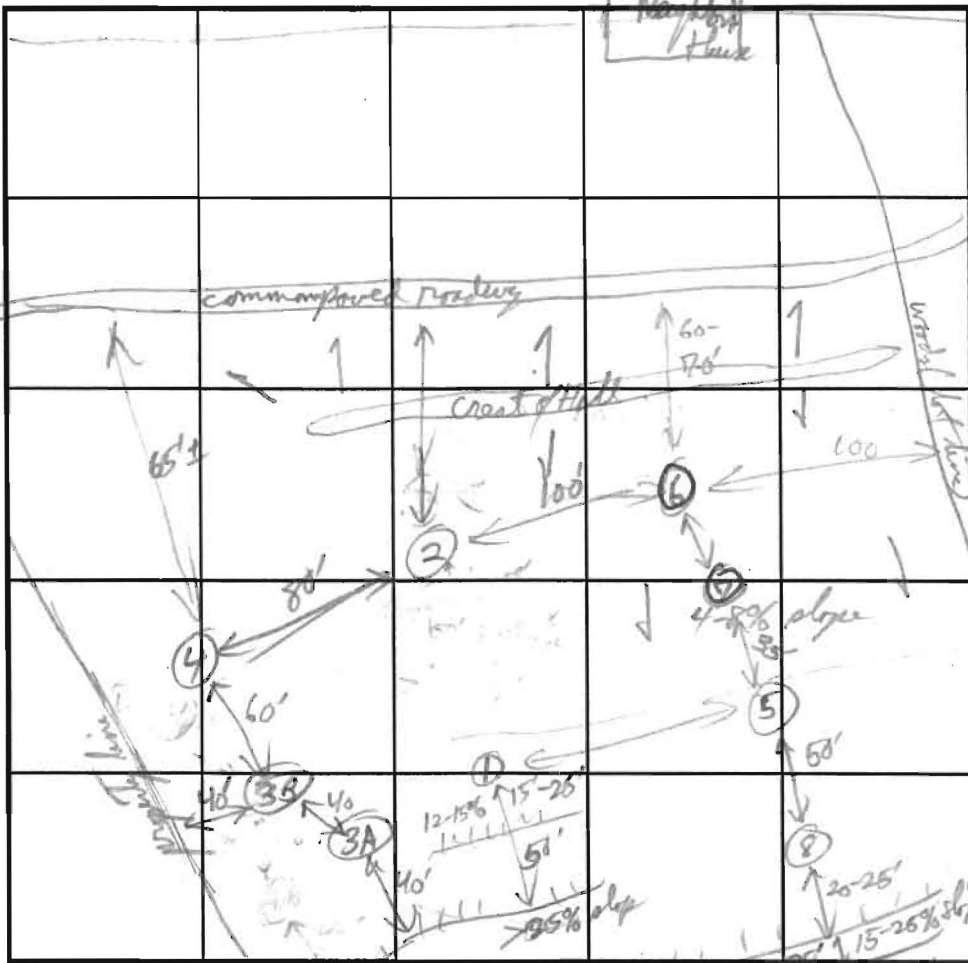

INDICATE NORTH - NAME ADJOINING ROADWAY AS BASE LINE.

SOIL PROFILE

0'

Neighborhood House

DATE	TEST NO.	DEPTH	PRE-WET		TEST - 1" DROP		TIME	
			START	STOP	START	STOP		
12/15/99	1	19"	11:46:30	11:48:10	11:48:10	11:53:35	5 1/2 min	
	1	28" 33"	12:09:46	12:16:50	12:15:50	12:45:20	30 min	
	2	19"	12:04:00	12:07:25	12:07:25	12:14:16	7 min	
	5	4 1/2' 19"	12:50:15	Pass @ 10 1/2' 11:00		1:04:10	7 min	
	6	Refusal @ 3'	Too Rocky	stone & rocks > 50%	Boys @ 1-1 1/2 ft		Fail	
	7	Refusal @ 3'	Too Rocky	> 50% stone @ 1-1 1/2 ft			Fail	
	8	4 1/2' refusal		> 50% @ 2 1/2 ft	Visual		Pass	
	3A	not tested						
	3B	4' refusal		stone @ 3'				
	4	4 1/2' 19"	1:41:18	1:45:22	1:45:22	1:52:20	7 min	
			water in Stony Br & Van of Boygen 3 1/2 hrs					

REMARKS: testing on Crest of Hill (very rocky lot) slopes 48% + 5-12% (than > 25% drop off hill)

TYPE OF SOIL: dark Menas loam, very stony

TESTED BY: R. P. Ruddy ALSO PRESENT \_\_\_\_\_

TRENCH DESIGN DATA: AVERAGE PERCOLATION TIME \_\_\_\_\_ TRENCH WIDTH \_\_\_\_\_

INLET DEPTH \_\_\_\_\_ MAXIMUM BOTTOM DEPTH \_\_\_\_\_ SQ. FT./BEDROOM \_\_\_\_\_

# APPLICATION

## PERCOLATION TESTING

A \_\_\_\_\_

P \_\_\_\_\_

DISTRICT Third

DATE 6/30/99

HOWARD COUNTY HEALTH DEPARTMENT  
BUREAU OF ENVIRONMENTAL HEALTH  
3525-H ELLICOTT MILLS DRIVE/ELLICOTT CITY, MARYLAND 21043  
TELEPHONE: 313-2640

TO: THE COUNTY HEALTH OFFICER  
ELLICOTT CITY, MARYLAND

*PREVIEW OK -  
PREVIEW HISTORY OF FAILURE  
BUT UPGR PARTITION NOT  
THOROUGHLY EXPLOR'G.  
QUESTIONS OF SLOPE  
& SEPARATION FROM  
NEIGHBORING  
WELLS & SEPTICS  
TO BE ADDRESSED.  
(CW)*

I HEREBY APPLY FOR THE NECESSARY TEST PRIOR TO APPLICATION FOR PERMIT TO CONSTRUCT (OR RECONSTRUCT) A SEWAGE DISPOSAL SYSTEM.

PROPERTY OWNER Daniel Ricker Dennis Light

ADDRESS Parcel 69 Gaither Rd. PHONE 410 465-8300

AGENT OR PROSPECTIVE BUYER Daniel Ricker

ADDRESS 13898 Forsythe Rd PHONE 443-463-4777

PROPERTY LOCATION: Sykesville Md 21284

SUBDIVISION Dennis Light LOT NO. 1

ROAD AND DESCRIPTION Gaither Rd. Near Pat. River

TAX MAP \_\_\_\_\_ PARCEL # 69

SIZE OF LOT 5.171 Acres TYPE BLDG. Single Fam.  
(SINGLE FAMILY DWELLING OR COMMERCIAL)

THE SYSTEM INSTALLED UNDER THIS APPLICATION IS ACCEPTABLE ONLY UNTIL PUBLIC FACILITIES BECOME AVAILABLE. I FULLY UNDERSTAND THE FEE CONNECTED WITH THE FILING OF THIS PERC TEST APPLICATION IS NON-REFUNDABLE UNDER ANY CIRCUMSTANCES. I ALSO AGREE TO COMPLY WITH ALL M.O.S.H.A. REQUIREMENTS IN TESTING THIS LOT. \_\_\_\_\_  
(SIGNATURE OF APPLICANT)

APPROVED BY \_\_\_\_\_ FOR \_\_\_\_\_ DATE \_\_\_\_\_

DISAPPROVED BY \_\_\_\_\_ FOR \_\_\_\_\_ DATE \_\_\_\_\_

HOLD PENDING FURTHER TESTS \_\_\_\_\_

REASONS FOR REJECTION OR HOLDING \_\_\_\_\_

PERCOLATION TEST PLAT/PRELIMINARY PLAT - TITLE OR I.D. # \_\_\_\_\_ DATE \_\_\_\_\_

SITE DEVELOPMENT PLAN/FINAL PLAT - TITLE OR I.D. # \_\_\_\_\_ DATE \_\_\_\_\_

# THIS IS NOT A PERMIT

*7/28/99.  
10:00  
SAND MOUNDS DATE  
IF NEEDED  
7/28/99*

