

PUB. SEWER STATUS VERIFIED BY _____

ISSUE DATE: 6/20/2005

APPROVAL DATE: _____

PERMIT
INDEXED
03-324958

522542
P 518028-B
A 518028-B

ON-SITE SEWAGE DISPOSAL SYSTEM
HOWARD COUNTY HEALTH DEPARTMENT
BUREAU OF ENVIRONMENTAL HEALTH

Fogles Septic Clean, Inc. IS PERMITTED TO INSTALL ALTER

ADDRESS: 580 Obrecht Rd., Sykesville 21784 PHONE NUMBER: 410-795-5670

SUBDIVISION: Buell/Greenfield LOT NUMBER: _____

ADDRESS: 11793 Frederick Road PROPERTY OWNER: Greenfield Homes

SEPTIC TANK CAPACITY (GALLONS): _____

PUMP CHAMBER CAPACITY (GALLONS): _____

NUMBER OF BEDROOMS: _____

SQUARE FEET PER BEDROOM: _____

LINEAR FEET OF TRENCH REQUIRED: _____

TRENCHES:	Trench to be _____ feet wide. Inlet _____ feet below original grade. Bottom maximum depth _____ feet below original grade. Effective area begins at _____ feet below original grade. _____ feet of stone below distribution pipe.
LOCATION:	
PURPOSE:	Inspection of connection from Pool House to septic system.

PLANS APPROVED: Kacie Noonan DATE: 6/20/05

- NOTE: PERMIT VOID AFTER 2 YEARS
- NOTE: CONTRACTOR RESPONSIBLE FOR SCHEDULING A PRE-CONSTRUCTION INSPECTION FOR ALL INSTALLATIONS
- NOTE: WATERTIGHT SEPTIC TANKS REQUIRED
- NOTE: ALL PARTS OF SEPTIC SYSTEM SHALL BE 100 FEET FROM ANY WATER WELL
- NOTE: MANHOLE RISERS REQUIRED ON ALL SEPTIC TANKS AND PUMP CHAMBERS

NEITHER THE HOWARD COUNTY COUNCIL OR THE HEALTH DEPARTMENT IS RESPONSIBLE FOR THE SUCCESSFUL OPERATION OF ANY SYSTEM PERMITTEE RESPONSIBLE FOR OBTAINING FINAL APPROVAL ON THIS PERMIT CALL 410-313-2640 FOR INSPECTION OF SEPTIC SYSTEM

0522542

NOT TO SCALE

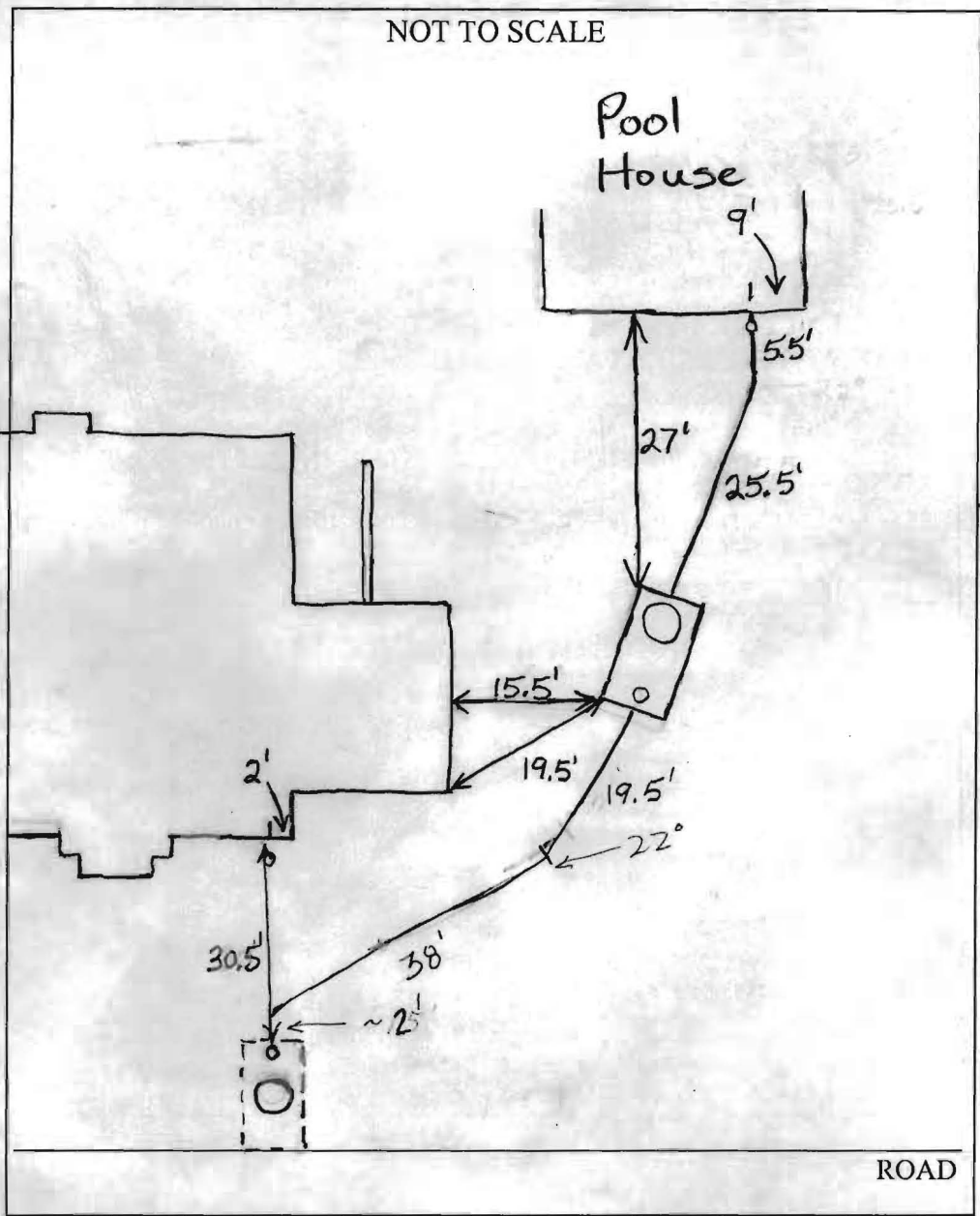

TRENCH/DRAINFIELD DATA		
WIDTH	INLET	BOTTOM
_____	_____	_____
NUMBER OF TRENCHES _____		
TOTAL LENGTH _____		
ABSORPTION AREA _____		
DISTRIBUTION BOX LEVEL _____		
DISTRIBUTION BOX BAFFLE _____		
DISTRIBUTION BOX PORT _____		

SEPTIC TANK DATA	
SEPTIC TANK 1 LEVEL	<u>Yes</u>
CAPACITY	<u>1500</u> GAL
SEAM LOC	<u>Top</u>
TANK LID DEPTH	<u>Near Grade</u>
BAFFLES	<u>Yes</u>
BAFFLE FILTER	<u>No</u>
MANHOLE LOC	<u>Front</u>
6" PORT LOC	<u>Rear</u>
WATERTIGHT TEST	<u>No</u>
SEPTIC TANK 2 LEVEL _____	
CAPACITY	_____ GAL
SEAM LOC	_____
TANK LID DEPTH	_____
BAFFLES	_____
BAFFLE FILTER	_____
MANHOLE LOC	_____
6" PORT LOC	_____
WATERTIGHT TEST	_____

Babylon
2-Comp

PRE-CONSTRUCTION _____

INSTALLATION 6/21/05 Septic tank set and house connection made. Need rear baffle and line to existing tank. O.K to cover current work. (BB) 6/22/05 Line between tanks finished tank for pool house y into existing septic tank 2' before tank. Ok to cover all work. (GL)

FINAL INSPECTOR D. Lewis

DATE OF APPROVAL 6/22/05