

APPLICATION

HOWARD COUNTY

SERIAL NUMBER

# PERMIT APPLICATION

DEPARTMENT OF INSPECTIONS, LICENSES & PERMIT

3430 COURT HOUSE DRIVE, ELLICOTT CITY, MARYLAND 21043

45801

BUILDING ADDRESS (HOUSE NO., STREET, TOWN OR AREA)

5489 HARRIS FARM LANE  
CLARKSVILLE, MD 21029

GRADING/SEDIMENT CONTROL  YES  NO

DESCRIPTION OF WORK AUTHORIZED

BUILDING AND FINISHING  
FAMILY USED  
WITH FULL BATH  
DOOR CASES  
FR 2 1/2 BATHS - ORIGINAL ROUGH IN BATH

LOT NO.	PARCEL NO.	SEC.	AREA	BLOCK NO.	LIBER	FOLIO
872				20	712	1154

SUB DIVISION	ZONE	ZONE MAP	ELEC. DIST.	CENSUS TR.
	RK	28	5	

OWNER NAME AND ADDRESS  
JACK PAUN SWEET  
5489 HARRIS FARM LANE  
CLARKSVILLE, MD 21029

PHONE NO.  
(301) 434-8873

OCCUPANT'S NAME AND ADDRESS  
SAME

PHONE NO.

ARCHITECT OR ENGINEER'S NAME AND ADDRESS  
NONE

PHONE NO.

CONTRACTOR'S NAME AND ADDRESS  
JEFF BOWEN  
316 CARROLL AVE  
BETHESDA, MD 20814

PHONE NO.  
(301) 433-2216

EXISTING USE  
VACANT LOT

PROPOSED USE  
SINGLE FAMILY DWELLING

EST. CONSTRUCTION COST  
\$110,000

LICENSE NUMBER

PERMIT FEE

SIZE OF BLDG	FRONT	DEPTH	HEIGHT
TYPE OF BLDG	AREA	VOLUME	ROOF
B. ROOMS			
ROOMS			
BATHS			
FIREPLACES			
FOOTINGS	FOUNDATION	B. WALLS	

UTILITIES

WATER	WEL	SEWER	ELECT	GAS	TYPE OF HEAT	AC
					H.P.	

I have carefully examined and read this application and know the same is true and correct, and that in doing this work, all provisions of Howard County Ordinances and the State Laws of Maryland will be complied with, whether specified or not, and I will notify the Department of Inspections, and Permits twenty-four hours in advance when I am ready for the inspections called for elsewhere in the application; and that no work will be covered up until such inspections have been completed with.

CONTRACTOR SIGNATURE: [Signature]  
TITLE: CONTRACTOR  
DATE: 10-15-92

W/S CODE FOR OFFICE USE ONLY

DISTRICT IN FEET FROM RAW LINE TO FRONT BUILDING LINE

SIDE YARD (DISTANCE IN FEET FROM SIDE BLDG. LINE TO SIDE PROPERTY LINE)

TO SIDE BUILDING LINE

DISTANCE IN FEET, REAR YD. REQUIRING SET

BACK (CORNER LOT ONLY)

SDP #

Check payable to: DIRECTOR OF FINANCE OF HOWARD COUNTY

FUNCTION	DATE	SIGNATURE APPROVAL
ZONING/PLANNING		
SHA		
SEDIMENT/GRADING		
BUILDING OFFICIAL		
WATER & SEWER		
HEALTH DEPT.	10/26/92	B. Hodge
FIRE PROTECTION		
STORM WATER MGM.		

IMPORTANT: PLEASE SHOW ZIP CODES AND AREA CODES WHEREVER REQUIRED.

APPROVED DATE

Distribution of Copies:  
White - Building Official  
Green - Planning & Zoning  
Yellow - Engineering  
Pink - Health Dept.  
Gold - S.H.A.

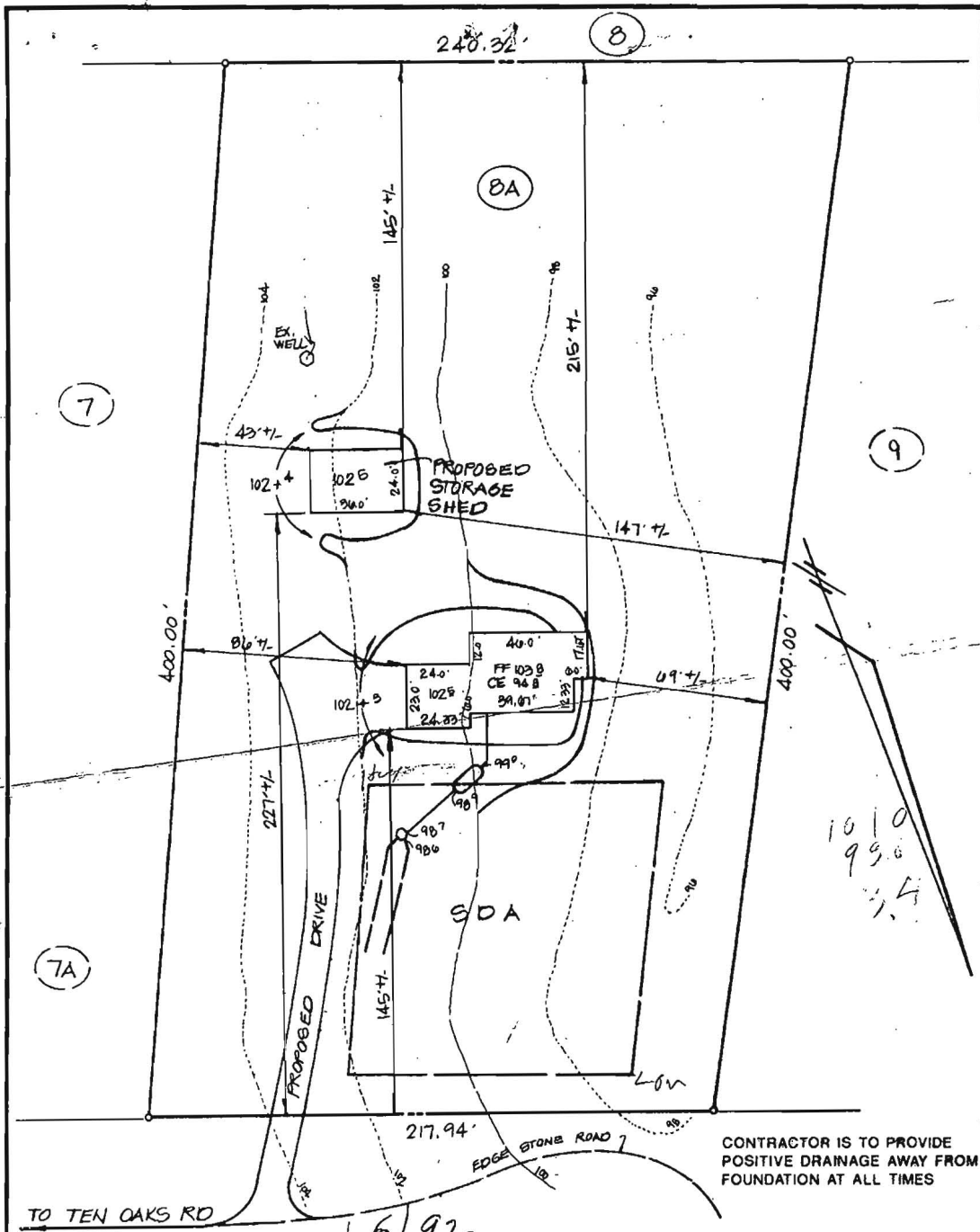

TO TEN OAKS RD

10/26/92  
PLANS OK  
BP 45801

**J.W.M.K.** RH

5TH ELECT. DIST. HOWARD CO, MD

James W. McKee, MD Reg. 9012 Date

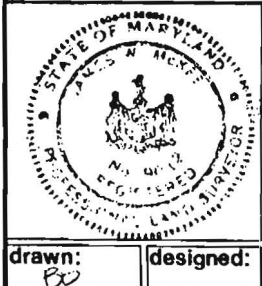

**SITE PLAN**

LOT 8A PROPERTY OF ALAN WEINTRAUB

**McKEE & ASSOCIATES, INC.**

CIVIL ENGINEERS - LAND SURVEYORS  
SHAWAN PLACE  
5 SHAWAN ROAD HUNT VALLEY, MD 21030  
301-527-1555

scale:  
1" = 50'

date:  
10-15-92

job no.:  
JR-10

drawn: *BJ*

designed: