

\$396.00

Will pick up Monday



Howard County Health Department

APPLICATION

FOR PERCOLATION TESTING AND SITE EVALUATION

TEST DATE(S) _____ TEST TIME _____ A/P _____

AGENCY REVIEW _____ DATE _____

DO NOT WRITE ABOVE THIS LINE

I HEREBY APPLY FOR THE NECESSARY TESTING/EVALUATION PRIOR TO ISSUANCE OF SEWAGE DISPOSAL SYSTEM PERMIT(S) TO:

CHECK AS NEEDED:

- CONSTRUCT NEW SEPTIC SYSTEM(S)
- REPAIR/ADD TO AN EXISTING SEPTIC SYSTEM
- REPLACE AN EXISTING SEPTIC SYSTEM

CHECK AS NEEDED:

- NEW STRUCTURE(S)
- ADDITION TO AN EXISTING STRUCTURE
- REPLACE AN EXISTING STRUCTURE

CHECK ONE:

- CREATE NEW LOT(S)
- BUILD ON AN EXISTING LOT IN A SUBDIVISION
- BUILD ON AN EXISTING PARCEL OF RECORD

IS THE PROPERTY WITHIN 2500' OF ANY RESERVOIR?

- YES
- NO

THE TYPE OF STRUCTURE IS:

- RESIDENTIAL WITH _____ PROPOSED BEDROOMS IN THE COMPLETED STRUCTURE (NOTE UNKNOWN IF APPROPRIATE)
- COMMERCIAL (PROVIDE DETAIL OF NUMBERS AND TYPES OF EMPLOYEES/ CUSTOMERS ON ACCOMPANYING PLAN)
- INSTITUTIONAL/GOVERNMENT (PROVIDE DETAIL OF NUMBERS AND TYPES OF EMPLOYEES/USERS ON ACCOMPANYING PLAN)

PROPERTY OWNER(S) Dave Roarty ROARTY

DAYTIME PHONE 240-299-1911 CELL _____ FAX _____

MAILING ADDRESS 2402 Cherry Tree Dr Clarksville STATE 21029 ZIP _____
STREET CITY/TOWN

APPLICANT Fyock Septic

DAYTIME PHONE 410-988-9270 CELL 410-984-0999 FAX 410-531-1256

MAILING ADDRESS P.O. Box 89 Glenely MD STATE 21237 ZIP _____
STREET CITY/TOWN

APPLICANT'S ROLE: DEVELOPER BUILDER BUYER RELATIVE/FRIEND REALTOR CONSULTANT

PROPERTY LOCATION SUBDIVISION/PROPERTY NAME Same AS Above LOT NO. _____

PROPERTY ADDRESS _____ STREET TOWN/POST OFFICE

TAX MAP PAGE(S) _____ GRID _____ PARCEL(S) _____ PROPOSED LOT SIZE _____

AS APPLICANT, I UNDERSTAND THE FOLLOWING: THE SYSTEM INSTALLED SUBSEQUENT TO THIS APPLICATION IS ACCEPTABLE ONLY UNTIL PUBLIC SEWERAGE IS AVAILABLE. THIS APPLICATION IS COMPLETE WHEN ALL APPLICABLE FEES AND A SUITABLE SITE PLAN HAVE BEEN RECEIVED. I ACCEPT THE RESPONSIBILITY FOR COMPLIANCE WITH ALL M.O.S.H.A. AND "MISS UTILITY" REQUIREMENTS. APPROVAL IS BASED UPON SATISFACTORY REVIEW OF A PERC CERTIFICATION PLAN.

TEST RESULTS WILL BE MAILED TO APPLICANT. Tammy Skappo
SIGNATURE OF APPLICANT

HOWARD COUNTY HEALTH DEPARTMENT, BUREAU OF ENVIRONMENTAL HEALTH, WELL AND SEPTIC PROGRAM
3525-H ELLICOTT MILLS DRIVE, ELLICOTT CITY, MARYLAND 21043-4544 (410) 313-1771 FAX (410) 313-2648
TDD (410) 313-2323 TOLL FREE 1-877-4MD-DHMH

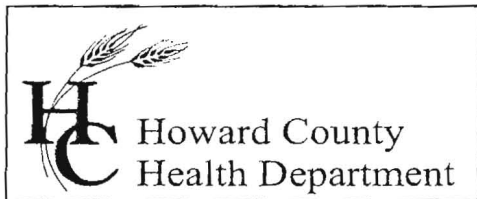

7178 Columbia Gateway Drive, Columbia, MD 21046
(410) 313-2640 Fax (410) 313-2648
TDD (410) 313-2323 Toll Free 1-866-313-6300
website: www.hchealth.org

Penny E. Borenstein, M.D., M.P.H., Health Officer

September 8, 2005

Mr. Roartey
7402 Cherry Tree Drive
Clarksville, MD 21029

Re: Confirm Septic Repair Area
7402 Cherry Tree Drive

To Whom It May Concern:

The Howard County Health Department found both satisfactory and unsatisfactory soils limiting replacement sewage disposal area on September 2, 2005 on the referenced property. The major limiting factors include two existing sheds, former in ground pool, existing wells and deep impermeable soils. The septic area found is only to be used in a repair situation only. No new bedrooms will be permitted for the above referenced property.

If you have any questions feel free to call me at (410) 313-1771)

Sincerely,

Kevin J. Bell
Water and Septic Program

Cc: Robert Fyock

File

FYOCK SEPTIC SERVICE
24-HOUR SERVICE
410 988-9270 OR 410 531-2939
FAX: 410 531-1256

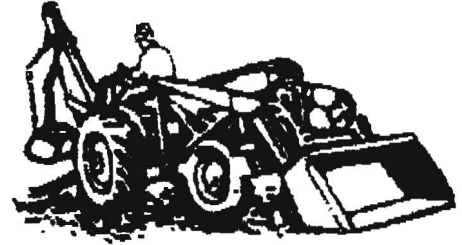

TO: _____ DATE: _____

FROM: Tommy _____ PAGES: _____

MESSAGE: _____ URGENT _____ REPLY ASAP _____ PLEASE REVIEW

Call me if any questions

Thanks

Tommy

410-984-0999

SITE INSPECTION SHEET

OWNER: David Roarty PHONE #: _____
 ADDRESS: 7402 Cherry Tree Drive CONTRACTOR: Fyock
 SUBDIVISION: Hopkins Meade LOT: 18 WELL TAG #: -Buried-
 PROPOSAL: add. w/ Bedroom COUNTY #: Howard

LOCATION DIAGRAM

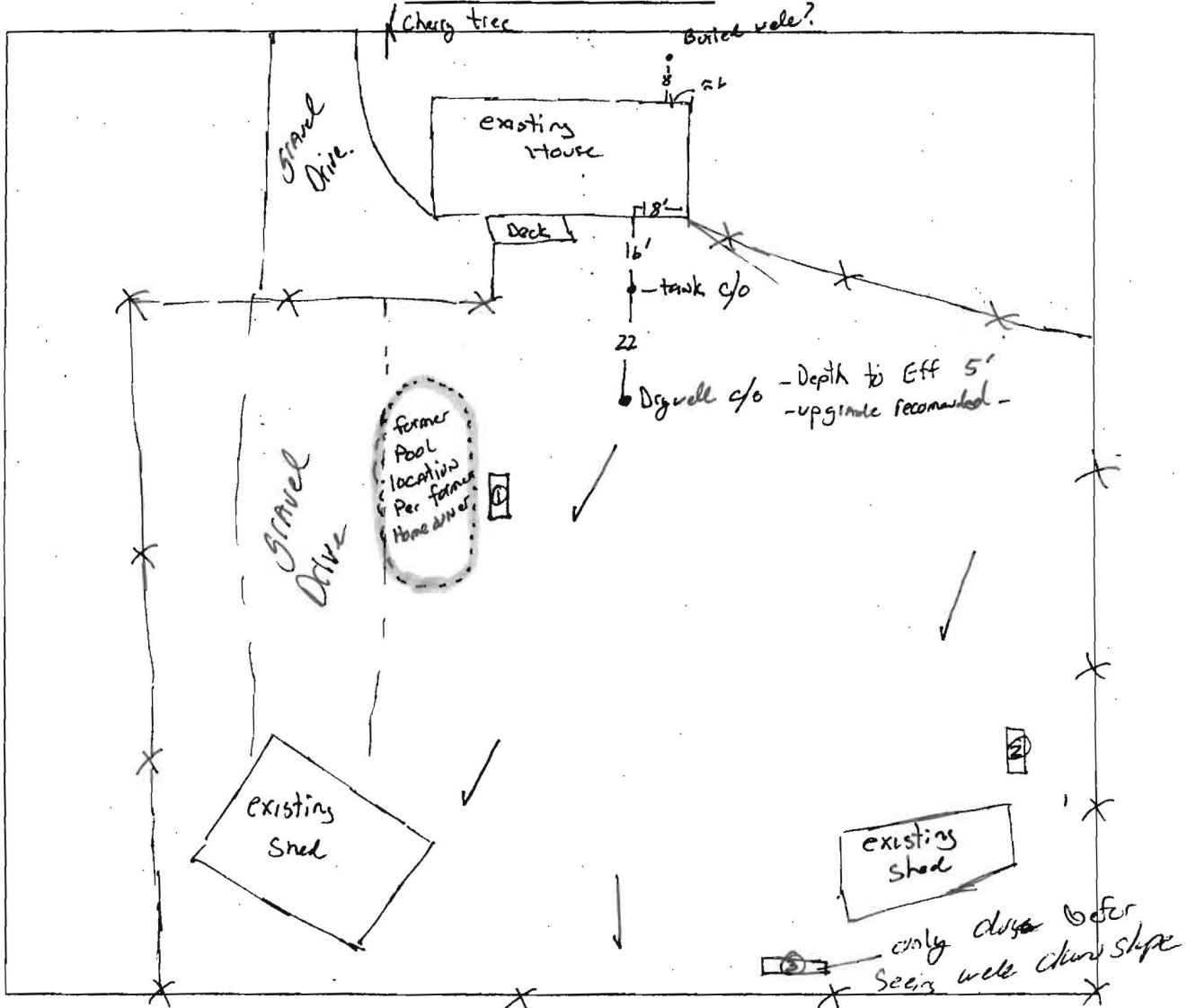

COMMENTS: wells downslope, not to exceed existing shed w/ septic.

* Per Notes + times on Back -

-trench specs → Inlet at 4' - max bottom 11' - eff. area 7' - Area not found for a new Bedroom for repair only!

DATE: 9/2/05

INSPECTOR: KJB/SF/OC

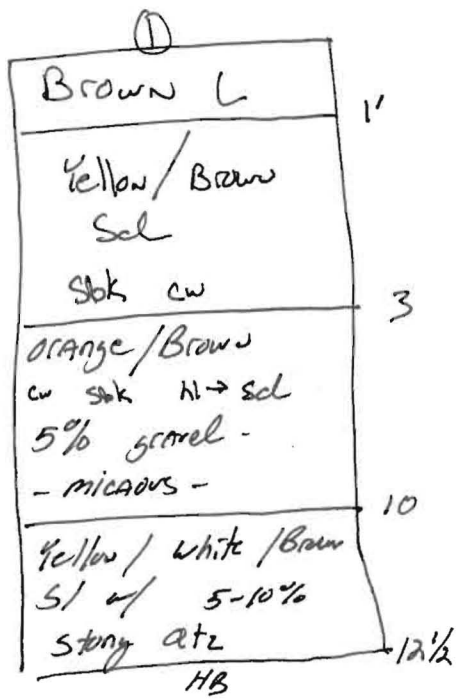

Depth	Time	1st	2nd	Per F
① 6' / 12.5'	11:44	Pulled @ 12:02	Slow	F
② 7' / 15'	12:24	12:29	12:40	(P) 11 min

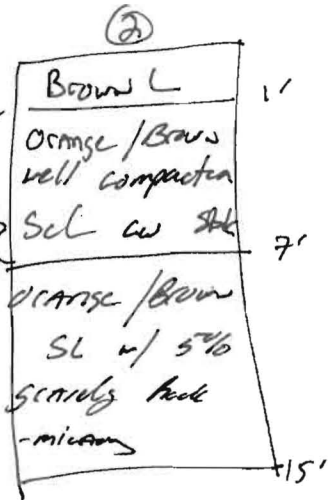

veins of
silt & sel in
this section

11:44