

Ready for final

PERMIT

P 01112
A 00920

SEWAGE DISPOSAL SYSTEM

MARYLAND STATE DEPARTMENT OF HEALTH

HOWARD COUNTY

ELLICOTT CITY

DISTRICT 2

DATE 6/9/59

INDEXED

02196808

Excavating Contractors IS PERMITTED TO INSTALL ALTER

ADDRESS 1211 Baker Ave. Balto. 7 PHONE Ri. 4-4154

A SEWAGE DISPOSAL-SYSTEM LOCATED AT _____

SUBDIVISION Brinkleigh Manor ROAD 2989 Brookwood LOT 39

PROPERTY OWNER Yale Contractors Inc. Robt. Brehm *3911 new st*

ADDRESS 508 Stanford Rd. Balto. 29

SPECIFICATIONS

DRAIN FIELD _____ DEPTH _____ FEET, BOTTOM AREA _____ SQ. FT.

SEEPAGE PITS ABSORBENT SIDE-WALL AREA _____ SQ. FT.

SEPTIC TANK CAPACITY 750 GALLONS

FOR GARBAGE GRINDER, INCREASE DISPOSAL AREA 22% & TANK CAPACITY 50%.

OTHER 30' X 30' at 10 ft. depth.

PLANS APPROVED BY J. Hennigan DATE 5/20/59

FILL SEPTIC TANK AND DISTRIBUTION BOX WITH WATER BEFORE CALLING FOR AN INSPECTION. COVER NO WORK UNTIL INSPECTED AND APPROVED.

NEITHER THE HOWARD COUNTY COMMISSIONERS NOR THE HEALTH DEPARTMENT IS RESPONSIBLE FOR THE SUCCESSFUL OPERATION OF ANY SYSTEM.

A522879-A
A00920

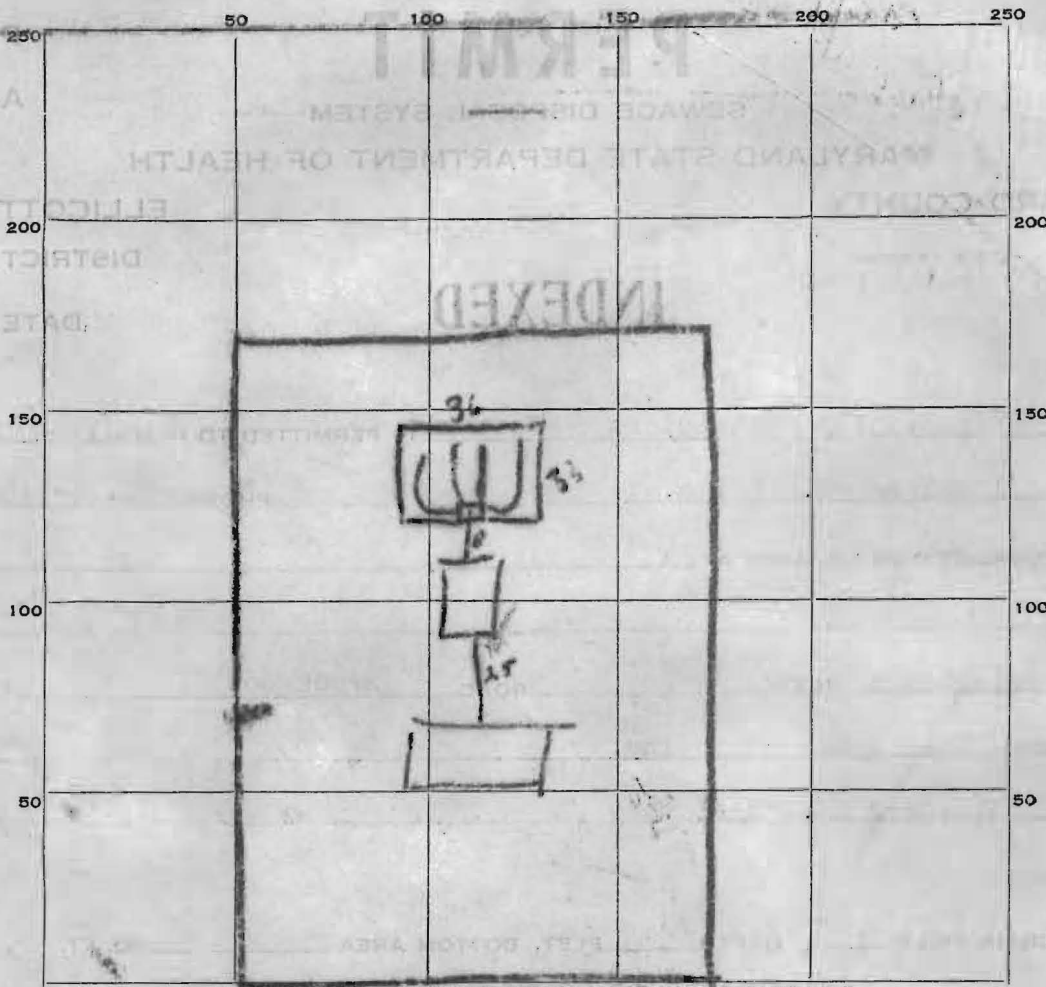

INDICATE NORTH. - NAME ADJOINING ROADWAY AS BASE LINE.

PERMIT CARD yes

SEPTIC TANK, LEVEL OK 750 CLEANOUTS OK 8"

DISTRIBUTION BOX, LEVEL OK

TILE FIELD, DEPTH _____ FT. TRENCH WIDTH _____ FT.

GRAVEL DEPTH _____ IN. TOTAL LENGTH _____ FT.

NUMBER OF TRENCHES _____ TOTAL BOTTOM AREA _____

SEEPAGE PITS, INSIDE DIAMETER _____ FT. DEPTH BELOW INLET _____ FT.

ABSORBENT AREA _____ SQ. FT.

REMARKS Leaching Bed 36 x 33 = 1088 sq ft
2" gravel over pipes 2 1/2' under
pipes
Depth of Bed about 7 ft.

DATE SYSTEM APPROVED 8/20/59 INSPECTOR Raymond
Hodge

APPLICATION

A 00920

P 01112

SEWAGE DISPOSAL TESTING

MARYLAND STATE DEPARTMENT OF HEALTH

HOWARD COUNTY

ELLICOTT CITY

DISTRICT 2

DATE 5-7-59

*30' x 30' at 10 FT. depth.
750 gal septic tank*

TO: THE COUNTY HEALTH OFFICER
ELLICOTT CITY, MARYLAND

I, HEREBY, APPLY FOR THE NECESSARY TESTS IN ORDER TO CONSTRUCT (OR RECONSTRUCT) A SEWAGE DISPOSAL SYSTEM.

PROPERTY OWNER Yale Contractors Inc.

ADDRESS 508 Stanford Rd., Balto. 29 PHONE E. C. 1680

PROPERTY LOCATION:

SUBDIVISION Brinkleigh Manor LOT NO. 39

ROAD AND DESCRIPTION Brookwood Rd. *39 is new #*

OCCUPANT _____ PHONE _____

PERSON TO CONSTRUCT SYSTEM _____

ADDRESS _____ PHONE _____

SIZE OF LOT 125 x 165 TYPE BLDG. 3
NUMBER OF BEDROOMS

IF NOT SINGLE RESIDENCE DESCRIBE _____

SIGNATURE OF APPLICANT E. Hynes

APPROVED BY *J. Hennigan* FOR *sewer bed.* DATE 5-20-59
(KIND OF SYSTEM)

REJECTED BY _____ FOR _____ DATE _____
(KIND OF SYSTEM)

HOLD PENDING FURTHER TESTS _____ DATE _____

REASONS FOR REJECTION OR HOLDING _____

THIS IS NOT A PERMIT

A 00920

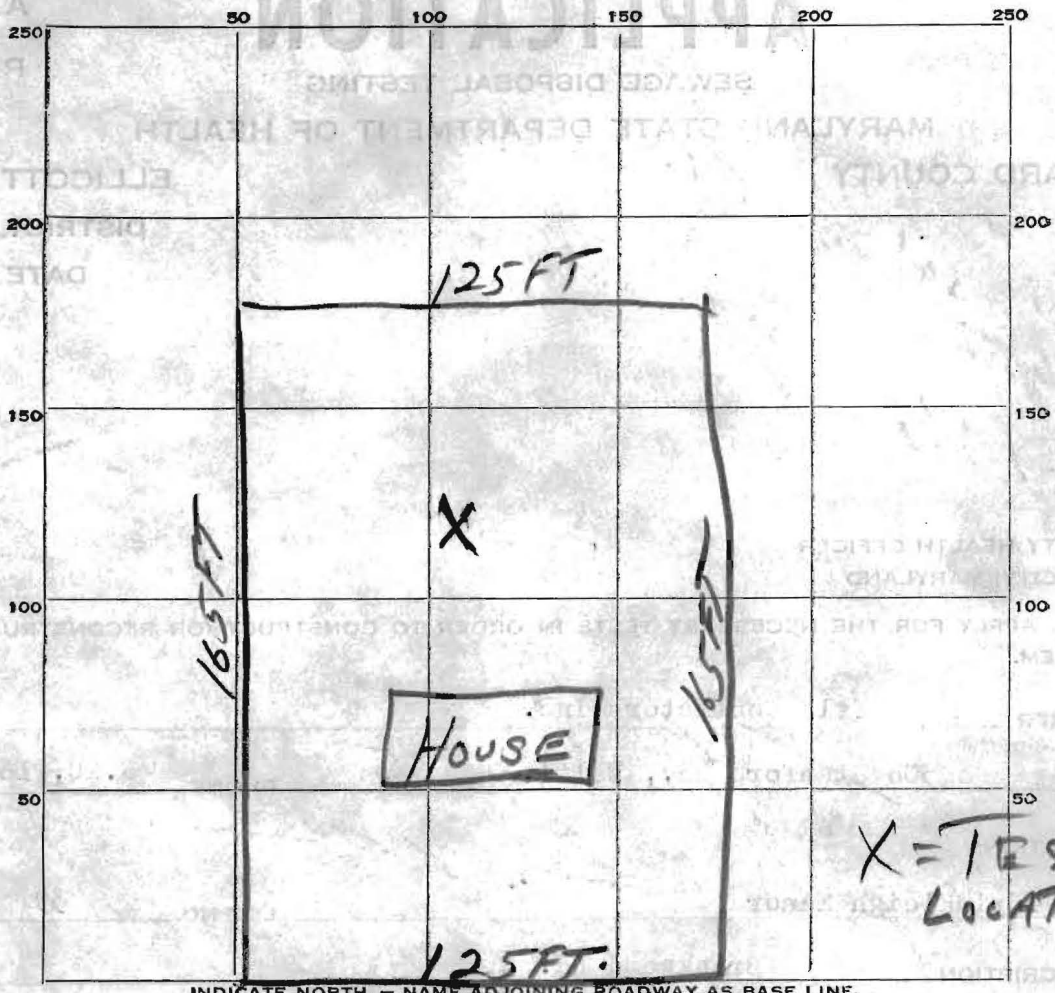

DATE	TEST NO.	DEPTH.	PRE-WET		TEST - 1" DROP		TIME
			START	STOP	START	STOP	
5-20-59	1	10 FT	10:39	10:56	10:56	11:36	40 Minutes

SOIL AUGER FINDING

TESTED BY *J.H.*

REMARKS *P Smith*

ALSO PRESENT LOT NO. *# 39*

STATE OF MARYLAND

HOWARD COUNTY HEALTH DEPARTMENT ELLICOTT CITY, MARYLAND

Date

June 9

19

Name

Explosives Contractors

Telephone No.

Ri 84-4154

DETAILED LOCATION OF SITE, DEVELOPMENT,
SECTION, ROAD, LOT NO. & ELECTION DISTRICT

*Brimbley Manor -
Brookwood Lot # 39*

PRIVATE SEWAGE DISPOSAL SYSTEMS

Testing and Inspection

\$

Installation Permit

\$

1.00

Received
Payment

Marion Buckley

01112

TRIPPLICATE

THIS RECEIPT IS NOT
A PERMIT AND IT IS
NOT A WARRANTY OF
PERFORMANCE OF
THE SYSTEM THAT
IS INSTALLED

5/20/05

PART OF MR'S
pile

NEEDS TO
REINDEX

DEPARTMENT OF INSPECTIONS, LICENSES AND PERMITS

HOWARD COUNTY

LICENSES AND PERMIT DIVISION

It is understood that disconnection, pumping and filling of septic system, with earth, is required at time of connecting house sewer to County Sewer Connection. Reference Howard County Plumbing Code, Chapter 16.

- 1 - Copy to Owner
- 1 - Copy to Plumber
- 1 - Copy with Application
- 1 - Copy with Plumber's Application to Health Dept.

<u>Robert Brehm</u>	
Homeowner	
<u>2989 Brookwood Road, Ellicott City</u>	
Address	
<u>Robert Rueter</u>	<u>3052</u>
Plumber	Registration No.