

LAYOUT \_\_\_\_\_ INSP 4 \_\_\_\_\_  
INSP 2 \_\_\_\_\_ INSP 5 \_\_\_\_\_  
INSP 3 \_\_\_\_\_ INSP 6 \_\_\_\_\_

ISSUE DATE: 6/17/05

P 522539

APPROVAL DATE: 7/12/05

A Upgrade

**PERMIT**  
**INDEXED**

**TAX ID #05-435897**

**ON-SITE SEWAGE DISPOSAL SYSTEM**  
**HOWARD COUNTY HEALTH DEPARTMENT**  
**BUREAU OF ENVIRONMENTAL HEALTH**

Brian Tarantino IS PERMITTED TO INSTALL  ALTER

ADDRESS: 13401 Allnutt Lane PHONE NUMBER: 301-859-9994

SUBDIVISION: Allnutt Farms Estates LOT NUMBER: 27

ADDRESS: 13401 Allnutt Lane PROPERTY OWNER: Brian Tarantino

SEPTIC TANK CAPACITY (GALLONS): 1500 OUTLET BAFFLE FILTER REQUIRED

PUMP CHAMBER CAPACITY (GALLONS): n/a COMPARTMENTED TANK REQUIRED

NUMBER OF BEDROOMS: 5

SQUARE FEET PER BEDROOM: 180

LINEAR FEET OF TRENCH REQUIRED: 126 HOUSE SERVED BY PUBLIC WATER

TRENCHES:	Trench to be 3.0 feet wide. Inlet 3.0 feet below original grade. Bottom maximum depth 8.0 feet below original grade. Effective area begins at 4.0 feet below original grade. 5.0 feet of stone below distribution pipe.
LOCATION:	Keep distribution at the highest elevation in the approved SDA.
NOTES:	Upgrade is in support of future building permit for a proposed pool & addition. Make sure new trench does not intersect with old abandoned trenches. Shed to be removed in future repairs.

PLANS APPROVED: Peter A. Yencsik Reviewed by: \_\_\_\_\_ DATE: 6/17/05

NOTES: PERMIT VOID AFTER 2 YEARS  
CONTRACTOR IS RESPONSIBLE FOR SCHEDULING A PRE-CONSTRUCTION INSPECTION FOR ALL INSTALLATIONS  
WATERTIGHT SEPTIC TANKS REQUIRED  
ALL PARTS OF SEPTIC SYSTEM SHALL BE 100 FEET FROM ANY WATER WELL UNLESS SPECIFICALLY AUTHORIZED  
MANHOLE RISERS REQUIRED ON ALL SEPTIC TANKS AND PUMP CHAMBERS UNLESS SPECIFICALLY AUTHORIZED  
CONTRACTOR RESPONSIBLE FOR COMPLIANCE WITH APPLICABLE REGULATIONS, GUIDELINES AND THE TERMS OF THIS PERMIT

**NEITHER THE HOWARD COUNTY COUNCIL NOR THE HEALTH DEPARTMENT IS RESPONSIBLE FOR THE SUCCESSFUL OPERATION OF ANY SYSTEM**

**PERMITTEE RESPONSIBLE FOR OBTAINING FINAL APPROVAL ON THIS PERMIT**

**BUILDING PERMIT SIGNED** 313-1771 FOR INSPECTION OF SEPTIC SYSTEM

**AND RETURNED**

7-17-05 BOO/54817-2 STORY ADDITION

0522007

NOT TO SCALE

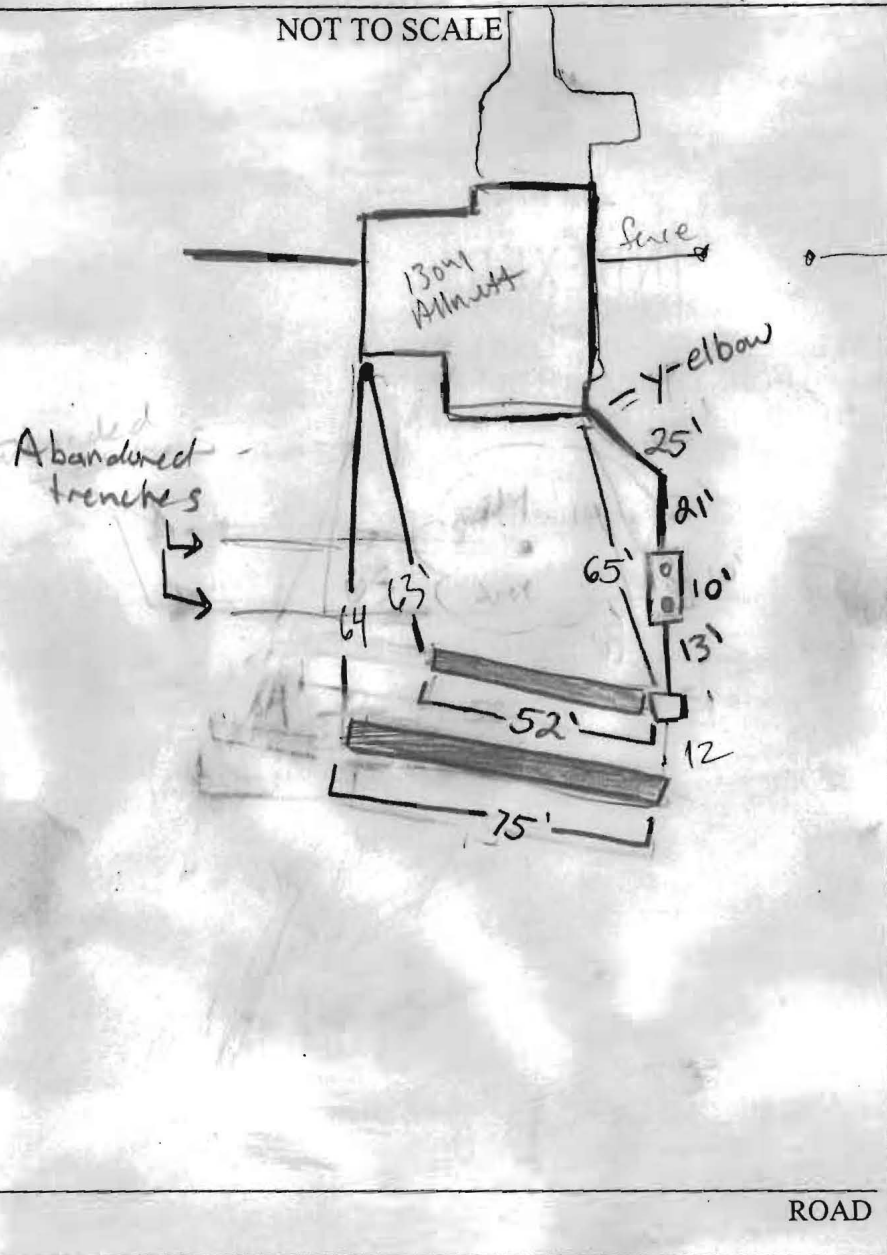

TRENCH/DRAINFIELD DATA		
WIDTH	INLET	BOTTOM
3	3	8
NUMBER OF TRENCHES		2
TOTAL LENGTH		127
ABSORPTION AREA		
DISTRIBUTION BOX LEVEL <input checked="" type="checkbox"/>		
DISTRIBUTION BOX BAFFLE <input checked="" type="checkbox"/>		
DISTRIBUTION BOX PORT <input checked="" type="checkbox"/>		

SEPTIC TANK DATA		
SEPTIC TANK 1 LEVEL <input checked="" type="checkbox"/>		
CAPACITY	1500	GAL
SEAM LOC	top	
TANK LID DEPTH	1 1/2	
BAFFLES	<input checked="" type="checkbox"/>	
BAFFLE FILTER		
MANHOLE LOC	2	
6" PORT LOC	<input checked="" type="checkbox"/>	
WATERTIGHT TEST	N/A	
SEPTIC TANK 2 LEVEL <input type="checkbox"/>		
CAPACITY		GAL
SEAM LOC		
TANK LID DEPTH		
BAFFLES		
BAFFLE FILTER		
MANHOLE LOC		
6" PORT LOC		
WATERTIGHT TEST		

PRE-CONSTRUCTION \_\_\_\_\_

INSTALLATION Layout - 1 56' trench + 1 70' trench  
3' wide PAY 7/12/05 tank level 4 in place  
1st trench shorter than layout, but added to  
second trench for future pool installation.  
O.K. to cover all work (PAY)

FINAL INSPECTOR PAY DATE OF APPROVAL 5/12/05

BUILDING PERMIT SIGNED AND RETURNED

# FILE INQUIRY FORM

Property Address: 13401 Allnut Lane

301-854-9991 - Robin Jordan

Allnut

Need a  
1500  
gallon  
tank

a hand  
auger.

~~Need plan~~  
Possible Pool

3 14  
44  
- 28  
16

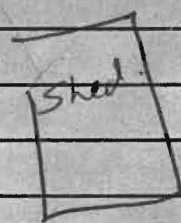
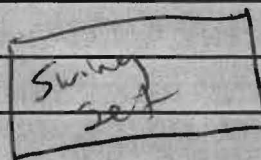
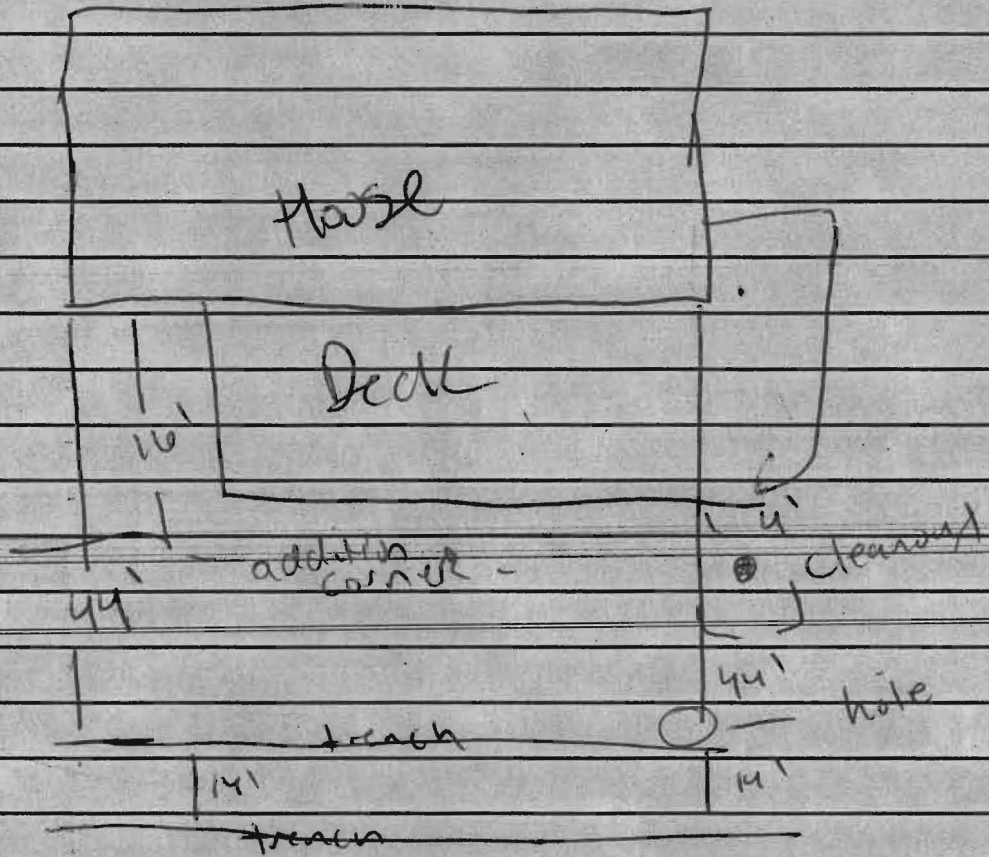

Perce

# FILE INQUIRY FORM

Property Address: \_\_\_\_\_

*Arroyo Viejo*

5/24/05

Called Owner & asked for  
new scale drawing w/  
trenches to be only 2 feet  
wide, not 2.

SITE INSPECTION SHEET

OWNER: \_\_\_\_\_ PHONE #: \_\_\_\_\_

ADDRESS: Almatt Farms CONTRACTOR: \_\_\_\_\_

\_\_\_\_\_ WELL TAG #: \_\_\_\_\_

SUBDIVISION: \_\_\_\_\_ LOT: \_\_\_\_\_ COUNTY #: \_\_\_\_\_

PROPOSAL: \_\_\_\_\_

LOCATION DIAGRAM

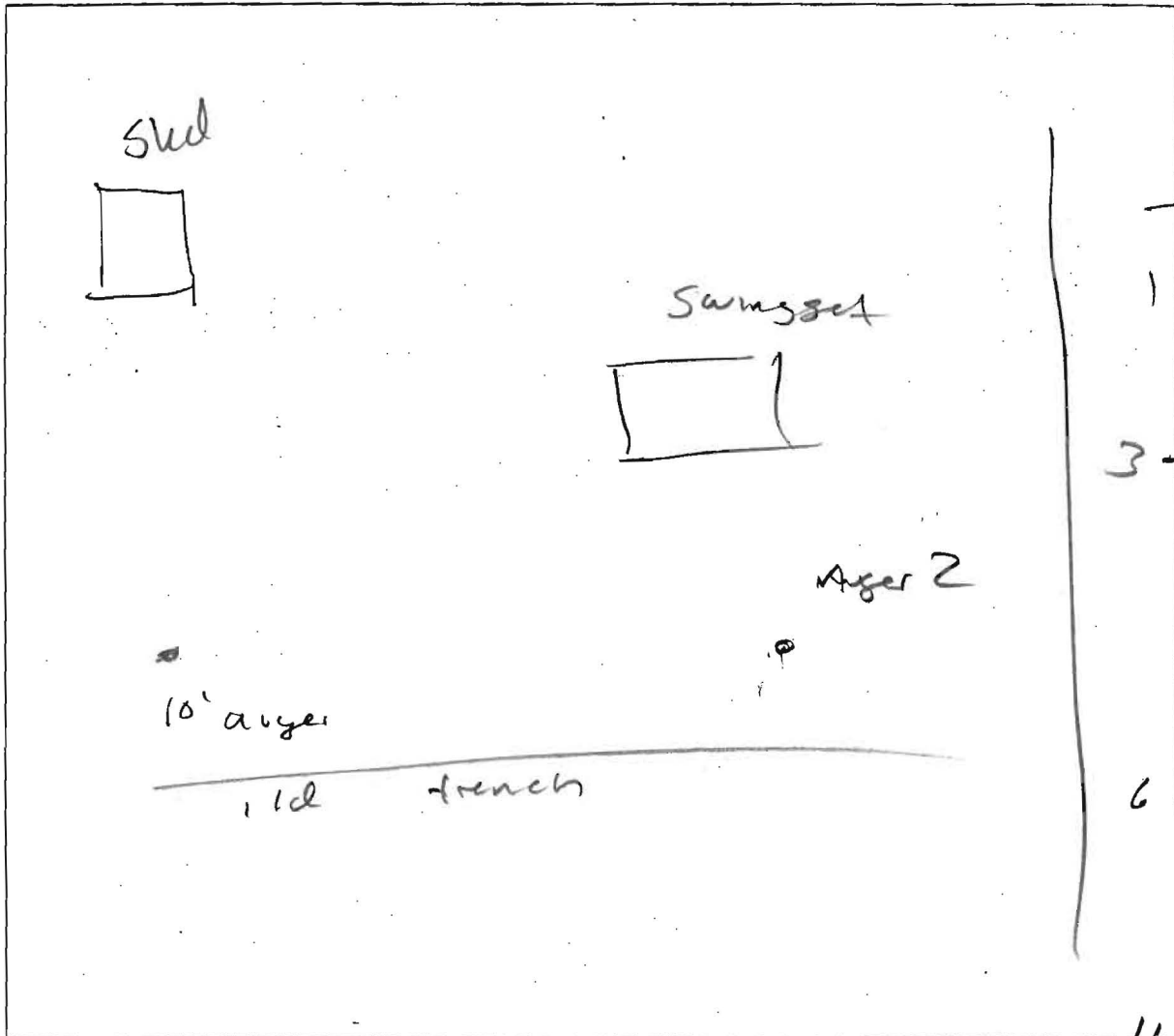

COMMENTS: Bottom at 6 inlet @ 3

3' Sidewall @ 180

Rate,

GOOD SOILS

DATE: 6/14/05 INSPECTOR: PAY