

PUB. SEWER STATUS VERIFIED BY _____

ISSUE DATE: 6/8/05

PERMIT

P 522525

APPROVAL DATE: 6/28/05

A 29107/repair

03313115
**ON-SITE SEWAGE DISPOSAL SYSTEM
HOWARD COUNTY HEALTH DEPARTMENT
BUREAU OF ENVIRONMENTAL HEALTH**

Dun Rite Septic Tank Service IS PERMITTED TO INSTALL ALTER

ADDRESS: 15300 Parrish Rd, Upperco PHONE NUMBER: 410-461-3255

SUBDIVISION: Mathis Property LOT NUMBER: 24

ADDRESS: 12388 Frederick Road PROPERTY OWNER: James Mathis

SEPTIC TANK CAPACITY (GALLONS): _____

PUMP CHAMBER CAPACITY (GALLONS): _____

NUMBER OF BEDROOMS: 3

SQUARE FEET PER BEDROOM: 180'

LINEAR FEET OF TRENCH REQUIRED: 90'

*Inlet 4.5'
Bottom 9.0'
2' Wide*

TRENCHES:	Trench to be _____ feet wide. Inlet _____ feet below original grade. Bottom maximum depth _____ feet below original grade. Effective area begins at _____ feet below original grade. _____ feet of stone below distribution pipe.
LOCATION:	
PURPOSE:	Existing septic system has failed. Call for inspection when ground is opened so sanitarian can recommend repair.

PLANS APPROVED: _____ DATE: _____

- NOTE: PERMIT VOID AFTER 2 YEARS
- NOTE: CONTRACTOR RESPONSIBLE FOR SCHEDULING A PRE-CONSTRUCTION INSPECTION FOR ALL INSTALLATIONS
- NOTE: WATERTIGHT SEPTIC TANKS REQUIRED
- NOTE: ALL PARTS OF SEPTIC SYSTEM SHALL BE 100 FEET FROM ANY WATER WELL
- NOTE: MANHOLE RISERS REQUIRED ON ALL SEPTIC TANKS AND PUMP CHAMBERS

NEITHER THE HOWARD COUNTY COUNCIL OR THE HEALTH DEPARTMENT IS RESPONSIBLE FOR THE SUCCESSFUL OPERATION OF ANY SYSTEM PERMITTEE RESPONSIBLE FOR OBTAINING FINAL APPROVAL ON THIS PERMIT CALL 410-313-2640 FOR INSPECTION OF SEPTIC SYSTEM

P 522525

NOT TO SCALE

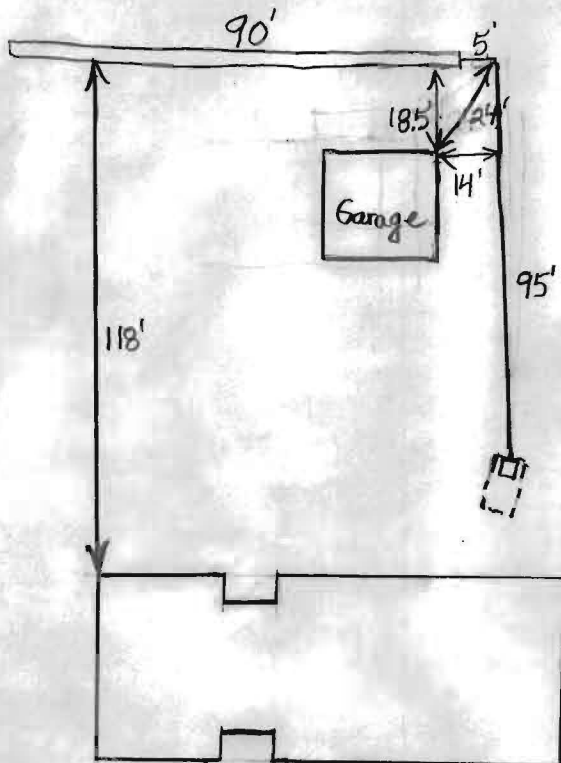

Frederick ROAD

TRENCH/DRAINFIELD DATA		
WIDTH	INLET	BOTTOM
2'	4'-4.5'	9'
NUMBER OF TRENCHES		1
TOTAL LENGTH		90'
ABSORPTION AREA _____		
DISTRIBUTION BOX LEVEL _____		
DISTRIBUTION BOX BAFFLE _____		
DISTRIBUTION BOX PORT _____		

SEPTIC TANK DATA	
SEPTIC TANK 1 LEVEL _____	
CAPACITY	Existing GAL
SEAM LOC	Midseam
TANK LID DEPTH	4.5'
BAFFLES _____	
BAFFLE FILTER	No
MANHOLE LOC	Rear
6" PORT LOC	None
WATERTIGHT TEST No	
SEPTIC TANK 2 LEVEL _____	
CAPACITY	_____ GAL
SEAM LOC _____	
TANK LID DEPTH _____	
BAFFLES _____	
BAFFLE FILTER _____	
MANHOLE LOC _____	
6" PORT LOC _____	
WATERTIGHT TEST _____	

PRE-CONSTRUCTION 6/21/05 Contractor to pump out and fill in existing drywell with dirt. Put in a 90' trench on
 INSTALLATION contour near the perc test hole. Use the specifications on the front of the permit. (BB) 6/28/05
 Trench done. Connection to tank made. Old drywell pumped out and filled in per contractor. (BB)

FINAL INSPECTOR B. Baker DATE OF APPROVAL 6/28/05