

LAYOUT _____

INSP 1 _____ INSP 3 _____

INSP 2 _____ INSP 5 _____

ISSUE DATE: 6/7/2005

P 522515

APPROVAL
DATE: 6/14/05

PERMIT SHARED SEPTIC SYSTEM

A 515326

INDEXED

03343960

HOUSE SEWER LINE CONNECTION

HOWARD COUNTY HEALTH DEPARTMENT
BUREAU OF ENVIRONMENTAL HEALTH

NVR Inc T/A Ryan Homes IS PERMITTED TO INSTALL ALTER

ADDRESS: 6085 Marshalee Dr, Suite 140 PHONE NUMBER: 410-796-0980

SUBDIVISION Homeland LOT NUMBER: 86

ADDRESS: 11907Hampstead Green PROPERTY OWNER: NVR. Inc. t/a Ryan Homes

NUMBER OF BEDROOMS: 2

HOUSE SERVED BY PUBLIC WATER? YES

LOCATION:	Install 4" house sewer line connection per the approved site plan.
NOTES:	This permit is limited to the installation of the individual house sewer line connection and installation of the grinder pump, if applicable. The Howard County Bureau of Utilities must be contacted for scheduling of inspection of these items, as well at 410-313-4900.

PLANS APPROVED: Kevin J. Bell DATE: 5/18/05

PERMIT VOID AFTER 2 YEARS

1. CONTRACTOR IS RESPONSIBLE FOR SCHEDULING A PRE-CONSTRUCTION INSPECTION FOR ALL INSTALLATIONS.
2. ALL PARTS OF SEPTIC SYSTEM SHALL BE 100 FEET FROM ANY WATER WELL UNLESS SPECIFICALLY AUTHORIZED.
3. MANHOLE RISERS REQUIRED ON ALL SEPTIC TANKS AND PUMP CHAMBERS UNLESS SPECIFICALLY AUTHORIZED.
4. CONTRACTOR RESPONSIBLE FOR COMPLIANCE WITH APPLICABLE REGULATIONS, GUIDELINES AND THE TERMS OF THIS PERMIT.
5. NEITHER THE HOWARD COUNTY COUNCIL OR THE HEALTH DEPARTMENT IS RESPONSIBLE FOR THE SUCCESSFUL OPERATION OF ANY SYSTEM.
6. PERMITTEE RESPONSIBLE FOR OBTAINING FINAL APPROVAL ON THIS PERMIT.

CALL 410-313-1771 FOR INSPECTION HOUSE CONNECTION

P522515

NOT TO SCALE

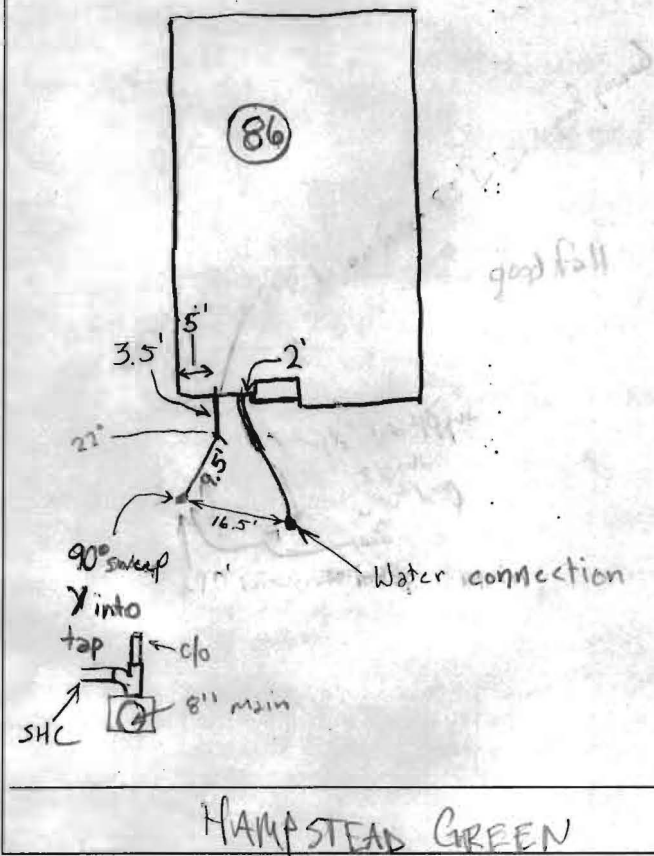

HAMPSTEAD GREEN

ROAD

TRENCH/DRAINFIELD DATA		
WIDTH	INLET	BOTTOM
_____	_____	_____
NUMBER OF TRENCHES _____		
TOTAL LENGTH _____		
ABSORPTION AREA _____		
DISTRIBUTION BOX LEVEL _____		
DISTRIBUTION BOX BAFFLE _____		
DISTRIBUTION BOX PORT _____		

SEPTIC TANK DATA	
SEPTIC TANK 1 LEVEL _____	
CAPACITY _____	GAL
SEAM LOC _____	
TANK LID DEPTH _____	
BAFFLES _____	
BAFFLE FILTER _____	
MANHOLE LOC _____	
6" PORT LOC _____	
WATERTIGHT TEST _____	
SEPTIC TANK 2 LEVEL _____	
CAPACITY _____	GAL
SEAM LOC _____	
TANK LID DEPTH _____	
BAFFLES _____	
BAFFLE FILTER _____	
MANHOLE LOC _____	
6" PORT LOC _____	
WATERTIGHT TEST _____	

PRE-CONSTRUCTION _____

INSTALLATION 6/14/05 Sewer House Connection comes out below footer of poured foundation; 9.5' below top of poured foundation. Checked fall w/ level → is good. Sewer tap into main is ~ 7.0' below grade @ tap into main. Water connection is sleeved ~ 10' out of house with 1 1/2" sch. 40 pvc. Did not see line itself. (GAK)

FINAL INSPECTOR Daniel A. Luigs

DATE OF APPROVAL 6/14/05

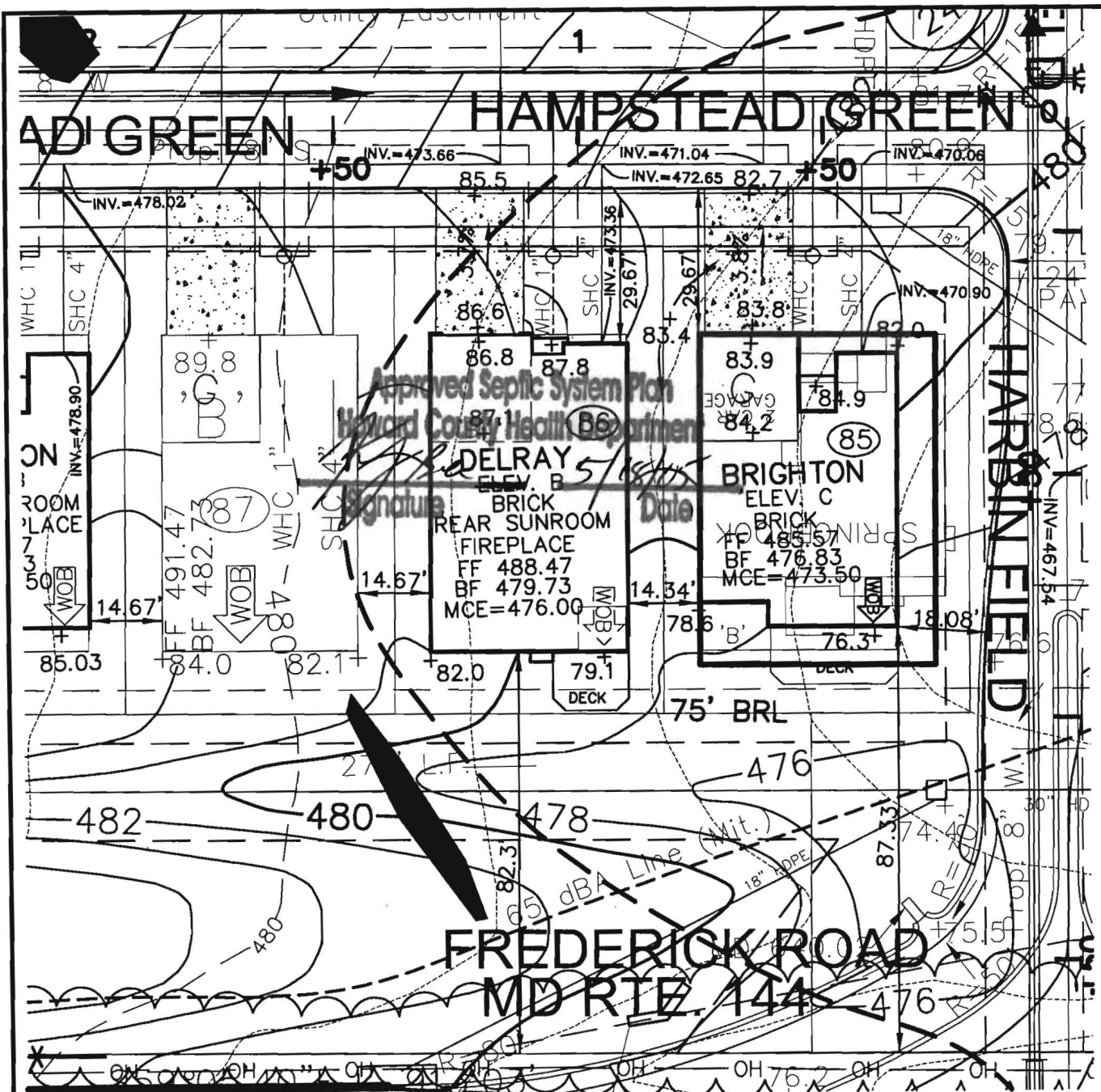

VA ROBERT H. VOGEL ENGINEERING, INC.
ENGINEERS • SURVEYORS • PLANNERS
8407 MAIN STREET TEL: 410.461.7666
ELLCOTT CITY, MD 21043 FAX: 410.461.8961

SCALE 1"=30'
DRAWN BY JCO
CHECKED BY RHV
DATE MAY, 2005
W. O. # 04-87.00
SHEET# 1 OF 1

**RYAN HOMES
HOMELAND
UNIT 86**

SDP-03-30
TAX MAP 16
3RD ELECTION DISTRICT

PARCEL 53,96,165&204
HOWARD COUNTY, MARYLAND



HOWARD COUNTY HEALTH DEPARTMENT

Bureau of Environmental Health
7178 Columbia Gateway Drive, Columbia MD 21046
(410) 313-2640 FAX (410) 313-2648
TDD (410) 313-2323 Toll Free 1-877-4MD-DHMH

Penny E. Borenstein, M.D., M.P.H., County Health Officer

06/23/2005

NVR Inc. t/a Ryan Homes
6085 Marshalee Drive, Suite 140
Elkridge, Maryland 21075

SENT VIA FACSIMILE 410-796-7094

RE: Homeland, Lot 86
11907 Hampstead Green
Ellicott City, MD 21043
BP # B00153676
PUBLIC WATER

Dear Sirs or Madam:

This is to advise that the connection from the house to the street has been installed and inspected for the referenced property. A Community Septic System serves this dwelling. **Final approval was granted on 06/14/2005 by HCHD for the house connection.**

The property is served by public water and is therefore exempt from the Health Department water sampling requirements.

By issuance of this letter, this office recommends release of the Use and Occupancy permit for the referenced property.

RECOMMENDATION FOR USE AND OCCUPANCY

Respectfully,

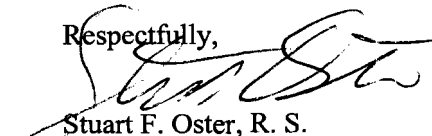

Stuart F. Oster, R. S.
Well and Septic Program

cc: DILP, Building Inspectors Office
File