

LAYOUT _____

INSP 1 _____ INSP 3 _____

INSP 2 _____ INSP 4 _____

ISSUE DATE: 4/14/05

P 522096

APPROVAL DATE: 5/19/05

PERMIT INDEXED
03343847

A _____

**COMMUNITY SEPTIC SYSTEM
HOUSE SEWER LINE CONNECTION**

**HOWARD COUNTY HEALTH DEPARTMENT
BUREAU OF ENVIRONMENTAL HEALTH**

NVR Inc. T/A Ryan/Nv Homes IS PERMITTED TO INSTALL ALTER

ADDRESS: 6085 Marshalee Dr., Suite 140 PHONE NUMBER: 410-796-0980

SUBDIVISION Homeland Unit # 39

ADDRESS: 11983 Grayton Run PROPERTY OWNER: NVR Inc. t/a Ryan Homes

NUMBER OF BEDROOMS: 2

HOUSE SERVED BY PUBLIC WATER

LOCATION:	Install 4" house sewer line connection per the approved site plan. Final acceptance of the sewer system will be subject to the approval of the Maryland Dept. of the Environment.
NOTES:	This permit is limited to the installation of the individual house sewer line connection.

PLANS APPROVED: Kevin J. Bell DATE: 3/25/05

PERMIT VOID AFTER 2 YEARS

1. CONTRACTOR IS RESPONSIBLE FOR SCHEDULING A PRE-CONSTRUCTION INSPECTION FOR ALL INSTALLATIONS.
2. ALL PARTS OF SEPTIC SYSTEM SHALL BE 100 FEET FROM ANY WATER WELL UNLESS SPECIFICALLY AUTHORIZED.
3. CONTRACTOR RESPONSIBLE FOR COMPLIANCE WITH APPLICABLE REGULATIONS, GUIDELINES AND THE TERMS OF THIS PERMIT.
4. NEITHER THE HOWARD COUNTY COUNCIL OR THE HEALTH DEPARTMENT IS RESPONSIBLE FOR THE SUCCESSFUL OPERATION OF ANY SYSTEM.
5. PERMITTEE RESPONSIBLE FOR OBTAINING FINAL APPROVAL ON THIS PERMIT.

**CALL 410-313-1771 FOR INSPECTION OF SEPTIC CONNECTION
BUILDING PERMIT SIGNED
AND RETURNED**

4-2205 BOD153217-DECK

P 522096

NOT TO SCALE



TRENCH/DRAINFIELD DATA		
WIDTH	INLET	BOTTOM
_____	_____	_____
NUMBER OF TRENCHES _____		
TOTAL LENGTH _____		
ABSORPTION AREA _____		
DISTRIBUTION BOX LEVEL _____		
DISTRIBUTION BOX BAFFLE _____		
DISTRIBUTION BOX PORT _____		

SEPTIC TANK DATA	
SEPTIC TANK 1 LEVEL _____	
CAPACITY _____	GAL
SEAM LOC _____	
TANK LID DEPTH _____	
BAFFLES _____	
BAFFLE FILTER _____	
MANHOLE LOC _____	
6" PORT LOC _____	
WATERTIGHT TEST _____	
SEPTIC TANK 2 LEVEL _____	
CAPACITY _____	GAL
SEAM LOC _____	
TANK LID DEPTH _____	
BAFFLES _____	
BAFFLE FILTER _____	
MANHOLE LOC _____	
6" PORT LOC _____	
WATERTIGHT TEST _____	

PRE-CONSTRUCTION _____

INSTALLATION 5/19/05 Came out AM. plumber was digging for lines and nothing was done. Came back out PM. Everything was covered and graded. drawing above taken from plumber's word. (GAC)

BUILDING PERMIT SIGNED AND RETURNED

FINAL INSPECTOR *John D...*

DATE OF APPROVAL 5/19/05

Approved Septic System Plan
Howard County Health Department

Imm 3/18/05

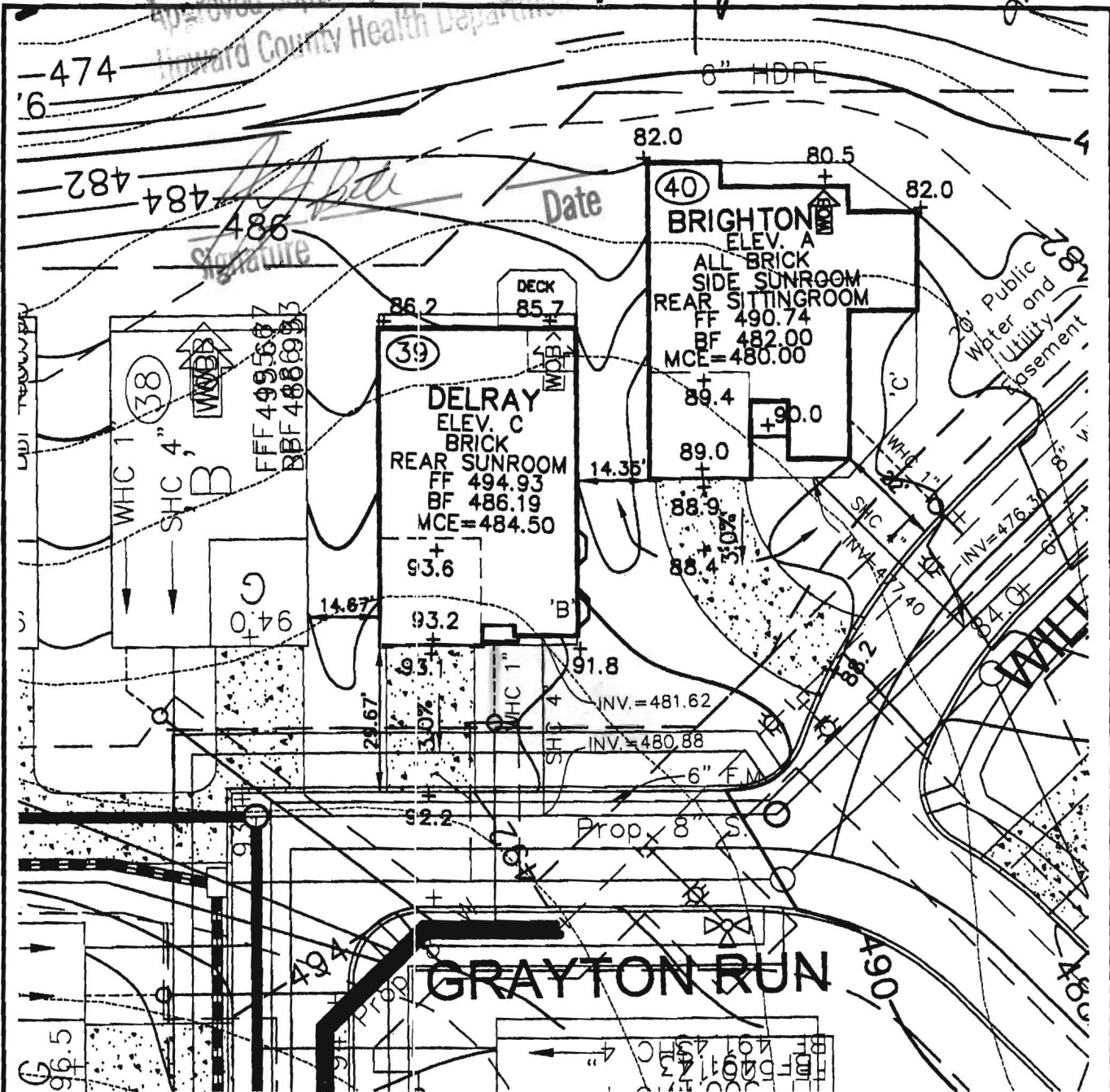

ROBERT H. VOGEL
ENGINEERING, INC.
ENGINEERS • SURVEYORS • PLANNERS
8407 MAIN STREET TEL: 410.461.7666
ELLICOTT CITY, MD 21043 FAX: 410.461.8981

NOTE:
ALL DIMENSION ARE FROM
ARCHITECTURAL BRICK LEDGE.

SCALE: 1"=30'
DRAWN BY: JCO
CHECKED BY: RHV
DATE: MARCH, 2005
W. O. #: 04-87.00
SHEET#: 1 OF 1

RYAN HOMES
ELLICOTT MEADOWS
UNIT 39

HOME/AND SDP-03-30
TAX MAP 18
3RD ELECTION DISTRICT

PARCEL 53,96,165&204
HOWARD COUNTY, MARYLAND

Methods.
Operator's Operation and Maintenance Manuals

provide operations and maintenance

and at least 60 days prior to the date set for to the Owner five (5) Operation and Maintenance Manuals for all electrical systems and equipment. The manuals shall include all installation, operation, start-up and maintenance procedures. The manuals shall consist of catalogs, parts lists, assembly drawings, wiring diagrams, and approved working drawings for the Owner to establish an effective

and in 3-ring loose-leaf binders and indexed. The manuals shall be of standard dimensions and placed in envelopes.

The Operator and/or Owner in understanding the operation and maintenance of the equipment as well as to ensure safe operation. Technical and maintenance information and electrical components shall be included but not limited to, Operation Responsibilities, Design Criteria, Operational Modifications, Component Equipment O&M, System Equipment and As-Built.

Work on the facilities will not be undertaken until all manuals have been submitted. Partial approvals

NH ₃ -N	35	mg/L
Alkalinity (as CaCO ₃)	100	mg/L
pH	6.0 - 9.0	S.U.
Water Temperature Min.	15	°C
Water Temperature Max	28	°C
Air Temperature Min.	0	°F
Air Temperature Max	100	°F
Site Elevation	442	ft
Effluent Characteristics		
BOD ₅ (20°C)	30	mg/L
Total Suspended Solids	30	mg/L
NH ₃ -N	1.0	mg/L
Total Nitrogen (N)	10.0	mg/l
Influent Pumping		
Average design rate in	15.3	gpm
Peak rate in	61.2	gpm @ 4 x Avg.
Pump rate provided	70	gpm 1 pump (28'TD)

SBR F

Dosing

PUBLIC WATER +
PRIVATE SHARED SEPTIC SYSTEM

SDP-03-030

HOMELAND SENIOR CENTER
147 UNITS TOTAL
EACH UNIT CAN ONLY
BE A TOTAL OF 2 BEDROOMS

Approved Septic System Plan MDE
~~Howard County Health Department~~

Approved Septic System Plan
Howard County Health Department

[Signature]
Signature
9-2-03
Date

Steven Roger King
Signature
9/2/03
Date

W.



HOWARD COUNTY HEALTH DEPARTMENT

Bureau of Environmental Health
7178 Columbia Gateway Drive, Columbia MD 21046
(410) 313-2640 FAX (410) 313-2648
TDD (410) 313-2323 Toll Free 1-877-4MD-DHMH

Penny E. Borenstein, M.D., M.P.H., County Health Officer

June 10, 2005

NVR Inc. t/a Ryan Homes
6085 Marshalee Drive, Suite 140
Elkridge, Maryland 21075

SENT VIA FACSIMILE 410-796-7094

RE: Homeland, Lot 39
11983 Grayton Run
Ellicott City, MD 21043
BP # B00152749
PUBLIC WATER

Dear Sirs or Madam:

This is to advise that the connection from the house to the street has been installed and inspected for the referenced property. A Community Septic System serves this dwelling. **Final approval was granted on 05/19/2005 by HCHD for the house connection.**

The property is served by public water and is therefore exempt from the Health Department water sampling requirements.

By issuance of this letter, this office recommends release of the Use and Occupancy permit for the referenced property.

RECOMMENDATION FOR USE AND OCCUPANCY

Respectfully,

Stuart F. Oster, R. S.
Well and Septic Program

cc: DILP, Building Inspectors Office
File