

check out

Hold check out May 4, 2:00

PERMIT

P 02397

SEWAGE DISPOSAL SYSTEM

A _____

MARYLAND STATE DEPARTMENT OF HEALTH

HOWARD COUNTY

INDEXED

ELLICOTT CITY

DISTRICT 6th

repair job

5/17/60 approved July 30/60
B/H

DATE 4/30/60

Claude Cissel IS PERMITTED TO INSTALL ALTER

ADDRESS Highland, Md. PHONE st 63326

A SEWAGE DISPOSAL SYSTEM LOCATED AT Harding Rd - 3rd house on right off Rt. 29#

SUBDIVISION _____ ROAD _____ LOT _____

PROPERTY OWNER Mildred E. Mitchell

ADDRESS Harding Rd. Laurel, Md.

SPECIFICATIONS

DRAIN FIELD _____ DEPTH _____ FEET, BOTTOM AREA _____ SQ. FT.

SEEPAGE PITS 1 ABSORBENT SIDE-WALL AREA 300 SQ. FT.

SEPTIC TANK CAPACITY 750 GALLONS

FOR GARBAGE GRINDER, INCREASE DISPOSAL AREA 22% & TANK CAPACITY 50%.

OTHER _____

PLANS APPROVED BY Robert F. Wynn DATE 4/30/60

FILL SEPTIC TANK AND DISTRIBUTION BOX WITH WATER BEFORE CALLING FOR AN INSPECTION. COVER NO WORK UNTIL INSPECTED AND APPROVED.

NEITHER THE HOWARD COUNTY COMMISSIONERS NOR THE HEALTH DEPARTMENT IS RESPONSIBLE FOR THE SUCCESSFUL OPERATION OF ANY SYSTEM.

A02397

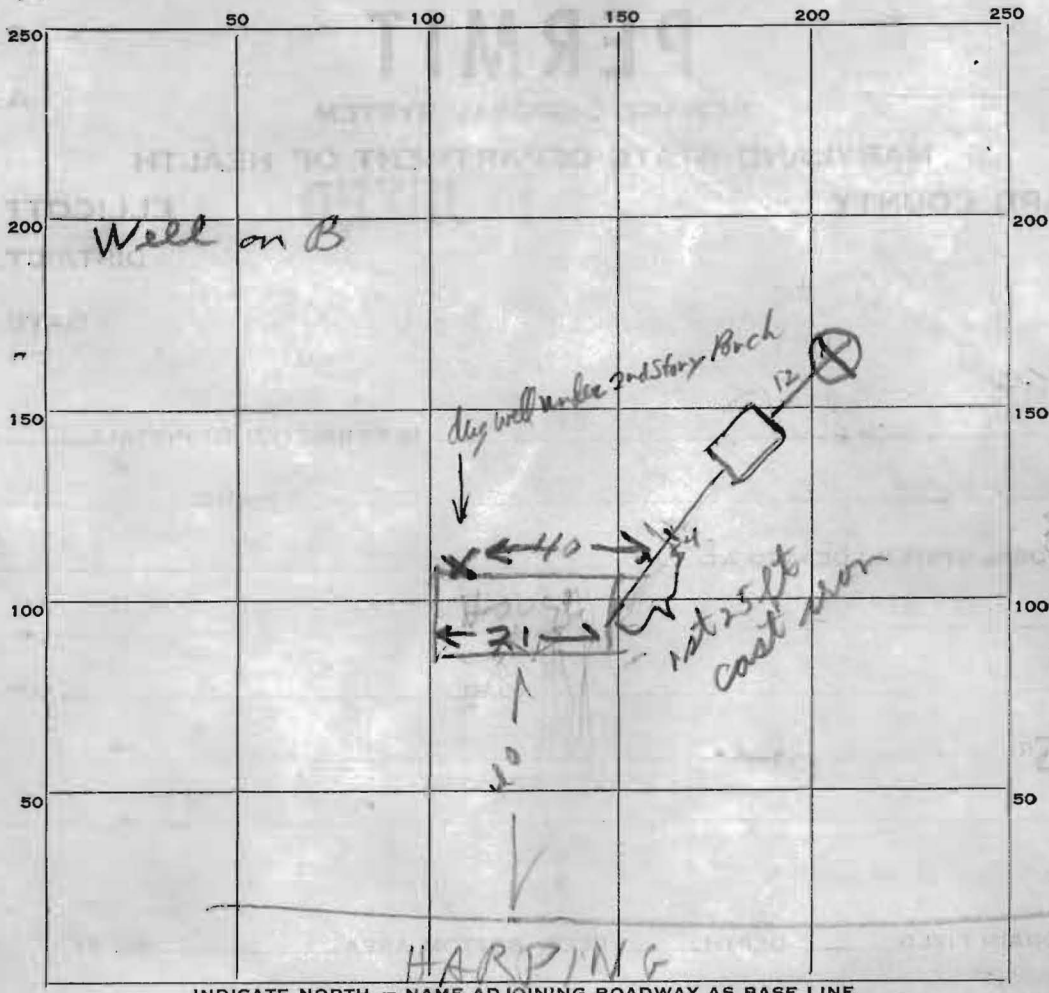

INDICATE NORTH. - NAME ADJOINING ROADWAY AS BASE LINE.

PERMIT CARD W

SEPTIC TANK, LEVEL OK 750 CLEANOUTS OK 8" Manhole

DISTRIBUTION BOX, LEVEL _____

TILE FIELD, DEPTH _____ FT. TRENCH WIDTH _____ FT.

GRAVEL DEPTH _____ IN. TOTAL LENGTH _____ FT.

NUMBER OF TRENCHES _____ TOTAL BOTTOM AREA _____

SEEPAGE PITS, INSIDE DIAMETER 7 1/2 FT. DEPTH BELOW INLET 9 FT.

ABSORBENT AREA 270 SQ. FT.

REMARKS Inlet 2 ft. below grade
6" to 1 ft of gravel around outside
of dry well
5/17/60 Orangeburg Sewer pipe less than 50 ft from well
Add cast iron pipe to all points within 50 ft or less
from the well OK, cast iron installed
 DATE SYSTEM APPROVED 5/17/60 INSPECTOR Raymond Hodger

STATE OF MARYLAND

HOWARD COUNTY HEALTH DEPARTMENT ELLICOTT CITY, MARYLAND

Date

4/30/00

19

Name

Clare Gissel

Telephone No.

at 63326

DETAILED LOCATION OF SITE, DEVELOPMENT,
SECTION, ROAD, LOT NO. & ELECTION DISTRICT

Warding Rd.

PRIVATE SEWAGE DISPOSAL SYSTEMS

Testing and Inspection

\$

Installation Permit

\$

Received
Payment

Palmer F. Quinn

P
02397
DUPLICATE

THIS RECEIPT IS NOT
A PERMIT AND IT IS
NOT A WARRANTY OF
PERFORMANCE OF
THE SYSTEM THAT
IS INSTALLED