

SITE INSPECTION SHEET

OWNER: William Tye PHONE #: \_\_\_\_\_

ADDRESS: 10963 Route 108 CONTRACTOR: \_\_\_\_\_

Co 1 2/10/44 WELL TAG #: \_\_\_\_\_

SUBDIVISION: TM 29, P. 115 LOT: \_\_\_\_\_ COUNTY #: \_\_\_\_\_

PROPOSAL: request for emergency inclusion in Metro Dist. due to low quantity & poor quality

LOCATION DIAGRAM

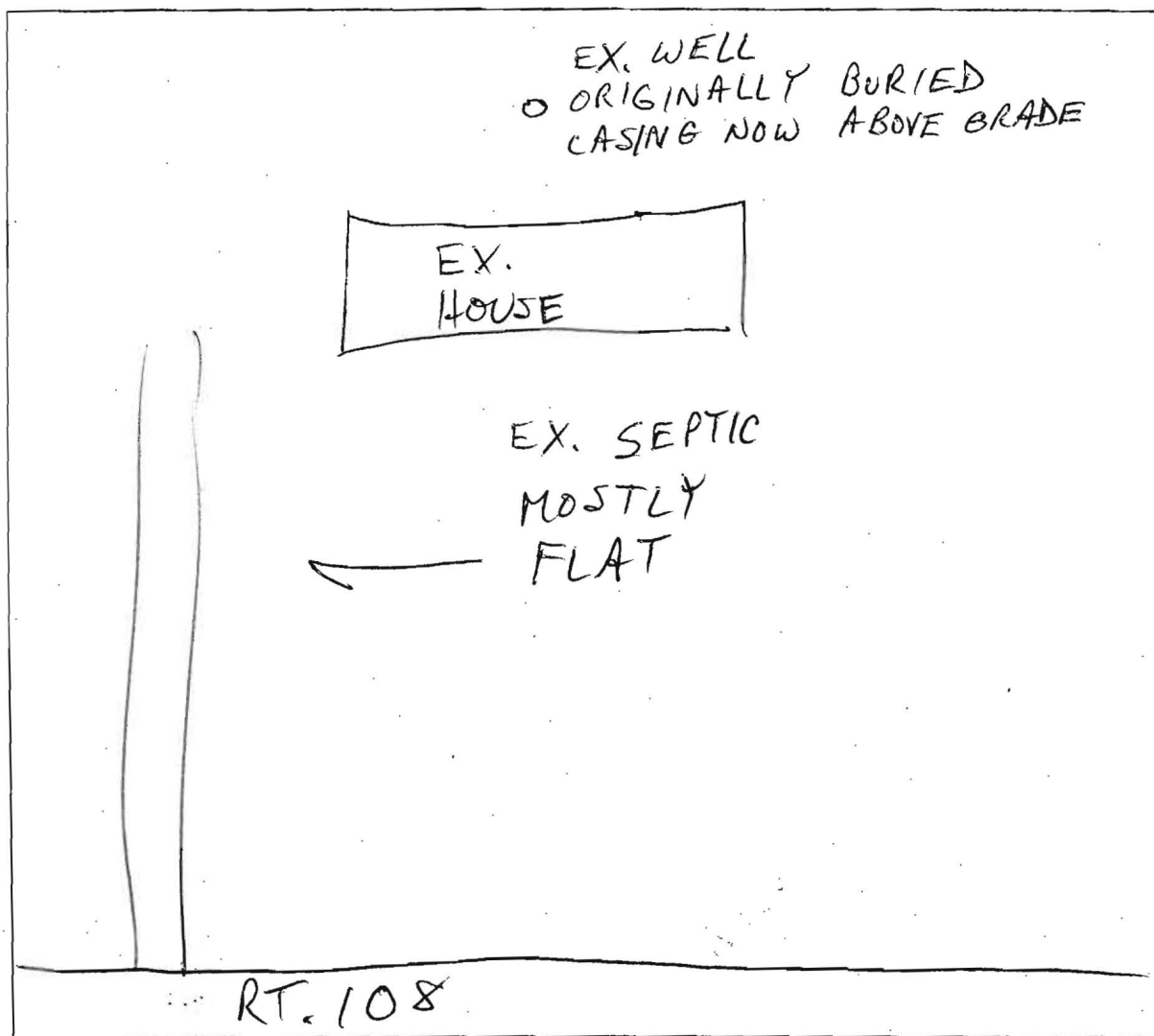

COMMENTS: 6/25/04 MET OWNER @ SITE: FINE SEDIMENT  
OBS'D IN H<sub>2</sub>O @ KITCHEN TAP, BROWN STAINS IN TOILET,  
NO CONFIRMATION OF POOR QUANTITY; OWNER REPORTS SIG  
QUANTITY OF SEDIMENT REMOVED FROM PRESSURE TANK ⇒ NO FLOW  
 DATE: \_\_\_\_\_ INSPECTOR: MR PROBS,  
 ENCOURAGED ~~FOR~~ SIMULTANEOUS CONN. TO PUB. SEWER

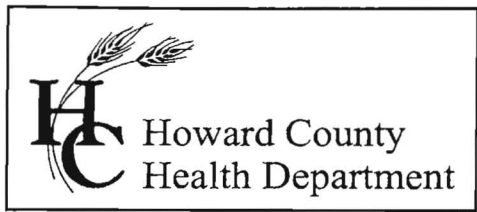

3525 H Ellicott Mills Drive, Ellicott City, MD 21043  
 (410) 313-2640 Fax (410) 313-2648  
 TDD (410) 313-2323 Toll Free 1-866-313-6300  
 website: www.hchealth.org

Penny E. Borenstein, M.D., M.P.H., Health Officer

June 28, 2004

MEMORANDUM

TO: Charlotte Dryden  
 Division of Real Estate Services

FROM: Mark Rifkin   
 Well and Septic Program

RE: Emergency Metropolitan District Inclusion  
 10963 Route 108  
 TM 29, Parcel 115

The Health Department recommends emergency inclusion of the referenced property into the Metropolitan District.

An inspection conducted June 25, 2004 revealed fine sediment in the well water supply. For the record, the owner reports intentions to maintain the well as a non-potable outdoor supply. Due to the age of the septic system, the owner is also encouraged to pursue simultaneous connection to public sewer.

MR  
 cc: File

[Click here for a plain text ADA compliant screen.](#)

 <b>Maryland Department of Assessments and Taxation</b> <b>HOWARD COUNTY</b> <b>Real Property Data Search</b>	<a href="#">Go Back</a> <a href="#">View Map</a> <a href="#">New Search</a> <a href="#">Ground Rent</a>
--	--

**Account Identifier:** District - 05 Account Number - 370078

**Owner Information**

<b>Owner Name:</b> TYE WILLIAM E & WF  <b>Mailing Address:</b> 10963 ROUTE 108 COLUMBIA MD 21044-1087	<b>Use:</b> RESIDENTIAL <b>Principal Residence:</b> YES <b>Deed Reference:</b> 1) / 385/ 199 2)
--	--

**Location & Structure Information**

<b>Premises Address</b>	<b>Legal Description</b>
10963 ROUTE 108 COLUMBIA 21044	1.339 ACRES 10963 ROUTE 108

Map	Grid	Parcel	Sub District	Subdivision	Section	Block	Lot	Group	Plat No: Plat Ref:
29	17	115						81	

<b>Special Tax Areas</b>	<b>Town Ad Valorem Tax Class</b>	NO A/V, NO M/P, METRO FIRE TAX
--------------------------	----------------------------------	--------------------------------

Primary Structure Built		Enclosed Area	Property Land Area	County Use
1962		1,586 SF	1.33 AC	
Stories	Basement	Type		Exterior
1	YES	STANDARD UNIT		FRAME

**Value Information**

	Base Value	Value As Of 01/01/2002	Phase-in Assessments As Of 07/01/2003	Phase-in Assessments As Of 07/01/2004
Land:	97,300	110,950		
Improvements:	73,690	93,180		
<b>Total:</b>	<b>170,990</b>	<b>204,130</b>	<b>193,082</b>	<b>204,130</b>
Preferential Land:	0	0	0	0

**Transfer Information**

<b>Seller:</b>	<b>Date:</b>	<b>Price:</b>
<b>Type:</b>	<b>Deed1:</b>	<b>Deed2:</b>
<b>Seller:</b>	<b>Date:</b>	<b>Price:</b>
<b>Type:</b>	<b>Deed1:</b>	<b>Deed2:</b>
<b>Seller:</b>	<b>Date:</b>	<b>Price:</b>
<b>Type:</b>	<b>Deed1:</b>	<b>Deed2:</b>

**Exemption Information**

<b>Partial Exempt Assessments</b>	<b>Class</b>	07/01/2003	07/01/2004
County	000	0	0
State	000	0	0
Municipal	000	0	0

**Tax Exempt:** NO **Special Tax Recapture:**  
**Exempt Class:** \* NONE \*