

# APPLICATION

A 21412

## SEWAGE DISPOSAL TESTING

P \_\_\_\_\_

STATE OF MARYLAND - DEPARTMENT OF HEALTH AND MENTAL HYGIENE

HOWARD COUNTY HEALTH DEPARTMENT  
ENVIRONMENTAL HEALTH SERVICES  
P. O. BOX 476, ELLICOTT CITY, MARYLAND 21043  
TELEPHONE: 485-5000, EXT. 356

DISTRICT 5

DATE 4/29/75

TO: THE COUNTY HEALTH OFFICER  
ELLICOTT CITY, MARYLAND

I, HEREBY, APPLY FOR THE NECESSARY TEST IN ORDER TO CONSTRUCT (OR RECONSTRUCT) A SEWAGE DISPOSAL SYSTEM.

PROPERTY OWNER Hilda Linthicum  
(Contract Purchaser - Ronald Bryan)  
ADDRESS Beltsville, Maryland PHONE Mrs. Dillman  
Any questions call:  
206-2945 or 988-9303

PROPERTY LOCATION: \_\_\_\_\_

SUBDIVISION \_\_\_\_\_ LOT NO. \_\_\_\_\_

ROAD AND DESCRIPTION Highland Road - approx. 1/4 mile from Brighton Dam Road - on left side - several lots past Nichols Drive

SIZE OF LOT 3.000 acres TYPE BLDG. 3 or 4

IF NOT SINGLE RESIDENCE DESCRIBE \_\_\_\_\_  
NUMBER OF BEDROOMS  
(Single Emly. Dwellg.)

THE SYSTEM INSTALLED UNDER THIS APPLICATION IS ACCEPTABLE ONLY UNTIL PUBLIC FACILITIES BECOME AVAILABLE.

SIGNATURE OF APPLICANT Carolyn Dillman

APPROVED BY \_\_\_\_\_ FOR \_\_\_\_\_ DATE \_\_\_\_\_  
(KIND OF SYSTEM)

REJECTED BY \_\_\_\_\_ FOR \_\_\_\_\_ DATE \_\_\_\_\_  
(KIND OF SYSTEM)

HOLD PENDING FURTHER TESTS \_\_\_\_\_ DATE \_\_\_\_\_

REASONS FOR REJECTION OR HOLDING \_\_\_\_\_

# THIS IS NOT A PERMIT

A 21412

1. - 0 clay loam  
 + 2'  
 - 4' mix  
 ↓  
 grading  
 from  
 surface  
 into  
 sandy loam  
 - 11%

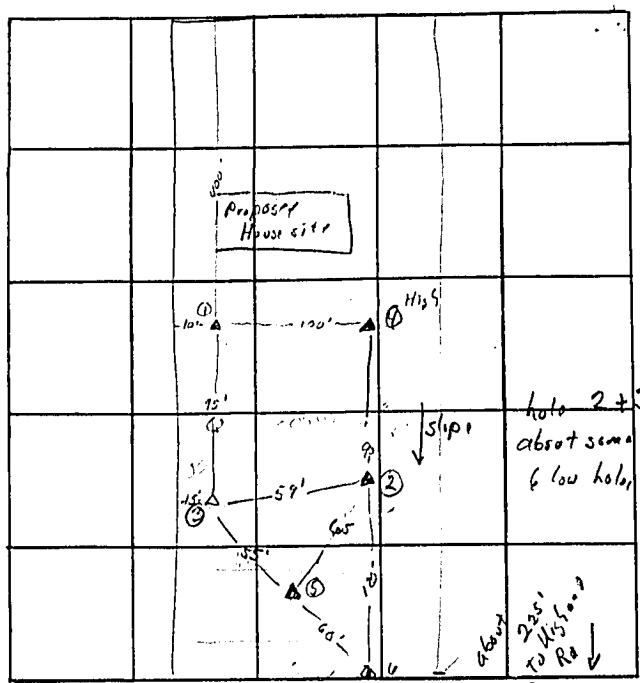

INDICATE NORTH. - NAME ADJOINING ROADWAY AS BASE LINE  
 Highway Rd.

DATE	TEST NO.	DEPTH	PRE-WET		TEST - 1" DROP		TIME
			START	STOP	START	STOP	
5/10/44	1s	4'	12 <sup>20</sup>	12 <sup>21</sup>	12 <sup>21</sup>	12 <sup>22</sup>	1 min
"	1d	10 1/2'	12 <sup>20</sup>	12 <sup>26</sup>	12 <sup>26</sup>	12 <sup>30</sup>	4 min
"	2s	4 1/2'	12 <sup>30</sup>	12 <sup>32</sup>	12 <sup>32</sup>	12 <sup>35</sup>	3 min
"	2d	11'	12 <sup>30</sup>	12 <sup>35</sup>	12 <sup>35</sup>	12 <sup>46</sup>	11 min
"	3d	12 1/2'	12 <sup>41</sup>	12 <sup>42</sup>	12 <sup>42</sup>	12 <sup>45</sup>	3 min
"	3s	4 1/2'	12 <sup>41</sup>	12 <sup>45</sup>	12 <sup>45</sup>	12 <sup>50</sup>	5 min
"	4	visual	11 1/2'				
"	5	visual	11'				
"	6s	4 1/2'	12 <sup>48</sup>	12 <sup>55</sup>	12 <sup>55</sup>	12 <sup>05</sup>	10 min
"	6d	12'	12 <sup>48</sup>	12 <sup>56</sup>	12 <sup>56</sup>	12 <sup>59</sup>	3 min

REMARKS no good soil at 3'

TYPE OF SOIL All sandy loam with a 6 silt band in all visual holes

TESTED BY \_\_\_\_\_ ALSO PRESENT: \_\_\_\_\_