

5/22/78 before
5/19/78 u.m. please
trench in f.m. if possible

PERMIT

P 28064

A 23908

SEWAGE DISPOSAL SYSTEM

MARYLAND STATE DEPARTMENT OF HEALTH*

HOWARD COUNTY

ELLICOTT CITY

DISTRICT 3rd

INDEXED

DATE 5/11/78

Pat Lendrim IS PERMITTED TO INSTALL X ALTER

ADDRESS Sykesville, Md. PHONE _____

SUBDIVISION Indian Hill ROAD Howard Lodge Road LOT 12511

PROPERTY OWNER Earl S. Helmrich, Jr.

ADDRESS 7417 Village Road, Sykesville, Md.

SPECIFICATIONS 3 bedrooms

SEPTIC TANK CAPACITY 1000 GALLONS

DRAIN FIELD _____ DEPTH _____ FEET, BOTTOM AREA _____ SQ. FT.

DEEP TRENCH _____ DEPTH _____ FEET, BOTTOM AREA _____ SQ. FT.

SEEPAGE PITS _____ ABSORBENT SIDE-WALL AREA 150 SQ. FT. per bedroom

INLET PIPE 3 FT. BELOW ORIGINAL GRADE. MAXIMUM DEPTH 10 FT. BELOW ORIGINAL GRADE

EFFECTIVE DEPTH AT _____ FT. BELOW ORIGINAL GRADE.

LOCATE DISPOSAL AREA 188 FT. FROM rear LOT LINE AND 150 FT. FROM left LOT LINE AS SEEN WHEN FACING LOT FROM Howard Lodge Road.

If trench is used, follow contours of land, trench to be 2 ft. wide, 10 ft. deep, 7 ft. of stone. Trench to begin 5 ft. from edge of dry well.

PLANS APPROVED BY Robert T. Moorefield DATE 12/27/76

COVER NO WORK UNTIL INSPECTED AND APPROVED.

NEITHER THE HOWARD COUNTY COUNCIL NOR THE HEALTH DEPARTMENT IS RESPONSIBLE FOR THE SUCCESSFUL OPERATION OF ANY SYSTEM.

NOTE: IF TRENCH IS USED CALL FOR INSPECTION BEFORE PLACING GRAVEL IN TRENCH.

NOTE: NO DRY WELL SHALL EXCEED 15 FOOT IN DIAMETER.

NOTE: ALL PIPE FROM HOUSE TO DISPOSAL AREA MUST BE CAST IRON.

PERMIT VOID AFTER THREE YEARS.

NOTE: INSTALL STAND PIPE ON SEPTIC TANK AND DRY WELL. STAND PIPES MUST BE 6 INCHES IN DIAMETER. CAST IRON, CONCRETE OR TERRA COTTA ACCEPTED.

***INSTALLER IS RESPONSIBLE FOR OBTAINING FINAL APPROVAL ON THIS PERMIT.**

A 23908

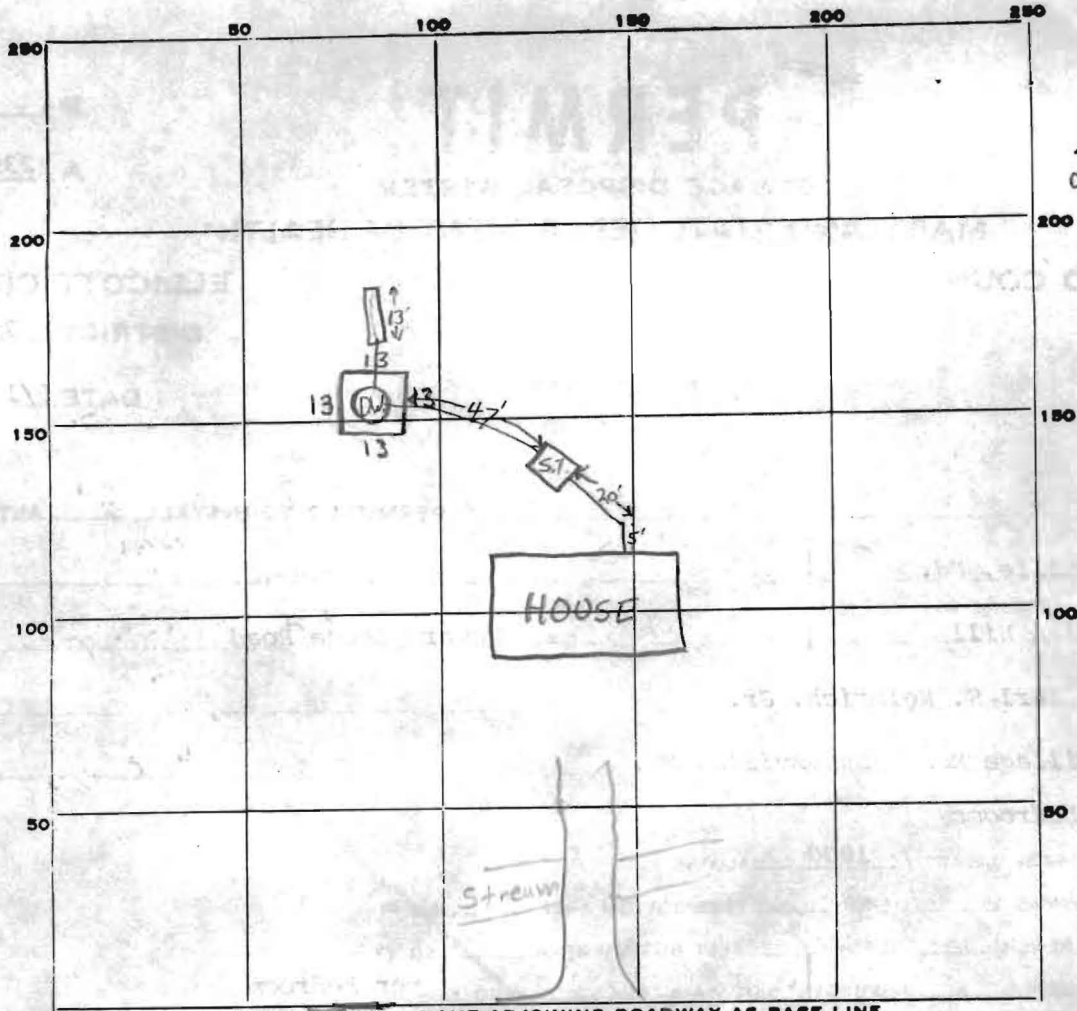

23908

52
 7
 364
 455

INDICATE NORTH. - NAME ADJOINING ROADWAY AS BASE LINE.

Howard Lodge Rd.

PERMIT CARD

SEPTIC TANK, LEVEL

S.T.	D.W.
<input checked="" type="checkbox"/>	<input checked="" type="checkbox"/>

DISTRIBUTION BOX, LEVEL n.a.

TILE FIELD, DEPTH 10 FT. TRENCH WIDTH 2 FT.

GRAVEL DEPTH 7 1/2 FT. TOTAL LENGTH 13 FT.

NUMBER OF TRENCHES 1 TOTAL BOTTOM AREA 91 1/2

SEEPAGE PITS, INSIDE DIAMETER 52 FT. DEPTH BELOW INLET 7 FT. Drywell abs. area 364

ABSORBENT AREA ±455 SQ. FT.

REMARKS: 5/19/78 13' long trench c gravel from 3' → 10' still need trench checked this a.m. has caved in, new trench to be dug. O.K. to install 10' orange clay stoneware in trench to check depth F.S.
 5/22/78 O.K. to corral work F.S.

DATE SYSTEM APPROVED 5/22/78

INSPECTOR F. Skinner