

LAYOUT _____ INSP 4 _____
INSP 2 11/2/04 INSP 5 _____
INSP 3 _____ INSP 6 _____

ISSUE DATE: 10/14/04

P 521533

APPROVAL DATE: 11/2/04

A REPAIR

PERMIT

TAX ID #04-319397

ON-SITE SEWAGE DISPOSAL SYSTEM HOWARD COUNTY HEALTH DEPARTMENT BUREAU OF ENVIRONMENTAL HEALTH

Fyock Septic Services IS PERMITTED TO INSTALL ALTER

ADDRESS: P. O. Box 89, Glenelg MD 21737 PHONE NUMBER: 410-988-9270

SUBDIVISION: _____ LOT NUMBER: _____

ADDRESS: 14564 Dorsey Mill Road PROPERTY OWNER: Chris Cunningham

SEPTIC TANK CAPACITY (GALLONS): 2000 ~~1500~~ OUTLET BAFFLE FILTER REQUIRED

PUMP CHAMBER CAPACITY (GALLONS): N/A **COMPARTMENTED TANK** REQUIRED

NUMBER OF BEDROOMS: 5

SQUARE FEET PER BEDROOM: _____

LINEAR FEET OF TRENCH REQUIRED: 100' HOUSE SERVED BY PUBLIC WATER

TRENCHES:	Trench to be 2.0 feet wide. Inlet 4.0 feet below original grade. Bottom maximum depth 10.0 feet below original grade. Effective area to be determined at layout, as well as number of feet of stone below distribution pipe.
LOCATION:	
NOTES:	Septic tank to be upgraded to 1500 gallon, pump & collapse old septic tank. Adding 100' of trench, no perc required due to vicinal testing conducted for proposed subdivision.

PLANS APPROVED: John A. Boris Reviewed by: _____ DATE: 10/12/04

NOTES: PERMIT VOID AFTER 2 YEARS
CONTRACTOR IS RESPONSIBLE FOR SCHEDULING A PRE-CONSTRUCTION INSPECTION FOR ALL INSTALLATIONS
WATERTIGHT SEPTIC TANKS REQUIRED
ALL PARTS OF SEPTIC SYSTEM SHALL BE 100 FEET FROM ANY WATER WELL UNLESS SPECIFICALLY AUTHORIZED
MANHOLE RISERS REQUIRED ON ALL SEPTIC TANKS AND PUMP CHAMBERS UNLESS SPECIFICALLY AUTHORIZED
CONTRACTOR RESPONSIBLE FOR COMPLIANCE WITH APPLICABLE REGULATIONS, GUIDELINES AND THE TERMS OF THIS PERMIT

NEITHER THE HOWARD COUNTY COUNCIL NOR THE HEALTH DEPARTMENT IS RESPONSIBLE FOR THE SUCCESSFUL OPERATION OF ANY SYSTEM
BUILDING PERMITTEE RESPONSIBLE FOR OBTAINING FINAL APPROVAL ON THIS PERMIT
AND RETURNED ALL 410-313-2640 FOR INSPECTION OF SEPTIC SYSTEM

511625 BA 153583-2 story Addition w/beam

P 521533

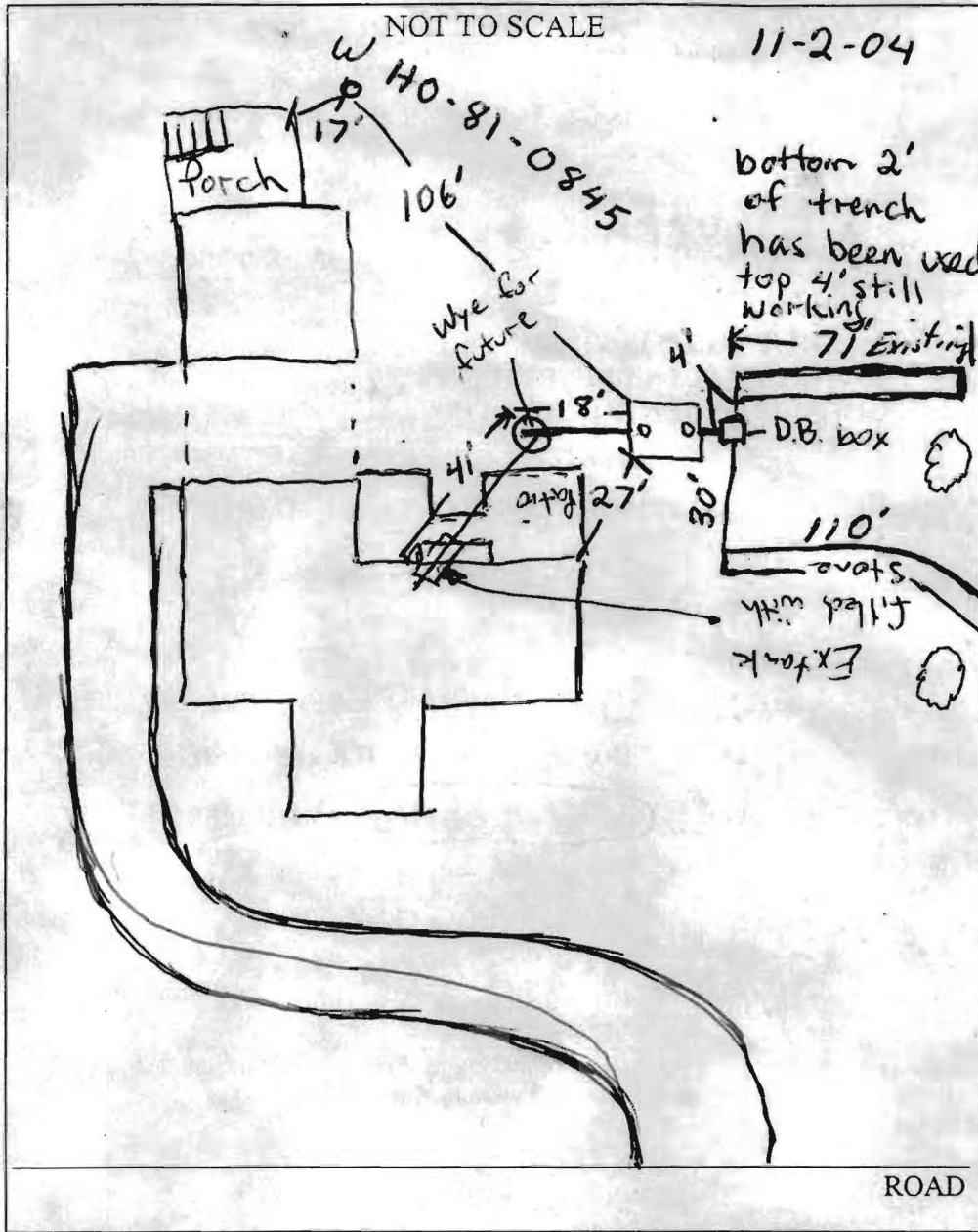

TRENCH/DRAINFIELD DATA		
WIDTH	INLET	BOTTOM
2'	4	10
NUMBER OF TRENCHES		2
TOTAL LENGTH		181'
ABSORPTION AREA		1086 sq
DISTRIBUTION BOX LEVEL		✓
DISTRIBUTION BOX BAFFLE		✓
DISTRIBUTION BOX PORT		—

SEPTIC TANK DATA	
SEPTIC TANK 1 LEVEL	✓
CAPACITY	2000 GAL
SEAM LOC	Top
TANK LID DEPTH	2'-6"
BAFFLES	✓
BAFFLE FILTER	NA
MANHOLE LOC	—
6" PORT LOC	Front & back
WATERTIGHT TEST	—
SEPTIC TANK 2 LEVEL	
CAPACITY	— GAL
SEAM LOC	—
TANK LID DEPTH	—
BAFFLES	—
BAFFLE FILTER	—
MANHOLE LOC	—
6" PORT LOC	—
WATERTIGHT TEST	—

PRE-CONSTRUCTION See file.

INSTALLATION 11/2/04 - Ex tank collapsed filled w/ground. New tank set, new trench installed, OK to cover (50)

FINAL INSPECTOR [Signature] DATE OF APPROVAL 11-2-04

AND RETURNED
BUILDING PERMIT SIGNED

