

3561 Conchita Drive

ready around 2:00
6/28/79

File

PERMIT

SEWAGE DISPOSAL SYSTEM
MARYLAND STATE DEPARTMENT OF HEALTH*

P 29941
A 13400

HOWARD COUNTY

ELLICOTT CITY

4/28/79
if not 6/28/79

DISTRICT 3rd.

INDEXED

DATE 6/21/79

Schisler

Robert L. Orndorff

IS PERMITTED TO INSTALL ALTER

ADDRESS 13938 Highland Rd., Clarksville, Md. 21029 PHONE 596-9394

SUBDIVISION Kingston ROAD Triadelphia Road LOT 12A

PROPERTY OWNER B & B Construction Co *Bernard Hill*

ADDRESS Box 117B - Elizebeth Rd., Pasadena, Md. 21122

SPECIFICATIONS 3 Bedrooms

SEPTIC TANK CAPACITY 1000 GALLONS

DRAIN FIELD _____ DEPTH _____ FEET, BOTTOM AREA _____ SQ. FT.

DEEP TRENCH _____ DEPTH _____ FEET, BOTTOM AREA _____ SQ. FT.

SEEPAGE PITS _____ ABSORBENT SIDE-WALL AREA 336 SQ. FT.

INLET PIPE 3 FT. BELOW ORIGINAL GRADE. MAXIMUM DEPTH 10 FT. BELOW ORIGINAL GRADE

EFFECTIVE DEPTH AT _____ FT. BELOW ORIGINAL GRADE.

LOCATE DISPOSAL AREA _____ FT. FROM _____ LOT LINE AND _____ FT. FROM _____ LOT LINE AS SEEN WHEN

FACING LOT FROM

Place dry well 65 feet from front lot line and 21 feet from left sideline as seen when

facing lot from the front.

PLANS APPROVED BY Donald W. Monaghan DATE 7/3/72

COVER NO WORK UNTIL INSPECTED AND APPROVED.

NEITHER THE HOWARD COUNTY COUNCIL NOR THE HEALTH DEPARTMENT IS RESPONSIBLE FOR THE SUCCESSFUL OPERATION OF ANY SYSTEM.

NOTE: IF TRENCH IS USED CALL FOR INSPECTION BEFORE PLACING GRAVEL IN TRENCH.

NOTE: NO DRY WELL SHALL EXCEED 16 FOOT IN DIAMETER.

NOTE: ALL PIPE FROM HOUSE TO DISPOSAL AREA MUST BE CAST IRON.

PERMIT VOID AFTER THREE YEARS.

NOTE: INSTALL STAND PIPE ON SEPTIC TANK AND DRY WELL. STAND PIPES MUST BE 8 INCHES IN DIAMETER. CAST IRON, CONCRETE OR TERRA

COTTA ACCEPTED.

*INSTALLER IS RESPONSIBLE FOR OBTAINING FINAL APPROVAL ON THIS PERMIT.

13400

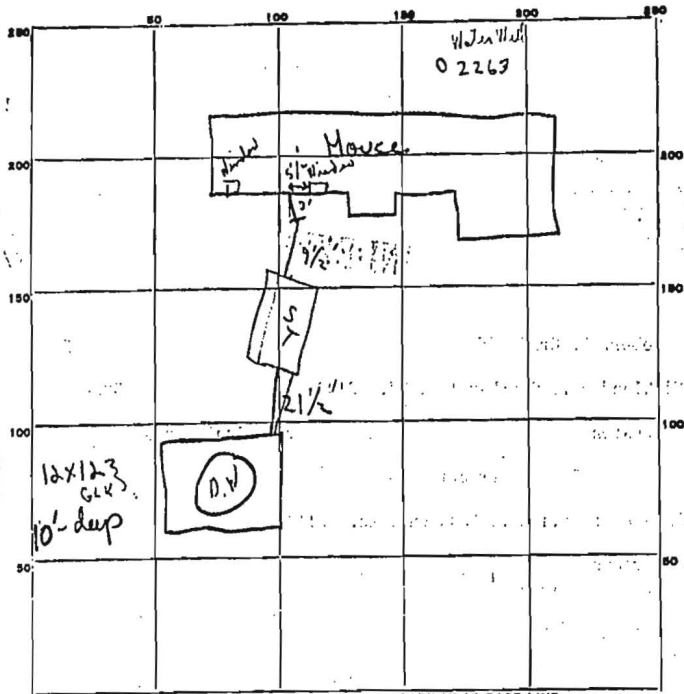

48
+1
336

INDICATE NORTH. - NAME ADJOINING ROADWAY AS BASE LINE.

PERMIT CARD 3561 - CONCHITA Tridelpna
 (Yes or entrance) ST DW
 SEPTIC TANK, LEVEL R CLEANOUTS ✓ ✓
 DISTRIBUTION BOX, LEVEL --- T.C. --- T.C. ---
 C.R. --- C.R. ---
 TILE FIELD, DEPTH --- FT. TRENCH WIDTH --- FT.
 GRAVEL DEPTH --- IN. TOTAL LENGTH --- FT.
 NUMBER OF TRENCHES --- TOTAL BOTTOM AREA ---
 SEEPAGE PITS, INSIDE DIAMETER 48 ± FT. DEPTH BELOW INLET 7 ± FT. 336
 ABSORBENT AREA 336 ± SQ. FT.

REMARKS 26 June 79 - Call for final when sewers, documents, 3 septic tank installed & when gravel level is downed (GLK) NOTE: 336 ft was indicated on permit not 360 ft. (GLK) 6/28/79 checked - found C.I. all the way to dry well. ✓ ok as of this date.
 C.B.V.

DATE SYSTEM APPROVED 6/28/79 as above INSPECTOR C.B. Theater