

11/4/75
around noon
if possible - trench inspection

PERMIT

P 22414

SEWAGE DISPOSAL SYSTEM

A 5 21925

MARYLAND STATE DEPARTMENT OF HEALTH

HOWARD COUNTY

ELLICOTT CITY

INDEXED

DISTRICT 2nd

DATE 10/28/75

11/5/75
after 12 noon

William R. Spicer (Roland Barch) IS PERMITTED TO INSTALL X ALTER

ADDRESS 4489 Centennial Lane, Ellicott City, Md. PHONE 465-6613

A SEWAGE DISPOSAL SYSTEM LOCATED AT _____

SUBDIVISION _____ ROAD 4489 Centennial Lane LOT _____

PROPERTY OWNER William R. Spicer

ADDRESS same as above

SPECIFICATIONS 3 bedrooms

DRAIN FIELD _____ DEPTH _____ FEET, BOTTOM AREA _____ SQ. FT.

SEEPAGE PITS _____ ABSORBENT SIDE-WALL AREA _____ SQ. FT.

SEPTIC TANK CAPACITY 1000 GALLONS

FOR GARBAGE GRINDER, INCREASE DISPOSAL AREA 22% & TANK CAPACITY 50%.

note: 10/3/75
D.W.

OTHER ~~DRY WELL AND~~ TRENCH - Inlet 4 ft. and maximum depth 10 ft., 300 sq. ft. absorbent sidewall area to be located 10 ft. from rear of lot and 35 ft. from right property line. 5 foot earth buffer between dry well and trench. Trench to be 20 ft. long to run 10 ft. from rear property line towards right property line. Inlet at 4 ft. maximum depth 10 ft. Call office for inspection of trench before pouring stone in trench.

NOTE: ALL PIPE FROM HOUSE TO DISPOSAL AREA MUST BE CAST IRON.
PERMIT VOID AFTER THREE YEARS. NOTE: INSTALL STAND PIPE ON SEPTIC TANK AND DRY WELL.
STAND PIPES MUST BE 6 INCHES IN DIAMETER. CAST IRON, CONCRETE OR TERRA COTTA ACCEPTED.

PLANS APPROVED BY David J. O'Neill DATE 8/11/75

FILL SEPTIC TANK AND DISTRIBUTION BOX WITH WATER BEFORE CALLING FOR AN INSPECTION. COVER NO WORK UNTIL INSPECTED AND APPROVED.

NEITHER THE HOWARD COUNTY COMMISSIONERS NOR THE HEALTH DEPARTMENT IS RESPONSIBLE FOR THE SUCCESSFUL OPERATION OF ANY SYSTEM.

BLDG. PERMIT SIGNED
AND RETURNED 11/4/75
Serial # 43335
Addition family Room

521925

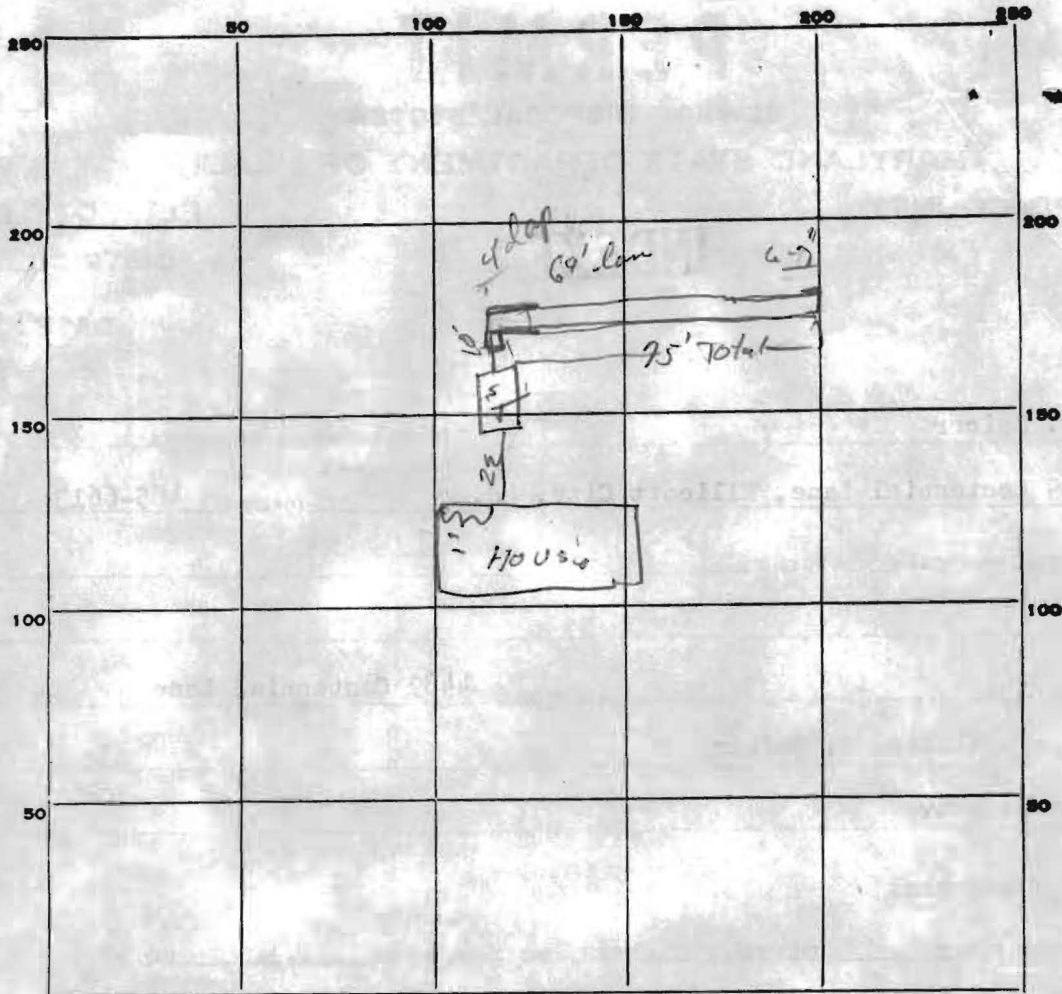

INDICATE NORTH. - NAME ADJOINING ROADWAY AS BASE LINE.

PERMIT CARD Final 11/5/55

SEPTIC TANK, LEVEL _____ CLEANOUTS ST

DISTRIBUTION BOX, LEVEL N/A

TILE FIELD, DEPTH 10-12 FT. TRENCH WIDTH 2 FT.

GRAVEL DEPTH 5' approx. IN. TOTAL LENGTH 25 FT.

NUMBER OF TRENCHES 1 TOTAL BOTTOM AREA 675'

SEEPAGE PITS, INSIDE DIAMETER NA FT. DEPTH BELOW INLET 164 FT.

ABSORBENT AREA 675' SQ. FT.

275
5
395

REMARKS Extend trench 5' deep - trench to be extended to 75' long.
Stone 4' from surface at inlet 6-7' at high end

DATE SYSTEM APPROVED 11/5/55 INSPECTOR M. J. O'Neil