



APPLICATION

FOR PERCOLATION TESTING AND SITE EVALUATION

TEST DATE(S) 9/12/03 TEST TIME 9:00 AP A 519559
 AGENCY REVIEW: _____ DATE 9/4/2003

DO NOT WRITE ABOVE THIS LINE

I HEREBY APPLY FOR THE NECESSARY TESTING/EVALUATION PRIOR TO ISSUANCE OF SEWAGE DISPOSAL SYSTEM PERMIT(S) TO:

- CHECK AS NEEDED:
- CONSTRUCT NEW SEPTIC SYSTEM(S)
 - REPAIR/ADD TO AN EXISTING SEPTIC SYSTEM
 - REPLACE AN EXISTING SEPTIC SYSTEM

- CHECK AS NEEDED:
- NEW STRUCTURE(S)
 - ADDITION TO AN EXISTING STRUCTURE
 - REPLACE AN EXISTING STRUCTURE

- CHECK ONE:
- CREATE NEW LOT(S)
 - BUILD ON AN EXISTING LOT IN A SUBDIVISION
 - BUILD ON AN EXISTING PARCEL OF RECORD

IS THE PROPERTY WITHIN 2500' OF ANY RESERVOIR?
 YES
 NO

THE TYPE OF STRUCTURE IS:
 RESIDENTIAL WITH SFD PROPOSED BEDROOMS IN THE COMPLETED STRUCTURE (NOTE **UNKNOWN** IF APPROPRIATE)
 COMMERCIAL (PROVIDE DETAIL OF NUMBERS AND TYPES OF EMPLOYEES/ CUSTOMERS ON ACCOMPANYING PLAN)
 INSTITUTIONAL/GOVERNMENT (PROVIDE DETAIL OF NUMBERS AND TYPES OF EMPLOYEES/USERS ON ACCOMPANYING PLAN)

PROPERTY OWNER(S) Chester Kukwa c/o Cindy DelZoppo - Long & Foster

DAYTIME PHONE _____ CELL 443-250-6395 FAX 410-730-8823

MAILING ADDRESS 12345 Wake Forest Road Ste F - Clarksville, MD 21029
STREET CITY/TOWN STATE ZIP

APPLICANT As Above

DAYTIME PHONE _____ CELL _____ FAX _____

MAILING ADDRESS _____ STREET CITY/TOWN STATE ZIP

APPLICANT'S ROLE: DEVELOPER BUILDER BUYER RELATIVE/FRIEND REALTOR CONSULTANT

PROPERTY LOCATION
SUBDIVISION/PROPERTY NAME Buckskin Woods LOT NO. 3

PROPERTY ADDRESS NW Side of Buckskin Lake Drive EC (A 33780)
STREET TOWN/POST OFFICE

TAX MAP PAGE(S) 22 GRID 21 PARCEL(S) 535 PROPOSED LOT SIZE 5.85Ac

AS APPLICANT, I UNDERSTAND THE FOLLOWING: THE SYSTEM INSTALLED SUBSEQUENT TO THIS APPLICATION IS ACCEPTABLE ONLY UNTIL PUBLIC SEWERAGE IS AVAILABLE. THIS APPLICATION IS COMPLETE WHEN ALL APPLICABLE FEES AND A SUITABLE SITE PLAN HAVE BEEN RECEIVED. I ACCEPT THE RESPONSIBILITY FOR COMPLIANCE WITH ALL M.O.S.H.A. AND "MISS UTILITY" REQUIREMENTS. APPROVAL IS BASED UPON SATISFACTORY REVIEW OF A PERC CERTIFICATION PLAN.

TEST RESULTS WILL BE MAILED TO APPLICANT. Cindy DelZoppo
SIGNATURE OF APPLICANT

HOWARD COUNTY HEALTH DEPARTMENT, BUREAU OF ENVIRONMENTAL HEALTH, WELL AND SEPTIC PROGRAM
 3525-H ELLICOTT MILLS DRIVE, ELLICOTT CITY, MARYLAND 21043-4544 (410) 313-1771 FAX (410) 313-2648
 TDD (410) 313-2323 TOLL FREE 1-877-4MD-DHMH

AP 119
 0 1' brn sacl lm
 3 3/4' brn micasa lm
 5 2' tan gray mica sand 25-30% Rk
 WEST 5 2' tan gray mica sand EAST
 9 30% 15-25% platy saprolite
 11 5-10% frags H. B.

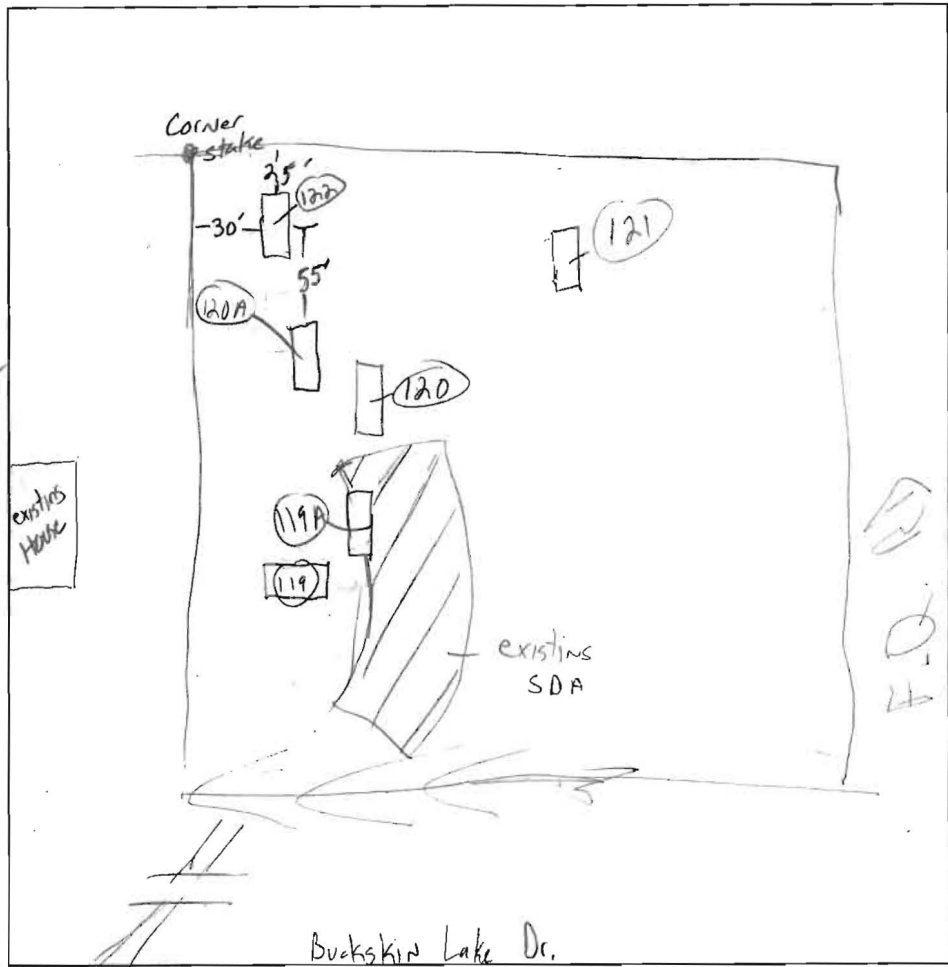

120A
 1' light brown tan sil
 Brown/tan sil
 3' sandy platy mica schist
 Brown/tan Black
 Rock > 50%
 - worse uphill -
 9 1/2' Rock Bottom

120
 1' Br. L
 tan/brown mica sil
 3 1/2' tan/brown gray mica schist sand
 4 1/2' Brown/gray tan mica schist platy
 40-55% Rock
 8 1/2' HARD BOT

121
 exact profile not obtained prior to backfill
 12' water

DATE	TEST #	DEPTH	START	BREAK 1" DROP	STOP 2" DROP	TIME OF 2nd INCH	P/F/H
10/8/03	119 M	7'	10:32:50	10:33:00	10:33:20	20 sec	F
	119 V	11'	10:37:15	10:37:43	10:38:15	30 sec	F
	120 V	8 1/2'					F
	m	5 1/2'	11:53:45	11:58	12:05	7 min	P
	122 V	9 1/2'					F
	m	6 1/2'	12:30:20	12:31:00	12:32:00	1 min	F
	120A V	9 1/2'	12:32:45	12:33:35	12:34:50	1 min 15 sec	F
	m	6 1/2'	1:22:05	1:22:35	1:23:10	45 sec	MARGINAL
	119A V	8'	1:23:25	1:24:05	1:25:10	1 min 5 sec	MARGINAL
	Hole under 1' x 1'	6 1/2'	1:31:10	1:32:00	1:33:20	1 min 20 sec	MARGINAL
	119A M	6 1/2'	1:37:10	1:38:05	1:39:50	1 min 45 sec	MARGINAL
	121 V	12'	H ₂ O @ 12'				F

119A
 tan/light brown sil
 3' gray/tan sand
 5' 50% Rock 20-25% Rock
 8' downhill

122
 3' light brown tan micans sil
 9 1/2' sandy platy mica schist/saprolite
 Brown/tan Black
 20-30% Rock worse on the uphill
 9 1/2' Hard Bottom

REMARKS **PROPOSAL FAILS - EX. SDA MINIMALLY ACCEPTABLE**
 SANITARIAN KB, MR BACKHOE _____ OTHERS _____
 TEST HOLES USED IN SDA — AVG. PERC TIME < 2 SQ. FT/BR 180 x 0.83
 TRENCH WIDTH 3 INLET DEPTH 1 MAX. BOT DEPTH 3 EFFECTIVE SW 1
 250'