

05373719

PUB. SEWER STATUS VERIFIED BY _____

ISSUE DATE: 12/11/04

P 521626

APPROVAL DATE: 2/1/05

A REPAIR

PERMIT INDEXED

ON-SITE SEWAGE DISPOSAL SYSTEM HOWARD COUNTY HEALTH DEPARTMENT BUREAU OF ENVIRONMENTAL HEALTH

Hatfields Equipment IS PERMITTED TO INSTALL ALTER

ADDRESS: 13785 Burntwoods Rd. PHONE NUMBER: (301) 854-6172

SUBDIVISION: _____ LOT NUMBER: 2

ADDRESS: 14054 Howard Road PROPERTY OWNER: Scoville

SEPTIC TANK CAPACITY (GALLONS): Existing

PUMP CHAMBER CAPACITY (GALLONS): N/A

NUMBER OF BEDROOMS: 3 4.5'-8.5'

SQUARE FEET PER BEDROOM: 210

LINEAR FEET OF TRENCH REQUIRED: 113+ 2-60' Trenches

TRENCHES:	Trench to be _____ feet wide. Inlet _____ feet below original grade. Bottom maximum depth _____ feet below original grade. Effective area begins at _____ feet below original grade. _____ feet of stone below distribution pipe.
LOCATION:	
PURPOSE:	Existing septic system has failed. Call for inspection when ground is opened so sanitarian can recommend repair.

PLANS APPROVED: _____ DATE: _____

- NOTE: PERMIT VOID AFTER 2 YEARS
- NOTE: CONTRACTOR RESPONSIBLE FOR SCHEDULING A PRE-CONSTRUCTION INSPECTION FOR ALL INSTALLATIONS
- NOTE: WATERTIGHT SEPTIC TANKS REQUIRED
- NOTE: ALL PARTS OF SEPTIC SYSTEM SHALL BE 100 FEET FROM ANY WATER WELL
- NOTE: MANHOLE RISERS REQUIRED ON ALL SEPTIC TANKS AND PUMP CHAMBERS

**NEITHER THE HOWARD COUNTY COUNCIL OR THE HEALTH DEPARTMENT IS
RESPONSIBLE FOR THE SUCCESSFUL OPERATION OF ANY SYSTEM
PERMITTEE RESPONSIBLE FOR OBTAINING FINAL APPROVAL ON THIS PERMIT
CALL 410-313-2640 FOR INSPECTION OF SEPTIC SYSTEM**

P521626

NOT TO SCALE

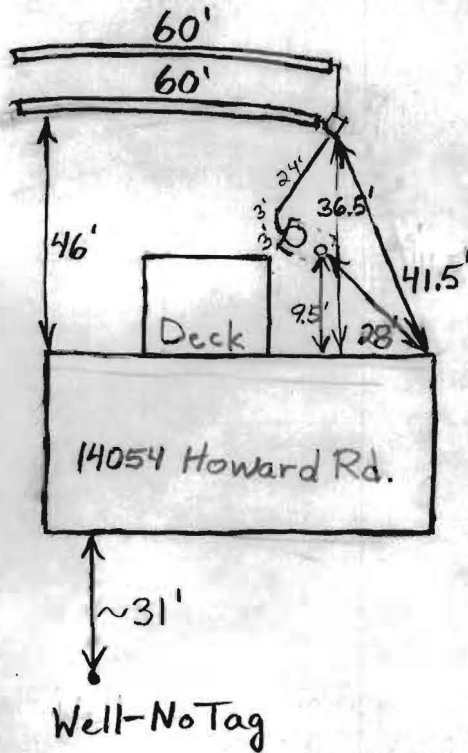

← To Howard Road

ROAD

TRENCH/DRAINFIELD DATA		
WIDTH	INLET	BOTTOM
2'	4.5'	8.5'
NUMBER OF TRENCHES		2
TOTAL LENGTH		120'
ABSORPTION AREA		480 sq. ft.
DISTRIBUTION BOX LEVEL		Levelers
DISTRIBUTION BOX BAFFLE		Yes
DISTRIBUTION BOX PORT		No

SEPTIC TANK DATA	
SEPTIC TANK 1 LEVEL _____	
CAPACITY	_____ GAL
SEAM LOC	Midseam
TANK LID DEPTH	3'-4'
BAFFLES	Yes
BAFFLE FILTER	No
MANHOLE LOC	Rear
6" PORT LOC	Front
WATERTIGHT TEST	No
SEPTIC TANK 2 LEVEL N/A	
CAPACITY	_____ GAL
SEAM LOC	_____
TANK LID DEPTH	_____
BAFFLES	_____
BAFFLE FILTER	_____
MANHOLE LOC	_____
6" PORT LOC	_____
WATERTIGHT TEST	_____

PRE-CONSTRUCTION _____

INSTALLATION 1/31/05 - 2/1/05 Trenches installed as planned. Manhole cleanout put on septic tank. Old drywell pumped out and filled with dirt. O.K. to cover everything. A perc test hole was dug because the file was misplaced. See the test sheet for more information (BB)

FINAL INSPECTOR B. Baker

DATE OF APPROVAL 2/1/05

20659

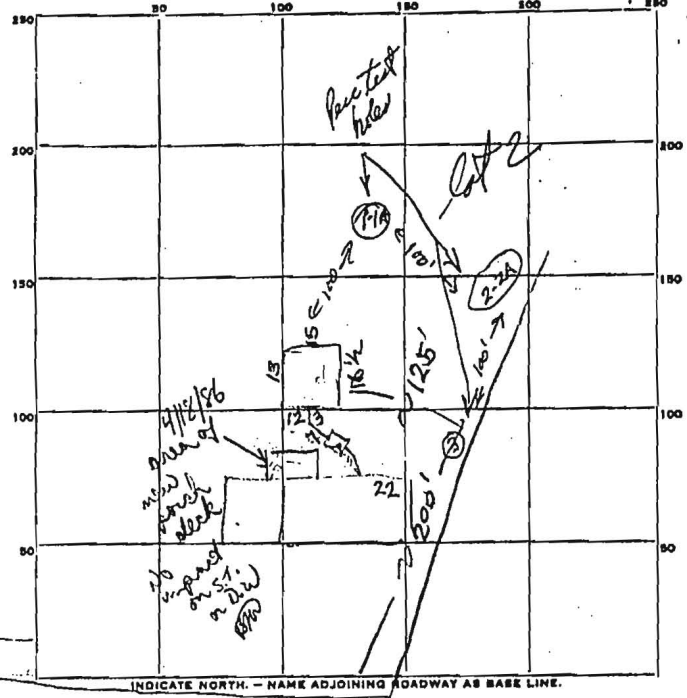

Row

INDICATE NORTH. - NAME ADJOINING ROADWAY AS BASE LINE.

PERMIT CARD present

SEPTIC TANK, LEVEL

CLEANOUTS 5r / dk
no / no

DISTRIBUTION BOX, LEVEL N/A

TILE FIELD, DEPTH _____ FT. TRENCH WIDTH _____ FT.

4 ³ 56.5
37 3.5
GRAVEL DEPTH _____ IN. TOTAL LENGTH _____ FT.

NUMBER OF TRENCHES _____ TOTAL BOTTOM AREA _____

SEEPAGE PITS, INSIDE DIAMETER perimeter 56 1/2 FT. DEPTH BELOW INLET ? FT.

ABSORBENT AREA 395.0 SQ. FT.

16 deep
3 inlet

REMARKS _____

DATE SYSTEM APPROVED _____ INSPECTOR _____

8/22/75
Randy

PERMIT

SEWAGE DISPOSAL SYSTEM

MARYLAND STATE DEPARTMENT OF HEALTH

HOWARD COUNTY

P 21562

A 20659

ELLICOTT CITY

DISTRICT 5th

DATE 5/2/75

INDEX

Souder Builders IS PERMITTED TO INSTALL ALTER
ADDRESS 14269 Triadelphia Mill Road, Dayton, Maryland PHONE 286-3408

A SEWAGE DISPOSAL SYSTEM LOCATED AT _____

SUBDIVISION _____ ROAD 14054 Howard Road LOT 2

PROPERTY OWNER Edwin G. Willson (Services)

ADDRESS Gilpin Road, Silver Spring, Md.

SPECIFICATIONS 3 bedrooms

DRAIN FIELD _____ DEPTH _____ FEET, BOTTOM AREA _____ SQ. FT.

SEEPAGE PITS _____ ABSORBENT SIDE-WALL AREA _____ SQ. FT.

SEPTIC TANK CAPACITY 1000 GALLONS

FOR GARBAGE GRINDER, INCREASE DISPOSAL AREA 22% & TANK CAPACITY 50%.

OTHER DRY WELL - 360 sq. ft. sidewall area below inlet. Dry well inlet to be 3 ft. deep and bottom of dry well to be 10 ft. deep. Place the dry well 125 ft. from the lot line which is 477.92 ft. long and 200 ft. from the lot line which is 674.96 ft. long. Trench approved but call Mr. Hodges if trench system wanted.

NOTE: ALL PIPE FROM HOUSE TO DISPOSAL AREA MUST BE CAST IRON, PERMIT VOID AFTER THREE YEARS.

NOTE: INSTALL STAND PIPE ON SEPTIC TANK AND DRY WELL. STAND PIPES MUST BE 6 INCHES IN DIAMETER. CAST IRON, CONCRETE OR TERRA COZZTA ACCEPTED.

PLANS APPROVED BY Raymond Hodges DATE 3/4/75

FILL SEPTIC TANK AND DISTRIBUTION BOX WITH WATER BEFORE CALLING FOR AN INSPECTION. COVER ND WORK UNTIL INSPECTED AND APPROVED.

NEITHER THE HOWARD COUNTY COMMISSIONERS NOR THE HEALTH DEPARTMENT IS RESPONSIBLE FOR THE SUCCESSFUL OPERATION OF ANY SYSTEM.

BLDG. PERMIT SIGNED
AND RETURNED 7/2/75
Serial # 69490
Sam dech

A 20659