

12/14/04

12/15/04

03293483

PUB. SEWER STATUS VERIFIED BY _____

ISSUE DATE: 12/13/04

P 521619

APPROVAL DATE: 12/15/04

PERMIT INDEXED

A REPAIR

ON-SITE SEWAGE DISPOSAL SYSTEM HOWARD COUNTY HEALTH DEPARTMENT BUREAU OF ENVIRONMENTAL HEALTH

Fogles Septic Clean, Inc IS PERMITTED TO INSTALL ALTER

ADDRESS: 580 Obrecht Road, Sykesville PHONE NUMBER: 410-795-5670

SUBDIVISION: _____ LOT NUMBER: _____

ADDRESS: 12510 Frederick Road PROPERTY OWNER: William Stiles

SEPTIC TANK CAPACITY (GALLONS): _____

PUMP CHAMBER CAPACITY (GALLONS): _____

NUMBER OF BEDROOMS: _____

SQUARE FEET PER BEDROOM: _____

LINEAR FEET OF TRENCH REQUIRED: _____

TRENCHES:	Trench to be _____ feet wide. Inlet _____ feet below original grade. Bottom maximum depth _____ feet below original grade. Effective area begins at _____ feet below original grade. _____ feet of stone below distribution pipe.
LOCATION:	_____
PURPOSE:	Existing septic has collapsed. Tank to be replaced. Call for inspection when ground is opened so sanitarian can recommend repair.

PLANS APPROVED: _____ DATE: _____

- NOTE: PERMIT VOID AFTER 2 YEARS
- NOTE: CONTRACTOR RESPONSIBLE FOR SCHEDULING A PRE-CONSTRUCTION INSPECTION FOR ALL INSTALLATIONS
- NOTE: WATERTIGHT SEPTIC TANKS REQUIRED
- NOTE: ALL PARTS OF SEPTIC SYSTEM SHALL BE 100 FEET FROM ANY WATER WELL
- NOTE: MANHOLE RISERS REQUIRED ON ALL SEPTIC TANKS AND PUMP CHAMBERS

**NEITHER THE HOWARD COUNTY COUNCIL OR THE HEALTH DEPARTMENT IS
RESPONSIBLE FOR THE SUCCESSFUL OPERATION OF ANY SYSTEM
PERMITTEE RESPONSIBLE FOR OBTAINING FINAL APPROVAL ON THIS PERMIT
CALL 410-313-2640 FOR INSPECTION OF SEPTIC SYSTEM**

P 521619

NOT TO SCALE

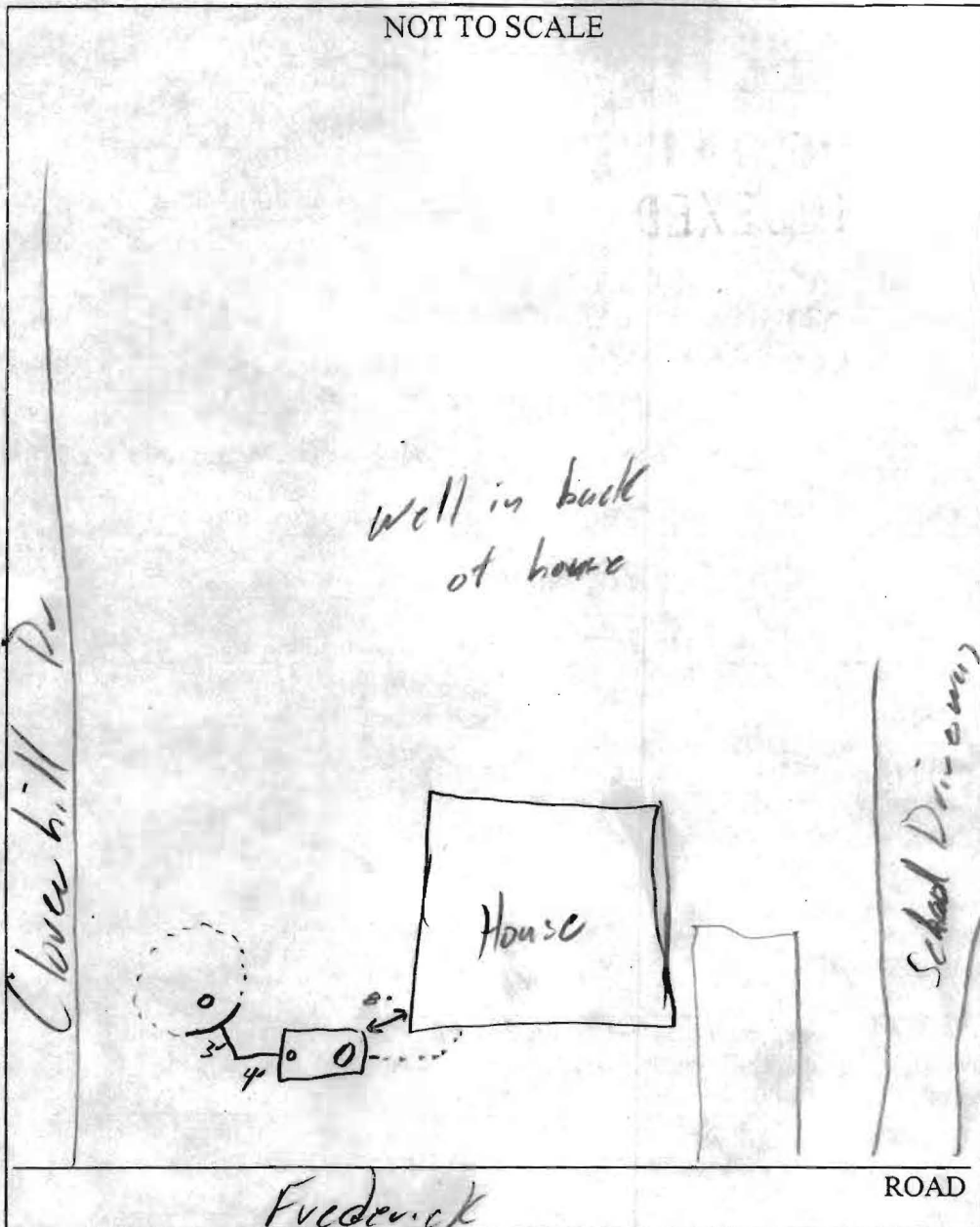

TRENCH/DRAINFIELD DATA

WIDTH _____ INLET _____ BOTTOM _____
Ex. Dry Well

NUMBER OF TRENCHES _____

TOTAL LENGTH _____ 2' below

ABSORPTION AREA _____ Inlet

DISTRIBUTION BOX LEVEL _____

DISTRIBUTION BOX BAFFLE _____

DISTRIBUTION BOX PORT _____

SEPTIC TANK DATA

SEPTIC TANK 1 LEVEL _____

loop CAPACITY 1500 GAL

SEAM LOC Top

TANK LID DEPTH 2'

BAFFLES _____

BAFFLE FILTER _____

MANHOLE LOC Front

6" PORT LOC Back

WATERTIGHT TEST _____

SEPTIC TANK 2 LEVEL _____

CAPACITY _____ GAL

SEAM LOC _____

TANK LID DEPTH _____

BAFFLES N/A

BAFFLE FILTER _____

MANHOLE LOC _____

6" PORT LOC _____

WATERTIGHT TEST _____

PRE-CONSTRUCTION 12/14/04 - Not ready (S)

INSTALLATION 12/15/04 - New tank set, old metal tank pumped & removed. Tied into dry well that is completely dry. OK to cover (S)

FINAL INSPECTOR [Signature] DATE OF APPROVAL 12/15/04

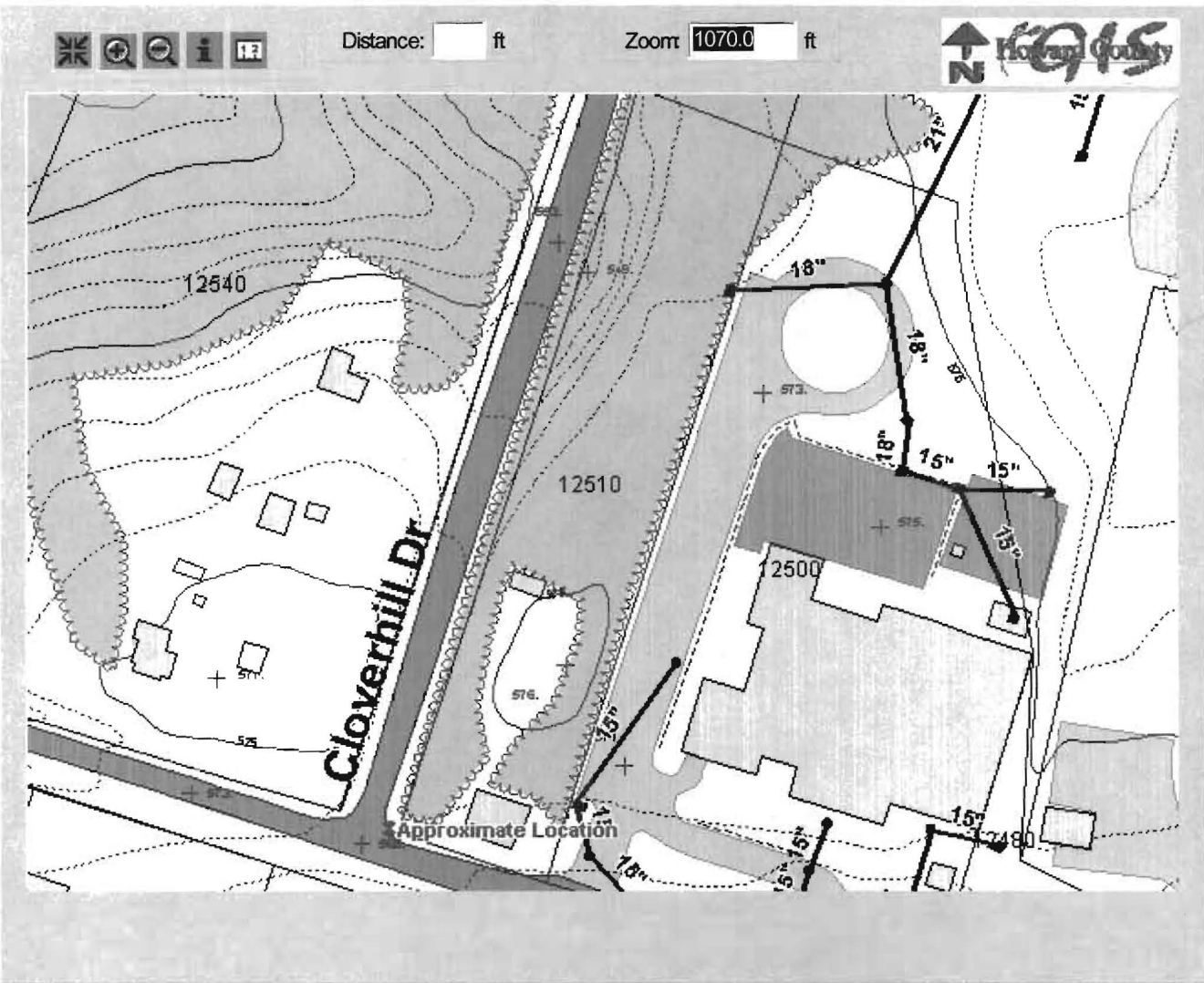
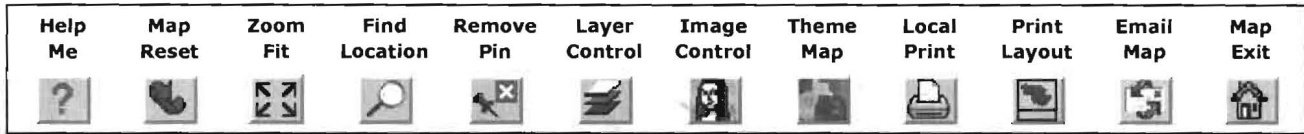

Disclaimer: Howard County, Maryland assumes no responsibility for the accuracy of this map or the information contained herein or derived therefrom. The buyer and/or user assumes all risks and liabilities whatsoever resulting from or arising out of the use of this map. There are no oral agreements or warranties relating to this sale and/or use of this map.

Tuesday, December 14 2004 | 10:37:31 AM | @692

Map Legends

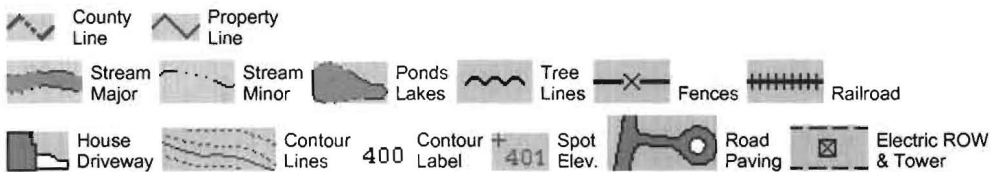

Property Information



Sanitary Sewer



12510 Fred Rd

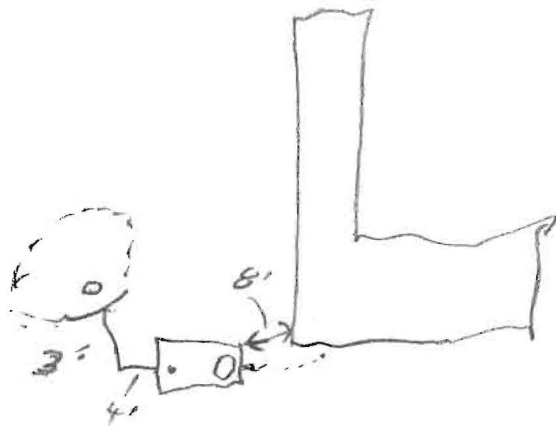

Fred Rd

Comp 1500 TS
2' Deep

Dry well Dry
7' Deep