

8/12/04 - 10.30 @ 2:30

PUB. SEWER STATUS VERIFIED BY _____

ISSUE DATE: 8/6/04

P 520765

APPROVAL DATE: 8/12/04

PERMIT INDEXED

A REPAIR

ON-SITE SEWAGE DISPOSAL SYSTEM HOWARD COUNTY HEALTH DEPARTMENT BUREAU OF ENVIRONMENTAL HEALTH

K & K Excavating IS PERMITTED TO INSTALL ALTER

ADDRESS: 15882 Frederick Road, Lisbon, MD 21765 PHONE NUMBER: 410-442-1336

SUBDIVISION: Moorestfield LOT NUMBER: 6-A

ADDRESS: 7534 Cherry Tree Drive PROPERTY OWNER: Calvin Fry

SEPTIC TANK CAPACITY (GALLONS): CAVE IN 1000 gall, replace w/ 1250 gallon

PUMP CHAMBER CAPACITY (GALLONS): N/A

NUMBER OF BEDROOMS: 4

SQUARE FEET PER BEDROOM: 210 @ inlet, 180 in tx zone $\frac{180 \times 4}{2} \times .31 = 111'$

LINEAR FEET OF TRENCH REQUIRED: 110'

TRENCHES:	Trench to be 2 feet wide. Inlet 4 feet below original grade. Bottom maximum depth 9 feet below original grade. Effective area begins at 4 feet below original grade. 5 feet of stone below distribution pipe.
LOCATION:	REPLACE Ex S.T. - No deeper than 3', Pump & cave in ex. dry wells. Run 2-55' long trenches on contour starting in vicinity of perc hole A - SEE PERC NOTES
PURPOSE:	Existing septic system has failed. Call for inspection when ground is opened so sanitarian can recommend repair.

PLANS APPROVED: Kacie Noonan DATE: 8/9/04

- NOTE: PERMIT VOID AFTER 2 YEARS
- NOTE: CONTRACTOR RESPONSIBLE FOR SCHEDULING A PRE-CONSTRUCTION INSPECTION FOR ALL INSTALLATIONS
- NOTE: WATERTIGHT SEPTIC TANKS REQUIRED
- NOTE: ALL PARTS OF SEPTIC SYSTEM SHALL BE 100 FEET FROM ANY WATER WELL
- NOTE: MANHOLE RISERS REQUIRED ON ALL SEPTIC TANKS AND PUMP CHAMBERS

NEITHER THE HOWARD COUNTY COUNCIL OR THE HEALTH DEPARTMENT IS RESPONSIBLE FOR THE SUCCESSFUL OPERATION OF ANY SYSTEM PERMITTEE RESPONSIBLE FOR OBTAINING FINAL APPROVAL ON THIS PERMIT CALL 410-313-2640 FOR INSPECTION OF SEPTIC SYSTEM

P 520765

NOT TO SCALE

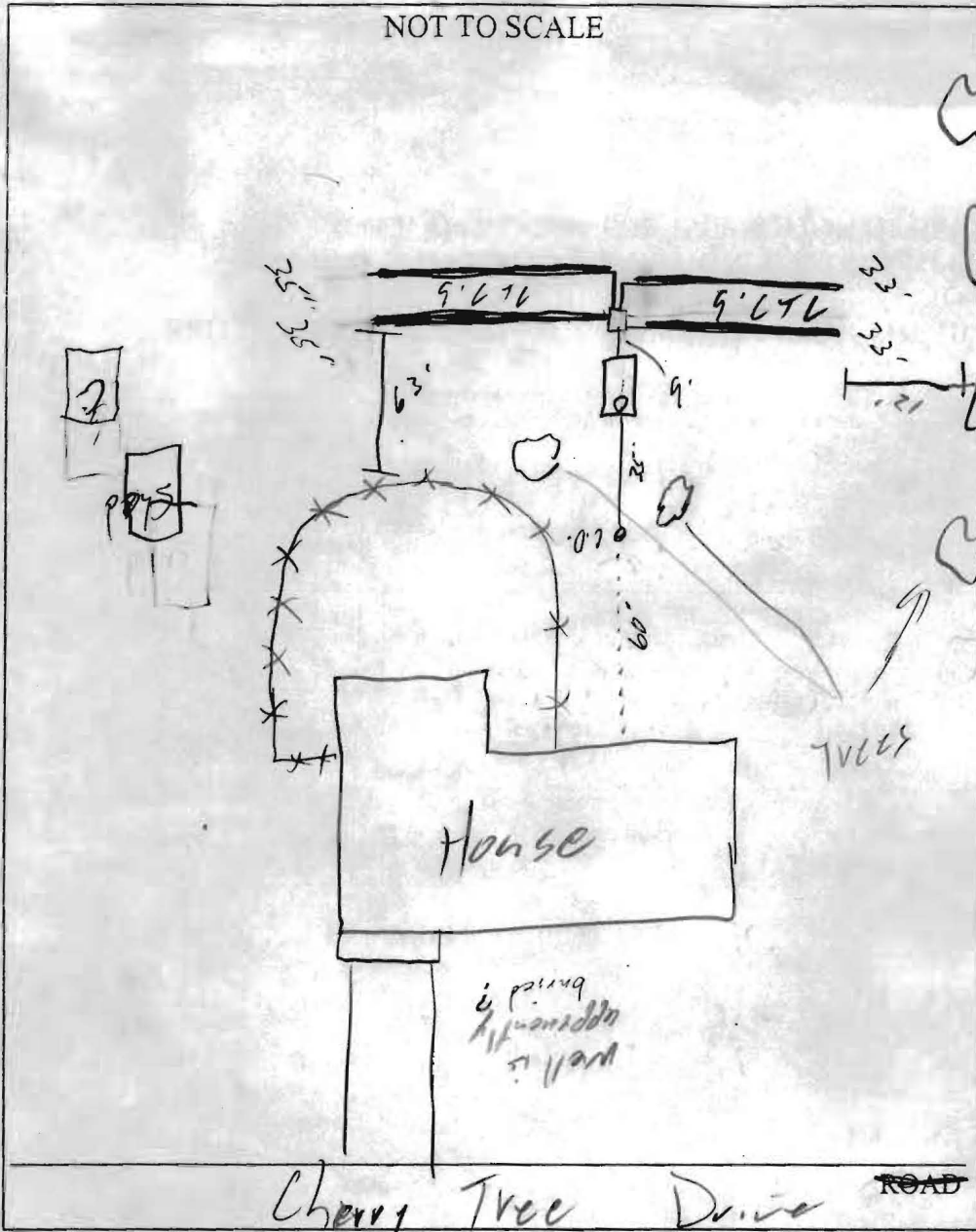

TRENCH/DRAINFIELD DATA		
WIDTH	INLET	BOTTOM
2'	4'	9'
NUMBER OF TRENCHES		4
TOTAL LENGTH		136'
ABSORPTION AREA		680 sq
DISTRIBUTION BOX LEVEL		<input checked="" type="checkbox"/>
DISTRIBUTION BOX BAFFLE		<input checked="" type="checkbox"/>
DISTRIBUTION BOX PORT		<input checked="" type="checkbox"/>

SEPTIC TANK DATA	
SEPTIC TANK 1 LEVEL	<input checked="" type="checkbox"/>
CAPACITY	1500 GAL
SEAM LOC	Top
TANK LID DEPTH	2-3'
BAFFLES	<input checked="" type="checkbox"/>
BAFFLE FILTER	<input checked="" type="checkbox"/>
MANHOLE LOC	Front
6" PORT LOC	<input checked="" type="checkbox"/>
WATERTIGHT TEST	<input checked="" type="checkbox"/>
SEPTIC TANK 2 LEVEL	
CAPACITY	_____ GAL
SEAM LOC	_____
TANK LID DEPTH	_____
BAFFLES	N/A
BAFFLE FILTER	N/A
MANHOLE LOC	_____
6" PORT LOC	_____
WATERTIGHT TEST	_____

PRE-CONSTRUCTION _____

INSTALLATION 8/12/04 - ST and (2) D.W. pumped, collapsed & abandoned. ST w/ stone. Complete system installed. OK to cover all work (SC)

FINAL INSPECTOR *[Signature]*

DATE OF APPROVAL 8/12/04