

LAYOUT 7/21/04-11A INSP 4 \_\_\_\_\_  
 INSP 2 \_\_\_\_\_ INSP 5 \_\_\_\_\_  
 INSP 3 \_\_\_\_\_ INSP 6 \_\_\_\_\_

ISSUE DATE: 7/15/2004

P 520781

APPROVAL DATE: 7/22/04

**PERMIT**  
 TAX ID # 05-367190  
**INDEXED**

A UPGRADE

**ON-SITE SEWAGE DISPOSAL SYSTEM  
 HOWARD COUNTY HEALTH DEPARTMENT  
 BUREAU OF ENVIRONMENTAL HEALTH**

Hatfields Equipment IS PERMITTED TO INSTALL  ALTER

ADDRESS: 13785 Burntwoods Rd., Glenelg PHONE NUMBER: 410-531-6773

SUBDIVISION: \_\_\_\_\_ LOT NUMBER: \_\_\_\_\_

ADDRESS: 5250 Greenbridge Road PROPERTY OWNER: John & Terri Taylor

SEPTIC TANK CAPACITY (GALLONS): 1500 OUTLET BAFFLE FILTER REQUIRED

PUMP CHAMBER CAPACITY (GALLONS): N/A COMPARTMENTED TANK REQUIRED

NUMBER OF BEDROOMS: 5 After addition is completed

SQUARE FEET PER BEDROOM: 210

LINEAR FEET OF TRENCH REQUIRED: 215 <sup>2</sup> 210 HOUSE SERVED BY PUBLIC WATER

TRENCHES:	Trench to be <u>2.0</u> feet wide. Inlet 3.0 feet below original grade. Bottom maximum depth <u>6.5</u> feet below original grade. Effective area begins at 3.0 feet below original grade. <u>3.0</u> feet of stone below distribution pipe.
LOCATION:	In support of proposed building permit adding two bedrooms. Adding a 500 gallon septic tank and connecting to existing 1000 gallon septic tank. Drywell to be pumped and collapsed. Distribution box and two 87' trenches to be installed.
NOTES:	<u>9' CYC (3) 70' Trenches</u>

PLANS APPROVED: Kevin Bell Reviewed by: \_\_\_\_\_ DATE: 6/24/04

NOTES: PERMIT VOID AFTER 2 YEARS  
 CONTRACTOR IS RESPONSIBLE FOR SCHEDULING A PRE-CONSTRUCTION INSPECTION FOR ALL INSTALLATIONS  
 WATERTIGHT SEPTIC TANKS REQUIRED  
 ALL PARTS OF SEPTIC SYSTEM SHALL BE 100 FEET FROM ANY WATER WELL UNLESS SPECIFICALLY AUTHORIZED  
 MANHOLE RISERS REQUIRED ON ALL SEPTIC TANKS AND PUMP CHAMBERS UNLESS SPECIFICALLY AUTHORIZED  
 CONTRACTOR RESPONSIBLE FOR COMPLIANCE WITH APPLICABLE REGULATIONS, GUIDELINES AND THE TERMS OF THIS PERMIT

**NEITHER THE HOWARD COUNTY COUNCIL NOR THE HEALTH DEPARTMENT IS RESPONSIBLE FOR THE SUCCESSFUL OPERATION OF ANY SYSTEM PERMITTEE RESPONSIBLE FOR OBTAINING FINAL APPROVAL ON THIS PERMIT**  
 BUILDING PERMIT SIGNED

**AND RETURNED**  
10-22-04 1300150831-46 LP TANK

P 520781

NOT TO SCALE

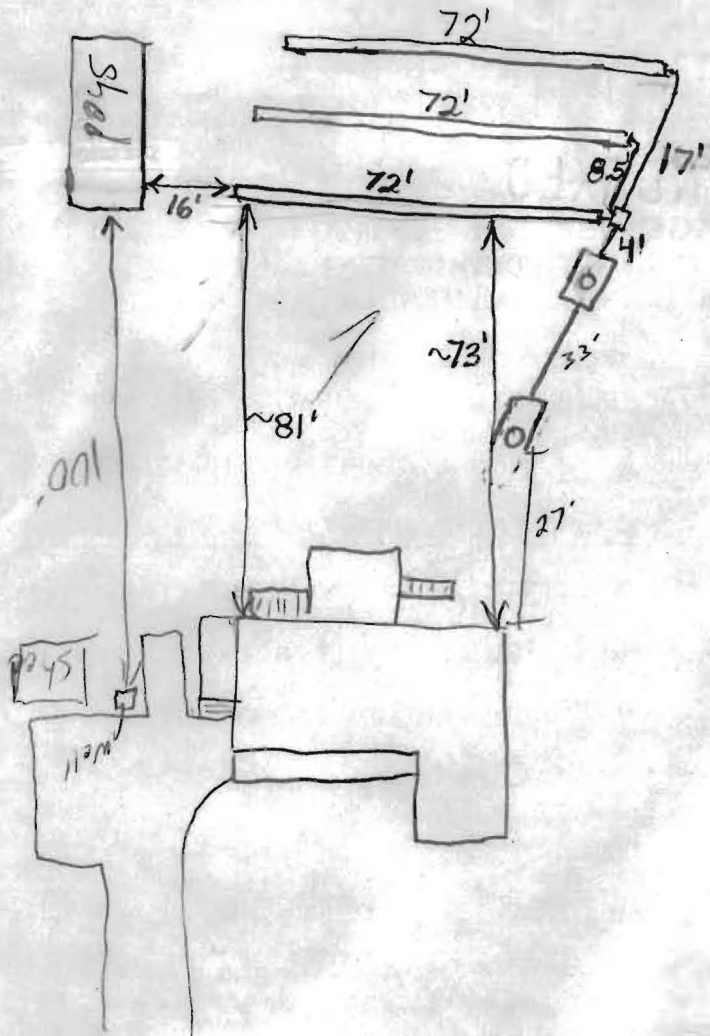

TRENCH/DRAINFIELD DATA		
WIDTH	INLET	BOTTOM
2'	3'	6.5'
NUMBER OF TRENCHES		3
TOTAL LENGTH		216
ABSORPTION AREA		648 + Bottom
DISTRIBUTION BOX LEVEL		Yes
DISTRIBUTION BOX BAFFLE		Yes
DISTRIBUTION BOX PORT		No

SEPTIC TANK DATA	
SEPTIC TANK 1 LEVEL	<input checked="" type="checkbox"/>
CAPACITY	Ex 1000 GAL
SEAM LOC	Mid
TANK LID DEPTH	4'
BAFFLES	<input checked="" type="checkbox"/>
BAFFLE FILTER	<input type="checkbox"/>
MANHOLE LOC	Center
6" PORT LOC	<input type="checkbox"/>
WATERTIGHT TEST	<input checked="" type="checkbox"/>
SEPTIC TANK 2 LEVEL	<input checked="" type="checkbox"/>
CAPACITY	500 GAL
SEAM LOC	Top
TANK LID DEPTH	1'
BAFFLES	<input checked="" type="checkbox"/>
BAFFLE FILTER	<input type="checkbox"/>
MANHOLE LOC	Center
6" PORT LOC	<input type="checkbox"/>
WATERTIGHT TEST	<input type="checkbox"/>

PRE-CONSTRUCTION 7/21/04 - New tank set. Cont. measured well/radiant at front of lower shed, leave only 70' for trench. Re-spaced trench to accommodate spacing (SS) 7/22/04 End of top trench near shed is off contour. Running uphill, lower trenches more on contour. O.K. to cover everything, (BB)

FINAL INSPECTOR B. Baker DATE OF APPROVAL 7/22/04

BUILDING PERMIT SIGNED AND RETURNED

SITE INSPECTION SHEET

OWNER: \_\_\_\_\_ PHONE #: \_\_\_\_\_  
ADDRESS: 5250 green Bridge Rd. CONTRACTOR: \_\_\_\_\_  
WELL TAG #: 73-3794  
SUBDIVISION: \_\_\_\_\_ LOT: \_\_\_\_\_ COUNTY #: \_\_\_\_\_  
PROPOSAL: 2 Bedroom addition

LOCATION DIAGRAM

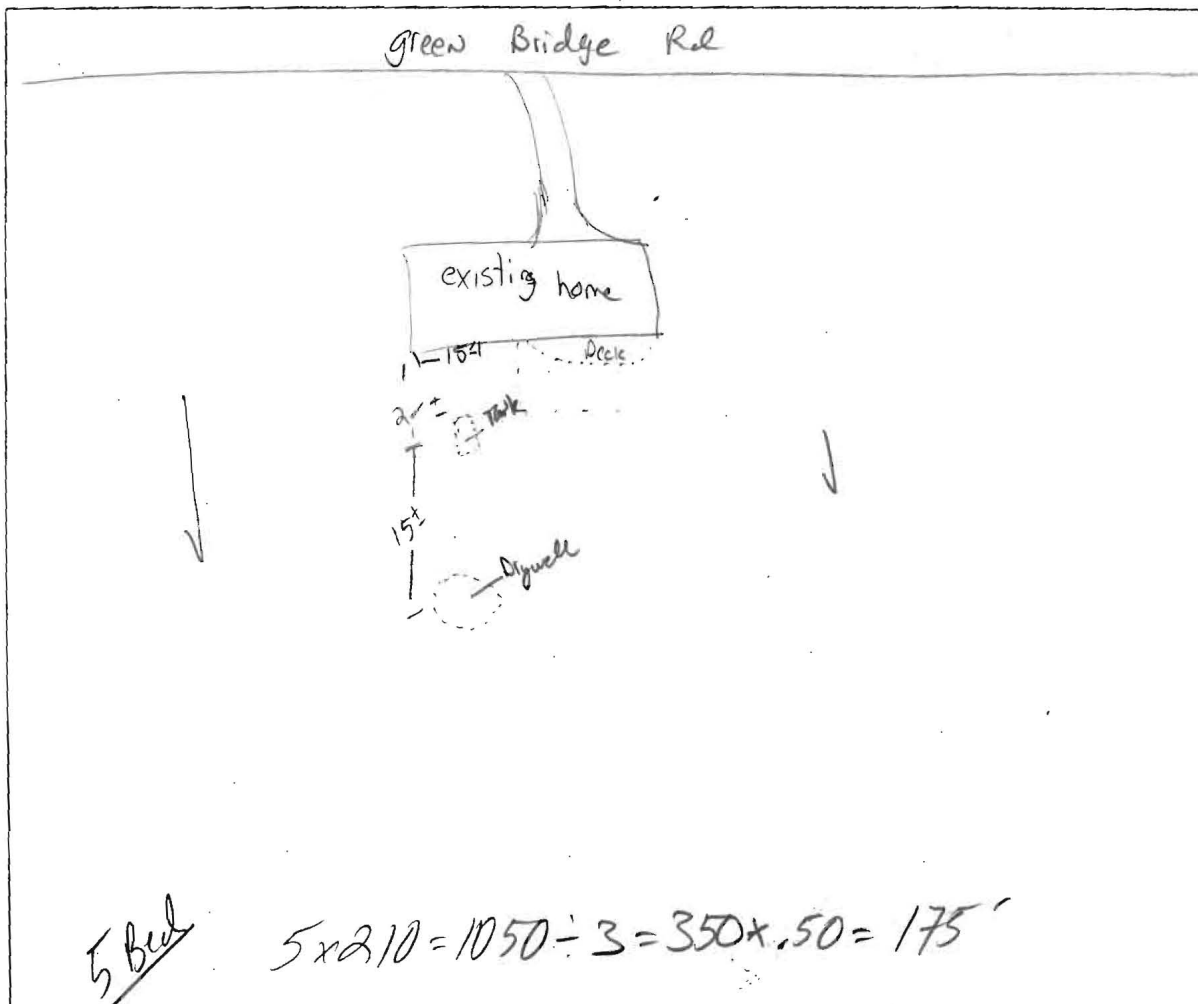

Specs - Inlet at 3' = Bottom at 6' = Effective Area 3' - 3' of stone - 3' wide

COMMENTS: told him that adding 2 new Bedrooms you need 1500 gal tank he is going to get a 500 gal + connect to existing system. After talking w/ John, he is going to not use existing dywell + use a d-box and trenches. - hand Auger used -

DATE: 6/1/04 INSPECTOR: K. Bell

