

8/18/04 9:30

PUB. SEWER STATUS VERIFIED BY _____

ISSUE DATE: 8/9/04

P 520816-A

APPROVAL DATE: 9/1/04

PERMIT INDEXED

A REPAIR

ON-SITE SEWAGE DISPOSAL SYSTEM HOWARD COUNTY HEALTH DEPARTMENT BUREAU OF ENVIRONMENTAL HEALTH

Fyock Septic Service IS PERMITTED TO INSTALL ALTER

ADDRESS: P. O. Box 89, Glenelg 21737 PHONE NUMBER: 410-988-9270

SUBDIVISION: Flamewood LOT NUMBER: ~~20~~ 3?

ADDRESS: 75/2 ~~200~~ Flamewood Drive PROPERTY OWNER: Timothy Barila

SEPTIC TANK CAPACITY (GALLONS): Existing *6'-7' for safety.*

PUMP CHAMBER CAPACITY (GALLONS): N/A *12' Depth*

NUMBER OF BEDROOMS: 4 *3' Wide*

SQUARE FEET PER BEDROOM: 180

LINEAR FEET OF TRENCH REQUIRED: 150

TRENCHES:	Trench to be _____ feet wide. Inlet _____ feet below original grade. Bottom maximum depth _____ feet below original grade. Effective area begins at _____ feet below original grade. _____ feet of stone below distribution pipe.
LOCATION:	
PURPOSE:	Existing septic system has failed. Call for inspection when ground is opened so sanitarian can recommend repair.

PLANS APPROVED: _____ DATE: _____

- NOTE: PERMIT VOID AFTER 2 YEARS
- NOTE: CONTRACTOR RESPONSIBLE FOR SCHEDULING A PRE-CONSTRUCTION INSPECTION FOR ALL INSTALLATIONS
- NOTE: WATERTIGHT SEPTIC TANKS REQUIRED
- NOTE: ALL PARTS OF SEPTIC SYSTEM SHALL BE 100 FEET FROM ANY WATER WELL
- NOTE: MANHOLE RISERS REQUIRED ON ALL SEPTIC TANKS AND PUMP CHAMBERS

NEITHER THE HOWARD COUNTY COUNCIL OR THE HEALTH DEPARTMENT IS RESPONSIBLE FOR THE SUCCESSFUL OPERATION OF ANY SYSTEM PERMITTEE RESPONSIBLE FOR OBTAINING FINAL APPROVAL ON THIS PERMIT CALL 410-313-2640 FOR INSPECTION OF SEPTIC SYSTEM

P520816-A

NOT TO SCALE

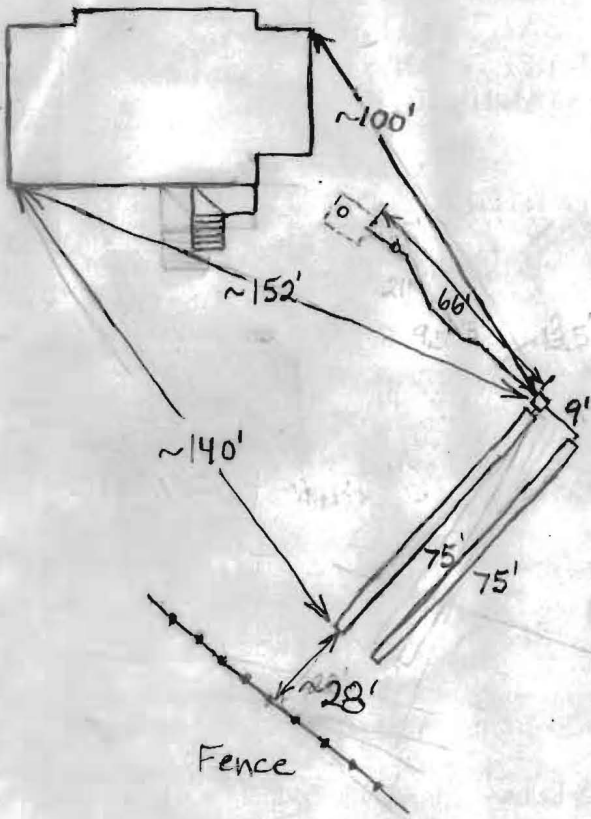

ROAD

TRENCH/DRAINFIELD DATA		
WIDTH	INLET	BOTTOM
3'	6.5'-7'	12'
NUMBER OF TRENCHES		2
TOTAL LENGTH		150'
ABSORPTION AREA		450 + Sidewalk
DISTRIBUTION BOX LEVEL		Yes
DISTRIBUTION BOX BAFFLE		Yes
DISTRIBUTION BOX PORT		No

SEPTIC TANK DATA	
SEPTIC TANK 1 LEVEL	Existing
CAPACITY	_____ GAL
SEAM LOC	_____
TANK LID DEPTH	_____
BAFFLES	_____
BAFFLE FILTER	_____
MANHOLE LOC	_____
6" PORT LOC	_____
WATERTIGHT TEST	_____
SEPTIC TANK 2 LEVEL	N/A
CAPACITY	_____ GAL
SEAM LOC	_____
TANK LID DEPTH	_____
BAFFLES	_____
BAFFLE FILTER	_____
MANHOLE LOC	_____
6" PORT LOC	_____
WATERTIGHT TEST	_____

PRE-CONSTRUCTION 8/18/04 To install 2-75' trenches downhill of the existing system. Abandon, pump out and fill the drywell (BB)

INSTALLATION 8/31/04 One trench done. (BB) 9/1/04 System finished. O.K. to cover. Drywell pumped out and filled in with dirt (BB)

FINAL INSPECTOR B. Baker DATE OF APPROVAL 9/1/04