

LAYOUT _____ INSP 4 _____
 INSP 2 _____ INSP 5 _____
 INSP 3 _____ INSP 6 _____

05-397812

ISSUE DATE: 8/17/2004

P 520831

APPROVAL DATE: 10/13/04

A UPGRADE

PERMIT INDEXED

ON-SITE SEWAGE DISPOSAL SYSTEM HOWARD COUNTY HEALTH DEPARTMENT BUREAU OF ENVIRONMENTAL HEALTH

Fyock Septic Service IS PERMITTED TO INSTALL ALTER

ADDRESS: P.O Box 89, Glenelg, MD 21737 PHONE NUMBER: _____

SUBDIVISION: _____ LOT NUMBER: _____

ADDRESS: 7167 Pindell School Road PROPERTY OWNER: Richard Allison

SEPTIC TANK CAPACITY (GALLONS): 1500 ? OUTLET BAFFLE FILTER REQUIRED

~~PUMP CHAMBER CAPACITY~~ (GALLONS): 1500 COMPARTMENTED TANK REQUIRED

NUMBER OF BEDROOMS: 10 *According to Homeowner Will be 10 → w/ Traffic-Bearing Tank*

SQUARE FEET PER BEDROOM: 160

LINEAR FEET OF TRENCH REQUIRED: 300

2-7.5

TRENCHES:	Trench to be <u>2</u> feet wide. Inlet <u>11.5-12</u> feet below original grade. Bottom maximum depth <u>4.5</u> feet below original grade. Effective area begins at <u>4.5</u> feet below original grade. feet of stone below distribution pipe.
LOCATION:	<u>Install (3) 100' trenches between the house & Pindell School Rd</u>
NOTES:	

PLANS APPROVED: [Signature]

DATE: 9/10/04

- NOTE: PERMIT VOID AFTER 2 YEARS
- NOTE: CONTRACTOR RESPONSIBLE FOR SCHEDULING A PRE-CONSTRUCTION INSPECTION FOR ALL INSTALLATIONS
- NOTE: WATERTIGHT SEPTIC TANKS REQUIRED
- NOTE: ALL PARTS OF SEPTIC SYSTEM SHALL BE 100 FEET FROM ANY WATER WELL
- NOTE: MANHOLE RISERS REQUIRED ON ALL SEPTIC TANKS AND PUMP CHAMBERS UNLESS SPECIFICALLY AUTHORIZED

NEITHER THE HOWARD COUNTY COUNCIL NOR THE HEALTH DEPARTMENT IS RESPONSIBLE FOR THE SUCCESSFUL OPERATION OF ANY SYSTEM PERMITTEE RESPONSIBLE FOR OBTAINING FINAL APPROVAL ON THIS PERMIT CALL 410-313-2640 FOR INSPECTION OF SEPTIC SYSTEM

P520831

NOT TO SCALE

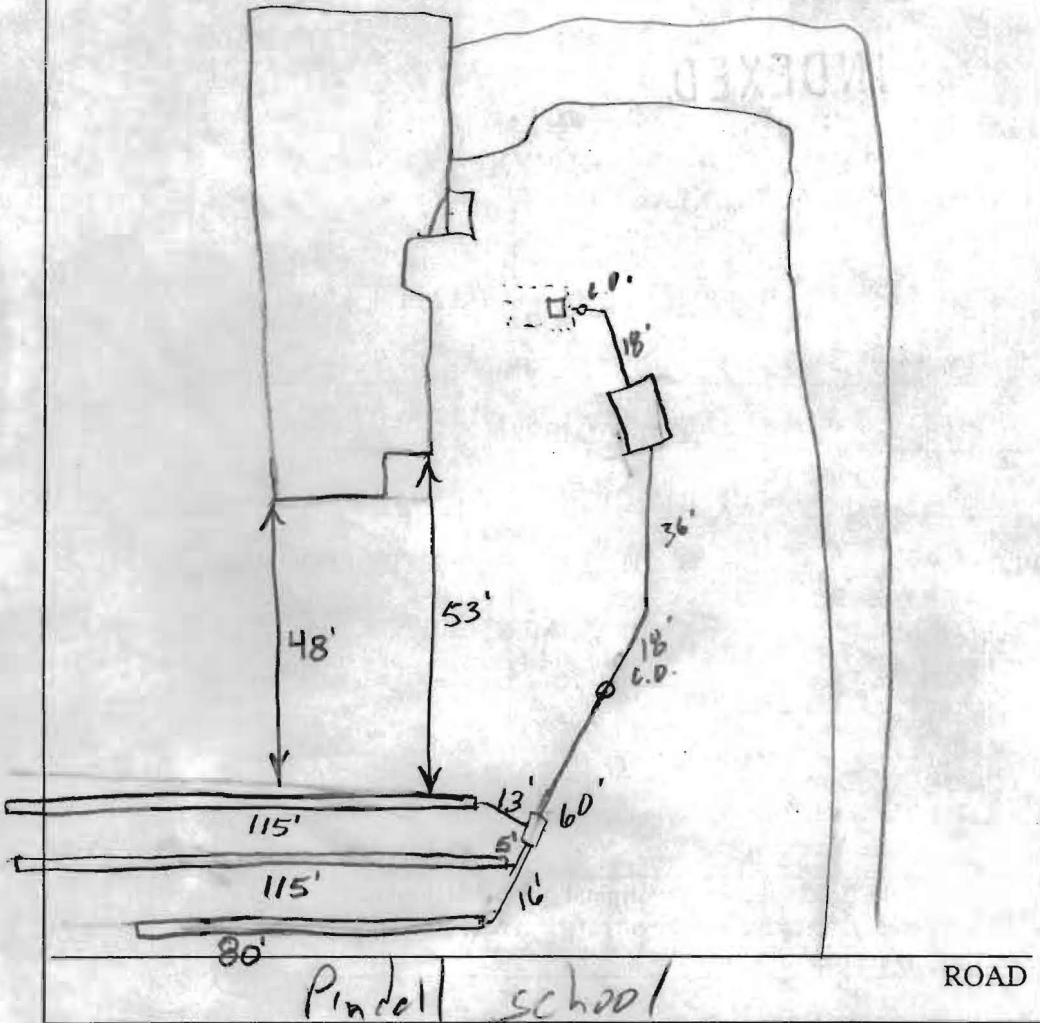

TRENCH/DRAINFIELD DATA		
WIDTH	INLET	BOTTOM
<u>2'</u>	<u>7'-7.5'</u>	<u>11.5'-12'</u>
NUMBER OF TRENCHES <u>3</u>		
TOTAL LENGTH <u>310'</u>		
ABSORPTION AREA <u>1395 sq. ft.</u>		
DISTRIBUTION BOX LEVEL <u>Yes</u>		
DISTRIBUTION BOX BAFFLE <u>Fall to Box</u>		
DISTRIBUTION BOX PORT <u>No ~ 1/16" Per Foot</u>		

SEPTIC TANK DATA	
SEPTIC TANK 1 LEVEL <input checked="" type="checkbox"/>	
T.B. CAPACITY	<u>1500</u> GAL
SEAM LOC	<u>Top</u>
TANK LID DEPTH	<u>2'</u>
BAFFLES	<input checked="" type="checkbox"/>
BAFFLE FILTER	<input type="checkbox"/>
MANHOLE LOC	<u>Front</u>
6" PORT LOC	<u>None</u>
WATERTIGHT TEST	<input checked="" type="checkbox"/>
SEPTIC TANK 2 LEVEL <input type="checkbox"/>	
CAPACITY	<u> </u> GAL
SEAM LOC	<u> </u>
TANK LID DEPTH	<u> </u>
BAFFLES	<u> </u>
BAFFLE FILTER	<u> </u>
MANHOLE LOC	<u> </u>
6" PORT LOC	<u> </u>
WATERTIGHT TEST	<u> </u>

PRE-CONSTRUCTION See prev sheet

INSTALLATION 10/12/04 - Tank set, gravity dist line run, D.B set, working on 1st trench so 10/12/04 is 90' of 1st trench dug (SD) 10/13/04 Both drywells were pumped out and filled in per contractor. System done O.K. to cover everything. (BB)

FINAL INSPECTOR B. Baber DATE OF APPROVAL 10/13/04