

PUB. SEWER STATUS VERIFIED BY _____

ISSUE DATE: 9/2/2004

P 520861

APPROVAL DATE: 9/16/04

A UPGRADE

PERMIT INDEXED

ON-SITE SEWAGE DISPOSAL SYSTEM HOWARD COUNTY HEALTH DEPARTMENT BUREAU OF ENVIRONMENTAL HEALTH

Hatfield's Equipment *(Paid by Acker Contracting, Inc.)* IS PERMITTED TO INSTALL ALTER

ADDRESS: 13785 Burntwoods Rd, Glenelg PHONE NUMBER: 410-531-6773

SUBDIVISION: Kingston LOT NUMBER: 3

ADDRESS: 3590 Conchita Drive PROPERTY OWNER: Juanita Conway

SEPTIC TANK CAPACITY (GALLONS): _____

PUMP CHAMBER CAPACITY (GALLONS): _____

NUMBER OF BEDROOMS: _____

SQUARE FEET PER BEDROOM: _____

LINEAR FEET OF TRENCH REQUIRED: _____

TRENCHES:	Trench to be _____ feet wide. Inlet _____ feet below original grade. Bottom maximum depth _____ feet below original grade. Effective area begins at _____ feet below original grade. _____ feet of stone below distribution pipe.
LOCATION:	
PURPOSE:	In support of BP #B00149516. Call for inspection when ground is opened so sanitarian can recommend repair.

PLANS APPROVED: _____ DATE: _____

- NOTE: PERMIT VOID AFTER 2 YEARS
- NOTE: CONTRACTOR RESPONSIBLE FOR SCHEDULING A PRE-CONSTRUCTION INSPECTION FOR ALL INSTALLATIONS
- NOTE: WATERTIGHT SEPTIC TANKS REQUIRED
- NOTE: ALL PARTS OF SEPTIC SYSTEM SHALL BE 100 FEET FROM ANY WATER WELL
- NOTE: MANHOLE RISERS REQUIRED ON ALL SEPTIC TANKS AND PUMP CHAMBERS

NEITHER THE HOWARD COUNTY COUNCIL OR THE HEALTH DEPARTMENT IS RESPONSIBLE FOR THE SUCCESSFUL OPERATION OF ANY SYSTEM PERMITTED RESPONSIBLE FOR OBTAINING FINAL APPROVAL ON THIS PERMIT CALL 410-313-2640 FOR INSPECTION OF SEPTIC SYSTEM

P520861

NOT TO SCALE

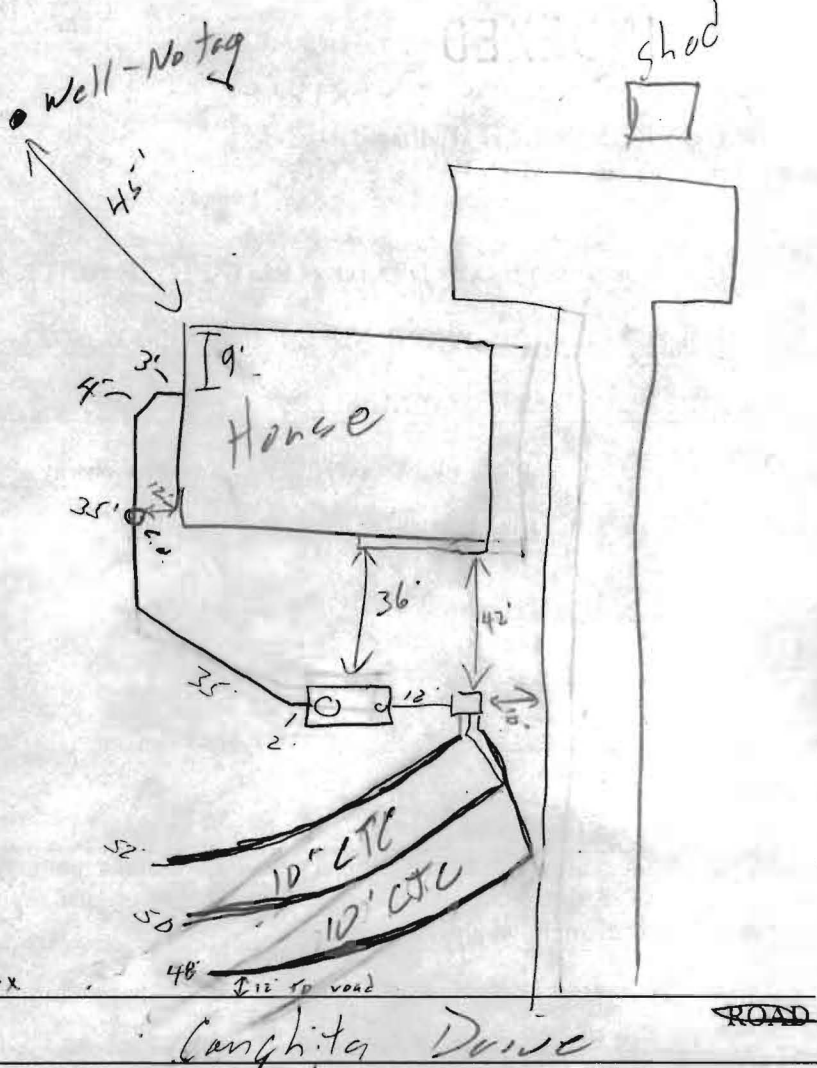

TRENCH/DRAINFIELD DATA		
WIDTH	INLET	BOTTOM
3	4	8
NUMBER OF TRENCHES		3
TOTAL LENGTH		150
ABSORPTION AREA		662
DISTRIBUTION BOX LEVEL		✓
DISTRIBUTION BOX BAFFLE		✓
DISTRIBUTION BOX PORT		—

SEPTIC TANK DATA	
SEPTIC TANK 1 LEVEL	✓
CAPACITY	2000 GAL
SEAM LOC	Top
TANK LID DEPTH	2-2.5'
BAFFLES	✓
BAFFLE FILTER	—
MANHOLE LOC	Front
6" PORT LOC	Back
WATERTIGHT TEST	—
SEPTIC TANK 2 LEVEL	—
CAPACITY	— GAL
SEAM LOC	—
TANK LID DEPTH	—
BAFFLES	—
BAFFLE FILTER	—
MANHOLE LOC	—
6" PORT LOC	—
WATERTIGHT TEST	—

PRE-CONSTRUCTION 8/19/04 - See pour test

INSTALLATION 9/15/04 - Tank set, house conn complete (SO)
9/16/04 - Trenches installed. OK to cover all work (SO)

FINAL INSPECTOR [Signature] DATE OF APPROVAL 9/16/04

PUB. SEWER STATUS VERIFIED BY _____

ISSUE DATE: 9/2/2004

PERMIT

P 520861

APPROVAL DATE: _____

A UPGRADE

ON-SITE SEWAGE DISPOSAL SYSTEM HOWARD COUNTY HEALTH DEPARTMENT BUREAU OF ENVIRONMENTAL HEALTH

Hatfield's Equipment IS PERMITTED TO INSTALL ALTER

ADDRESS: 13785 Burntwoods Rd, Glenelg PHONE NUMBER: 410-531-6773

SUBDIVISION: Kingston LOT NUMBER: 3

ADDRESS: 3590 Conchita Drive PROPERTY OWNER: Juanita Conway

SEPTIC TANK CAPACITY (GALLONS): 2000

PUMP CHAMBER CAPACITY (GALLONS): —

NUMBER OF BEDROOMS: 6

SQUARE FEET PER BEDROOM: 26'

LINEAR FEET OF TRENCH REQUIRED: 152

TRENCHES:	Trench to be <u>3</u> feet wide. Inlet <u>4</u> feet below original grade. Bottom maximum depth <u>8</u> feet below original grade. Effective area begins at <u>4</u> feet below original grade. <u>4</u> feet of stone below distribution pipe.
LOCATION:	
PURPOSE:	In support of BP #B00149516. Call for inspection when ground is opened so sanitarian can recommend repair.

PLANS APPROVED: KJR DATE: 9/7/04

- NOTE: PERMIT VOID AFTER 2 YEARS
- NOTE: CONTRACTOR RESPONSIBLE FOR SCHEDULING A PRE-CONSTRUCTION INSPECTION FOR ALL INSTALLATIONS
- NOTE: WATERTIGHT SEPTIC TANKS REQUIRED
- NOTE: ALL PARTS OF SEPTIC SYSTEM SHALL BE 100 FEET FROM ANY WATER WELL
- NOTE: MANHOLE RISERS REQUIRED ON ALL SEPTIC TANKS AND PUMP CHAMBERS

NEITHER THE HOWARD COUNTY COUNCIL OR THE HEALTH DEPARTMENT IS RESPONSIBLE FOR THE SUCCESSFUL OPERATION OF ANY SYSTEM PERMITTEE RESPONSIBLE FOR OBTAINING FINAL APPROVAL ON THIS PERMIT CALL 410-313-2640 FOR INSPECTION OF SEPTIC SYSTEM

Conway Res.
3590 Conchita Dr.
Ellicott City 21042

Drain + collapse
Exist Tank +
drywell

