

PUB. SEWER STATUS VERIFIED BY \_\_\_\_\_

ISSUE DATE: \_\_\_\_\_

APPROVAL DATE: \_\_\_\_\_

# PERMIT INDEXED

P 520425-C

A RE-INDEX

## ON-SITE SEWAGE DISPOSAL SYSTEM HOWARD COUNTY HEALTH DEPARTMENT BUREAU OF ENVIRONMENTAL HEALTH

TAX ID# 04-336178

IS PERMITTED TO INSTALL  ALTER

ADDRESS: \_\_\_\_\_ PHONE NUMBER: \_\_\_\_\_

SUBDIVISION: Lisbon Acres LOT NUMBER: 14

ADDRESS: 1216 Round Gate Court PROPERTY OWNER: \_\_\_\_\_

SEPTIC TANK CAPACITY (GALLONS): \_\_\_\_\_

PUMP CHAMBER CAPACITY (GALLONS): \_\_\_\_\_

NUMBER OF BEDROOMS: \_\_\_\_\_

SQUARE FEET PER BEDROOM: \_\_\_\_\_

LINEAR FEET OF TRENCH REQUIRED: \_\_\_\_\_

TRENCHES:	Trench to be _____ feet wide. Inlet _____ feet below original grade. Bottom maximum depth _____ feet below original grade. Effective area begins at _____ feet below original grade. _____ feet of stone below distribution pipe.
LOCATION:	
PURPOSE:	Reindex file 7/30/04

PLANS APPROVED: \_\_\_\_\_ DATE: \_\_\_\_\_

- NOTE: PERMIT VOID AFTER 2 YEARS
- NOTE: CONTRACTOR RESPONSIBLE FOR SCHEDULING A PRE-CONSTRUCTION INSPECTION FOR ALL INSTALLATIONS
- NOTE: WATERTIGHT SEPTIC TANKS REQUIRED
- NOTE: ALL PARTS OF SEPTIC SYSTEM SHALL BE 100 FEET FROM ANY WATER WELL
- NOTE: MANHOLE RISERS REQUIRED ON ALL SEPTIC TANKS AND PUMP CHAMBERS

**NEITHER THE HOWARD COUNTY COUNCIL OR THE HEALTH DEPARTMENT IS  
RESPONSIBLE FOR THE SUCCESSFUL OPERATION OF ANY SYSTEM  
PERMITTEE RESPONSIBLE FOR OBTAINING FINAL APPROVAL ON THIS PERMIT  
CALL 410-313-2640 FOR INSPECTION OF SEPTIC SYSTEM  
BUILDING PERMIT SIGNED**

**AND RETURNED**

6/25/2004 B00148729 SUNROOM, DECK  
9-29-04 B00150443-46 PROPANE TANK  
EXPAND MASTER BR

P520425-C

SITE INSPECTION SHEET

OWNER: \_\_\_\_\_ PHONE #: \_\_\_\_\_  
 ADDRESS: 1216 Roundgate CT CONTRACTOR: \_\_\_\_\_  
WOODBINE MD WELL TAG #: \_\_\_\_\_  
 SUBDIVISION: Lisbon Acres LOT: 14 COUNTY #: \_\_\_\_\_  
 PROPOSAL: Identify septic system functioning

LOCATION DIAGRAM

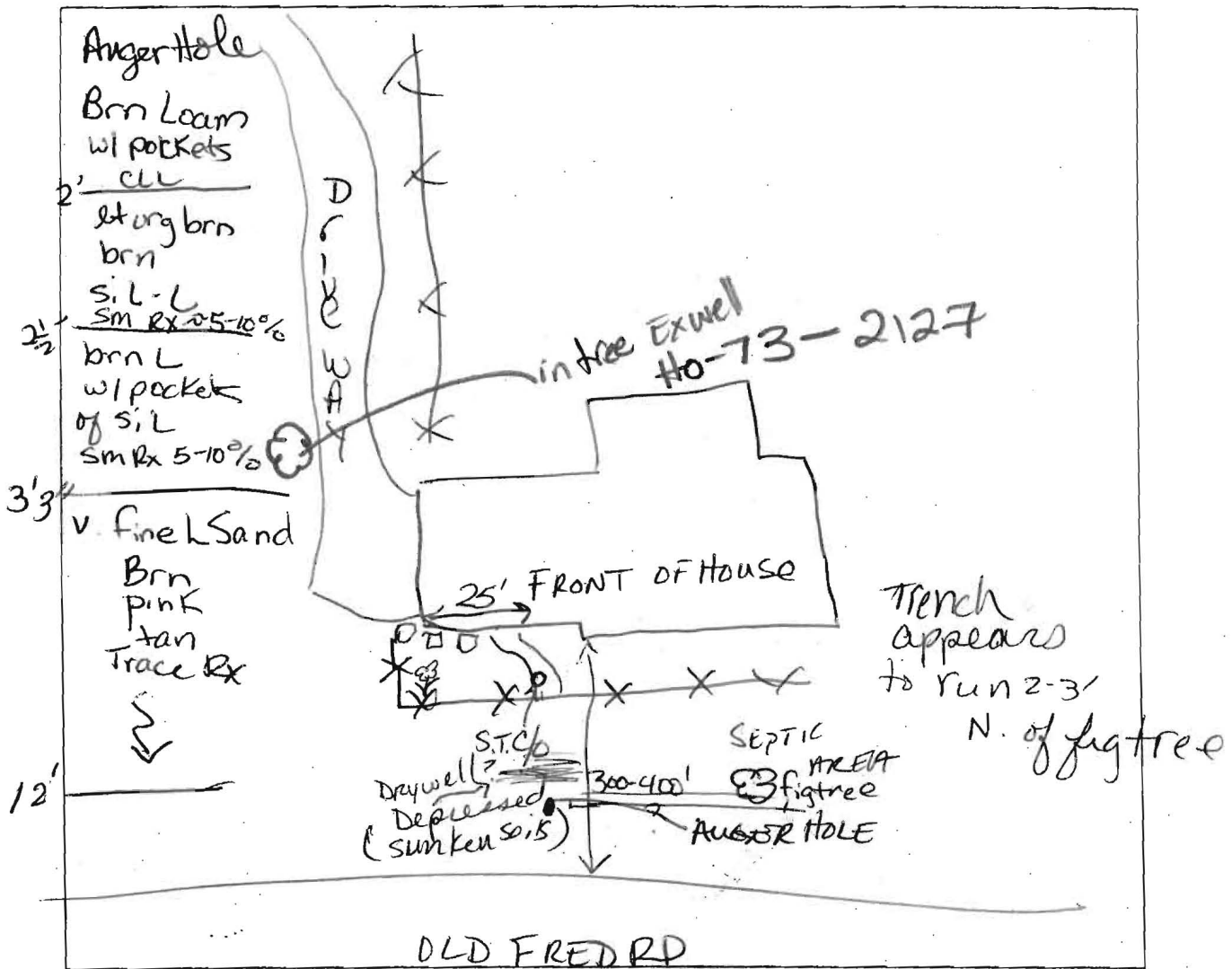

COMMENTS: Septic tank full of sludge. Spoke w/ Mrs. about having it pumped. Dropped pebble - fell 3 1/2-4" "plop" on top of solid, not scum. Saw water & soap come from house into S.T., over solid layer & left (into dry well)

DATE: 6/25/04 INSPECTOR: Kacie Noonan