

APPLICATION

A 10413

SEWAGE DISPOSAL TESTING

P _____

MARYLAND STATE DEPARTMENT OF HEALTH

HOWARD COUNTY *750 gal. for 3 bedrooms*

ELLICOTT CITY

Septic tank 1,000 " " " " "

DISTRICT 3

Drywell - 100 sq. ft. absorbent sidewalk area below inlet pipe per bedroom

DATE 1/28/65

Inlet pipe to be 4 ft. below original grade no deeper than

Locate drywell 75 ft. from front lot line and 60' from right side line as lot is seen when facing it from Evergreen Way.

TO: THE COUNTY HEALTH OFFICER
ELLICOTT CITY, MARYLAND

I, HEREBY, APPLY FOR THE NECESSARY TESTS IN ORDER TO CONSTRUCT (OR RECONSTRUCT) A SEWAGE DISPOSAL SYSTEM.

PROPERTY OWNER Carwell, Inc.

ADDRESS 172 Chatham Rd., E. C. PHONE MC 5-2677

PROPERTY LOCATION:

SUBDIVISION Green Range LOT NO. 7, 312

ROAD AND DESCRIPTION Evergreen Way

OCCUPANT _____ PHONE _____

PERSON TO CONSTRUCT SYSTEM _____

ADDRESS _____ PHONE _____

SIZE OF LOT 150' x 132' x 102' x 163' x 207' TYPE BLDG. 3 or 4
NUMBER OF BEDROOMS

IF NOT SINGLE RESIDENCE DESCRIBE _____

SIGNATURE OF APPLICANT /s/ Mr. Rosch

APPROVED BY _____ FOR _____ DATE _____
(KIND OF SYSTEM)

REJECTED BY _____ FOR _____ DATE _____
(KIND OF SYSTEM)

HOLD PENDING FURTHER TESTS _____ DATE _____

REASONS FOR REJECTION OR HOLDING _____

THIS IS NOT A PERMIT

TRIDELPHIA R17

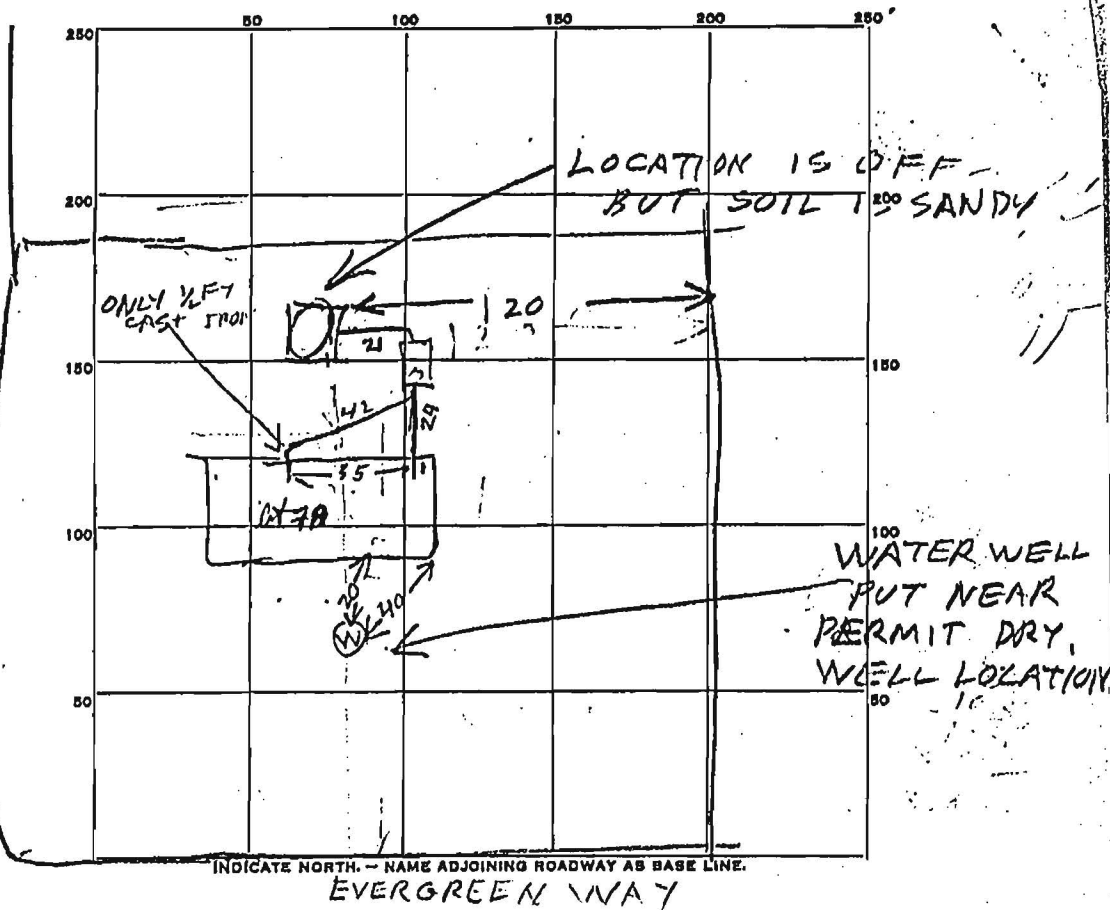

PERMIT CARD

SEPTIC TANK, LEVEL OK 1000 connect CLEANOUTS OK
 Top 1/2 FT. below grade
 DISTRIBUTION BOX, LEVEL _____

TILE FIELD, DEPTH _____ FT. TRENCH WIDTH _____ FT.

GRAVEL DEPTH _____ IN. TOTAL LENGTH _____ FT.

NUMBER OF TRENCHES _____ TOTAL BOTTOM AREA _____

SEEPAGE PITS, INSIDE DIAMETER 12 FT. DEPTH BELOW INLET 10.5 FT.

ABSORBENT AREA 380 SQ. FT. not counting stone

49
105
295
490
5145

REMARKS 7/7/66 245 - One well in pit is 4 1/2 FT
below grade. About 2 ft stone around
dry well. Therefore about 500 sq ft
side wall area counting stone
Must tell plumber and inspector that there is
only 1/2 FT cast iron house sewer or kitchen drain

DATE SYSTEM APPROVED 7/7/66 INSPECTOR Raymond Hodge
7/26/66 - Cast Iron Pipe Installed