

# APPLICATION

PERCOLATION TESTING

A \_\_\_\_\_

P \_\_\_\_\_

HOWARD COUNTY HEALTH DEPARTMENT  
BUREAU OF ENVIRONMENTAL HEALTH  
3525-H ELLICOTT MILLS DRIVE/ELLICOTT CITY, MARYLAND 21043  
TELEPHONE: 313-2640

DISTRICT \_\_\_\_\_

DATE \_\_\_\_\_

TO: THE COUNTY HEALTH OFFICER  
ELLICOTT CITY, MARYLAND

I HEREBY APPLY FOR THE NECESSARY TEST PRIOR TO APPLICATION FOR PERMIT TO CONSTRUCT (OR RECONSTRUCT) A SEWAGE DISPOSAL SYSTEM.

PROPERTY OWNER \_\_\_\_\_

ADDRESS \_\_\_\_\_ PHONE \_\_\_\_\_

AGENT OR PROSPECTIVE BUYER \_\_\_\_\_

ADDRESS 13742 Barberray Way PHONE \_\_\_\_\_

PROPERTY LOCATION:

SUBDIVISION \_\_\_\_\_ LOT NO. \_\_\_\_\_

ROAD AND DESCRIPTION \_\_\_\_\_

TAX MAP \_\_\_\_\_ PARCEL # \_\_\_\_\_

SIZE OF LOT \_\_\_\_\_ TYPE BLDG. \_\_\_\_\_  
(SINGLE FAMILY DWELLING OR COMMERCIAL)

THE SYSTEM INSTALLED UNDER THIS APPLICATION IS ACCEPTABLE ONLY UNTIL PUBLIC FACILITIES BECOME AVAILABLE. I FULLY UNDERSTAND THE FEE CONNECTED WITH THE FILING OF THIS PERC TEST APPLICATION IS NON-REFUNDABLE UNDER ANY CIRCUMSTANCES. I ALSO AGREE TO COMPLY WITH ALL M.O.S.H.A. REQUIREMENTS IN TESTING THIS LOT.

(SIGNATURE OF APPLICANT)

APPROVED BY \_\_\_\_\_ FOR \_\_\_\_\_ DATE \_\_\_\_\_

DISAPPROVED BY \_\_\_\_\_ FOR \_\_\_\_\_ DATE \_\_\_\_\_

HOLD PENDING FURTHER TESTS \_\_\_\_\_

REASONS FOR REJECTION OR HOLDING \_\_\_\_\_

PERCOLATION TEST PLAT/PRELIMINARY PLAT - TITLE OR I.D. # \_\_\_\_\_ DATE \_\_\_\_\_

SITE DEVELOPMENT PLAN/FINAL PLAT - TITLE OR I.D. # \_\_\_\_\_ DATE \_\_\_\_\_

# THIS IS NOT A PERMIT

COUNTY #

SOIL PROFILE

0'

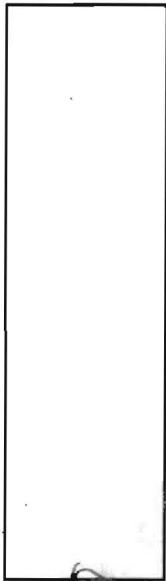

SOIL PROFILE

0'

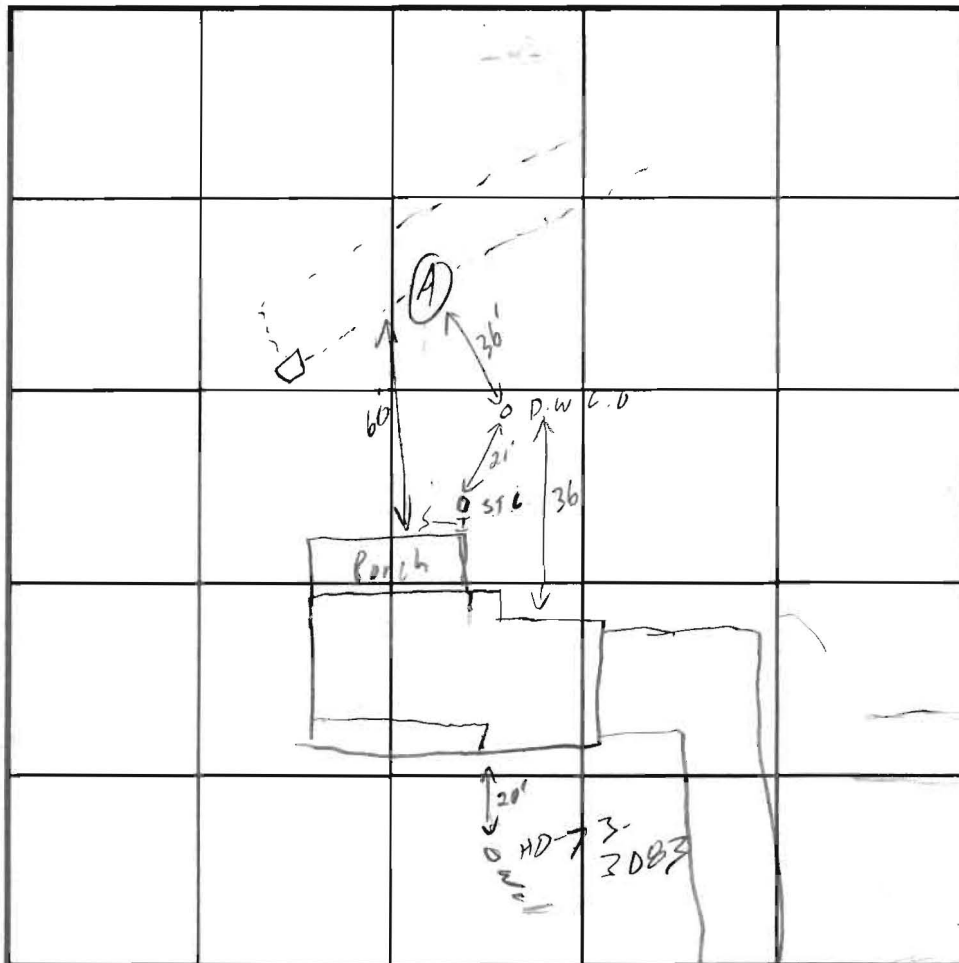
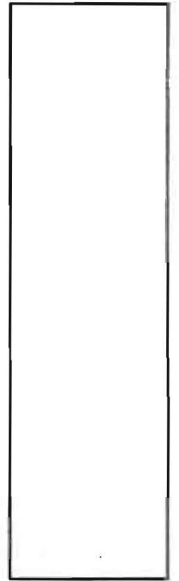

INDICATE NORTH - NAME ADJOINING ROADWAY AS BASE LINE.

Topsoil  
Orange Red  
Si Clay

4-4.5'

Tan Brown  
So Cl Lom

Break  
varied  
from 4-4.5'  
to 7'

DATE	TEST NO.	DEPTH	PRE-WET		TEST - 1" DROP		TIME
			START	STOP	START	STOP	
4/29/04	(A)	6' / 13'	10:57	11:15	1/2 inch movement stick pulled		
		7'	11:19	11:25	11:25	11:37	12
		5'	9'	4'			

REMARKS  $210 \times 4 \div 2 \times .36 = 152$

TYPE OF SOIL  $3 \times .42 = 119$

TESTED BY SD ALSO PRESENT Homborne, Dan Rite

TRENCH DESIGN DATA: AVERAGE PERCOLATION TIME 12 TRENCH WIDTH 3 2 boys

INLET DEPTH 5 MAXIMUM BOTTOM DEPTH 9 SQ. FT./BEDROOM 210