

4/4/88 noon
pm.

PERMIT

SEWAGE DISPOSAL SYSTEM

MARYLAND STATE DEPARTMENT OF HEALTH

P 41255

A 39687

DISTRICT 5th

DATE 3/22/88

DATE SYSTEM APPROVED 4-4-88

INSPECTOR JEN

HOWARD COUNTY
BUREAU OF ENVIRONMENTAL HEALTH
461-9933

INDEXED

Ken Hatfield's Backhoe Rental IS PERMITTED TO INSTALL X ALTER

ADDRESS 13785 Burnt Woods Road, Glenelg, MD 21737 PHONE 854-6172

SUBDIVISION Smith Property ROAD 13850 Burntwoods Rd LOT 1

PROPERTY OWNER Christian Smith

ADDRESS _____

IF GARBAGE GRINDER IS USED INCREASE SEPTIC TANK CAPACITY BY 50% AND ABSORPTION AREA BY 22%.

GARBAGE GRINDER? YES _____ NO X

SEPTIC TANK CAPACITY 1000 GALLONS NUMBER OF BEDROOMS 3

160
3
61 480
80
480

TRENCHES - 160 sq. ft. per bedroom. Trench to be 2 feet wide. Inlet 3 feet below original grade. Bottom maximum depth 9 feet below original grade. Effective area begins at 3 feet below original grade. 6 feet of stone below distribution pipe.

LOCATION - Place the distribution box 20 feet up the right 1698.02' lot line and 15 feet off the right lot line as seen when facing the property from Burntwoods Road. Run trenches on contour toward the left lot line.

NOTE - No trench to exceed 100 feet in length. Provide 6" - 8" diameter cleanout and cap to grade or above on septic tank.

J.F.

PLANS APPROVED BY S. Abel DATE 10/08/87

COVER NO WORK UNTIL INSPECTED AND APPROVED.

NEITHER THE HOWARD COUNTY COUNCIL NOR THE HEALTH DEPARTMENT IS RESPONSIBLE FOR THE SUCCESSFUL OPERATION OF ANY SYSTEM.

NOTE: CLEANOUT REQUIRED EVERY 70 FEET OF SEWER LINE AND/OR AT 90° SWEEPS IN LINES FROM HOUSE TO DRAIN FIELDS.

NOTE: ALL PARTS OF SEPTIC SYSTEMS (I.E., TANK, DISTRIBUTION BOX, TRENCHES) TO BE 100 FEET FROM WELL (UNLESS OTHERWISE SPECIFICALLY AUTHORIZED)

NOTE: IF DEEP TRENCH(IES) ARE USED CALL FOR INSPECTION BEFORE AND AFTER PLACING GRAVEL IN TRENCH(IES).

NOTE: NO DRY WELL SHALL EXCEED 15 FOOT IN DIAMETER. NO ABSORPTION TRENCH TO EXCEED 100 FEET IN LENGTH.

NOTE: ALL PIPE FROM HOUSE TO SEPTIC TANK MUST BE CAST IRON OR SCHEDULE 40 PVC OR ABS.

PERMIT VOID AFTER TWO YEARS.

NOTE: INSTALL STAND PIPE ON SEPTIC TANK AND DRY WELL. STAND PIPES MUST BE 6 INCHES IN DIAMETER. CAST IRON, CONCRETE OR TERRA COTTA OR PVC OR ABS ACCEPTED. IF TOP OF SEPTIC TANK IS DEEPER THAN 3 FEET, MANHOLE TO GRADE REQUIRED.

NOTE: DISTRIBUTION BOXES MUST HAVE BAFFLES.

***INSTALLER IS RESPONSIBLE FOR OBTAINING FINAL APPROVAL ON THIS PERMIT**

*CALL 461-9933 FOR INSPECTION OF SEPTIC SYSTEMS.

EH - 2-1186

A 39687

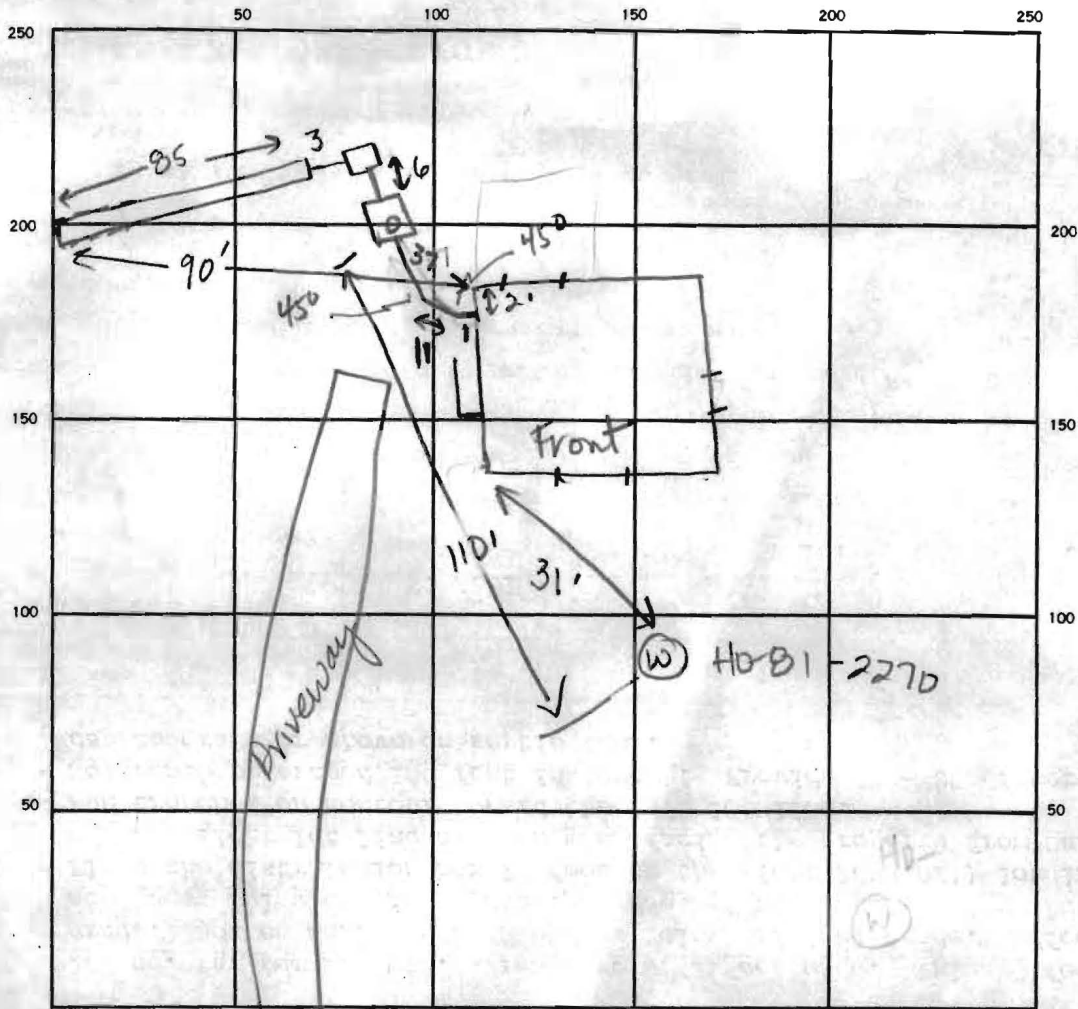

2
 35
 24
 40
 70
 1
 37
 24
 148
 74
 98
 1
 13
 24
 52
 26
 31

32
 24
 128
 64
 768
 31
 107

300
 510

SEPTIC TANK LEVEL 1000 gal CLEANOUTS 1 on septic tank

DISTRIBUTION BOX LEVEL OK w/ baffle

DRAIN FIELD/TILE FIELD DEPTH 9.5 FT. TRENCH WIDTH 2 FT. INLET DEPTH 3 FT.

EFFECTIVE GRAVEL DEPTH 6 FT. TOTAL LENGTH 85 FT.

NUMBER OF TRENCHES 1 ONE SIDEWALL BOTTOM AREA 510 SQ. FT.

DRYWELL INSIDE DIAMETER _____ FT. EFFECTIVE DEPTH BELOW INLET _____ FT.

ABSORBENT AREA 510 SQ. FT.

REMARKS 4-4-88 OK to add pipe, paper and stone to trench, can cover up to distribution box, JEN 4-4-88 OK to cover all work. JEN

DATE SYSTEM APPROVED 4-4-88 INSPECTOR Jane E. Nadeau