

# APPLICATION

PERCOLATION TESTING

A \_\_\_\_\_

P \_\_\_\_\_

HOWARD COUNTY HEALTH DEPARTMENT  
BUREAU OF ENVIRONMENTAL HEALTH  
3525-H ELLICOTT MILLS DRIVE/ELLICOTT CITY, MARYLAND 21043  
TELEPHONE: 313-2640

DISTRICT \_\_\_\_\_

DATE \_\_\_\_\_

TO: THE COUNTY HEALTH OFFICER  
ELLICOTT CITY, MARYLAND

I HEREBY APPLY FOR THE NECESSARY TEST PRIOR TO APPLICATION FOR PERMIT TO CONSTRUCT (OR RECONSTRUCT) A SEWAGE DISPOSAL SYSTEM.

PROPERTY OWNER \_\_\_\_\_

ADDRESS \_\_\_\_\_ PHONE \_\_\_\_\_

AGENT OR PROSPECTIVE BUYER \_\_\_\_\_

ADDRESS \_\_\_\_\_ PHONE \_\_\_\_\_

PROPERTY LOCATION:

SUBDIVISION \_\_\_\_\_ LOT NO. \_\_\_\_\_

ROAD AND DESCRIPTION 1420 Daisy Rd

TAX MAP \_\_\_\_\_ PARCEL # \_\_\_\_\_

SIZE OF LOT \_\_\_\_\_ TYPE BLDG. \_\_\_\_\_  
(SINGLE FAMILY DWELLING OR COMMERCIAL)

THE SYSTEM INSTALLED UNDER THIS APPLICATION IS ACCEPTABLE ONLY UNTIL PUBLIC FACILITIES BECOME AVAILABLE. I FULLY UNDERSTAND THE FEE CONNECTED WITH THE FILING OF THIS PERC TEST APPLICATION IS NON-REFUNDABLE UNDER ANY CIRCUMSTANCES. I ALSO AGREE TO COMPLY WITH ALL M.O.S.H.A. REQUIREMENTS IN TESTING THIS LOT.

(SIGNATURE OF APPLICANT)

APPROVED BY \_\_\_\_\_ FOR \_\_\_\_\_ DATE \_\_\_\_\_

DISAPPROVED BY \_\_\_\_\_ FOR \_\_\_\_\_ DATE \_\_\_\_\_

HOLD PENDING FURTHER TESTS \_\_\_\_\_

REASONS FOR REJECTION OR HOLDING \_\_\_\_\_

PERCOLATION TEST PLAT/PRELIMINARY PLAT - TITLE OR I.D. # \_\_\_\_\_ DATE \_\_\_\_\_

SITE DEVELOPMENT PLAN/FINAL PLAT - TITLE OR I.D. # \_\_\_\_\_ DATE \_\_\_\_\_

# THIS IS NOT A PERMIT

COUNTY #

SOIL PROFILE

0' [Empty box for soil profile]

SOIL PROFILE

0' [Empty box for soil profile]

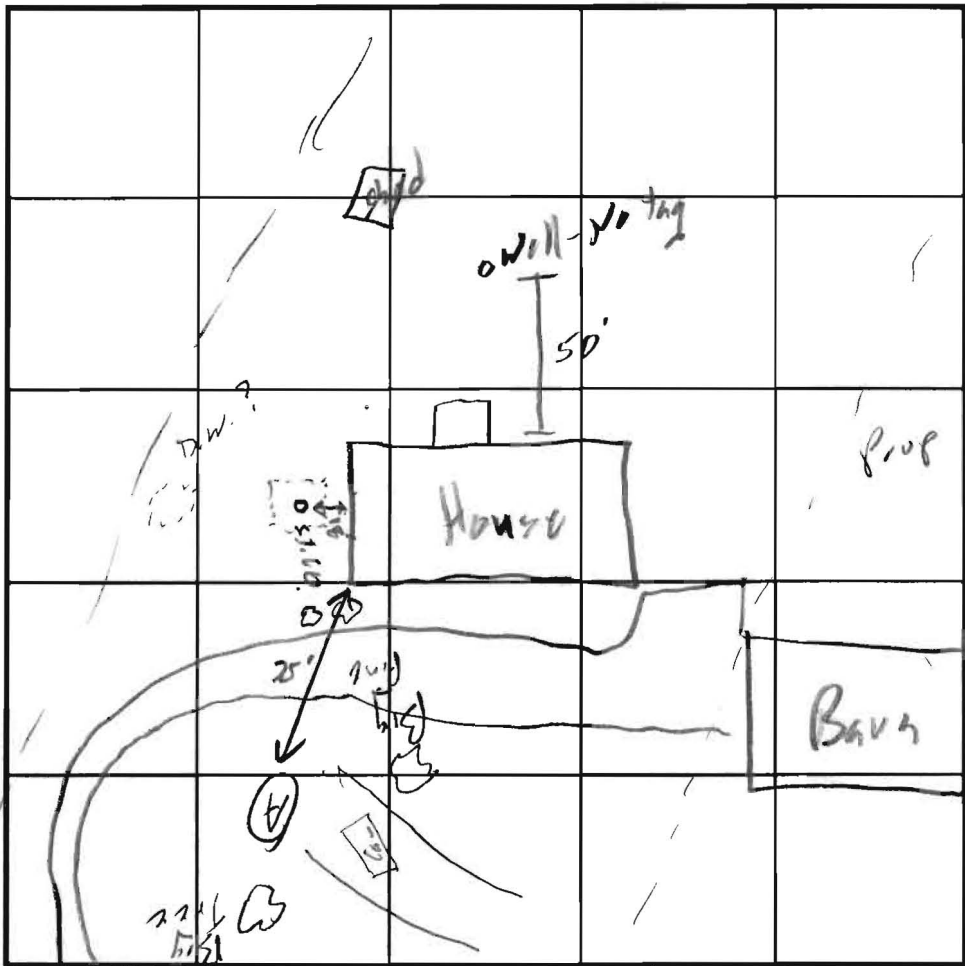

INDICATE NORTH - NAME ADJOINING ROADWAY AS BASE LINE.

6" Topsoil  
orange clay

4" orange tan clay loam

8" orange tan grey shale

10-15% Rx lean clay

12"

DATE	TEST NO.	DEPTH	PRE-WET		TEST - 1" DROP		TIME
			START	STOP	START	STOP	
6/21/04	①	4.5 12'	10:39	10:49	10:49	11:04	15

REMARKS Tank is 2 piece w/rd seam - 1000-1250? Invert: 1.5'

TYPE OF SOIL \_\_\_\_\_

TESTED BY SP ALSO PRESENT Jake

TRENCH DESIGN DATA: AVERAGE PERCOLATION TIME 15 TRENCH WIDTH 3

INLET DEPTH 4 MAXIMUM BOTTOM DEPTH 8 SQ. FT/BEDROOM 210