

APPLICATION

A 24499

SEWAGE DISPOSAL TESTING

P _____

STATE OF MARYLAND - DEPARTMENT OF HEALTH AND MENTAL HYGIENE

HOWARD COUNTY HEALTH DEPARTMENT
ENVIRONMENTAL HEALTH SERVICES
P. O. BOX 476, ELLICOTT CITY, MARYLAND 21043
TELEPHONE: 465-3000, EXT. 356

DISTRICT 5

DATE 3-15-76

$\bar{t} = 12 \text{ min} \Rightarrow 125 \text{ A/BR} + 20\% \Rightarrow 150 \text{ A/BR}$

TO: THE COUNTY HEALTH OFFICER
ELLICOTT CITY, MARYLAND

I, HEREBY, APPLY FOR THE NECESSARY TEST IN ORDER TO CONSTRUCT (OR RECONSTRUCT) A SEWAGE DISPOSAL SYSTEM.

PROPERTY OWNER Henry Dryfoos, III

ADDRESS 4701 Sangamore Road, Washington, D.C. 20016 PHONE 220-5052

PROPERTY LOCATION:

SUBDIVISION Flamewood LOT NO. NEW LOT 6-B
~~7, Block B~~

ROAD AND DESCRIPTION _____

SIZE OF LOT 65,000 TYPE BLDG. 4
NUMBER OF BEDROOMS

IF NOT SINGLE RESIDENCE DESCRIBE _____

THE SYSTEM INSTALLED UNDER THIS APPLICATION IS ACCEPTABLE ONLY UNTIL PUBLIC FACILITIES BECOME AVAILABLE.

SIGNATURE OF APPLICANT Henry Dryfoos III

APPROVED BY [Signature] FOR DW trench DATE 11/2/77
(KIND OF SYSTEM)

REJECTED BY _____ FOR _____ DATE _____
(KIND OF SYSTEM)

HOLD PENDING FURTHER TESTS _____ DATE _____

REASONS FOR REJECTION OR HOLDING _____

THIS IS NOT A PERMIT

7B

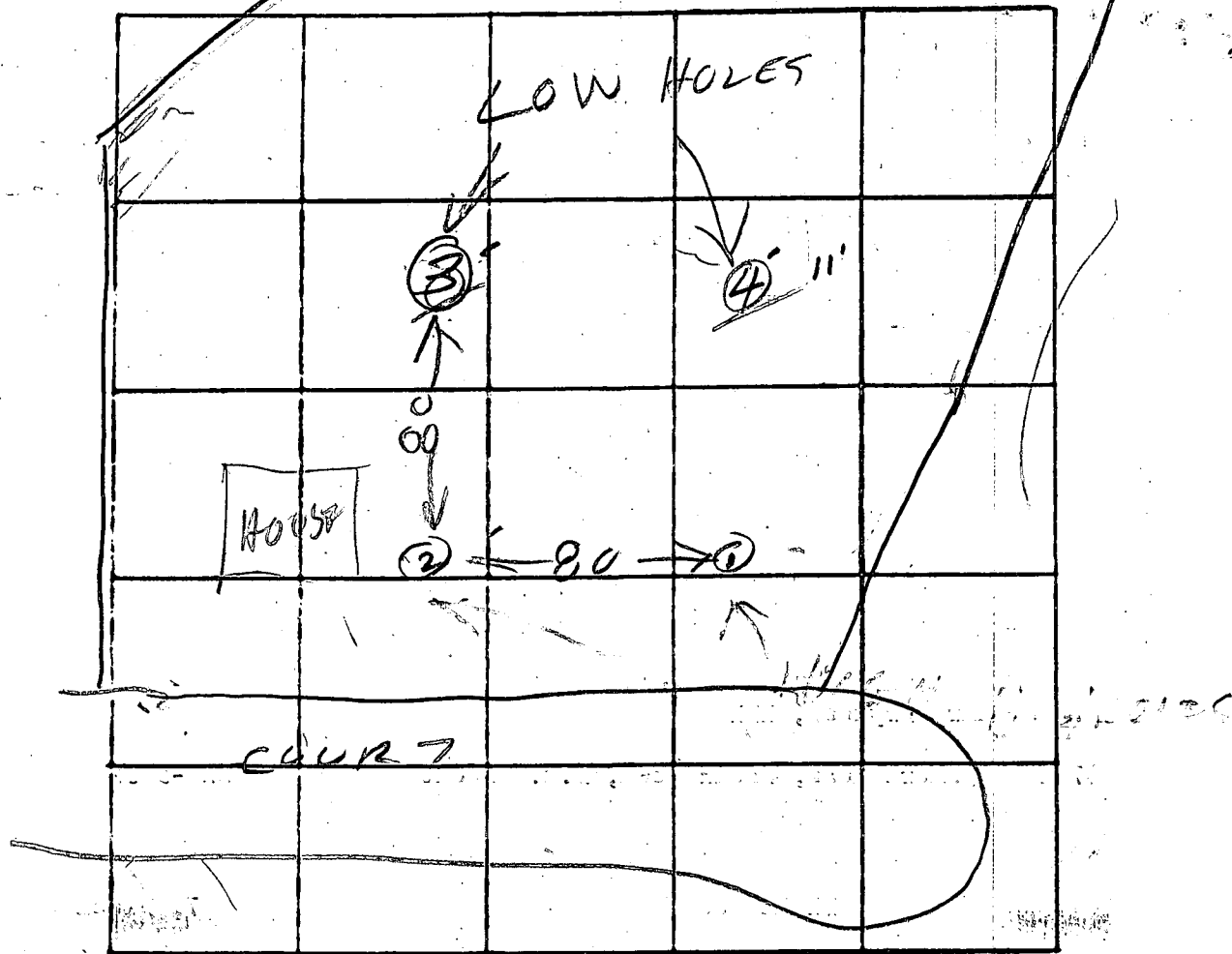

INDICATE NORTH. - NAME ADJOINING ROADWAY AS BASE LINE.

DATE	TEST NO.	DEPTH	PRE-WET		TEST - 1" DROP		TIME
			START	STOP	START	STOP	
4/2/76	1	13	TOP	4 FT	CLAY		
			BOT	9 FT	SANDY		20.7
	2	11	DRY	70	10 3 FT	CLAY	
					BOT	8 FT	SANDY
	3	14	SANDY		13 FT		
			WATER				
	4	14	SANDY		13 FT		
			WATER				
	1D	13 1/2	214	220	220	227	7
	1S	6	215	223	223	236	13
	4S	5	219	221	221	223	2
	3S	4	230	240	240	243	3
	2D	12	231	241	241	249	8
4/14/77	4	12	Visual	dry			
4/13/77	3	13 1/2	Water	13'	after 1 hour	good for 4'	

4 11/45

20

2.5

REMARKS

See Plat for Hole sets

TYPE OF SOIL

TESTED BY

B.H. & H.B.

ALSO PRESENT:

FYOCF - Burner