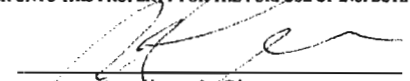
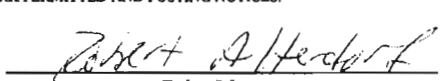

Building Address <u>3226 Hayloft Ct.</u> <u>Woodbine, MD 21797</u> Suite/Apt. #: _____ SDP/WP/Petition #: _____ Census Tract _____ Subdivision _____ Section _____ Area _____ Lot <u>51</u> Tax Map _____ Parcel _____ Grid _____ Zoning _____ Map Coordinates _____ Lot Size _____ Existing Use <u>Front Porch (Renovation)</u> Proposed Use <u>Front Porch</u> Estimated Construction Cost \$ <u>9,000.00</u> Description of Work <u>Renovation of Front</u> <u>6'6" x 19'6" with shed roof.</u> Occupant or Tenant <u>Jim &amp; Lesa Smola</u> Contact Name <u>Jim &amp; Lesa Smola</u> Address <u>3226 Hayloft Ct.</u> City <u>Woodbine</u> State <u>MD</u> Zip Code <u>21797</u> Phone <u>301-854-5635</u> Fax _____	Property Owner's Name <u>Jim &amp; Lesa Smola</u> Address <u>3226 Hayloft Ct.</u> City <u>Woodbine</u> State <u>MD</u> Zip Code <u>21797</u> Phone <u>301-854-5635</u> Phone <u>301-854-5635</u> Applicant's Name & Mailing Address, (if other than stated herein): _____ Phone _____ Fax _____ Contractor Company <u>R.S. Construction Inc.</u> Contact Person <u>Robert Attendorf</u> Address <u>14432 Long Channel Circle</u> City <u>Crofton</u> State <u>MD</u> Zip Code <u>21114</u> License No. <u>416606</u> Phone <u>301-540-9600</u> Fax <u>301-540-9677</u> Engineer or Architect Company _____ Contact Person _____ Address _____ City _____ State _____ Zip Code _____ Phone _____ Fax _____
---	---

BUILDING DESCRIPTION - COMMERCIAL		BUILDING DESCRIPTION - RESIDENTIAL	
Building Characteristics	Utilities	Building Characteristics	Utilities
Height: _____	Water Supply: _____ Public _____ Private _____	SF Dwelling <input checked="" type="checkbox"/> SF Townhouse <input type="checkbox"/> Depth _____ Width _____	Water Supply: _____ Public _____ Private <input checked="" type="checkbox"/>
No. of stories: _____	Sewage Disposal: _____ Public _____ Private _____	1 <sup>st</sup> floor: _____ 2 <sup>nd</sup> floor: _____ Basement: _____	Sewage Disposal: _____ Public _____ Private <input checked="" type="checkbox"/>
Gross area, sq. ft. per floor: _____	Electric Yes <input type="checkbox"/> No <input type="checkbox"/> Gas Yes <input type="checkbox"/> No <input type="checkbox"/>	Finished Basement <input checked="" type="checkbox"/> Unfinished Basement <input type="checkbox"/> Crawl space <input type="checkbox"/> Slab on Grade <input type="checkbox"/>	Electric Yes <input checked="" type="checkbox"/> No <input type="checkbox"/> Gas Yes <input type="checkbox"/> No <input type="checkbox"/>
Use group: _____	Heating System: _____ Electric <input type="checkbox"/> Oil <input type="checkbox"/> Natural Gas <input type="checkbox"/> Propane Gas <input type="checkbox"/>	No. of Bedrooms <u>3</u>	Heating System: _____ Electric <input type="checkbox"/> Oil <input type="checkbox"/> Natural Gas <input type="checkbox"/> Propane Gas <input type="checkbox"/>
Construction type: _____ Reinforced Concrete _____ Structural Steel _____ Masonry _____ Wood Frame _____ State Certified Modular _____	Sprinkler system: N/A <input type="checkbox"/> Full _____ Partial _____ Other Suppression _____ # of Heads _____	Multi-family dwellings: No. of efficiency units: _____ No. of 1 BR units: _____ No. of 2 BR units: _____ No. of 3 BR units: _____	Sprinkler system: N/A <input type="checkbox"/> NFPA #13D _____ NFPA #13R _____ Other: _____
		Other Structure: _____ Dimensions: _____ Footings: _____ Roof Height: _____	
		State Certified Modular Manufactured Home	

THE UNDERSIGNED HEREBY CERTIFIES AND AGREES AS FOLLOWS: (1) THAT HE/SHE IS AUTHORIZED TO MAKE THIS APPLICATION; (2) THAT THE INFORMATION IS CORRECT; (3) THAT HE/SHE WILL COMPLY WITH ALL REGULATIONS OF HOWARD COUNTY WHICH ARE APPLICABLE THERETO; (4) THAT HE/SHE WILL PERFORM NO WORK ON THE ABOVE REFERENCED PROPERTY NOT SPECIFICALLY DESCRIBED IN THIS APPLICATION; (5) THAT HE/SHE GRANTS COUNTY OFFICIALS THE RIGHT TO ENTER ONTO THIS PROPERTY FOR THE PURPOSE OF INSPECTING THE WORK PERMITTED AND POSTING NOTICES.

 Applicant's Signature <u>R.S. Construction Inc.</u> Title/Company	 Print Name <u>5/7/08</u> Date
--	---

Checks payable to: **DIRECTOR OF FINANCE OF HOWARD COUNTY**  
**\*\*PLEASE WRITE NEATLY AND LEGIBLY.\*\***  
**- FOR OFFICE USE ONLY -**

5/7/08 Robert

Distribution: _____ Title: _____ Date: _____ Signature: _____ Title: _____ Date: _____	Distribution: _____ Title: _____ Date: _____ Signature: _____ Title: _____ Date: _____
---	---

REV 10/28/04

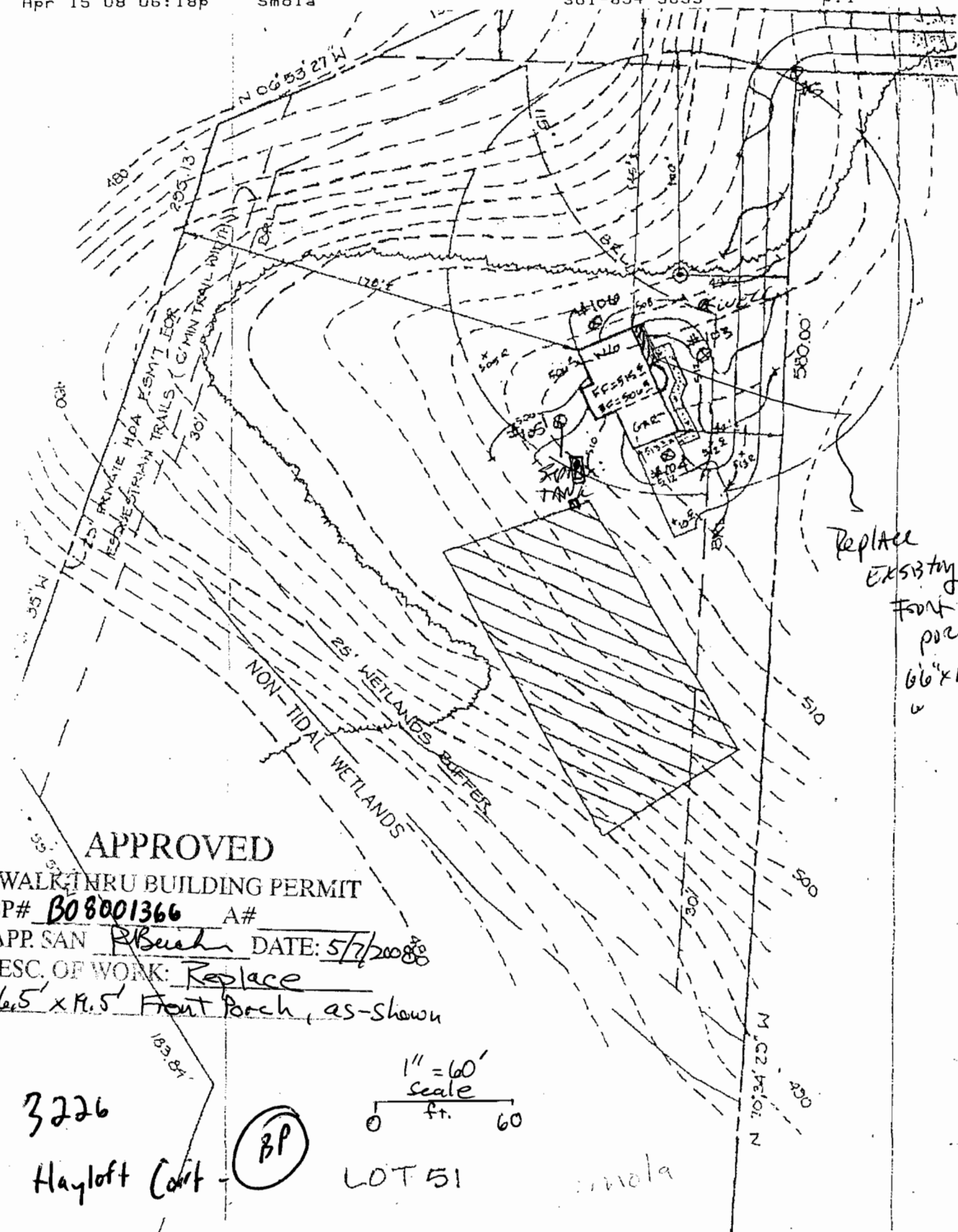

**APPROVED**  
 WALKTHRU BUILDING PERMIT  
 BP# B08001366 A# \_\_\_\_\_  
 APP. SAN R. Beecher DATE: 5/7/2008  
 DESC. OF WORK: Replace  
66.5' x 19.5' Front Porch, as-shown

3226

Hayloft Court



LOT 51

Smola

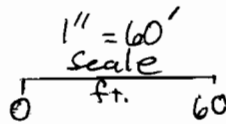

Replace  
 EXISTING  
 front  
 porch  
 66' x 19'6"  
 u