

APPROVED
5/8/85
RH
P. 35366
A REPAIR

PERMIT

SEWAGE DISPOSAL SYSTEM

MARYLAND STATE DEPARTMENT OF HEALTH*

HOWARD COUNTY
BUREAU OF ENVIRONMENTAL HEALTH
992-2330

INDEXED

ELLICOTT CITY

DISTRICT _____

DATE 4/30/85

Herman Sirk

IS PERMITTED TO INSTALL _____ ALTER X

ADDRESS 2555 Jennings Chapel Road, Woodbine, MD 21797 PHONE 489-4724

SUBDIVISION _____ ROAD 16539 A. E. Mullinix LOT _____
(End of A. E. Mullinix Road and Route 94)

PROPERTY OWNER Donald Warfield
ADDRESS 16539 A. E. Mullinix Road

IF GARBAGE GRINDER IS USED INCREASE SEPTIC TANK CAPACITY BY 50% AND ABSORPTION AREA BY 22%.

GARBAGE GRINDER? YES _____ NO _____

SEPTIC TANK CAPACITY _____ GALLONS NUMBER OF BEDROOMS _____

3 BR
NO GARB.

REPAIR - CALL FOR INSPECTION WHEN GROUND IS OPENED UP SO SANITARIAN CAN RECOMMEND REPAIR.

5/6/85 TO REPLACE EXISTING STRAIGHT PIPE DISCHARGE. VLS HOLE 12' DEEP.

INSTALL 1000 GAL MINIMUM SEPTIC TANK

AND 6 FT TRENCH 16' DEEP WITH KT STONE. CW

PLANS APPROVED BY C. Williams DATE 4/30/85

COVER NO WORK UNTIL INSPECTED AND APPROVED.

NEITHER THE HOWARD COUNTY COUNCIL NOR THE HEALTH DEPARTMENT IS RESPONSIBLE FOR THE SUCCESSFUL OPERATION OF ANY SYSTEM.

NOTE: IF TRENCH IS USED CALL FOR INSPECTION BEFORE AND AFTER PLACING GRAVEL IN TRENCH.

NOTE: NO DRY WELL SHALL EXCEED 15 FOOT IN DIAMETER. NO ABSORPTION TRENCH TO EXCEED 100 FEET IN LENGTH.

NOTE: ALL PIPE FROM HOUSE TO SEPTIC TANK MUST BE CAST IRON OR SCHEDULE 40 PVC OR ABS.

PERMIT VOID AFTER THREE YEARS.

NOTE: INSTALL STAND PIPE ON SEPTIC TANK AND DRY WELL. STAND PIPES MUST BE 6 INCHES IN DIAMETER CAST IRON, CONCRETE OR TERRA COTTA, OR PVC OR ABS ACCEPTED. IF TOP OF SEPTIC TANK IS DEEPER THAN 3 FEET MANHOLE TO GRADE REQUIRED

***INSTALLER IS RESPONSIBLE FOR OBTAINING FINAL APPROVAL ON THIS PERMIT**

*CALL 992-2330 FOR INSPECTION OF SEPTIC SYSTEMS.

EH - 2-1082

A
P. 35366
REPAIR

5/8/85
5/6/85
AM = APPROV.

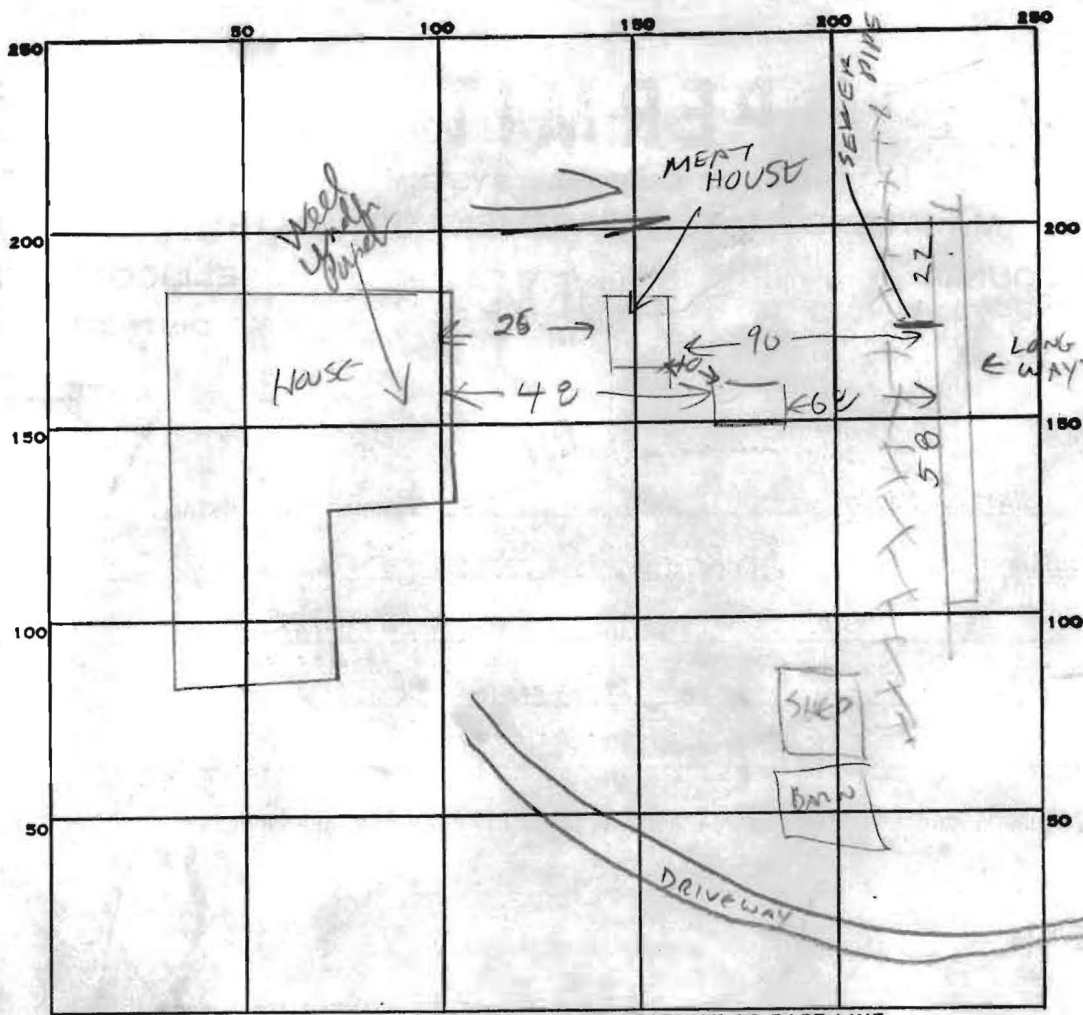

PERMIT CARD _____

SEPTIC TANK, LEVEL _____ CLEANOUTS 01

DISTRIBUTION BOX, LEVEL _____

PILE FIELD, DEPTH 10 FT. TRENCH WIDTH 2 FT.

GRAVEL DEPTH 7 FT IN. TOTAL LENGTH 80 FT.

NUMBER OF TRENCHES 1 TOTAL BOTTOM AREA 560

SEEPAGE PITS, INSIDE DIAMETER _____ FT. DEPTH BELOW INLET _____ FT.

5/6/85 ABSORBENT AREA _____ SQ. FT.

REMARKS 60 FT TRENCH DUG 10' DEEP. NEED TO EXTEND TO 80' AND
ADD 6' OF GRAVEL. THEN CONNECT TO NEW SEPTIC TANK. CW
5/8/85 - TRENCH OK OLD TANK TO BO
USED CLEANOUT PUT ON OLD TANK
IT WAS PUMPED OUT

DATE SYSTEM APPROVED 5/8/85 INSPECTOR Raymond Hodger