

# APPLICATION

PERCOLATION TESTING

A 59898

P \_\_\_\_\_

HOWARD COUNTY HEALTH DEPARTMENT  
BUREAU OF ENVIRONMENTAL HEALTH  
3525-H ELLICOTT MILLS DRIVE/ELLICOTT CITY, MARYLAND 21043  
TELEPHONE: 313-2640

DISTRICT \_\_\_\_\_

DATE 3/30/98

TO: THE COUNTY HEALTH OFFICER  
ELLICOTT CITY, MARYLAND

I HEREBY APPLY FOR THE NECESSARY TEST PRIOR TO APPLICATION FOR PERMIT TO CONSTRUCT (OR RECONSTRUCT) A SEWAGE DISPOSAL SYSTEM.

PROPERTY OWNER \_\_\_\_\_

ADDRESS \_\_\_\_\_ PHONE \_\_\_\_\_

AGENT OR PROSPECTIVE BUYER FISHER COLLINS and CARTER (Agent)

ADDRESS 10272 Baltimore national pike PHONE (410) 461-2855  
ELLICOTT CITY MD. 21042

PROPERTY LOCATION:

SUBDIVISION McCaan property LOT NO. 4 (3)

ROAD AND DESCRIPTION OLD FREDERICK Road

TAX MAP 8 PARCEL # 78

SIZE OF LOT 1 Ac. TYPE BLDG. S.F.D.  
(SINGLE FAMILY DWELLING OR COMMERCIAL)

THE SYSTEM INSTALLED UNDER THIS APPLICATION IS ACCEPTABLE ONLY UNTIL PUBLIC FACILITIES BECOME AVAILABLE. I FULLY UNDERSTAND THE FEE CONNECTED WITH THE FILING OF THIS PERC TEST APPLICATION IS NON-REFUNDABLE UNDER ANY CIRCUMSTANCES. I ALSO AGREE TO COMPLY WITH ALL M.O.S.H.A. REQUIREMENTS IN TESTING THIS LOT. Eschmaria G. Fisch (agent)  
(SIGNATURE OF APPLICANT)

APPROVED BY \_\_\_\_\_ FOR \_\_\_\_\_ DATE \_\_\_\_\_

DISAPPROVED BY \_\_\_\_\_ FOR \_\_\_\_\_ DATE \_\_\_\_\_

HOLD PENDING FURTHER TESTS \_\_\_\_\_

REASONS FOR REJECTION OR HOLDING \_\_\_\_\_

PERCOLATION TEST PLAT/PRELIMINARY PLAT - TITLE OR I.D. # \_\_\_\_\_ DATE \_\_\_\_\_

SITE DEVELOPMENT PLAN/FINAL PLAT - TITLE OR I.D. # \_\_\_\_\_ DATE \_\_\_\_\_

## THIS IS NOT A PERMIT

59898  
COUNTY #

LOT # ③

SOIL PROFILE  
4-261 / 4-260

0' top soil

1' org red  
brn  
cl lm

5' pale red  
brn  
to  
pale org  
brn  
sl lm

25%  
Rx  
frag

12'

4-1

0' top soil

1' red brn  
cl lm

3'

pale org  
pk tan  
sl lm

25%  
Rx  
frag

12'

4-258

0' top soil

1' org brn  
cl lm

5'

pale org  
tan  
sl lm

25-30%  
Rx  
frag

11.5'

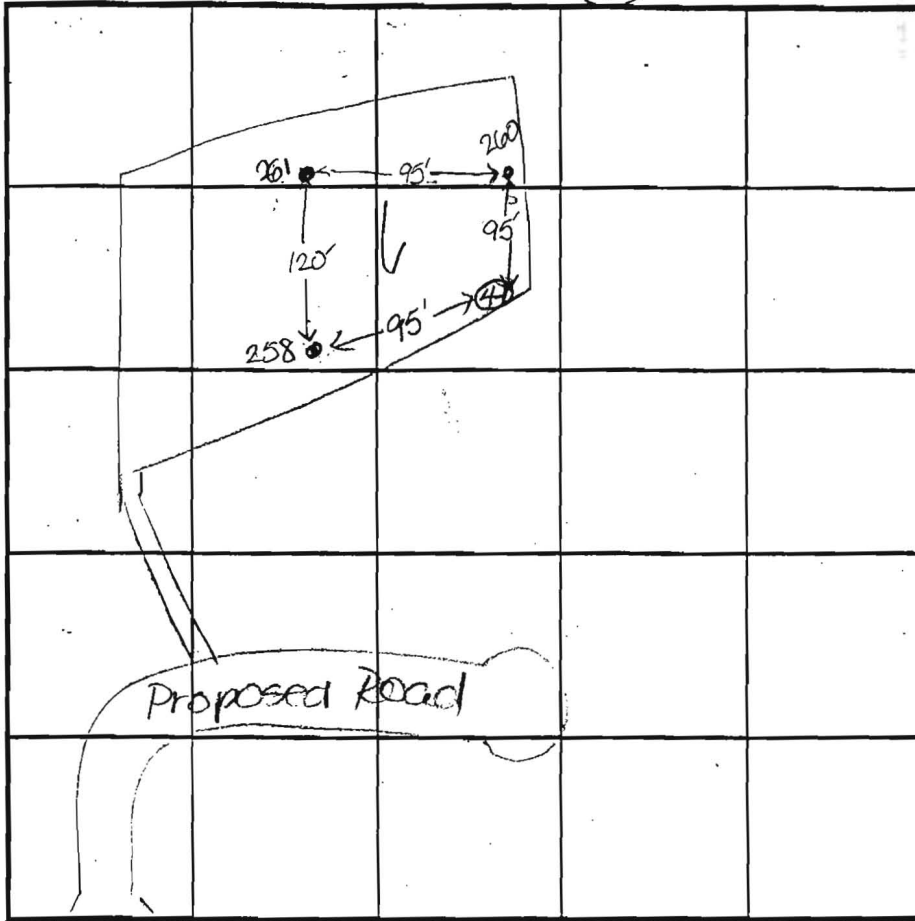

SOIL PROFILE

0'

INDICATE NORTH - NAME ADJOINING ROADWAY AS BASE LINE.  
Old Frederick Road

DATE	TEST NO.	DEPTH	PRE-WET		TEST - 1" DROP		TIME
			START	STOP	START	STOP	
4-02-98	4-261	4'8" S	10:30	8:00			OK below
		8.0' M	10:31	10:36	10:36	10:43	7
		12.0' D	visual				OK
	4-260	12.0' D	visual				OK
	4-1	3.5' S	11:06	11:09	11:09	11:12	3
		12.0' D	visual				OK
	4-258	11.5' D	visual				OK

REMARKS \_\_\_\_\_

TYPE OF SOIL \_\_\_\_\_

TESTED BY D. Sme ALSO PRESENT D. Ketterman Jr & Sr  
D. Carter

TRENCH DESIGN DATA: AVERAGE PERCOLATION TIME \_\_\_\_\_ TRENCH WIDTH \_\_\_\_\_

INLET DEPTH \_\_\_\_\_ MAXIMUM BOTTOM DEPTH \_\_\_\_\_ SQ. FT./BEDROOM \_\_\_\_\_



Approximate Tank Location

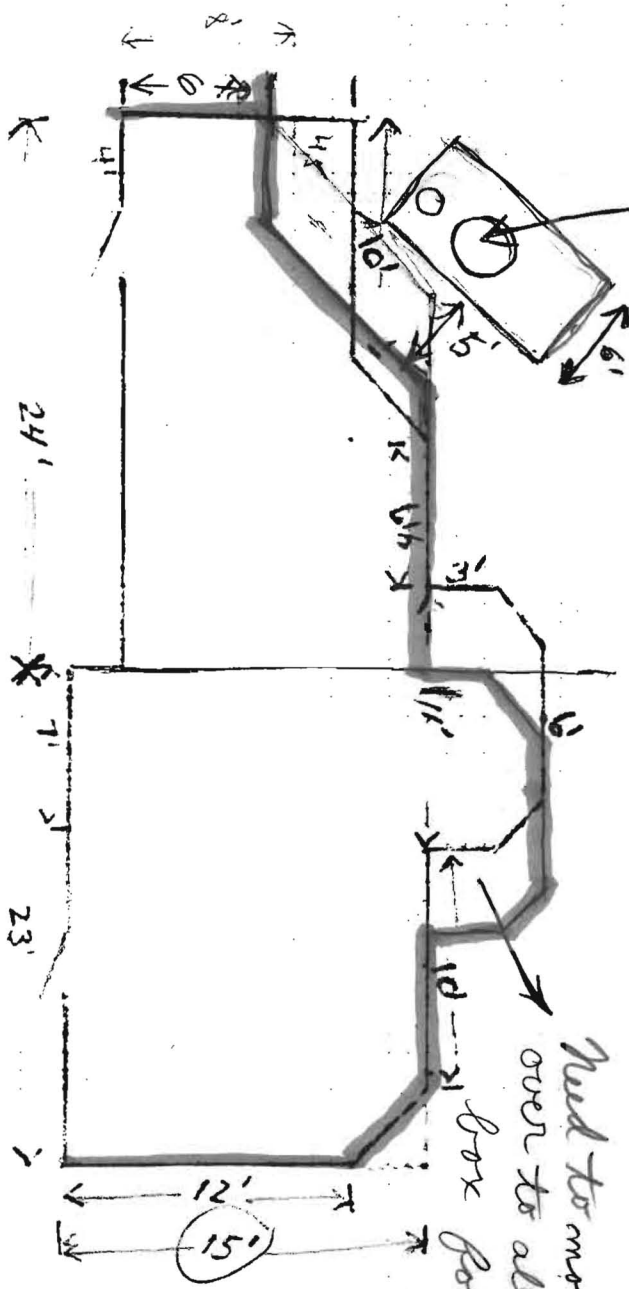

9/11/03 - Told homeowner to make these changes to his deck plan.

Need to change deck design to stay 5' away from septic tank.

Need to move overhanging section over to allow clearance to lift box for repairs.

Need to add 5' section to rear of septic rear of septic cement to make up for any lost area.

I will approve if revised plan submitted with these changes.

Deck  $\frac{1}{8}'' = 1ft$  **BB**  
Options