

C 1 **3278** SEQUENCE NO. (WRA USE ONLY)

1 2 3 (SEQ. NO.) 6

(THIS NUMBER IS TO BE PUNCHED IN COLS. 3-6 ON ALL CARDS)

STATE OF MARYLAND
WATER RESOURCES ADMINISTRATION
 TAWES STATE OFFICE BLDG., ANNAPOLIS, MD. 21401
WELL COMPLETION REPORT

THIS REPORT MUST BE SUBMITTED WITHIN 30 DAYS AFTER WELL COMPLETION

FILL IN THIS FORM COMPLETELY

COUNTY NUMBER

DATE RECEIVED (WRA USE ONLY) _____

DATE WELL COMPLETED 5-30-74

DEPTH OF WELL 125

PERMIT NO. FROM "PERMIT TO DRILL WELL" _____

DRILLERS IDENTIFICATION NO. 120

OWNER SCHNEIDER, LORRAINE LAST NAME FIRST NAME

STREET OR RFD 6883 HAWKLAND MILL ROAD POST OFFICE CLARKSVILLE MD 21029

WELL LOG			
DESCRIPTION (USE ADDITIONAL SHEETS IF NECESSARY)	FEET		CHECK IF WATER BEARING
	FROM	TO	
<u>OVERBURDEN</u>	<u>0</u>	<u>8</u>	
<u>BROWN SHALE</u>	<u>8</u>	<u>49</u>	
<u>GRAY ROCK</u>	<u>49</u>	<u>125 X</u>	

GROUTING RECORD

WELL HAS BEEN GROUTED (CIRCLE APPROPRIATE BOX) YES NO

TYPE OF GROUTING MATERIAL (CIRCLE BOX): CEMENT BENTONITE CLAY

NO. OF BAGS 21 NO. OF POUNDS 2100

GALLONS OF WATER 126

DEPTH OF GROUT SEAL (TO NEAREST FOOT)

FROM 0 FT. TO 51 FT.

(ENTER 0 IF FROM SURFACE)

CASING RECORD

INSERT APPROPRIATE CODE BELOW

STEEL CONCRETE

PLASTIC OTHER

MAIN CASING TYPE ST NOMINAL DIAMETER TOP (MAIN) CASING (NEAREST INCH) 6 TOTAL DEPTH OF MAIN CASING (NEAREST FOOT) 51

OTHER CASING (IF USED)

DIAMETER (INCH) _____ DEPTH (FEET) FROM _____ TO _____

SCREEN RECORD

INSERT APPROPRIATE CODE BELOW

STEEL BRASS OR BRONZE OPEN HOLE

PLASTIC OTHER

SCREEN

DEPTH (NEAREST WHOLE FOOT) FROM _____ TO _____

SLOT SIZE 1. _____ 2. _____ 3. _____

DIAMETER OF SCREEN 56 (NEAREST INCH) FROM _____ TO _____

GRAVEL PACK _____

IF WELL DRILLED WAS A FLOWING WELL CIRCLE BOX

WRA USE ONLY (NOT TO BE FILLED IN BY DRILLER)

TELESCOPE CASING LOG INDICATOR OTHER DATA AVAILABLE

C 3 (SEQ. NO.)

PUMPING TEST

HOURS PUMPED (TO NEAREST HOUR) 6

PUMPING RATE (GALLONS PER MINUTE TO NEAREST GALLON) 4 1/2

METHOD USED TO MEASURE PUMPING RATE AIR

WATER LEVEL: (DISTANCE FROM LAND SURFACE)

BEFORE PUMPING 31 (NEAREST FOOT)

WHEN PUMPING 115 (NEAREST FOOT)

TYPE OF PUMPED USED (CIRCLE APPROPRIATE BOX) (FOR PUMPING TEST)

AIR PISTON TURBINE

CENTRIFUGAL ROTARY OTHER (DESCRIBE BELOW)

JET SUBMERSIBLE

PUMP INSTALLED

TYPE OF PUMP (WRITE APPROPRIATE LETTER IN BOX - SEE ABOVE: A, C, J, P, R, S, T, O) 29

DRILLER WILL INSTALL PUMP (CIRCLE APPROPRIATE BOX) YES NO

CAPACITY: GALLONS PER MINUTE (TO NEAREST GALLON) 31 - 35

PUMP HORSE POWER 37 - 41

PUMP COLUMN LENGTH (NEAREST FOOT) 43 - 47

CASING HEIGHT (CIRCLE APPROPRIATE BOX AND ENTER CASING HEIGHT)

ABOVE BELOW

LAND SURFACE 50 - 51 (NEAREST FOOT)

LOCATION OF WELL ON LOT

SHOW PERMANENT STRUCTURE SUCH AS BUILDINGS, SEPTIC TANKS, AND/OR OTHER LAND MARKS AND INDICATE NOT LESS THAN TWO DISTANCES (MEASUREMENTS TO WELL).

CIRCLE APPROPRIATE BOXES

A WELL WAS ABANDONED AND SEALED WHEN THIS WELL WAS COMPLETED

ELECTRIC LOG OBTAINED

TEST WELL CONVERTED TO PRODUCTION WELL

I HEREBY CERTIFY THAT I HAVE COMPLIED WITH ALL CONDITIONS STATED ON THE ABOVE-CAPTIONED "PERMIT TO DRILL WELL", AND THAT INFORMATION CONTAINED IN THIS REPORT IS TRUE, ACCURATE, AND COMPLETE TO THE BEST OF MY KNOWLEDGE, INFORMATION AND BELIEF.

DRILLERS NAME B. EDGAR HARRISONS

SIGNATURE B. Edgar Harris

B 1 **4785** SEQUENCE NO. (WRA USE ONLY)

1 2 3 (SEQ. NO.) 6
 (THIS NUMBER IS TO BE PUNCHED IN COLS. 3-6 ON ALL CARDS)

STATE OF MARYLAND
WATER RESOURCES ADMINISTRATION
 TAWES STATE OFFICE BLDG., ANNAPOLIS, MARYLAND 21401
APPLICATION FOR PERMIT TO DRILL WELL

WRA PERMIT NUMBER

531-5115
 Street

FILL IN THIS FORM COMPLETELY

DATE RECEIVED (WRA USE ONLY)
 6/3/74
 2:30

OWNER Schneider, Lorraine Joan
 COL 15 LAST NAME FIRST NAME COL. 34

STREET OR RFD 6883 Haviland Mill Road
 COL 36 COL. 55

POST OFFICE Clarksville, Md 21029
 COL 57 COL. 76

B 1 CONTINUED DRILLER INFORMATION

1 2 3 (SEQ. NO.) 6

DATE April 19, 1974 LICENSE NUMBER 120
 8 77 80

G. Edgar Hare Sons Corp
 FIRST NAME DRILLER LAST NAME

SIGNATURE [Signature]

B 3 LOCATION OF WELL

1 2 3 (SEQ. NO.) 6

COUNTY Howard
 (DO NOT ABBREVIATE COUNTY NAME) 21

SUBDIVISION Parcel 7 42

SECTION 44 46 LOT 48 50

NEAREST TOWN Clarksville 71

MILES FROM TOWN (ENTER 0 IF IN TOWN) 2 M I 76 77 78

B 2 WELL INFORMATION

1 2 3 (SEQ. NO.) 6

MAXIMUM PUMPING RATE (GALLONS PER MINUTE) 5 8 12

AVERAGE DAILY QUANTITY NEEDED (GALLONS PER DAY) 750 14 20

USE FOR WATER (CIRCLE APPROPRIATE BOX)

D HOME (SINGLE OR DOUBLE HOUSEHOLD UNIT ONLY)

F FARMING, AGRICULTURE, IRRIGATION

I INDUSTRIAL, COMMERCIAL, STATE AND FEDERAL GOVERNMENT.

M MUNICIPAL WATER SUPPLY } MUST HAVE STATE HEALTH DEPT. APPROVAL

P PRIVATE WATER COMPANY

T TEST

B 4 DIRECTION FROM TOWN (CIRCLE APPROPRIATE BOX)

1 2 3 (SEQ. NO.) 6

N NORTH E EAST NE NORTHEAST SE SOUTHEAST

S SOUTH W WEST NW NORTHWEST SW SOUTHWEST

NEAR WHAT ROAD Haviland Mill Road 11 30

ON WHICH SIDE OF ROAD (CIRCLE APPROPRIATE BOX) N S E W 32 32 32 32

DISTANCE FROM ROAD (ENTER DISTANCE AND CIRCLE APPROPRIATE BOX) 80 34 37 38 39

APPROXIMATE DEPTH OF WELL 150 24 28 FEET

APPROXIMATE DIAMETER OF WELL 6 (NEAREST INCH)

METHOD OF DRILLING USED (CIRCLE APPROPRIATE METHOD)

BORED (OR AUGERED) JETTED DRIVEN

30-37 AIR-ROTARY AIR-PERCUSSION ROTARY (HYDRAULIC ROTARY)

CABLE REVERSE-ROTARY DRIVE-POINT

OTHER (DESCRIBE)

REPLACEMENT OR DEEPEINED WELLS (CIRCLE APPROPRIATE BOX)

N THIS WELL WILL NOT REPLACE AN EXISTING WELL

Y THIS WELL WILL REPLACE A WELL THAT WILL BE ABANDONED AND SEALED

39 S THIS WELL WILL REPLACE A WELL THAT WILL BE USED AS A STANDBY

D THIS WELL WILL DEEPEIN AN EXISTING WELL PERMIT NUMBER OF WELL TO BE REPLACED OR DEEPEINED (IF AVAILABLE)

41 52

NOT TO BE FILLED IN BY DRILLER (WRA USE ONLY)

APPROPRIATION PERMIT NUMBER 54 ENGINEER REVIEW DISTRICT NO. 63 65

FORCE 87 88 WRITE INITIALS IN BOX CONDITIONS W 70 71 72 73 74 75 76 77 78 79

B 4 CONTINUED HEALTH DEPARTMENT APPROVAL

1 2 3 (SEQ. NO.) 6

41 S (STATE HEALTH (CIRCLE BOX)) COUNTY NAME Howard COUNTY NO. 00033

DATE 6/3/74 MO. DAY YR. APPROVED BY [Signature]

43 48

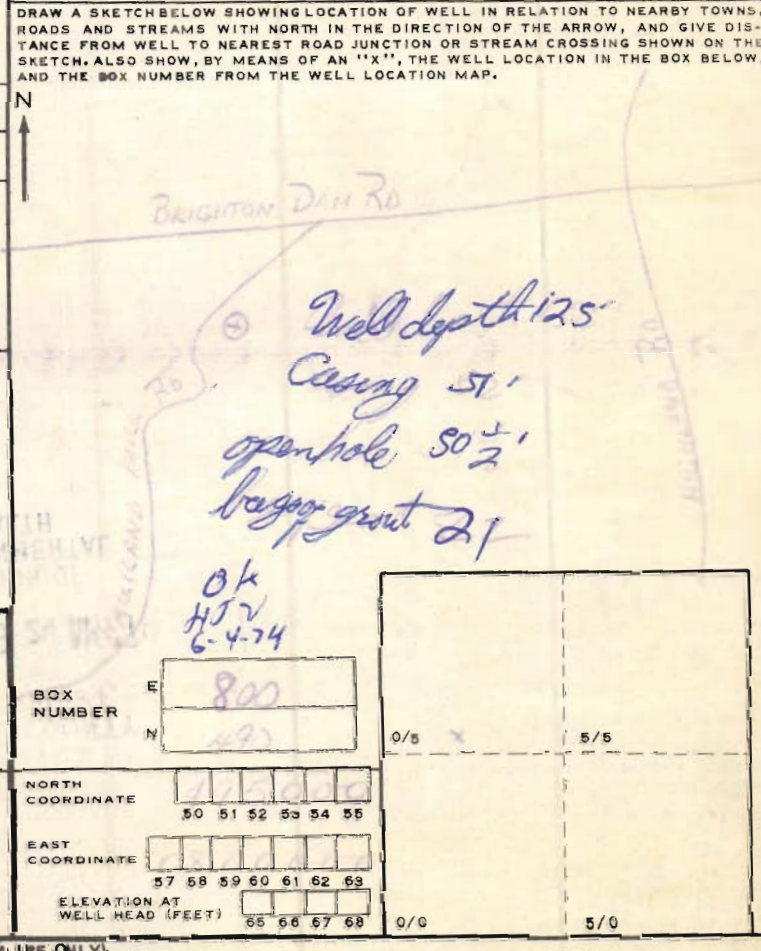

B 5 SPECIAL CONDITIONS 8-63 (WRA USE ONLY)

1 2 3 (SEQ. NO.) 6

May 20, 1976

Mrs. Lorraine J. Schneider
6111 Turnabout Lane
Apartment #6
Columbia, Maryland 21044

Dear Mrs. Schneider:

This is to advise that the lot tested for you under the name of Robert A. Schrepf and located on Haviland Mill Road passed the standard percolation tests on April 4, 1974.

The water well was grouted and approved by the Health Department on June 4, 1974.

Very truly yours,

Donald W. Monaghan, Chief
Division of Water and Sewerage

DWM:hs