

APPLICATION

A 14790

P _____

SEWAGE DISPOSAL TESTING

MARYLAND STATE DEPARTMENT OF HEALTH

HOWARD COUNTY *up to 750 g.p.d.* ELLICOTT CITY

*Dist. will be 468 ft. cap. of 11" diameter sewer
line to be installed in inlet pipe manhole - dist. of 11" will
be 11" to 12" from original grade & into a well. 4' part of
manhole by line and 9' dist. of manhole of manhole to be set
in line of a standard line out of the existing lat.*

DISTRICT 4

DATE 9/8/69

TO: THE COUNTY HEALTH OFFICER
ELLICOTT CITY, MARYLAND

I, HEREBY, APPLY FOR THE NECESSARY TESTS IN ORDER TO CONSTRUCT (OR RECONSTRUCT) A SEWAGE DISPOSAL SYSTEM.

PROPERTY OWNER Bernard Duplan - Valley View Landscape Co.

ADDRESS Hipsley Mill Road, BFD #2, Woodbine, Md. PHONE 442-2444

PROPERTY LOCATION:

SUBDIVISION _____ LOT NO. _____

ROAD AND DESCRIPTION Hipsley Mill Rd. - 650 ft. South of Jennings Chapel Rd.

Name on fence

OCCUPANT _____ PHONE _____

PERSON TO CONSTRUCT SYSTEM _____

ADDRESS _____ PHONE _____

SIZE OF LOT 11.669 acres TYPE BLDG Trailer (Use barn
3 for landmark
NUMBER OF BEDROOMS approx. 150

IF NOT SINGLE RESIDENCE DESCRIBE _____

SIGNATURE OF APPLICANT Bernard Duplan

APPROVED BY Jane T. D. [unclear] FOR [unclear] DATE 9/19/69
(KIND OF SYSTEM)

REJECTED BY _____ FOR _____ DATE _____
(KIND OF SYSTEM)

HOLD PENDING FURTHER TESTS _____ DATE _____

REASONS FOR REJECTION OR HOLDING _____

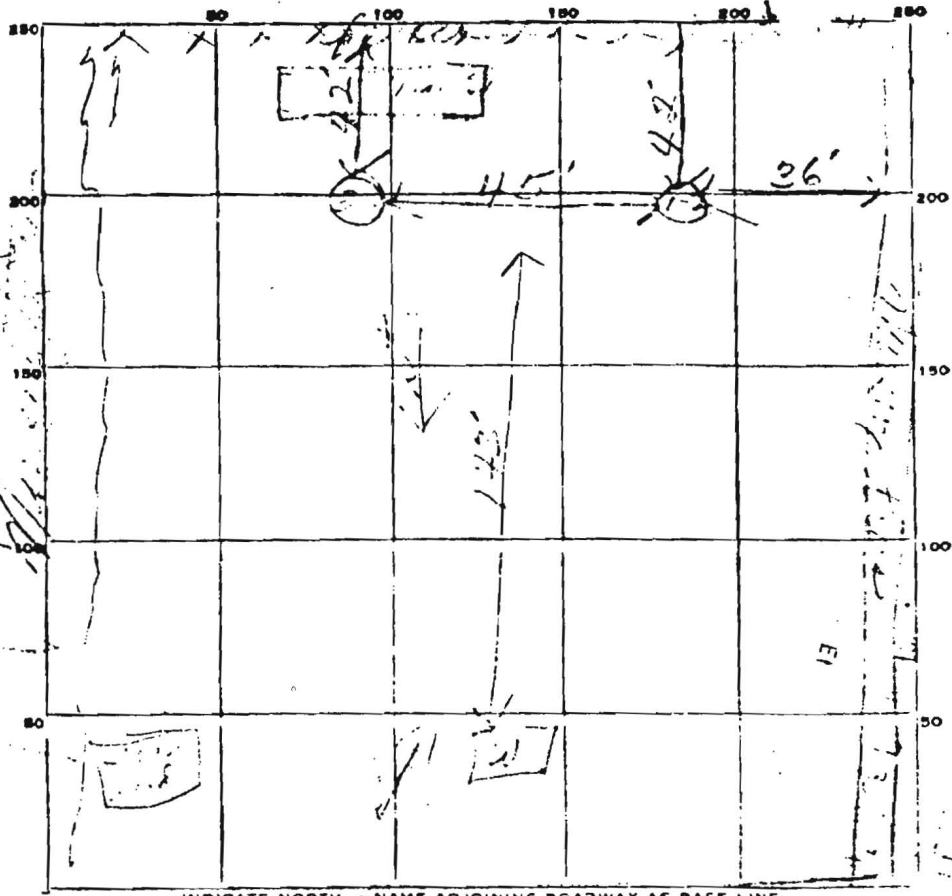

INDICATE NORTH - NAME ADJOINING ROADWAY AS BASE LINE

DATE	TEST NO.	DEPTH	PRE-WET		TEST - 1" DROP		TIME
			START	STOP	START	STOP	
9/10/2	1	10'	10 ³⁵	10 ⁵⁴	10 ⁵⁴	11 ¹⁵	2:10
	2	5'	10 ⁴³	10 ⁵²	10 ⁵²	11 ⁰⁰	2:00
	3	10'	10 ⁵⁴	10 ⁵⁸	10 ⁵⁸	11 ⁰⁰	5:00
	4	5'	10 ⁵⁶	11 ⁰⁰	11 ⁰⁰	11 ⁰⁰	12:00

16
11:00
11:00

SOIL AUGER FINDING *1/2" - 1/4" ...*