

APPLICATION

A 1977
P _____
DISTRICT 1
DATE 1/23/77

SEWAGE DISPOSAL TESTING

STATE OF MARYLAND - DEPARTMENT OF HEALTH AND MENTAL HYGIENE

HOWARD COUNTY HEALTH DEPARTMENT
ENVIRONMENTAL HEALTH SERVICES
P. O. BOX 476, ELLICOTT CITY, MARYLAND 21043
TELEPHONE: 469-3000, EXT. 300

TO: THE COUNTY HEALTH OFFICER
ELLICOTT CITY, MARYLAND

I, HEREBY, APPLY FOR THE NECESSARY TEST IN ORDER TO CONSTRUCT (OR RECONSTRUCT) A SEWAGE DISPOSAL SYSTEM.

PROPERTY OWNER Francis H. Barr & wife

ADDRESS 925 Day Road, Silverville, Maryland PHONE 469-1300

PROPERTY LOCATION:

SUBDIVISION _____ LOT NO. 6

ROAD AND DESCRIPTION right-of-way off Day Road - left turn just beyond brick house
black mail box - Shockey

SIZE OF LOT 1.1 acres TYPE BLDG. S
NUMBER OF BEDROOMS
(Single story, fully.)

IF NOT SINGLE RESIDENCE DESCRIBE _____

THE SYSTEM INSTALLED UNDER THIS APPLICATION IS ACCEPTABLE ONLY UNTIL PUBLIC FACILITIES BECOME AVAILABLE.

SIGNATURE OF APPLICANT Francis H. Barr

APPROVED BY _____ FOR _____ DATE _____
(KIND OF SYSTEM)

REJECTED BY _____ FOR _____ DATE _____
(KIND OF SYSTEM)

HOLD PENDING FURTHER TESTS _____ DATE _____

REASONS FOR REJECTION OR HOLDING _____

THIS IS NOT A PERMIT

LOT 5
AS PER
DOTTED
LINE

ATTACHED
PLAN
143173
Final Plat
→
Erioged

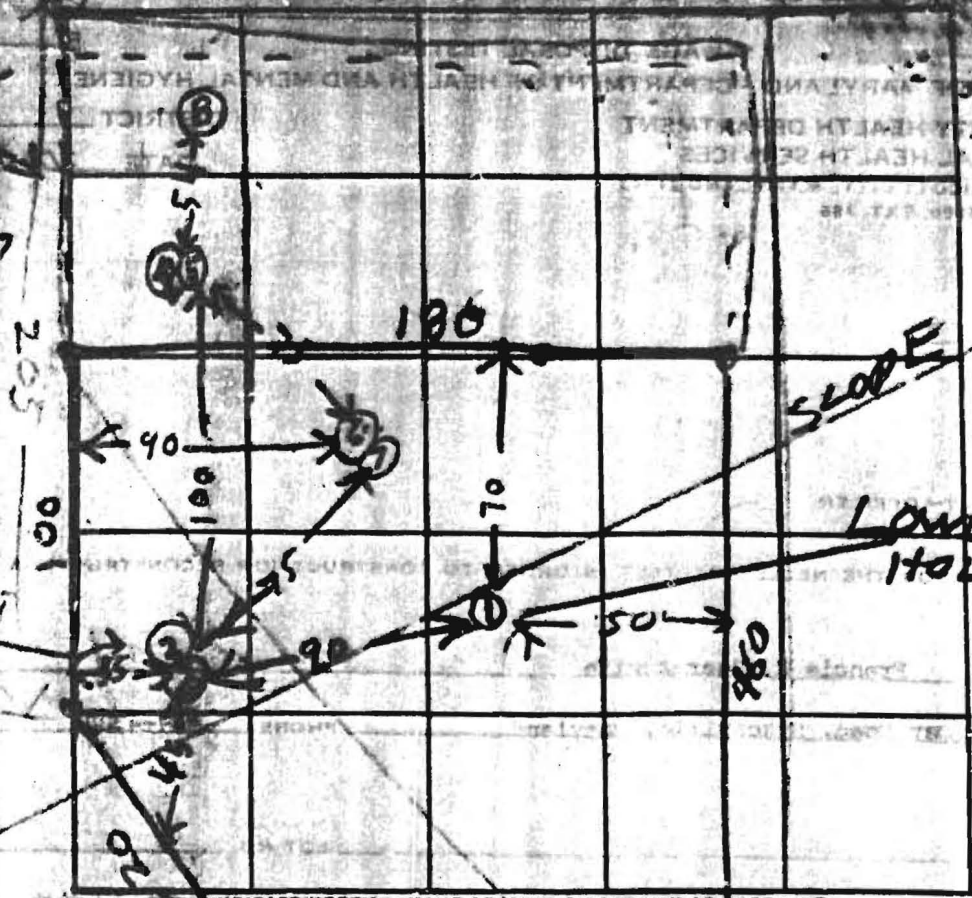

HIGHEST
HOLE
FOR
DW

INDICATE NORTH - NAME ADJOINING ROADWAY AS BOUNDARY LINE.

DATE	TEST NO.	DEPTH	PRE-WET		TEST - 1" DROP		TIME	
			START	STOP	START	STOP		
3/7/73	1	11	UNDERGROUND WATER COMES IN AT 10 FT TOP OF CLAY					
	2	7 1/2	1030	1035	1035	1055	20	
	3	5 1/2	1030	1035	1035	1145	10	
	4	11	1100	1103	1103	1126	3	
	5	5 1/2	1100	1103	1103	1105	2	
	6	11	1126	1134	1134	1145	11	
	7	5 1/2	1128	1134	1134	1144	6	
	8	11	TOP SET CLAY BUT GET SAND				DW	
	9	10	TOP SET CLAY BUT GET SAND					

DN LOT
#6 up or

REMARKS: LOT 5 TO RESIDUE LOT has good septic system
 & plenty of open area for both existing house

TESTED BY _____ ALSO PRESENT: _____