

PERMIT

SEWAGE DISPOSAL SYSTEM

MARYLAND STATE DEPARTMENT OF HEALTH

HOWARD COUNTY

ELLICOTT CITY

DISTRICT 301

DATE 4/4/78

INDEXED

William Snyder

IS PERMITTED TO INSTALL X ALTER

ADDRESS 3445 Apt. B Plum Tree Drive, Ellicott City, Md.

PHONE 465-1566

SUBDIVISION ~~Howard County~~

ROAD 987 Day Road

LOT 3

PROPERTY OWNER

William Snyder

Charles Faddis

ADDRESS same as above

SPECIFICATIONS

3 bedrooms

SEPTIC TANK CAPACITY 1000 GALLONS

DRAIN FIELD _____ DEPTH _____ FEET, BOTTOM AREA _____ SQ. FT.

DEEP TRENCH _____ DEPTH _____ FEET, BOTTOM AREA _____ SQ. FT.

SEEPAGE PITS _____ ABSORBENT SIDE-WALL AREA 429 SQ. FT. total sidewall area in dry well.

INLET PIPE 5 FT. BELOW ORIGINAL GRADE. MAXIMUM DEPTH 12 FT. BELOW ORIGINAL GRADE

EFFECTIVE DEPTH AT _____ FT. BELOW ORIGINAL GRADE.

LOCATE DISPOSAL AREA 45 FT. FROM 210.00' LOT LINE AND 35 FT. FROM 205.20' LOT LINE

PLANS APPROVED BY

Raymond Hodges

DATE 2/13/74

COVER AND WORK UNTIL INSPECTED AND APPROVED.

NEITHER THE HOWARD COUNTY COUNCIL NOR THE HEALTH DEPARTMENT IS RESPONSIBLE FOR THE SUCCESSFUL OPERATION OF ANY SYSTEM.

NOTE IF TRENCH IS USED CALL FOR INSPECTION BEFORE PLACING GRAVEL IN TRENCH.

NOTE NO DRY WELL SHALL EXCEED 15 FOOT IN DIAMETER.

NOTE ALL PIPE FROM HOUSE TO DISPOSAL AREA MUST BE CAST IRON.

PERMIT VOID AFTER THREE YEARS.

NOTE INSTALL STAND PIPE ON SEPTIC TANK AND DRY WELL. STAND PIPES MUST BE 8 INCHES IN DIAMETER. CAST IRON, CONCRETE OR TERRAZO ACCEPTED.

BLDG. PERMIT SIGNED
AND RETURNED 9/5/84
Serial # 66674 P.H.

INSTALLER IS RESPONSIBLE FOR OBTAINING FINAL APPROVAL ON THIS PERMIT.

17989

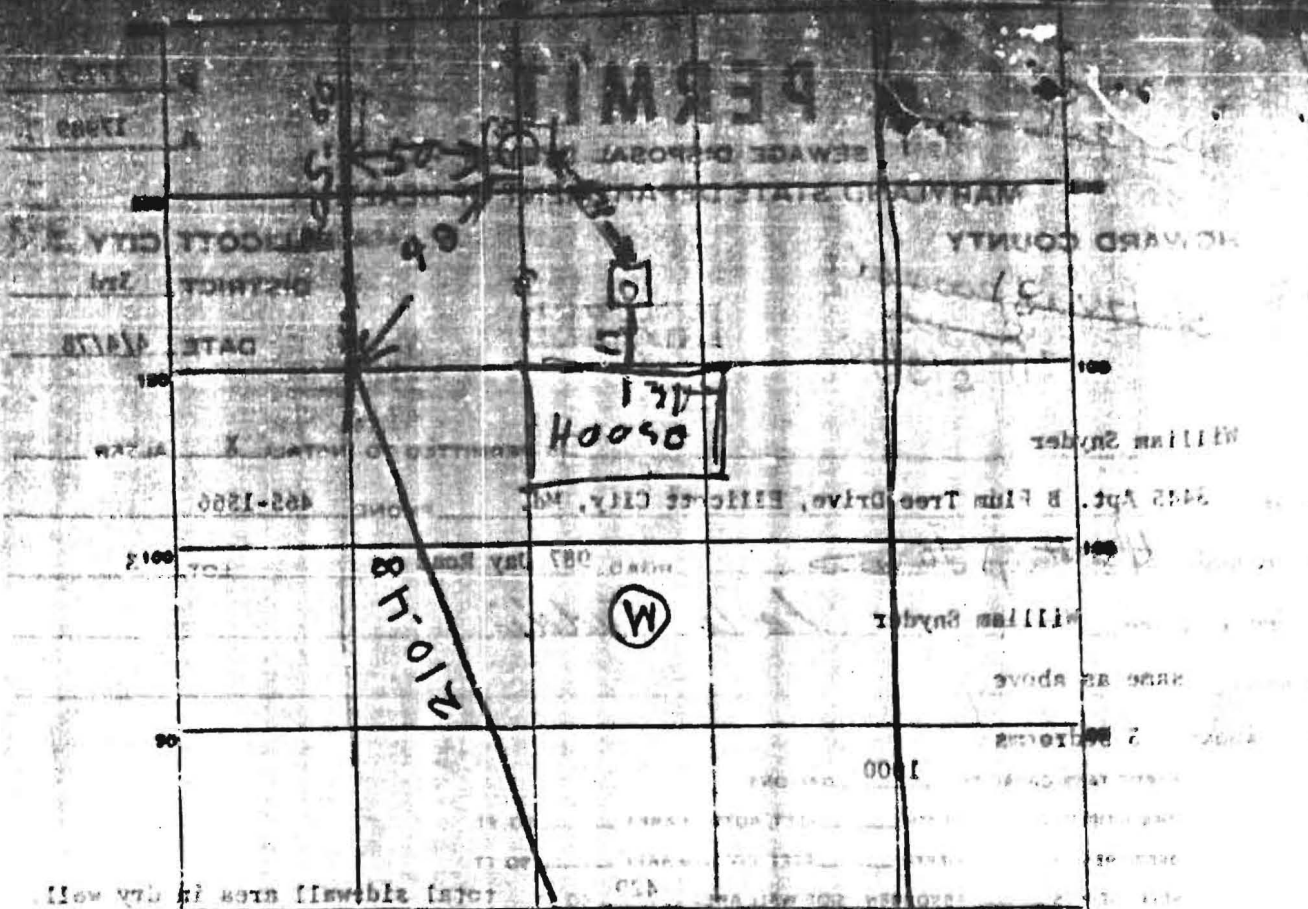

INDICATE NORTH & NAME ADJOINING ROADWAY AS BASE LINE.

PERMIT CARD _____ ST DW 4/27/78

SEPTIC TANK LEVEL 10.00 CLEANOUTS 019 V
TOP 2 FT BELOW GRADE

DISTRIBUTION BOX LEVEL _____

TILE FIELD, DEPTH _____ FT. TRENCH WIDTH _____ FT.

GRAVE DEPTH _____ IN. TOTAL LENGTH _____ FT.

NUMBER OF TRENCHES _____ TOTAL BOTTOM AREA _____

SEEPAGE PITS, INSIDE DIAMETER PERMIT # 4 FT. DEPTH BELOW INLET 20 1/2 (NOT YET INSTALLED) FT. 4/27/78

ABSORBENT AREA 448 SQ. FT.

REMARKS 4/27/78 AM - UNCERTAIN IF LOCATION OF DW IS
RIGHT. OWNER MUST MEET & SHOW INSPECTOR WHERE
LOT LINES LOCATED. SEPTIC TANK HOUSE
SEWER OK. DRYWELL INCOMPLETE R/H
4/27/78 AM LOCATION OK MET WITH OWNER, OK TO COVER
TANK & HOUSE SEWER. CALL FOR INSPECTION OF DRYWELL INLET & CLEANOUT

DATE SYSTEM APPROVED 5/3/78 INSPECTOR T. S. Ogle

