

3/23/04 - 10 AM

5/6 2 PM

PUB. SEWER STATUS VERIFIED BY mlb/corunetom

ISSUE DATE: 3/17/04

P 520102

APPROVAL DATE: 5/6/04

A REPAIR

PERMIT INDEXED

ON-SITE SEWAGE DISPOSAL SYSTEM HOWARD COUNTY HEALTH DEPARTMENT BUREAU OF ENVIRONMENTAL HEALTH

06-405029

Fyock Septic Service IS PERMITTED TO INSTALL ALTER

ADDRESS: PO Box 89, Glenelg, MD 21737 PHONE NUMBER: 410-988-9270

SUBDIVISION: _____ LOT NUMBER: _____

ADDRESS: 5509 Old Columbia Road PROPERTY OWNER: Stephen Gnadt

SEPTIC TANK CAPACITY (GALLONS): Ex. 1000

PUMP CHAMBER CAPACITY (GALLONS): N/A

NUMBER OF BEDROOMS: 4

SQUARE FEET PER BEDROOM: 210

LINEAR FEET OF TRENCH REQUIRED: 100

TRENCHES:	Trench to be <u>2</u> feet wide. Inlet <u>4</u> feet below original grade. Bottom maximum depth <u>10</u> feet below original grade. Effective area begins at <u>5</u> feet below original grade. <u>5</u> feet of stone below distribution pipe.
LOCATION:	
PURPOSE:	Existing septic system has failed. Call for inspection when ground is opened so sanitarian can recommend repair.

PLANS APPROVED: [Signature] DATE: 3/23/04

- NOTE: PERMIT VOID AFTER 2 YEARS
- NOTE: CONTRACTOR RESPONSIBLE FOR SCHEDULING A PRE-CONSTRUCTION INSPECTION FOR ALL INSTALLATIONS
- NOTE: WATERTIGHT SEPTIC TANKS REQUIRED
- NOTE: ALL PARTS OF SEPTIC SYSTEM SHALL BE 100 FEET FROM ANY WATER WELL
- NOTE: MANHOLE RISERS REQUIRED ON ALL SEPTIC TANKS AND PUMP CHAMBERS

NEITHER THE HOWARD COUNTY COUNCIL OR THE HEALTH DEPARTMENT IS RESPONSIBLE FOR THE SUCCESSFUL OPERATION OF ANY SYSTEM PERMITTEE RESPONSIBLE FOR OBTAINING FINAL APPROVAL ON THIS PERMIT CALL 410-313-2640 FOR INSPECTION OF SEPTIC SYSTEM

NOT TO SCALE

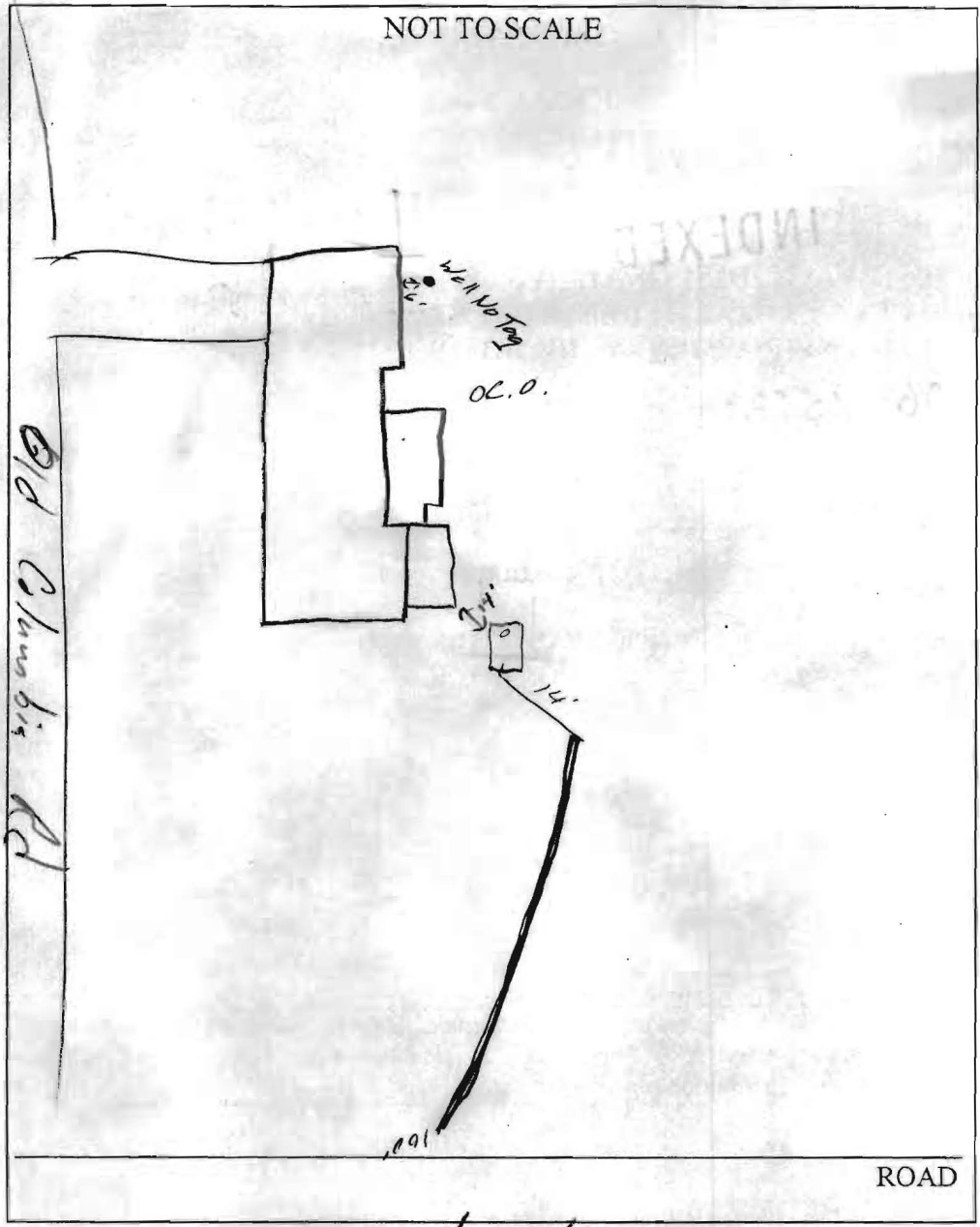

TRENCH/DRAINFIELD DATA		
WIDTH	INLET	BOTTOM
2'	4'	10'
NUMBER OF TRENCHES		1
TOTAL LENGTH		100'
ABSORPTION AREA		600sq
DISTRIBUTION BOX LEVEL		<input checked="" type="checkbox"/>
DISTRIBUTION BOX BAFFLE		<input checked="" type="checkbox"/>
DISTRIBUTION BOX PORT		<input checked="" type="checkbox"/>

SEPTIC TANK DATA	
SEPTIC TANK 1 LEVEL	
CAPACITY	2,100 GAL
SEAM LOC	Mid
TANK LID DEPTH	3'
BAFFLES	<input checked="" type="checkbox"/>
BAFFLE FILTER	
MANHOLE LOC	
6" PORT LOC	
WATERTIGHT TEST	
SEPTIC TANK 2 LEVEL	
CAPACITY	GAL
SEAM LOC	
TANK LID DEPTH	
BAFFLES	
BAFFLE FILTER	
MANHOLE LOC	
6" PORT LOC	
WATERTIGHT TEST	

PRE-CONSTRUCTION 3/23/04 - see perc sheet.

INSTALLATION 5/6/04 - Trench installed OK to cover all work (SD)

FINAL INSPECTOR [Signature] DATE OF APPROVAL 5/6/04