



B 1 6040  
1, 2 3 6

SEQUENCE NO. (MDE USE ONLY)

STATE OF MARYLAND  
APPLICATION FOR PERMIT TO DRILL WELL  
519000 please type

STATE PERMIT NUMBER

HO-94-3729  
fill in this form completely

Date Received (APA)  
06/06/03  
8 MM DD YY 13

OWNER INFORMATION

Toll Brothers  
6830 Creekside Rd  
Clarksville md. 21029

B 3 LOCATION OF WELL

Howard  
Pindell Chase  
Columbia  
MILES FROM TOWN (enter 0 if in town) 5

B 4 DIRECTION OF WELL FROM TOWN (CIRCLE BOX)

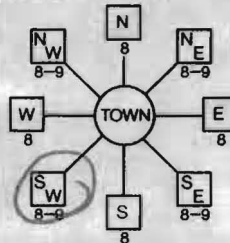

Pindell Chase Dr.  
ON WHICH SIDE OF ROAD (CIRCLE APPROPRIATE BOX)  
DISTANCE FROM ROAD 50 FT  
TAX MAP: 41 BLK: 14 PARCEL 59

B 2 WELL INFORMATION

APPROX. PUMPING RATE 5 (GAL. PER MIN.)  
AVERAGE DAILY QUANTITY NEEDED 500 (GAL. PER DAY)

USE FOR WATER (CIRCLE APPROPRIATE BOX)

- DOMESTIC POTABLE SUPPLY & RESIDENTIAL IRRIGATION
- FARMING (LIVESTOCK WATERING & AGRICULTURAL IRRIGATION)
- INDUSTRIAL, COMMERCIAL, DEWATERING
- PUBLIC WATER SUPPLY WELL
- TEST, OBSERVATION, MONITORING
- GEO-THERMAL

NOT TO BE FILLED IN BY DRILLER HEALTH DEPARTMENT APPROVAL

HOWARD COUNTY NAME  
A514292-C COUNTY NO.  
DATE ISSUED 07/03/03  
CO SIGNATURE Mark P. Riffin  
NORTH GRID 486000 EAST GRID 822000

APPROXIMATE DEPTH OF WELL 300 FEET  
APPROXIMATE DIAMETER OF WELL 6 INCH

METHOD OF DRILLING (circle one)

AIR-ROTary JETTED Jetted & DRIVEN  
AIR-PERCussion ROTARY (Hydraulic Rotary)  
CABLE REVERSE-ROTary DRIVE-POINT

REPLACEMENT OR DEEPEMED WELLS (CIRCLE APPROPRIATE BOX)

- THIS WELL WILL NOT REPLACE AN EXISTING WELL
- THIS WELL WILL REPLACE A WELL THAT WILL BE ABANDONED AND SEALED
- THIS WELL WILL REPLACE A WELL THAT WILL BE USED AS A STANDBY-CONTACT LOCAL APPROVING AUTHORITY FOR POLICY ON STANDBY WELLS
- THIS WELL WILL DEEPEM AN EXISTING WELL

SHOW MAJOR FEATURES OF BOX & LOCATE WELL WITH AN X  
SOURCES OF DRILLING WATER  
1. WELL

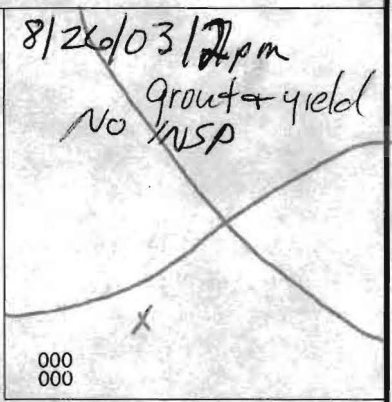

WRITE THE BOX NUMBER FROM THE MAP HERE  
E 822  
N 486

DRAW A SKETCH BELOW SHOWING LOCATION OF WELL IN RELATION TO NEARBY TOWNS AND ROADS AND GIVE DISTANCE FROM WELL TO NEAREST ROAD JUNCTION

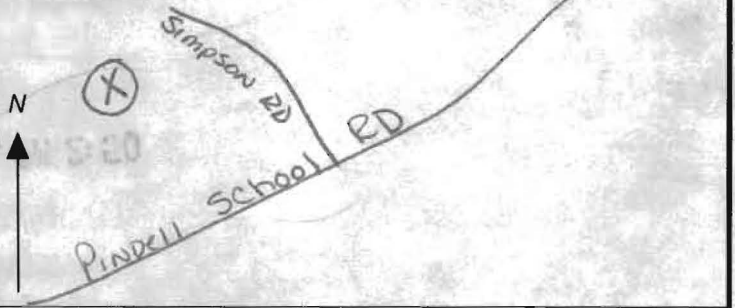

Not to be filled in by driller (MDE OR COUNTY USE ONLY)

APPROX. PERMIT NUMBER G  
PERMIT No. HO-94-3729

SPECIAL CONDITIONS  
NOTE - APPROVING AUTHORITIES SHOULD USE SEPARATE SHEET IF NEEDED



**HOWARD COUNTY HEALTH DEPARTMENT  
BUREAU OF ENVIRONMENTAL HEALTH  
WATER AND SEWERAGE PROGRAM  
TEL: (410)313-2640 FAX: (410)313-2648**

Information Form for the Installation of the Well Pump, Pitless Adapter, and Supply Piping

**NOTE: The installer is responsible for requesting an inspection prior to 9 am on the day of the desired inspection. No work is to be covered until approved by the Health Department. All installations must comply with the National Standard Plumbing Code (NSPC, as amended locally) and COMAR 26.04.04 (MD Well Construction Regulations). Submission of a complete form is required prior to Use and Occupancy approval.**

Company Name: Fogles Well Drilling Telephone #: 410-795-5670  
Address: 580 Obrecht Rd  
Sykesville, Md 21784

(Must circle one) Licensed Plumber Licensed Well Driller Licensed Well Pump Installer

License # and name of individual responsible for the field installation:  
Name (Print): Allen Compton License# MSD 009

\*A licensed individual must perform the actual installation. Apprentices must be under the direct supervision of a licensed journeyman or master plumber, pump installer or well driller. Licenses may be subjected to field verification.

Name of Property Owner: Toll Brothers Telephone #: \_\_\_\_\_  
Subdivision: Pindell Chase Lot #: 3 Well Tag #: HO-94-3729  
Site Address: 11712 Pindell Chase DR

<u>Submersible Pump Data</u>	<u>Pitless Adapter</u>	<u>Well Cap and Electric Conduit</u>
Make: <u>Goulds</u>	Make: <u>Cambell</u>	Two piece watertight cap: <u>yes</u>
Model #: <u>53Bn7422</u>	Model#: <u>N/A</u>	Screened, vented well cap: <u>yes</u>
Pump Capacity <u>5</u> GPM	Depth: <u>36</u> (36" min)	Cap secured to casing: <u>yes</u>
Well Yield: <u>4.5</u> GPM	NSF approved: <u>yes</u>	Conduit min 18" B.G.: <u>yes</u>
Depth of well encountered at time of pump installation: <u>308</u> (feet)		Conduit secured to well cap: <u>yes</u>

If pump capacity exceeds well yield, a low water cut off switch is required by NSPC 1990 Section 17.8.4  
Torque arrestors or Cable guards are required - Must circle one  
Safety rope, if used, attached to inside of well casing with eye bolt N/A

<u>Piping to house</u>	<u>House Connection</u>
Type: <u>1" Black Plastic</u>	PVC sleeved to undisturbed soil at wall penetration: <u>yes</u>
PSI: <u>160</u> (160 psi min)	Approximate length of sleeve: <u>5</u>
Depth of supply line: <u>42</u> (36" min)	Sleeve caulked and sealed properly: <u>yes</u>

The water supply line is required to be at least ten feet from the septic tank, pump chamber, sewage piping, distribution box, drainfields, and sewage reserve area. If this cannot be accomplished, contact this office for approval prior to installation.

Allen Compton 4-20-04  
Signature of company representative responsible for installation date

For Health Department Use Only - Not to be completed by Installer

Date Insp. Requested: \_\_\_\_\_ Date Insp. Approved: 2/12/04 (SO) BB

Inspection Data: Pitless adapter and water supply line at least 36" below grade ✓

Two piece cap installed and attached to casing securely ✓

Elec. conduit extends at least 18" below grade/attached to cap properly ✓

Safety rope installed inside of well casing ✓

Correct well tag attached properly and casing 8" above finished grade ✓

Water supply line sleeved adequately at house connection ✓

Adequate grout observed below pitless adapter ✓

**PLAN**  
SCALE 1" = 30'

Well Site OK  
MR 6/30/03  
N.D. Insp

**MATCH LINE SEE SHEET 5**

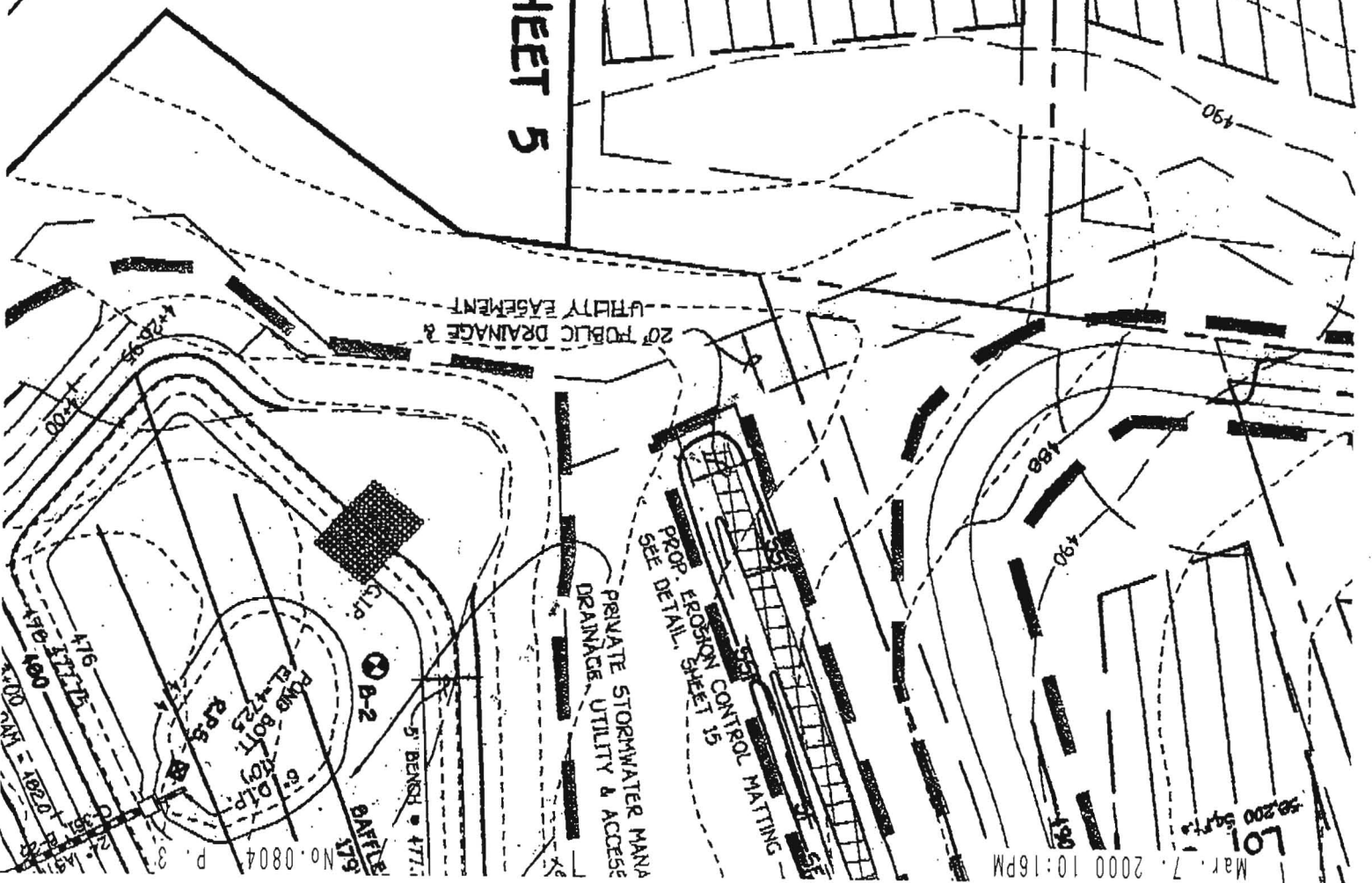
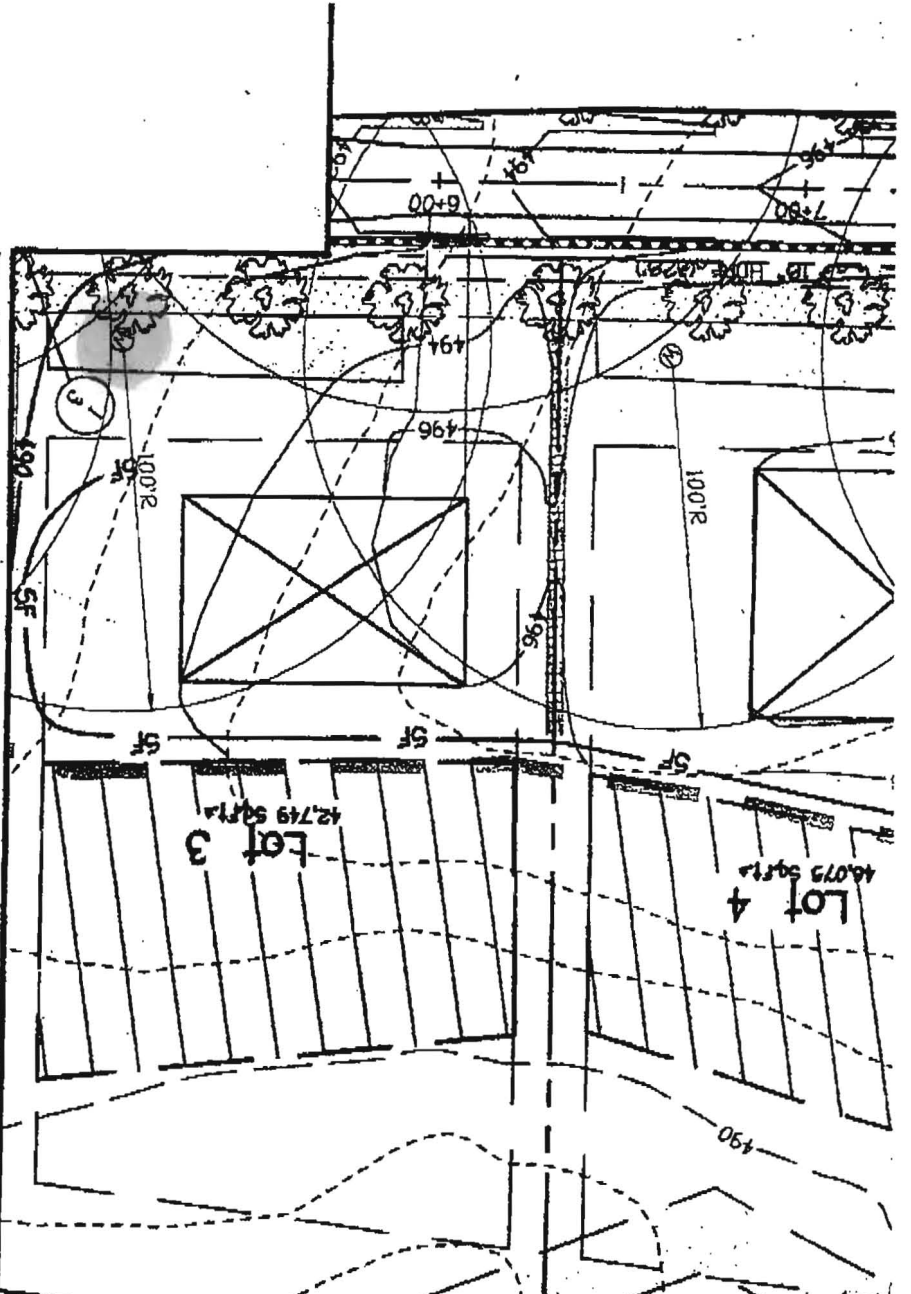

Lot 1  
16,200 sq ft  
Mar. 7, 2000 10:16 PM