

9-5-95
am c/o

PERMIT

SEWAGE DISPOSAL SYSTEM

DEPARTMENT OF HEALTH AND MENTAL HYGIENE

INDEXED

P 509676

A REPAIR

DISTRICT 5th

DATE _____

HOWARD COUNTY HEALTH DEPARTMENT

BUREAU OF ENVIRONMENTAL HEALTH

~~461-9933~~ 313-2640

DATE SYSTEM APPROVED 9/5/95

INSPECTOR [Signature]

Jack Fyock Septic Service IS PERMITTED TO INSTALL _____ ALTER X

ADDRESS 13775 Triadelphia Road, Glenelg, MD 21737 PHONE 988-9270

SUBDIVISION Linden Chapel Hills LOT 11 ROAD 4991 Morning Star Drive

PROPERTY OWNER Jonathan & Jeanne Seiles

ADDRESS _____

SEPTIC TANK CAPACITY 1500 GALLONS

NUMBER OF BEDROOMS 5

_____ SQUARE FEET PER BEDROOM

LINEAR FEET OF TRENCH REQUIRED _____

**BUILDING PERMIT SIGNED
AND RETURNED**

10-10-03 B08M3927-ADDITION

REPAIR - PURPOSE - DRY WELL IS FULL.

Call for inspection when ground is opened so sanitarian can recommend repair.

PLANS APPROVED BY _____ DATE _____

COVER NO WORK UNTIL INSPECTED AND APPROVED

NEITHER THE HOWARD COUNTY COUNCIL NOR THE HEALTH DEPARTMENT IS RESPONSIBLE FOR THE SUCCESSFUL OPERATION OF ANY SYSTEM

NOTE: CLEANOUT REQUIRED EVERY 70 FEET OF SEWER LINE AND/OR AT 90° SWEEPS IN LINES FROM HOUSE TO DRAIN FIELDS, 90° ELBOWS NOT ACCEPTABLE.

NOTE: ALL PARTS OF SEPTIC SYSTEMS (I.E. TANK, DISTRIBUTION BOX TRENCHES) TO BE 100 FEET FROM WELL (UNLESS OTHERWISE SPECIFICALLY AUTHORIZED)

NOTE: IF DEEP TRENCH(ES) ARE USED CALL FOR INSPECTION BEFORE AND AFTER PLACING GRAVEL IN TRENCH(ES)

NOTE: NO DRY WELL SHALL EXCEED 15 FOOT IN DIAMETER NO ABSORPTION TRENCH TO EXCEED 100 FEET IN LENGTH

NOTE: ALL PIPE FROM HOUSE TO SEPTIC TANK MUST BE CAST IRON OR SCHEDULE 35/40 PVC OR ABS

PERMIT VOID AFTER TWO YEARS

NOTE: INSTALL STAND PIPE ON SEPTIC TANK AND DRY WELL STAND PIPES MUST BE 6 INCHES IN DIAMETER CAST IRON. CONCRETE OR TERRA COTTA OR PVA OR ABS ACCEPTED. IF TOP OF SEPTIC TANK IS DEEPER THAN 3 FEET. MANHOLE TO GRADE REQUIRED.

NOTE: DISTRIBUTION BOXES MUST HAVE BAFFLES

***INSTALLER IS RESPONSIBLE FOR OBTAINING FINAL APPROVAL ON THIS PERMIT**

P509676

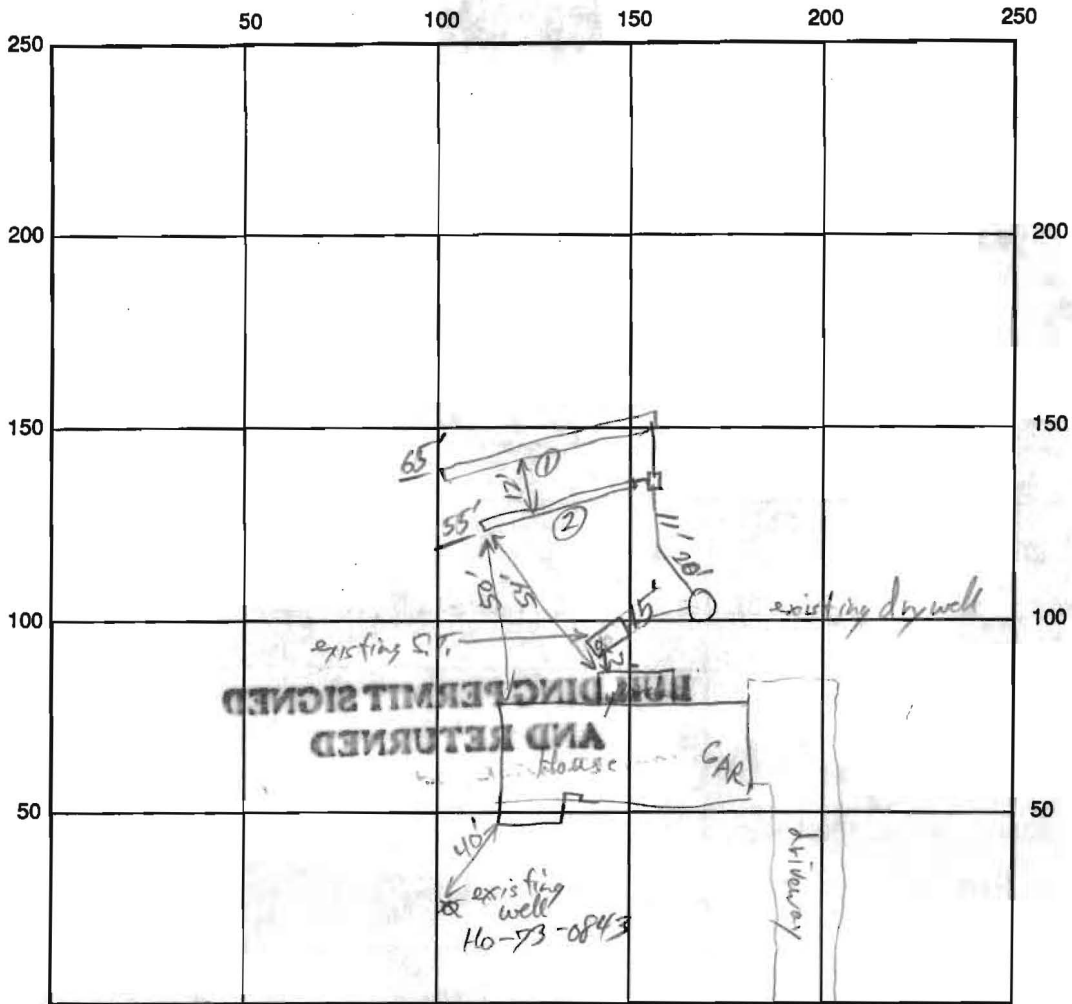

Morning Star Dr. INDICATE NORTH - NAME ADJOINING ROADWAY AS BASE LINE

SEPTIC TANK LEVEL existing 1000gal CLEANOUTS existing S.T. + dry well
 DISTRIBUTION BOX LEVEL ✓
 DRAIN FIELD/TITLE DEPTH 10 FT. TRENCH WIDTH 2' FT. INLET DEPTH 4 FT.
 EFFECTIVE GRAVEL DEPTH 6 FT. TOTAL LENGTH 65/55' FT. = 120 125
x 5 Bdn
625
 NUMBER OF TRENCHES 2 ONE SIDEWALL/BOTTOM AREA 720 SQ. FT.
 DRYWALL INSIDE DIAMETER NA FT. EFFECTIVE DEPTH BELOW INLET NA FT.
 ABSORBENT AREA NA SQ. FT.

REMARKS: First Trench OK to cover, second trench OK to gravel fill. OK to cover when finished. RP 9/5/95

DATE SYSTEM APPROVED 9/5/95 INSPECTOR AP